

T H E C O O P E R S N C O M P

SN Product Line

The housings have bolt hole centre distances and base to bearing centre-line heights that conform to ISO 113-2. Complete SN assemblies are suitable for replacement of solid, self aligning ball bearings and in most cases, 222 Series double row spherical bearings using adaptor sleeves.

The Cooper SN compatible pedestal is available for bearings with shaft sizes from 60mm (2 1/4") (SN513) to 140mm (5 1/2") (SN532).

The pedestals use standard Cooper 01 Series bearings and cartridges. This gives the option of using the comprehensive range of Cooper sealing options suitable for almost any application.

The seals remain concentric to the shaft under misalignment conditions.

The use of standard Cooper bearings and cartridges will cause the footprint area and total housing height to differ from compatible SN housings.

Pedestals are made from grey cast iron. Temperature and vibration mounting points may be specified.

Pedestal Loads

The maximum safe radial load for a pedestal casting is based on the bearing static rating C_{OR} . The full C_{OR} rating can be applied if the angle of the load falls within the shaded area of the diagram shown on the right.

If the load falls outside the shaded area or is greater than C_{OR} , please consult our technical department.

When considering suitability of pedestal castings, the resultant effective radial load must be used. The effective radial load is the resultant of net loads and appropriate dynamic factors, excluding speed and life factors.

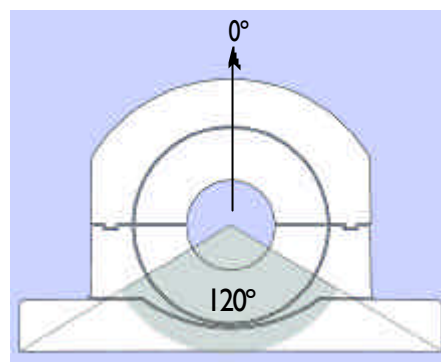

COOPER NOMENCLATURE - HOW TO ORDER

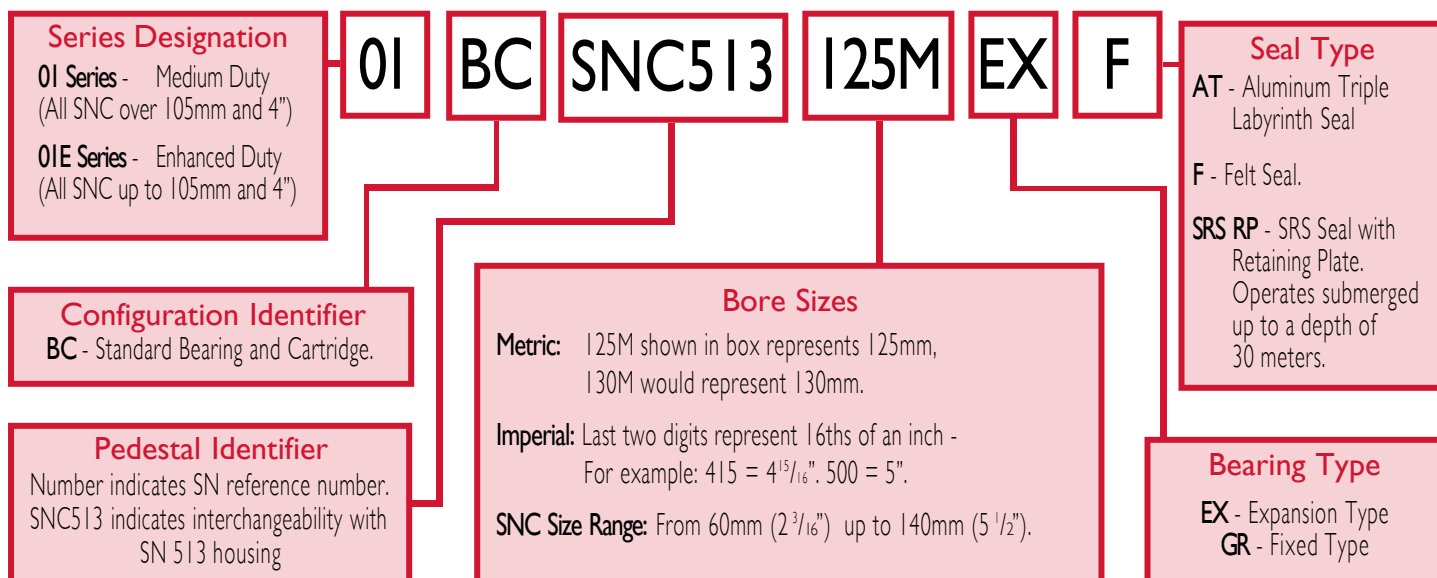

SN Product Line - Nomenclature Examples

- 01E BC SNC513 60M EX F:** Standard 60mm bearing, cartridge and pedestal assembly, expansion type with felt seals.
- 01 BC SNC532 503 GR AT:** Fixed type (5 1/16") bearing and cartridge assembly with aluminium triple labyrinth seals in a SN 532 compatible housing.

I N C R E A S E S U P T I M E

T I B L E P R O D U C T L I N E

Shaft Size mm *	Complete Standard Assembly	Alternative Bearing Sizes *	H	R		Bolt Size	L	N	O	P	T
				Min	Max						
60	01EBC SNC513 60M	65mm (2 ^{3/16}) (2 ^{1/4}) (2 ^{7/16})(2 ^{1/2})	80 3 ^{5/32}	226 8 ^{7/8}	242 9 ^{1/2}	2 x M16 5/8	104 4 ^{3/32}	280 11 1/32	70 2 ^{3/4}	32 1 1/4	180 7 ^{3/32}
65	01EBC SNC515 65M	60mm (2 ^{3/16}) (2 ^{1/4}) (2 ^{7/16})(2 ^{1/2})	80 3 ^{5/32}	226 8 ^{7/8}	242 9 ^{1/2}	2 x M16 5/8	104 4 ^{3/32}	280 11 1/32	70 2 ^{3/4}	32 1 1/4	180 7 ^{3/32}
70	01EBC SNC516 70M	75mm (2 ^{1/16}) (2 ^{3/8}) (2 ^{15/16})(3)	95 3 3/4	254 10	266 10 15/32	2 x M20 3/4	114 4 1/2	315 12 13/32	90 3 35/64	38 1 1/2	206 8 ^{7/64}
75	01EBC SNC517 75M	70mm (2 ^{1/16}) (2 ^{3/8}) (2 ^{15/16})(3)	95 3 3/4	254 10	266 10 15/32	2 x M20 3/4	114 4 1/2	315 12 13/32	90 3 35/64	38 1 1/2	206 8 ^{7/64}
80	01EBC SNC518 80M	85mm 90mm (3 ^{1/8}) (3 ^{1/4}) (3 ^{7/8}) (4)	100 3 15/16	284 11 3/16	296 11 21/32	2 x M20 3/4	136 5 23/64	345 13 17/64	100 3 15/16	32 1 17/64	240 9 29/64
85	01EBC SNC519 85M	80mm 90mm (3 ^{1/8}) (3 ^{1/4}) (3 ^{7/8})(3 1/2)	112 4 13/32	284 11 3/16	296 11 21/32	2 x M20 3/4	136 5 23/64	345 13 17/64	100 3 15/16	44 1 3/4	252 9 59/64
90	01EBC SNC520 90M	80mm 85mm (3 ^{1/8}) (3 ^{1/4}) (3 ^{7/8})(3 1/2)	112 4 13/32	312 12 29/32	382 12 29/32	2 x M24 7/8	136 5 23/64	380 14 31/32	90 3 35/64	44 1 3/4	252 9 59/64
100	01EBC SNC522 100M	105mm (3 ^{1/16}) (3 ^{3/8}) (3 ^{15/16})(4)	125 4 15/16	342 13 15/32	366 14 13/32	2 x M24 7/8	134 5 1/4	420 16 17/32	102 4 1/64	52 2 3/64	271 10 11/16
110	01EBC SNC524 110M	115mm (4 ^{3/16}) (4 ^{7/16}) (4 1/2)	140 5 1/2	344 13 35/64	356 14 1/64	2 x M24 7/8	142 5 5/8	410 16 9/64	120 4 23/32	45 1 25/32	310 12 13/64
115	01EBC SNC526 115M	110mm (4 ^{3/16}) (4 ^{7/16}) (4 1/2)	150 5 29/32	372 14 41/64	388 15 9/32	2 x M24 7/8	142 5 5/8	450 17 23/32	130 5 1/8	50 1 31/32	320 12 19/32
125	01EBC SNC528 125M	120mm 130mm (4 ^{15/16}) (5)	150 5 29/32	414 16 19/64	426 16 25/32	2 x M30 1 1/4	156 6 1/8	500 19 11/16	150 5 29/32	50 1 31/32	360 14 1/64
135	01EBC SNC530 135M	140mm (5 ^{1/8}) (5 ^{7/16}) (5 1/2)	160 6 19/64	444 17 31/64	456 17 61/64	2 x M30 1 1/4	168 6 5/8	530 20 55/64	160 6 19/64	56 2 13/64	381 15
140	01EBC SNC532 140M	135mm (5 ^{1/8}) (5 ^{7/16}) (5 1/2)	170 6 11/16	462 18 3/16	478 18 13/16	2 x M30 1 1/4	168 6 5/8	558 21 31/32	178 7	41 1 39/64	391 15 25/64

Metric Sizes Shown in Red. Imperial Sizes Shown in Black. Add EX to reference for Expansion Type or GR for Fixed Type.

* Shaft Size indicates standard SNC bearing. * Alternative Bearing Sizes shown may be fitted in the same pedestal.

T E C H N I C A L S P E C I F I C A T I O N S

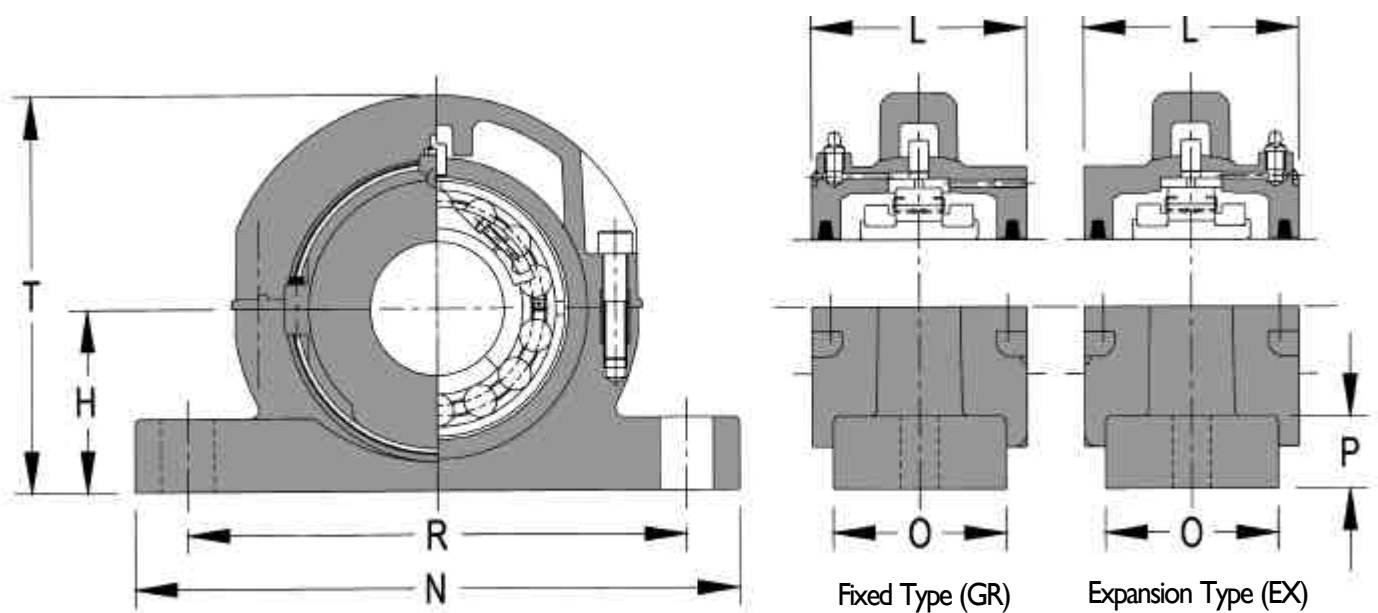

N D C U T S D O W N T I M E