

# CONTENTS

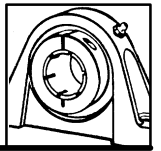

## D-LOK™ Ball Bearings

Features/Benefits .....	B4-2
How To Order/Nomenclature .....	B4-4
Selection .....	B4-5
Selection/Dimensions	
Pillow Blocks	
DL Normal Duty .....	B4-10
DLM - Medium Duty .....	B4-24
Flanges	
2-Bolt Flanges .....	B4-29
3-Bolt Flanges .....	B4-35
4-Bolt Flanges .....	B4-36
Piloted Flanges .....	B4-36
Take-Up Bearings	
Wide Slot .....	B4-48
Narrow Slot .....	B4-42
Inserts	
DL Normal Duty .....	B4-54
DLM - Medium .....	B4-58
Modifications/Accessories .....	B4-60
Related Products	
End Caps .....	B4-61
Part Number Index .....	INDEX-1
Keyword Index .....	INDEX-28

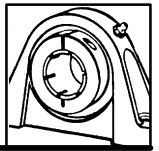

## FEATURES/BENEFITS

### D-LOK Ball Bearings

For concentric grip on the shaft and less vibration at higher speeds, specify DODGE D-LOK normal- or medium-duty mounted ball bearings.

These unique, concentric collar bearings are engineered with features that assure you superior holding power with improved concentricity.

Even at high speeds, the D-LOK bearing grips the shaft tighter and more uniformly for less vibration.

Manufactured at our state-of-the-art, ISO 9002-certified DODGE bearing plant in Rogersville, Tennessee, the new DODGE D-LOK bearing features:

- Precision-hardened and honed inner and outer rings
- New rugged housing design
- Normal-duty wide inner ring
- D-LOK locking mechanism
- DODGE PROGUARD PLUS™ land riding, positive contact seal with flingers
- Stronger, flexible ball retainer
- Simplified anti-rotation device
- Wide variety of styles
- 3/4" to 2-11/16" bore sizes
- Electrostatically applied epoxy paint
- Options:
  - Corrosion-resistant inserts
  - FDA/USDA lubricant and other special lubricants
  - High temperature

### PRECISION-FINISHED INNER AND OUTER RINGS

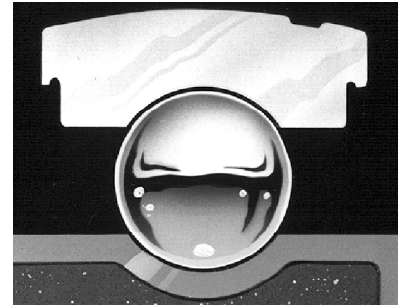

Precision-finished inner and outer rings feature hardened surfaces for greater wear resistance, quieter operation, and longer life.

### DODGE PROGUARD PLUS SEAL

DODGE PROGUARD PLUS SEAL

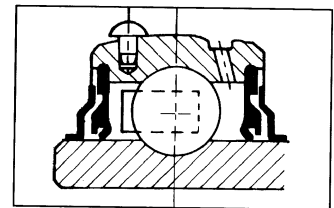

PROGUARD PLUS seal guards against contaminants, minimizes power loss from friction. This one-piece, land-riding, positive contact seal is mechanically anchored into position. It's specially compounded, nitrile rubber lip reduces the coefficient of friction.

### NEW D-LOK CONCENTRIC CLAMP COLLAR

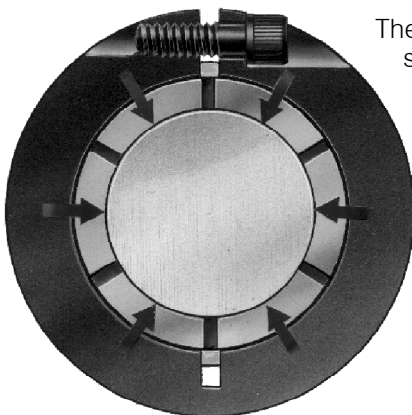

The D-LOK concentric clamp collar, with a single standard hex head cap screw and relief slot, provides greater holding power over competitive products. The collar, installed over the slotted inner ring, locks the bearing on the shaft concentrically—without marring or burring—and provides a 360° clamping force to the shaft with minimal run out (T.I.R.) for less vibration.

Patent number 5417500

# FEATURES/BENEFITS

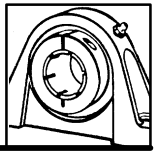

## D-LOK Ball Bearings

### NON-METALLIC RETAINER



Ball cage is made of heat-stabilized nylon, reinforced with 33% short strand fiberglass. This non-metallic container operates in higher temperatures with less water absorption and retains natural lubricity and flexibility.

### ANTI-ROTATION PIN

Anti-rotation pin prevents rotation of the outer race within the housing. Simple and effective, it makes system inserts easier to replace. There is no need to remove and replace grease fittings, location pins, or other devices.



### EXPANSION AND NON-EXPANSION MODELS

A complete series of expansion and non-expansion pillow blocks and bearing inserts are available. These all have the standard features of our D-LOK, plus a specially engineered retainer to meet the operating conditions where these bearings are required.

### RUGGED HOUSING DESIGN

Rugged housing design offers added strength. Solid feet are drilled for dowel pins—simplifies installation, alignment.

### WIDE VARIETY OF STYLES

#### Normal Duty

- DL Pillow Blocks
- DLB Pillow Blocks
- DLH Pillow Blocks
- DLH-E Pillow Blocks
- DL Tapped Base Pillow Blocks
- DL 2-Bolt Flanges
- DL Flanged Bracket Bearings
- DL 4-Bolt Flanges
- DL Piloted Flanges
- DL Inserts

#### Medium Duty

- DLM Pillow Blocks
- DLM 2-Bolt Flanges
- DLM 4-Bolt Flanges
- DLM Piloted Flanges
- DLM Inserts

### IN STOCK NEAR YOU

The complete line of DODGE mounted ball bearings is available at your local authorized DODGE distributor. For more information, check the Yellow Pages for your local distributor, call (864) 297-4800, or fax (864) 281-2318.

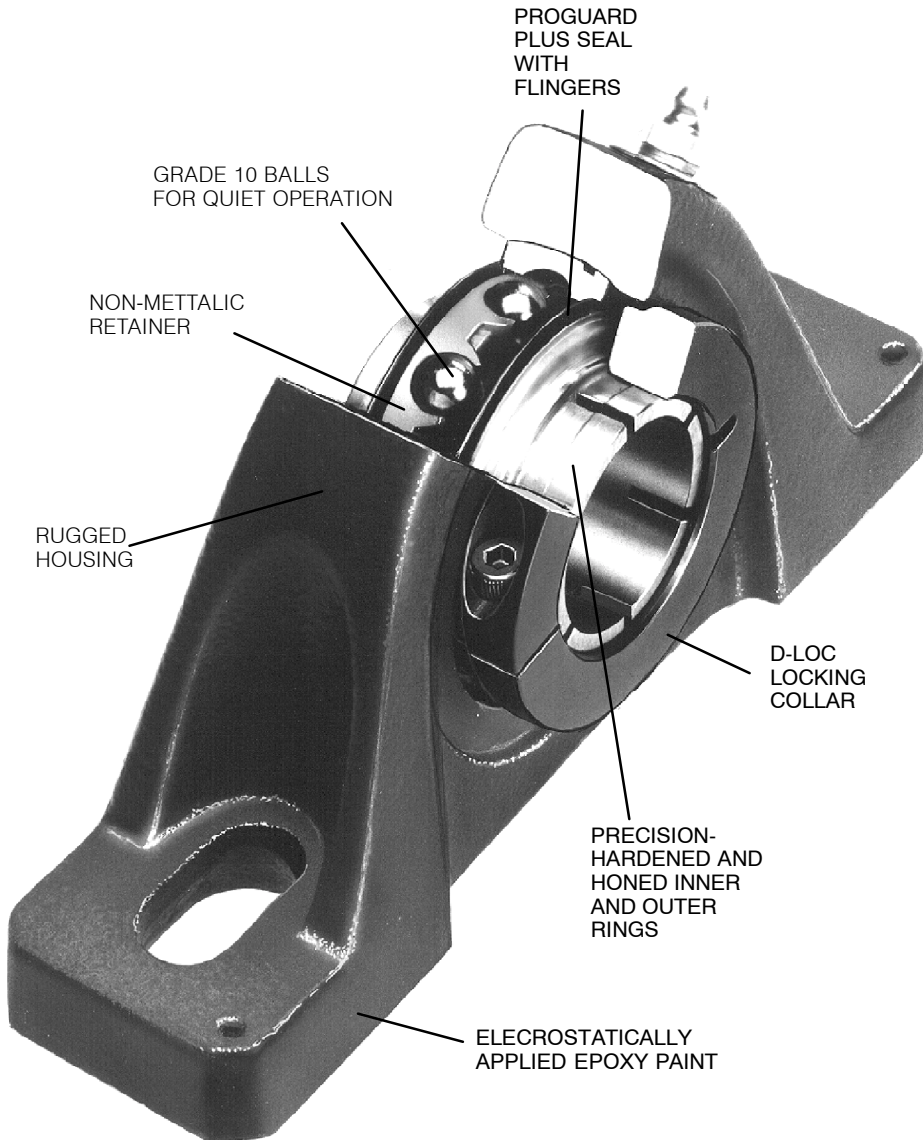

# HOW TO ORDER/ NOMENCLATURE

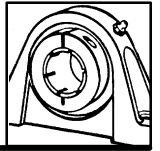

## D-LOK Ball Bearings

### HOW TO ORDER

There are two ways to specify DODGE Bearings. Most of the product offering have part numbers with listings shown throughout this catalog. Use of part numbers ensures accurate order processing.

When part numbers are not shown, the product may be specified by description or part name. This method is

used when ordering units that include modifications or options. To order by description, use the nomenclature key shown below and add any special instruction to the end of the description for options not covered by the nomenclature.

### NOMENCLATURE

P2B		DLAH		115	E	
Housing Style	Bearing Type	Shaft Size	Modifications/Features			
F2B	2 Bolt Flange	DL	Normal Duty, D-Lok Wide Inner Ring Bearings	104	Inches and 16ths First digit: number of inches. Second and third digit: number of sixteenths of an inch. 104 indicates 1-4/16 or 1-1/4	E Expansion FF Flingers on both sides of the insert LL Low torque labyrinth seals NL No lube or sealed for life
F2BZ	2 Bolt Piloted Flange	DLB	Normal Duty D-Lok Wide Inner Ring Bearings with low backing height	S	Indicates the next smaller ring size other than standard. 104S signifies 1-1/4 206 ring size	
F4B	4 Bolt Flange	DLH	Normal Duty, D-Lok Wide Inner Ring Bearings with high backing height for use in non-expansion and expansion mounted units.	L	Indicates the next larger ring size other than standard. 200L signifies 2" 211 ring size.	
FB	Flanged Bracket	DLMAH	Air Handling DLM Bearings			
FC	Flanged Cartridge (Piloted Flange)					
INS	Insert					
LF	Light Duty Flange, 3 Bolt					
LFT	Light Duty Flange, 2 Bolt					
P2B	Pillow Blocks					
TB	Tapped Base Pillow Blocks					
TP	Top Angle					
WSTU	Wide Slot Take-Up					
NSTU	Narrow Slot Take-Up					

# SELECTION

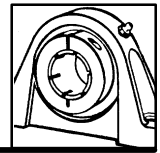

## D-LOK Ball Bearings

DODGE mounted ball bearings are primarily designed for radial loading. However, they have the capacity to carry thrust loads and combined radial/thrust loads. The maximum recommended load which can be applied is limited by various components in the system, such as bearing, housing, shaft attachments, speed and life requirements. DODGE mounted ball bearings have been applied successfully when these limits have been exceeded under controlled operating conditions. Contact DODGE Engineering for applications which exceed these recommendations.

Select a bearing from the Selection Chart that has a radial load rating at the operating speed equal to or greater than the calculated Equivalent Radial load for a desired  $L_{10}$  life. This simple method is all that is required for the majority of general applications and provides for occasional average shock loads.

**$L_{10}$  Hours Life**—is the life which may be expected for at least 90% of a given group of bearings operating under identical conditions.

For an  $L_{10}$  hours life other than those listed in the Selection Chart, multiply the equivalent Radial load by one of the following factors. For 50,000  $L_{10}$  hours life, use a factor of 1.18 and for 80,000, use 1.39. Then select a bearing from the bold face (30,000)  $L_{10}$  ratings only in the Selection Chart that has a rating equal to or greater than this value.

**Heavy Service**—For heavy shock loads, frequent shock loads or severe vibrations, add up to 50% (according to severity of conditions) to the Equivalent Radial Load to obtain a Modified Equivalent Radial Load. Consult Application Engineering for additional selection assistance.

A thrust load value of  $C/10$  is recommended as a guide for general applications and will give adequate  $L_{10}$  life. Where substantial radial load pulls the housing away from the mounting base, both the hold-down bolts and housing must be of adequate strength. Auxiliary load carrying devices, such as shear bars, are advisable for side or end-loading of pillow blocks and radial loads for flange units.

To determine the  $L_{10}$  hours life for loads and RPM's not listed use the following equation:

$$L_{10} = \left(\frac{C}{P}\right)^3 \times \frac{16667}{\text{RPM}}$$

Where:

$L_{10}$  = Life, hours

C = Dynamic capacity, lbs. or N

P = Equivalent Radial Load, lbs. or N

When the load on a ball bearing is solely a radial load with no thrust (axial) load, the Equivalent Radial Load (P) is equal to the actual radial load. However, when a thrust (axial) load is applied, the radial and thrust loads applied must be converted into an Equivalent Radial Load. The use of the X (radial factor) and Y (thrust factor) from Table 1 convert the actual applied thrust and radial loads to an Equivalent Radial Load which has the same effect on the life of a bearing as a radial load of this magnitude.

$$P = (X \times F_R) + (Y \times F_A)$$

Where:

P = Equivalent Radial Load, lbs.

$F_R$  = Radial load, lbs.

$F_A$  = Thrust load, lbs.

e = Thrust load to radial load factor (Table 1)

X = Radial load factor (Table 1)

Y = Thrust factor (Table 1)

$C_o$  = Basic static capacity

To find X and Y, first calculate  $F_A/C_o$  to determine e. Calculate  $F_A/F_R$  and compare to e to determine the X and Y factors to use from Table 1.

Substitute all known values into the Equivalent Radial Load equation. The Equivalent Radial loads (P) thus determined can be used in the  $L_{10}$  life formula or compared to the allowable Equivalent Radial Load rating desired in the expanded rating chart to select a bearing (Table 2).

If calculated value of P is less than  $F_R$ , use  $P=F_R$ .

Table 1

$\frac{F_A}{C_o}$	e	Radial/Thrust Factors			
		If $F_A/F_R$ is equal to or less than e		If $F_A/F_R$ is greater than e	
		$F_A/F_R \leq e$		$F_A/F_R > e$	
		X	Y	X	Y
.014	.19	1	0	.56	2.30
.021	.21	1	0	.56	2.15
.028	.22	1	0	.56	1.99
.042	.24	1	0	.56	1.85
.056	.26	1	0	.56	1.71
.070	.27	1	0	.56	1.63
.084	.28	1	0	.56	1.55
.110	.30	1	0	.56	1.45
.170	.34	1	0	.56	1.31
.280	.38	1	0	.56	1.15
.420	.42	1	0	.56	1.04
.560	.44	1	0	.56	1.00

**Lubrication**—DODGE Ball Bearings are lubricated at the factory and are ready to run. The bearings are initially lubricated with Shell Alvania #2 and should be relubricated with the same or some equivalent. For high speeds, high loads, extreme temperatures and other abnormal operating conditions, special greases may be required. Contact DODGE Application Engineering for recommendations on these types of applications.

**Misalignment**—DODGE Ball Bearings are designed to allow a maximum of  $\pm 2^\circ$  static misalignment. These bearings are not suitable for dynamic misalignment. To ensure good alignment, mounting surfaces must be checked for flatness and must lie in the same plane. When tightening base bolts, each bolt should be alternately tightened in incremental torque values until full torque is achieved to prevent the angular shifting of the pillow block that occurs when one bolt is tightened to its full torque. Shimming may be required to minimize misalignment.

Normal Shaft Size Inches	Shaft Tolerances		Recommended Shaft Tolerances D-LOK Ball Bearings Inches
	Commercial Shaft Tolerances Inches		
Up to 1-1/2"	+0.000	-0.002	+0.0000 -0.0005
Over 1-1/2" to 2-1/2"	+0.000	-0.003	+0.0000 -0.0010
Over 2-1/2" to 4"	+0.000	-0.004	+0.0000 -0.0010

MODIFICATIONS PAGE B4-60			
-----------------------------	--	--	--

# SELECTION

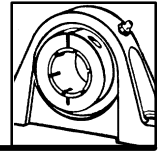

## D-LOK Ball Bearings

TABLE 2 EASY SELECTION FOR DL AND DLM BALL BEARING MOUNTED UNITS (POUNDS)

RING SIZE	SHAFT SIZE		DYNAMIC CAPACITY	STATIC CAPACITY	L10 LIFE	ALLOWABLE EQUIVALENT RADIAL LOAD RATINGS (LBS.) AT VARIOUS RPM*																
	DL	DLM				50	150	250	500	750	100	150	175	200	2500	3000	3500	4500	5000	5500	750	
204	3/4		2899	1390	20000	740	515	435	345	300	295	240	225	295	200	190	180	165	160	155	140	
					30000	645	450	380	300	260	240	210	200	190	175	165	155	145	140	135	120	
					40000	590	410	345	275	240	215	190	180	170	160	150	145	130	125	110	105	95
					60000	515	355	300	240	210	190	165	155	150	140	130	125	115	110	105	95	90
					100000	435	300	255	200	175	160	140	130	125	115	110	105	100	95	90	80	80
205	7/8 15/16 1		3146	1565	20000	805	560	470	375	3225	295	260	245	235	220	205	195	180	175	170	150	
					30000	705	485	410	325	285	260	225	215	205	190	180	170	155	150	145	130	
					40000	640	445	375	295	260	235	205	195	185	175	165	155	140	135	130	120	
					60000	560	385	325	260	225	205	180	170	165	150	140	135	125	120	115	105	
					100000	470	325	275	220	190	175	150	145	135	125	120	115	105	100	100	90	
206	1-1/8 1-3/16 1-1/4	1	4368	2250	20000	1115	775	655	520	455	410	360	340	325	305	285	270	250	240	235		
					30000	975	675	570	455	395	360	315	300	285	265	250	235	220	210	205		
					40000	885	615	520	410	360	325	285	270	260	240	225	215	200	190	185		
					60000	775	535	455	360	315	285	250	235	225	210	200	190	175	165	160		
					100000	655	455	380	305	265	240	210	200	190	175	165	160	145	140	135		
207	1-1/4 1-3/8 1-7/16	1-3/16 1-1/4	5759	3065	20000	1475	1020	860	685	595	545	475	450	430	400	375	355	330	315	305		
					30000	1285	890	755	595	520	475	415	395	375	350	330	310	285	275	270		
					40000	1170	810	685	545	475	430	375	355	340	315	300	285	260	250	245		
					60000	1020	710	595	475	415	375	330	310	300	275	260	250	230	220	125		
					100000	860	595	505	400	350	315	275	265	250	235	220	210	190	185	180		
208	1-1/2	1-7/16 1-1/2**	7332	4005	20000	1875	1300	1095	870	760	690	605	575	550	510	480	455	420	405			
					30000	1640	1135	960	760	665	605	525	500	480	445	420	400	365	355			
					40000	1490	1030	870	690	605	550	480	455	435	405	380	360	330	320			
					60000	1300	900	760	605	525	480	420	400	380	355	330	315	290	280			
					100000	1095	760	640	510	445	405	355	335	320	300	280	265	245	235			
209	1-5/8 1-11/16 1-3/4	1-1/2	7891	4450	20000	2020	1400	1180	935	820	745	650	615	590	550	515	490	450	435			
					30000	1765	1225	1030	820	715	650	570	540	515	480	450	430	395	380			
					40000	1600	1110	935	745	650	590	515	490	470	435	410	390	360	345			
					60000	1400	970	820	650	570	515	450	430	410	380	360	340	310	300			
					100000	1180	820	690	550	480	435	380	360	345	320	300	285	265	255			
210	1-15/16 2	1-11/16 1-3/4	7891	4450	20000	2020	1400	1180	935	820	745	650	615	590	550	515	490	450	435			
					30000	1765	1225	1030	820	715	650	570	540	515	480	450	430	395				
					40000	1600	1110	935	745	650	590	515	490	470	435	410	390	360				
					60000	1400	970	820	650	570	515	450	430	410	380	360	340	310				
					100000	1180	820	690	550	480	435	380	360	345	320	300	285	265				
211	2 2-3/16	1-15/16 2	9755	5630	20000	2491	1727	1457	1156	1010	918	802	761	729	676	636	604	556	528			
					30000	2176	1509	1272	1010	882	802	700	665	636	591	556	528					
					40000	1977	1371	1156	918	802	728	636	604	578	537	505	480					
					60000	1727	1197	1010	802	700	636	556	528	505	469	441	419					
					100000	1457	1010	852	676	591	537	469	445	426	395	372	353					
212	2-1/4 2-7/16	2-3/16 2-1/4	11791	6955	20000	3015	2090	1765	1400	1225	1110	970	925	880	820	770	730	680	640			
					30000	2635	1825	1540	1225	1070	970	880	805	770	715	675	640					
					40000	2395	1660	1400	1110	970	880	770	730	700	650	610	580					
					60000	2090	1450	1225	970	850	770	675	640	610	570	535	510					
					100000	1765	1225	1030	820	715	650	570	540	515	480	450	430					
214	2-1/2 2-11/16	2-7/16 2-1/2	13994	8415	20000	3580	2480	2095	1660	1450	1320	1155	1095	1045	970	915	850	800				
					30000	3125	2170	1830	1450	1270	1155	1005	955	915	850	800						
					40000	2840	1970	1660	1320	1155	1045	915	870	830	770	725						
					60000	2480	1720	1450	1155	1005	915	800	760	725	675	635						
					100000	2095	1450	1225	970	850	770	675	640	615	570	535						
215	2-15/16	2-11/16	14872	9255	20000	3805	2640	2225	1765	1545	1400	1225	1165	1115	1035	975	905	850				
					30000	3325	2305	1945	1545	1350	1225	1070	1015	975	905	850						
					40000	3020	2095	1765	1400	1225	1115	975	925	885	820	770						
					60000	2640	1830	1545	1225	1070	975	850	805	770	715	675						
					100000	2225	1545	1300	1035	905	820	715	680	650	605	570						
216		2-15/16	17407	11015	20000	4450	3085	2605	2065	1805	1640	1435	1360	1300	1210	1140	1055					
					30000	3890	2695	2275	1805	1580	1435	1250	1190	1140	1055							
					40000	3535	2450	2065	1640	1435	1300	1140	1080	1035	960							
					60000	3085	2140	1805	1435	1250	1140	995	945	905	840							
					100000	2605	1805	1525	1210	1055	960	840	795	760	705							
218		3-7/16	21451	13940	20000	5485	3805	3210	2550	2225	2025	1765	1680	1605								
					30000	4795	3325	2805	2225	1945	1765	1545	1465	1405								
					40000	4355	3020	2550	2025	1765	1605	1405	1335	1276								
					60000	3805	2640	2225	1765	1545	1405	1225	1165	1115								
					100000	3210	2225	1880	1490	1300	1185	1035	980	940								

\* Slight interference fit required when operating in the shaded area.

\*\* Piloted flange only.

FEATURES/BENEFITS PAGE B4-2	HOW TO ORDER/ NOMENCLATURE PAGE B4-4	SELECTION SET SCREW BALL BEARINGS PAGE B2-5	SELECTION ECCENTRIC COLLAR BALL BEARINGS PAGE B3-5
--------------------------------	--	---	--

# SELECTION

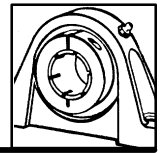

## D-LOK Ball Bearings – Metric

**TABLE 3 EASY SELECTION FOR DL AND DLM BALL BEARING MOUNTED UNITS (NEWTONS)**

RING SIZE	SHAFT SIZE (mm)		DYNAMIC CAPACITY C, (N.)	STATIC CAPACITY Co, (N.)	L10 LIFE HOURS	ALLOWABLE EQUIVALENT RADIAL LOAD RATINGS (N.) AT VARIOUS RPM*																			
	DL	DLM				50	150	250	500	750	1000	1500	1750	2000	2500	3000	3500	4500	5000	5500	7500				
204	20		12895	6183	20000	3292	2291	1935	1535	1334	1223	1068	1001	956	890	845	801	734	712	689	623				
					30000	2869	2002	1690	1334	1156	1068	934	890	845	778	724	689	645	623	600	534				
					40000	2624	1824	1535	1223	1068	956	845	801	756	712	667	645	578	556	512	489	467	423		
					60000	2291	1579	1334	1068	934	845	734	689	667	623	578	556	512	489	467	400	423	400	356	
					100000	1935	1334	1134	890	778	712	623	578	556	512	489	467	400	423	400	423	400	423	400	356
205	25		13993	6961	20000	3581	2491	2091	1668	1446	1312	1156	1090	1045	979	912	867	801	778	756	667				
					30000	3136	2157	1824	1446	1268	1156	1001	956	912	845	801	756	689	667	645	600	534			
					40000	2847	1979	1668	1312	1156	1045	912	867	823	778	734	689	623	600	600	600	600	534		
					60000	2491	1712	1446	1156	1001	912	801	756	734	667	623	600	556	534	512	467	445	445	400	
					100000	2091	1446	1223	979	845	778	667	645	600	556	534	512	467	445	445	445	445	445	400	
206	30		19429	10008	20000	4960	3447	2913	2313	2024	1824	1601	1512	1446	1357	1268	1201	1112	1068	1045					
					30000	4337	3002	2535	2024	1757	1601	1401	1334	1268	1179	1112	1045	979	934	912	912				
					40000	3936	2736	2313	1824	1601	1446	1268	1201	1156	1068	1001	958	890	845	823	823				
					60000	3447	2380	2024	1601	1401	1268	1112	1045	1001	934	890	845	778	734	712	667	667			
					100000	2913	2024	1690	1357	1179	1068	934	890	845	778	734	712	645	623	600	600	600	600		
207	35		25616	13633	20000	6561	4537	3825	3047	2647	2424	2113	2002	1913	1779	1668	1579	1468	1401	1357					
					30000	5716	3959	3358	2674	2313	2113	1846	1757	1668	1557	1468	1379	1268	1223	1201	1201				
					40000	5204	3603	3047	2424	2113	1913	1668	1579	1512	1401	1334	1268	1156	1112	1090	1090				
					60000	4537	3158	2647	2113	1846	1669	1468	1379	1334	1223	1156	1112	1023	979	956	956				
					100000	3825	2647	2246	1779	1557	1401	1223	1179	1112	1045	979	934	845	823	801	801	801			
208	40	35	32613	17814	20000	8340	5782	4871	3870	3380	3069	2691	2558	2446	2268	2135	2024	1868	1801						
					30000	7295	5048	4270	3380	2958	2691	2335	2224	2135	1979	1868	1779	1624	1579	1579					
					40000	6628	4581	3870	3069	2691	2446	2135	2024	1935	1801	1690	1601	1468	1423	1423					
					60000	5782	4003	3380	2691	2335	2135	1868	1779	1690	1576	1468	1401	1290	1245	1245					
					100000	4871	3380	2847	2268	1979	1801	1579	1490	1423	1334	1245	1179	1090	1045	1045					
209	45		35099	19794	20000	8985	6227	5249	4159	3647	3314	2891	2736	2624	2446	2291	2180	2002	1935						
					30000	7851	5449	4581	3649	3180	2891	2535	2402	2291	2135	2002	1913	1757	1690	1690					
					40000	7117	4937	4159	3314	2891	2624	2291	2180	2091	1935	1824	1735	1601	1535	1535					
					60000	6227	4315	3647	2891	2535	2291	2002	1913	1824	1690	1601	1512	1379	1334	1334					
					100000	5249	3647	3069	2446	2135	1935	1690	1601	1535	1423	1334	1268	1179	1134	1134					
210	50		35099	19794	20000	8985	6227	5249	4159	3647	3314	2891	2736	2624	2446	2291	2180	2002							
					30000	7851	5449	4581	3647	3180	2891	2535	2402	2291	2135	2002	1913	1757	1757						
					40000	7117	4937	4159	3314	2891	2624	2291	2180	2091	1935	1824	1735	1601	1512	1379					
					60000	6227	4315	3647	2891	2535	2291	2002	1913	1824	1690	1601	1512	1379	1379						
					100000	5249	3647	3069	2446	2135	1935	1690	1601	1535	1423	1334	1268	1179	1179						
211	55		43394	25042	20000	11079	7682	6479	5142	4492	4082	3566	3387	3241	3007	2830	2688								
					30000	9678	6711	5660	4492	3924	3566	3115	2959	2831	2627	2472	2348	2348							
					40000	8793	6097	5142	4082	3566	3240	2830	2688	2572	2387	2246	2134	2134							
					60000	7682	5326	4492	3566	3115	2830	2472	2348	2247	2085	1962	1864	1864							
					100000	6479	4492	3789	3007	2627	2387	2085	1981	1895	1759	1655	1572	1572							
212	60		52446	30936	20000	13411	9296	7851	6227	5449	4937	4315	4114	3914	3647	3425	3247								
					30000	11720	8118	6850	5449	4759	4315	3914	3425	3247	3114	2891	2713	2580	2580						
					40000	10653	7384	6227	4937	4315	3914	3425	3002	2847	2713	2535	2380	2268	2268						
					60000	9296	6450	5449	4315	3781	3425	3002	2847	2713	2535	2380	2268	2268							
					100000	7851	5449	4581	3647	3180	2891	2535	2402	2291	2135	2002	1913	1913							
214	70	65	62245	37430	20000	15924	11031	9319	7384	6450	5871	5137	4871	4648	4315	4070									
					30000	13900	9672	8140	6450	5649	5137	4470	4248	4070	3781	3558	3225	3225							
					40000	12632	8763	7384	5871	5137	4648	4070	3870	3692	3425	3225	2824	2824							
					60000	11031	7651	6450	5137	4470	4070	3558	3380	3225	3002	2824	2824								
					100000	9319	6450	5449	4315	3781	3425	3002	2847	2736	2535	2380	2380								

\* Slight interference fit required when operating in the shaded area.  
 \*\* Piloted flange only.

# SELECTION/DIMENSIONS

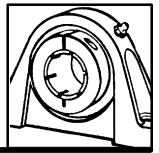

## D-LOK Ball Bearings

### DL NORMAL DUTY PILLOW BLOCKS

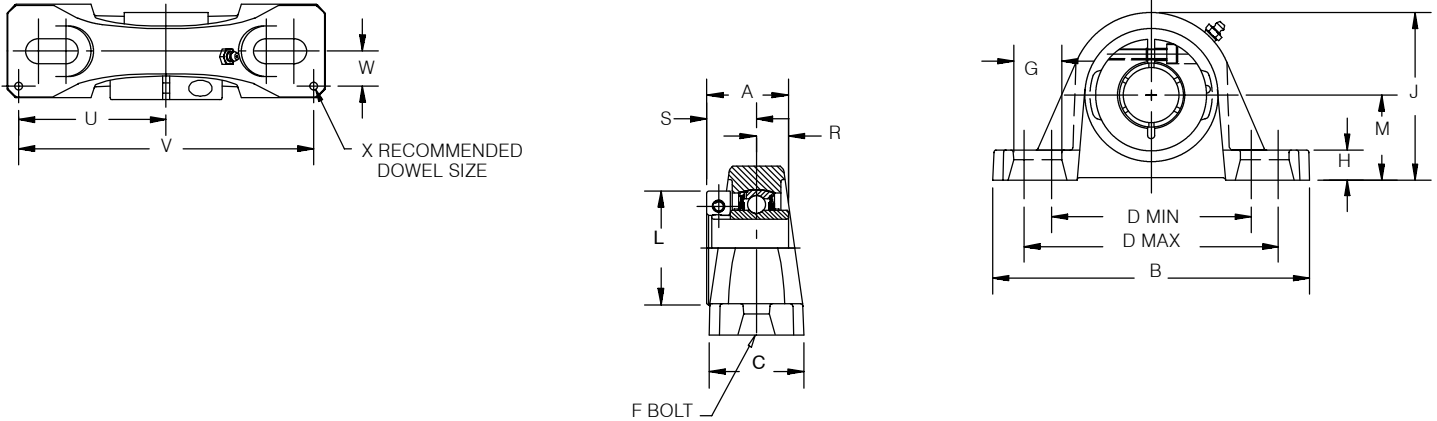

Series	Shaft Size	Part Number	Description
204	3/4	128700	P2B-DL-012
	20mm	126601	P2B-DL-20M
205	7/8	128701	P2B-DL-014
	15/16	128702	P2B-DL-015
	1	128703	P2B-DL-100
	25mm	126602	P2B-DL-25M
206	1-1/8	128704	P2B-DL-102
	1-3/16	128705	P2B-DL-103
	1-1/4	128706	P2B-DL-104S
	30mm	126603	P2B-DL-30M
207	1-1/4	128707	P2B-DL-104
	1-3/8	128708	P2B-DL-106
	1-7/16	128709	P2B-DL-107
	35mm	126604	P2B-DL-35M
208	1-1/2	128710	P2B-DL-108
	40mm	126605	P2B-DL-40M

@ Assembled to order

FEATURES/BENEFITS PAGE B4-2	HOW TO ORDER/ NOMENCLATURE PAGE B4-4	SELECTION PAGE B4-5	DIMENSIONS DL INSERTS PAGE B4-54
--------------------------------	--	------------------------	--



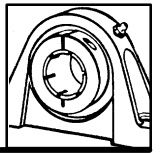

# SELECTION/DIMENSIONS

## D-LOK Ball Bearings

### DL NORMAL DUTY PILLOW BLOCKS

Series	Shaft Size	Weight lbs. kg.	A	B	C	D		F Bolt Dia.	G	
						Min.	Max.			
204	3/4 20mm	2.1	1-9/32	5	1-1/2	3-3/8	4-1/8	3/8	13/16	
		1.0	32.5	127.0	38.1	85.7	104.8	M10	20.6	
205	7/8 15/16 1 25mm	2.3	1-7/16	5-1/2	1-1/2	3-5/8	4-3/8	3/8	13/16	
		2.3								
		2.3								
		1.1	36.5	139.7	38.1	92.1	111.1	M10	20.6	
206	1-1/8 1-3/16 1-1/4 30mm	3.8	1-9/16	6-1/2	1-7/8	4-7/16	5-3/16	1/2	15/16	
		3.7								
		3.7								
		1.7	39.7	165.1	47.6	112.7	131.8	M12	23.8	
207	1-1/4 1-3/8 1-7/16 35mm	4.9	1-3/4	6-9/16	1-7/8	4-11/16	5-5/16	1/2	7/8	
		4.9								
		4.8								
		2.2	44.5	166.7	47.6	119.1	134.9	M12	22.2	
208	1-1/2 40mm	6.0	2	7-1/4	2-1/8	5-1/4	5-7/8	1/2	7/8	
		2.7	50.8	184.2	54.0	133.4	149.2	M12	22.2	

Series	Shaft Size	H	J	L	M	R	S	U	V	W	X
204	3/4 20mm	1/2	2-9/16	1-45/64	1-5/16	1/2	25/32	2-1/4	4-1/2	1/2	1/8
		12.7	65.1	43.3	33.3	12.7	19.8	57.2	114.3	12.7	3.2
205	7/8 15/16 1 25mm	5/8	2-13/16	2	1-7/16	9/16	7/8	2-1/2	5	1/2	1/8
		15.9	71.4	50.8	36.5	14.3	22.2	63.5	127.0	12.7	3.2
206	1-1/8 1-3/16 1-1/4 30mm	9/16	3-3/8	2-7/32	1-11/16	9/16	1	2-7/8	5-3/4	9/16	3/16
		14.3	85.7	56.4	42.9	14.3	25.4	73.0	146.1	14.3	4.8
207	1-1/4 1-3/8 1-7/16 35mm	11/16	3-13/16	2-11/16	1-7/8	11/16	1-1/16	2-29/32	5-13/16	9/16	3/16
		17.5	96.8	68.3	47.6	17.5	27.0	73.8	147.6	14.3	4.8
208	1-1/2 40mm	11/16	3-15/16	2-25/32	1-15/16	3/4	1-1/4	3-17/64	6-17/32	11/16	3/16
		17.5	100.0	70.6	49.2	19.1	31.8	82.9	165.9	17.5	4.8

MODIFICATIONS PAGE B4-60			
-----------------------------	--	--	--

# SELECTION/DIMENSIONS

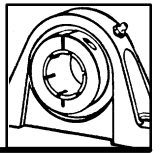

## D-LOK Ball Bearings

### DL NORMAL DUTY PILLOW BLOCKS

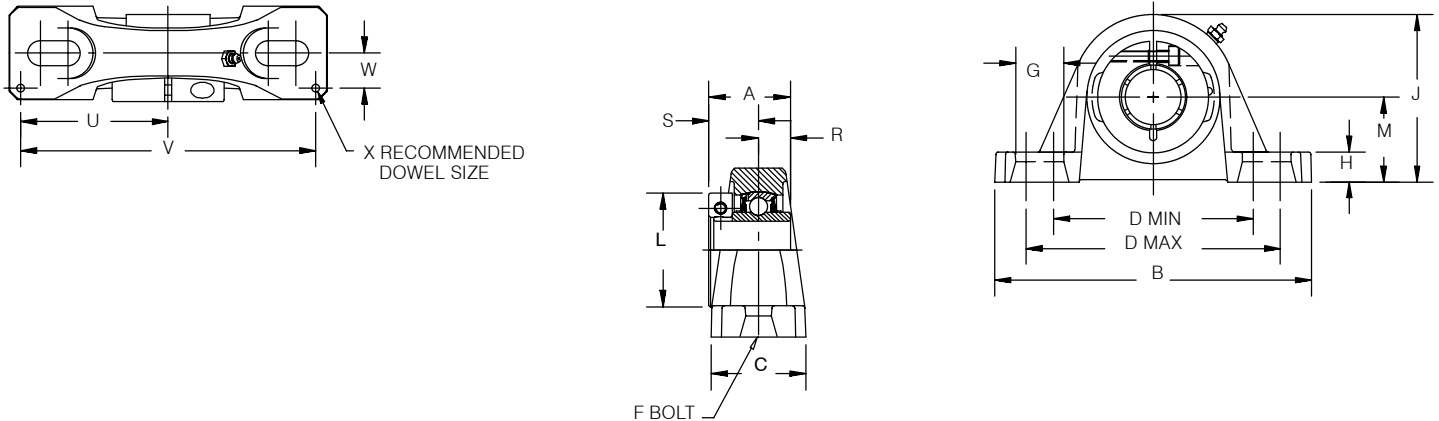

Series	Shaft Size	Part Number	Description
209	1-5/8	<b>128711</b>	P2B-DL-110L
	1-11/16	<b>128712</b>	P2B-DL-111
	1-3/4	<b>128713</b>	P2B-DL-112
	45mm	<b>126606</b>	P2B-DL-45M
210	1-15/16	<b>128714</b>	P2B-DL-115
	2	<b>128715</b>	P2B-DL-200
	50mm	<b>126607</b>	P2B-DL-50M
211	2	<b>128830</b>	P2B-DLM-200
	2-3/16	<b>128717</b>	P2B-DL-203
	55mm	<b>126608</b>	P2B-DL-55M
212	2-1/4	<b>128832</b>	P2B-DLM-204
	2-7/16	<b>128719</b>	P2B-DL-207
	60mm	<b>126609</b>	P2B-DL-60M
214	2-1/2	<b>128834</b>	P2B-DLM-208
	2-11/16	<b>128720</b>	P2B-DL-211
	70mm	<b>126610</b>	P2B-DL-70M
215	2-15/16	@	P2B-DL-215

@ Assembled to order

FEATURES/BENEFITS PAGE B4-2	HOW TO ORDER/ NOMENCLATURE PAGE B4-4	SELECTION PAGE B4-5	DIMENSIONS DL INSERTS PAGE B4-54
--------------------------------	--	------------------------	--

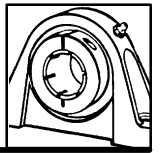

# SELECTION/DIMENSIONS

## D-LOK Ball Bearings

### DL NORMAL DUTY PILLOW BLOCKS

Series	Shaft Size	Weight lbs. kg.	A	B	C	D		F Bolt Dia.	G
						Min.	Max.		
209	1-5/8	6.8	2	7-1/2	2-1/8	5-7/16	6-1/16	1/2	7/8
	1-11/16	6.8							
	1-3/4	6.7							
	45mm	3.1							
210	1-15/16	8.5	2-3/32	8-1/8	2-3/8	6	6-1/2	5/8	15/16
	2	8.4	53.2	206.4	60.3				
	50mm	3.9							
211	2	12.2	2-1/4	8-5/8	2-3/8	6-3/8	7-1/4	5/8	1-1/8
	2-3/16	10.3	57.2	219.1	60.3	161.9	184.2	M16	28.6
	55mm	5.6							
212	2-1/4	17.5	2-5/8	9-1/2	2-3/4	6-7/8	7-7/8	5/8	1-3/16
	2-7/16	14.8	66.7	241.3	69.9	174.6	200.0	M16	30.2
	60mm	7.0							
214	2-1/2	19.4	2-13/16	11-1/4	2-7/8	7-1/2	8-7/8	3/4	1-1/2
	2-11/16	19.3	71.4	285.8	73.0	190.5	225.4	M18	38.1
	70mm	8.9							
215	2-15/16	24.9	2-21/64	11-3/4	2-7/8	8-1/2	9-1/2	7/8	1-7/16

Series	Shaft Size	H	J	L	M	R	S	U	V	W	X
209	1-5/8	11/16	4-1/4	3-1/16	2-1/8	3/4	1-1/4	3-3/8	6-3/4	11/16	3/16
	1-11/16	17.5	108.00	78.5	54.0	19.1	31.8	85.7	171.5	17.5	4.8
	1-3/4										
	45mm										
210	1-15/16	3/4	4-9/16	3-9/32	2-1/4	3/4	1-11/32	3-11/16	7-3/8	13/16	3/16
	2	19.1	115.9	83.3	57.2	19.1	34.1	93.7	187.3	20.6	4.8
	50mm										
211	2	13/16	5-1/16	3-11/16	2-1/2	7/8	1-3/8	3-15/16	7-7/8	13/16	3/16
	2-3/16	20.6	128.6	93.7	63.5	22.2	34.9	100.0	200.0	20.6	4.8
	55mm										
212	2-1/4	1	5-5/8	4-7/64	2-3/4	1	1-5/8	4-1/4	8-1/2	7/8	3/16
	2-7/16	25.4	142.9	104.4	69.9	25.4	41.3	108.0	215.9	22.2	4.8
	60mm										
214	2-1/2	1-1/16	6-1/4	4-3/8	3	1-1/16	1-3/4	4-7/8	9-3/4	15/16	3/16
	2-11/16	27.0	158.8	111.1	76.2	27.0	44.5	123.8	247.7	23.8	4.8
	70mm										
215	2-15/16	1	6-3/4	4-11/16	3-1/2	53/64	1-1/2	—	—	—	—

MODIFICATIONS PAGE B4-60			
-----------------------------	--	--	--

# SELECTION/DIMENSIONS

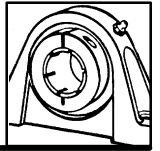

## D-LOK Ball Bearings

### DLAH NORMAL DUTY AIR HANDLING PILLOW BLOCKS

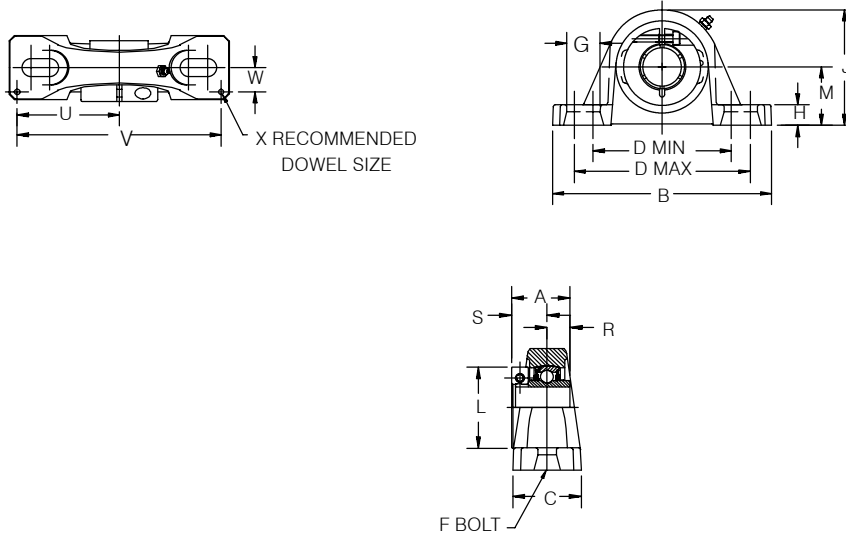

Series	Shaft Size	Part Number	Description
204	3/4 20mm	<b>128432</b> @	P2B-DLAH-012 P2B-DLAH-20M
205	7/8 15/16 1 25mm	@ @ <b>128435</b> @	P2B-DLAH-014 P2B-DLAH-015 P2B-DLAH-100 P2B-DLAH-25M
206	1-1/8 1-3/16 1-1/4 30mm	@ <b>128437</b> @ @	P2B-DLAH-102 P2B-DLAH-103 P2B-DLAH-104S P2B-DLAH-30M
207	1-1/4 1-3/8 1-7/16 35mm	@ <b>128440</b> <b>128441</b>	P2B-DLAH-104 P2B-DLAH-106 P2B-DLAH-107 P2B-DLAH-35M
208	1-1/2 40mm	@ @	P2B-DLAH-108 P2B-DLAH-40M

@ Assembled to order

FEATURES/BENEFITS PAGE B4-2	HOW TO ORDER/ NOMENCLATURE PAGE B4-4	SELECTION PAGE B4-5	DIMENSIONS DL INSERTS PAGE B4-54
--------------------------------	--	------------------------	--

# SELECTION/DIMENSIONS

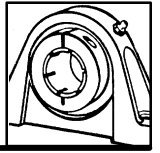

## D-LOK Ball Bearings

### DLAH AIR HANDLING NORMAL DUTY PILLOW BLOCKS

Series	Shaft Size	Weight lbs. kg.	A	B	C	D		F Bolt Dia.	G
						Min.	Max.		
204	3/4	2.1	1-9/32	5	1-1/2	3-3/8	4-1/8	3/8 M10	13/16 20.6
	20mm	1.0	32.5	127.0	38.1	85.7	104.8		
205	7/8	2.3	1-7/16	5-1/2	1-1/2	3-5/8	4-3/8	3/8 M10	13/16 20.6
	15/16	2.3							
	1	2.3							
206	25mm	1.1	36.5	139.7	38.1	92.1	111.1	1/2 M12	15/16 23.8
	1-1/8	3.8	1-9/16	6-1/2	1-7/8	4-7/16	5-3/16		
	1-3/16	3.7							
	1-1/4	3.7							
207	30mm	1.1	39.7	165.1	47.6	112.7	131.8	1/2 M12	7/8 22.2
	1-1/4	4.9	1-3/4	6-9/16	1-7/8	4-11/16	5-5/16		
	1-3/8	4.9							
	1-7/16	4.8							
208	35mm	2.2	44.5	166.7	47.6	119.1	134.9	1/2 M12	7/8 22.2
	40mm	6.0	2	7-1/4	2-1/8	5-1/4	5-7/8		
		2.7	50.8	184.2	54.0	133.4	149.2		

Series	Shaft Size	H	J	L	M	R	S	U	V	W	X
204	3/4	1/2	2-9/16	1-45/64	1-5/16	1/2	25/32	2-1/4	4-1/2	1/2	1/8
	20mm	12.7	65.1	43.3	33.3	12.7	19.8	57.2	114.3	12.7	3.2
205	7/8	5/8	2-13/16	2	1-7/16	9/16	7/8	2-1/2	5	1/2	1/8
	15/16										
	1	15.9	71.4	50.8	36.5	14.3	22.2	63.5	127.0	12.7	3.2
206	25mm										
	1-1/8	9/16	3-3/8	2-7/32	1-11/16	9/16	1	2-7/8	5-3/4	9/16	3/16
	1-3/16										
207	1-1/4	14.3	85.7	56.4	42.9	14.3	25.4	73.0	146.1	14.3	4.8
	1-3/8										
	1-7/16										
208	30mm										
	35mm	11/16	3-13/16	2-11/16	1-7/8	11/16	1-1/16	2-29/32	5-13/16	9/16	3/16
208	40mm	17.5	96.8	68.3	47.6	17.5	27.0	73.8	147.6	14.3	4.8
208	1-1/2	11/16	3-15/16	2-25/32	1-15/16	3/4	1-1/4	3-17/64	6-17/32	11/16	3/16
	40mm	17.5	100.0	70.6	49.2	19.1	31.8	82.9	165.9	17.5	4.8

MODIFICATIONS PAGE B4-60			
-----------------------------	--	--	--

# SELECTION/DIMENSIONS

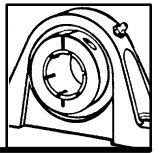

## D-LOK Ball Bearings

### DLAH NORMAL DUTY AIR HANDLING PILLOW BLOCKS

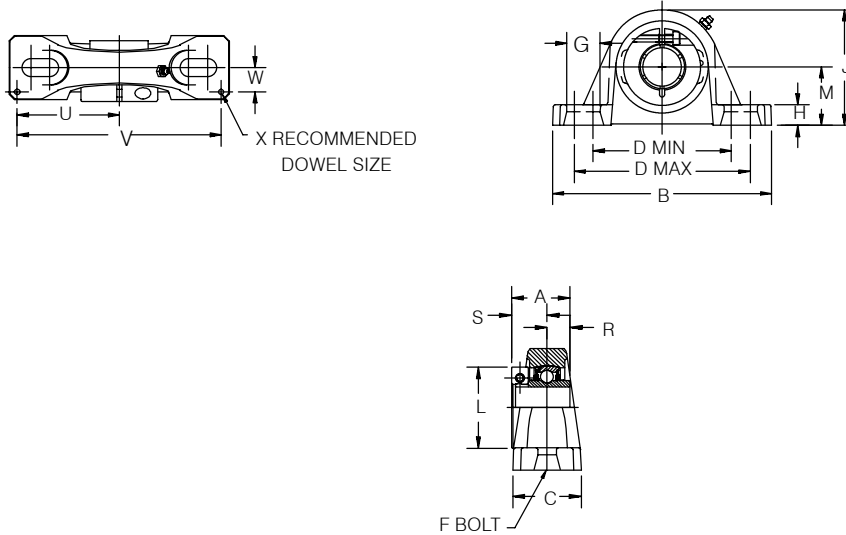

Series	Shaft Size	Part Number	Description
209	1-5/8	@	P2B-DLAH-110L
	1-11/16	<b>128444</b>	P2B-DLAH-111
	1-3/4	@	P2B-DLAH-112
	45mm	@	P2B-DLAH-45M
210	1-15/16	<b>128446</b>	P2B-DLAH-115
	2	@	P2B-DLAH-200
	50mm	@	P2B-DLAH-50M
211	2	@	P2B-DLMAH-200
	2-3/16	<b>128449</b>	P2B-DLAH-203
	55mm	@	P2B-DLAH-55M
212	2-1/4	@	P2B-DLMAH-204
	2-7/16	<b>128451</b>	P2B-DLAH-207
	60mm	@	P2B-DLAH-60M
214	2-1/2	@	P2B-DLMAH-208
	2-11/16	<b>128452</b>	P2B-DLAH-211
	70mm	@	P2B-DLAH-70M
215	2-15/16	@	P2B-DLAH215

@ Assembled to order

FEATURES/BENEFITS PAGE B4-2	HOW TO ORDER/ NOMENCLATURE PAGE B4-4	SELECTION PAGE B4-5	DIMENSIONS DL INSERTS PAGE B4-54
--------------------------------	--	------------------------	--

# SELECTION/DIMENSIONS

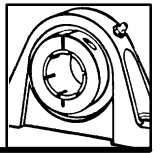

## D-LOK Ball Bearings

### DLAH AIR HANDLING NORMAL DUTY PILLOW BLOCKS

Series	Shaft Size	Weight lbs. kg.	A	B	C	D		F Bolt Dia.	G							
						Min.	Max.									
209	1-5/8	6.8	2	7-1/2	2-1/8	5-7/16	6-1/16	1/2	7/8							
	1-11/16	6.8														
	1-3/4	6.7														
	45mm	3.1								50.8	190.5	54.0	138.1	154.0	M12	22.2
210	1-15/16	8.5	2-3/32	8-1/8	2-3/8	6	6-1/2	5/8	15/16							
	2	8.4														
	50mm	3.9								53.2	206.4	60.3	152.4	165.1	M16	23.8
	2	12.2								2-1/4	8-5/8	2-3/8	6-3/8	7-1/4	5/8	1-1/8
2-3/16	10.3															
55mm	5.6	57.2	219.1	60.3	161.9	184.2	M16	28.6								
2-1/4	17.5	2-5/8	9-1/2	2-3/4	6-7/8	7-7/8	5/8	1-3/16								
2-7/16	14.8															
60mm	7.0								66.7	241.3	69.9	174.6	200.0	M16	30.2	
2-1/2	19.4								2-13/16	11-1/4	2-7/8	7-1/2	8-7/8	3/4	1-1/2	
2-11/16	19.3															
70mm	8.9	71.4	285.8	73.0	190.5	225.4	M18	38.1								
2-15/16	24.9	2-21/64	11-3/4	2-7/8	8-1/2	9-1/2	7/8	1-7/16								
2-15/16	24.9															

Series	Shaft Size	H	J	L	M	R	S	U	V	W	X
209	1-5/8	11/16	4-1/4	3-1/16	2-1/8	3/4	1-1/4	3-3/8	6-3/4	11/16	3/16
	1-11/16										
	1-3/4	17.5	108.0	78.5	54.0	19.1	31.8	85.7	171.5	17.5	4.8
	45mm										
210	1-15/16	3/4	4-9/16	3-9/32	2-1/4	3/4	1-11/32	3-11/16	7-3/8	13/16	3/16
	2										
	50mm	19.1	115.9	83.3	57.2	19.1	34.1	93.7	187.3	20.6	4.8
	2	13/16	5-1/16	3-11/16	2-1/2	7/8	1-3/8	3-15/16	7-7/8	13/16	3/16
211	2-3/16										
	55mm	20.6	128.6	93.7	63.5	22.2	34.9	100.0	200.0	20.6	4.8
	2-1/4	1	5-5/8	4-7/64	2-3/4	1	1-5/8	4-1/4	8-1/2	7/8	3/16
	2-7/16										
212	60mm	25.4	142.9	104.4	69.9	25.4	41.3	108.0	215.9	22.2	4.8
	2-1/2	1-1/16	6-1/4	4-3/8	3	1-1/16	1-3/4	4-7/8	9-3/4	15/16	3/16
	2-11/16										
	70mm	27.0	158.8	111.1	76.2	27.0	44.5	123.8	247.7	23.8	4.8
215	2-15/16	1	6-3/4	4-11/16	3-1/2	53/64	1-1/2	—	—	—	—

MODIFICATIONS PAGE B4-60			
-----------------------------	--	--	--

# SELECTION/DIMENSIONS

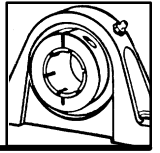

## D-LOK Ball Bearings

### DLB NORMAL DUTY PILLOW BLOCKS

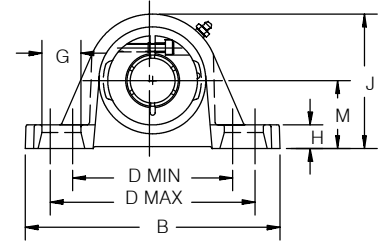
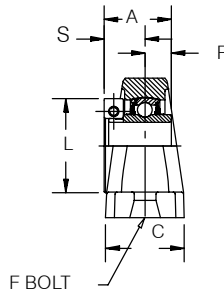
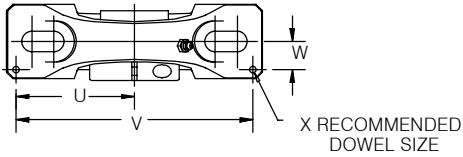

Series	Shaft Size	Part Number	Description
204	3/4 20mm	128721 @	P2B-DLB-012 P2B-DLB-20M
205	7/8 15/16 1 25mm	128722 128723 128724 @	P2B-DLB-014 P2B-DLB-015 P2B-DLB-100 P2B-DLB-25M
206	1-1/8 1-3/16 1-1/4 30mm	128725 128726 128727 @	P2B-DLB-102 P2B-DLB-103 P2B-DLB-104 SP2B-DLB-30M
207	1-1/4 1-3/8 1-7/16 35mm	128728 128729 128730 @	P2B-DLB-104 P2B-DLB-106 P2B-DLB-107 P2B-DLB-35M

@ Assembled to order

FEATURES/BENEFITS PAGE B4-2	HOW TO ORDER/ NOMENCLATURE PAGE B4-4	SELECTION PAGE B4-5	DIMENSIONS DL INSERTS PAGE B4-54
--------------------------------	--	------------------------	--



# SELECTION/DIMENSIONS

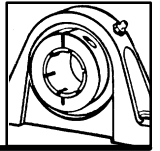

## D-LOK Ball Bearings

### DLB NORMAL DUTY PILLOW BLOCKS

Series	Shaft Size	Weight lbs. kg.	A	B	C	D		F Bolt Dia.	G	
						Min.	Max.			
204	3/4 20mm	2.1	1-9/32	5	1-1/2	3-3/8	4-1/8	3/8	13/16	
		1.0	32.5	127.0	38.1	85.7	104.8	M10	20.6	
205	7/8 15/16 1 25mm	2.3	1-7/16	5-1/2	1-1/2	3-5/8	4-3/8	3/8	13/16	
		2.3								
		2.3								
		1.1	36.5	139.7	38.1	92.1	111.1	M10	20.6	
206	1-1/8 1-3/16 1-1/4 30mm	3.8	1-9/16	6-1/2	1-7/8	4-7/16	5-3/16	1/2	15/16	
		3.7								
		3.7								
		1.7	39.7	165.1	47.6	112.7	131.8	M12	23.8	
207	1-1/4 1-3/8 1-7/16 35mm	4.9	1-3/4	6-9/16	1-7/8	4-11/16	5-5/16	1/2	7/8	
		4.9								
		4.8								
		2.2	44.5	166.7	47.6	119.1	134.9	M12	22.2	

Series	Shaft Size	H	J	L	M	R	S	U	V	W	X
204	3/4 20mm	7/16	2-1/2	1-45/64	1-1/4	1/2	25/32	2-1/4	4-1/2	1/2	1/8
		11.1	63.5	43.3	31.8	12.7	19.8	57.2	114.3	12.7	3.2
205	7/8 15/16 1 25mm	1/2	2-11/16	2	1-5/16	9/16	7/8	2-1/2	5	1/2	1/8
		12.7	68.3	50.8	33.3	14.3	22.2	63.5	127.0	12.7	3.2
206	1-1/8 1-3/16 1-1/4 30mm	7/16	3-1/4	2-7/32	1-9/16	9/16	1	2-7/8	5-3/4	9/16	3/16
		11.1	82.6	56.4	39.7	14.3	25.4	73.0	146.1	14.3	4.8
207	1-1/4 1-3/8 1-7/16 35mm	5/8	3-3/4	2-11/16	1-13/16	11/16	1-1/16	2-29/32	5-13/16	9/16	3/16
		15.9	95.3	68.3	46.0	17.5	27.0	73.8	147.6	14.3	4.8

MODIFICATIONS PAGE B4-60			
-----------------------------	--	--	--

# SELECTION/DIMENSIONS

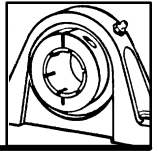

## D-LOK Ball Bearings

### DLB NORMAL DUTY PILLOW BLOCKS

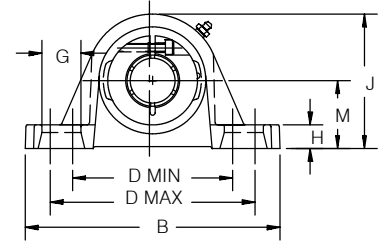
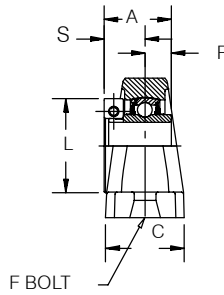
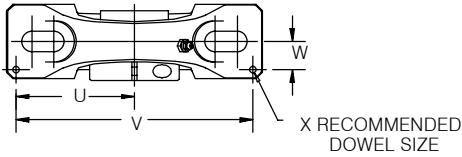

Series	Shaft Size	Part Number	Description
208	1-1/2	128710	P2B-DL-108
	40mm	126605	P2B-DLB-40M
209	1-5/8	128731	P2B-DLB-110L
	1-11/16	128732	P2B-DLB-111
	1-3/4	128733	P2B-DLB-112
	45mm	@	P2B-DLB-45M
210	1-15/16	128734	P2B-DLB-115
	2	128735	P2B-DLB-200
	50mm	@	P2B-DLB-50M
211	2	128736	P2B-DLB-200L
	2-3/16	127838	P2B-DLB-2032
	55mm	@	P2B-DLB-55M
212	2-1/4	128839	P2B-DLB-204L
	2-7/16	128741	P2B-DLB-207
	60mm	@	P2B-DLB-60M

@ Assembled to order

FEATURES/BENEFITS PAGE B4-2	HOW TO ORDER/ NOMENCLATURE PAGE B4-4	SELECTION PAGE B4-5	DIMENSIONS DL INSERTS PAGE B4-54
--------------------------------	--	------------------------	--

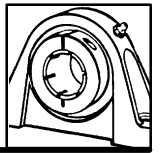

# SELECTION/DIMENSIONS

## D-LOK Ball Bearings

### DLB NORMAL DUTY PILLOW BLOCKS

Series	Shaft Size	Weight lbs. kg.	A	B	C	D		F Bolt Dia.	G
						Min.	Max.		
208	1-1/2 40mm	6.0	2	7-1/4	2-1/8	5-1/4	5-7/8	1/2	7/8
		2.7	50.8	184.2	54.0	133.4	149.2	M12	22.2
209	1-5/8 1-11/16 1-3/4 45mm	6.8	2	7-1/2	2-1/8	5-7/16	6-1/16	1/2	7/8
		6.8							
		6.7	50.8	190.5	54.0	138.1	154.0	M12	22.2
		3.1							
210	1-15/16 2 50mm	8.5	2-3/32	8-1/8	2-3/8	6	6-1/2	5/8	15/16
		8.4							
		3.9	53.2	206.4	60.3	152.4	165.1	M16	23.8
211	2 2-3/16 55mm	12.2	2-1/4	8-5/8	2-3/8	6-3/8	7-1/4	5/8	1-1/8
		10.3							
		5.6	57.2	219.1	60.3	161.9	184.2	M16	28.6
212	2-1/4 2-7/16 60mm	17.5	2-5/8	9-1/2	2-3/4	6-7/8	7-7/8	5/8	1-3/16
		14.8							
		7.0	66.7	241.3	69.9	174.6	200.0	M16	30.2

Series	Shaft Size	H	J	L	M	R	S	U	V	W	X
208	1-1/2 40mm	11/16	3-15/16	2-25/32	1-15/16	3/4	1-1/4	3-17/64	6-17/32	11/16	3/16
		17.5	100.0	70.6	49.2	19.1	31.8	82.9	165.9	17.5	4.8
209	1-5/8 1-11/16 1-3/4 45mm	5/8	4-3/16	3-1/16	2-1/16	3/4	1-1/4	3-3/8	6-3/4	11/16	3/16
		15.9	106.4	78.5	52.4	19.1	31.8	85.7	171.5	17.5	4.8
210	1-15/16 2 50mm	11/16	4-1/2	3-9/32	2-3/16	3/4	1-11/32	3-11/16	7-3/8	13/16	3/16
		17.5	114.3	83.3	55.6	19.1	34.1	93.7	187.3	20.6	4.8
211	2 2-3/16 55mm	3/4	5	3-11/16	2-7/16	7/8	1-3/8	3-15/16	7-7/8	13/16	3/16
		20.6	128.6	93.7	63.5	22.2	34.9	100.0	200.0	20.6	4.8
212	2-1/4 2-7/16 60mm	15/16	5-9/16	4-7/64	2-11/16	1	1-5/8	4-1/4	8-1/2	7/8	3/16
		23.8	141.3	104.4	68.3	25.4	41.3	108.0	215.9	22.2	4.8

MODIFICATIONS PAGE B4-60			
-----------------------------	--	--	--

# SELECTION/DIMENSIONS

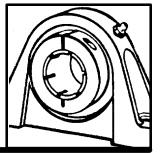

## D-LOK Ball Bearings

### DLH D-LOK NORMAL DUTY PILLOW BLOCKS

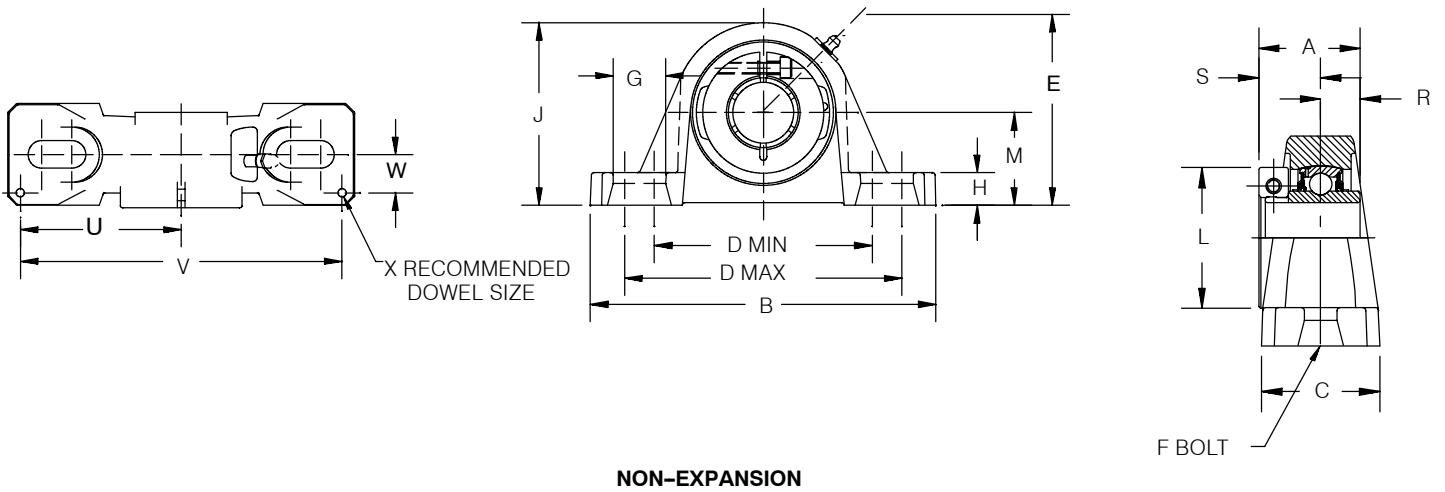
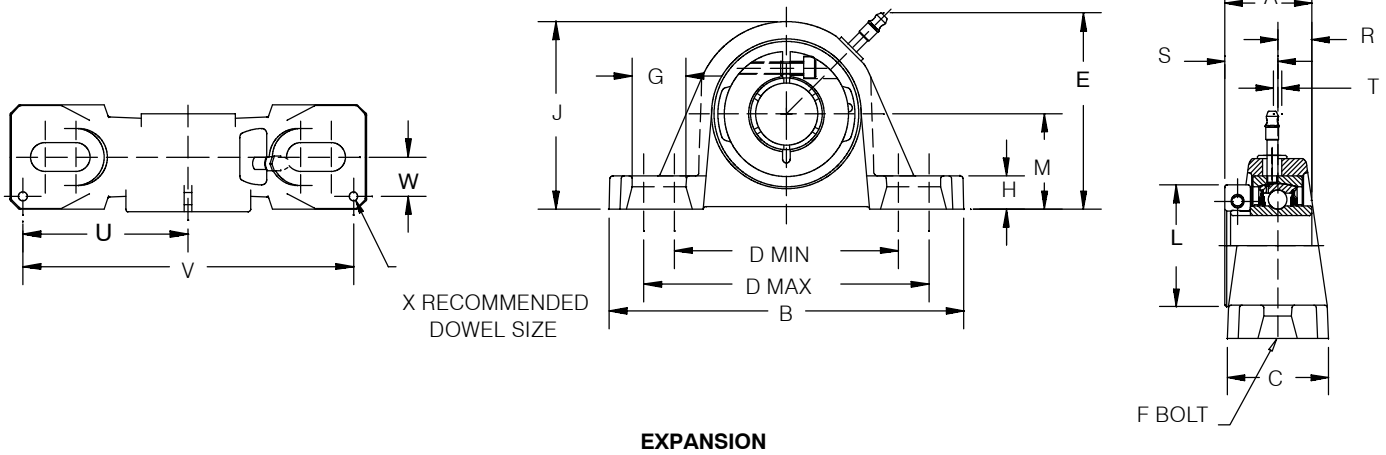

FEATURES/BENEFITS PAGE B4-2	HOW TO ORDER/ NOMENCLATURE PAGE B4-4	SELECTION PAGE B4-5	/
--------------------------------	--	------------------------	---

# SELECTION/DIMENSIONS

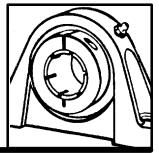

## D-LOK Ball Bearings

### DLH-E EXPANSION AND DLH NON-EXPANSION NORMAL DUTY PILLOW BLOCKS

Series	Shaft Size	Part No.	Expansion Description	Part No.	Non-Expansion Description	Part No.	Alternative Non-Exp. Description
206	1	@	P2B-DLMH-100-E	@	P2B-DLMH-100	@	---
	1-1/8	@	P2B-DLH-102-E	@	P2B-DLH-102	@	---
	1-3/16	<b>126450</b>	P2B-DLH-103-E	<b>126445</b>	P2B-DLH-103	<b>128824</b>	P2B-DLM-103
	1-1/4	@	P2B-DLH-104S-E	@	P2B-DLH-104S	<b>128707</b>	P2B-DL-104
	30mm	@	P2B-DLH-30M-E	@	P2B-DLH-30M	@	---
207	1-3/16	@	P2B-DLMH-103-E	@	P2B-DLMH-103	@	---
	1-1/4	@	P2B-DLH-104-E	@	P2B-DLH-104	@	---
	1-3/8	@	P2B-DLH-106-E	@	P2B-DLH-106	@	---
	1-7/16	<b>126451</b>	P2B-DLH-107-E	<b>126446</b>	P2B-DLH-107	<b>128825</b>	P2B-DLM-107
	35mm	@	P2B-DLH-35M-E	@	P2B-DLH-35M	<b>126639</b>	P2B-DLM-35M
209	1-1/2	@	P2B-DLMH-108-E	@	P2B-DLMH-108	@	---
	1-5/8	@	P2B-DLH-108L-E	@	P2B-DLH-108L	@	---
	1-11/16	@	P2B-DLH-111-E	@	P2B-DLH-111	<b>128827</b>	P2B-DLM-111
	1-3/4	@	P2B-DLH-112-E	@	P2B-DLH-112	<b>128828</b>	P2B-DLM-112
	45mm	@	P2B-DLH-45M-E	@	P2B-DLH-45M	@	---

@ Assembled to order

Series	Shaft Size	Weight lbs. kg.	A	B	C	D		F Bolt Dia.	G	H
						Min.	Max.			
206	1	5.0	1-9/16	6-9/16	1-7/8	411/16	5-5/16	1/2	7/8	11/16
	1-1/8	5.0								
	1-3/16	5.0								
	1-1/4	5.0								
	30mm	1.5	39.7	166.7	47.6	119.1	134.9	M12	22.2	17.5
207	1-3/16	6.9	1-3/4	7-1/4	2-1/8	5-1/4	5-7/8	1/2	7/8	11/16
	1-1/4	6.9								
	1-3/8	6.9								
	1-7/16	6.9								
	35mm	2.1	44.5	184.2	54.0	133.4	149.2	M12	22.2	17.5
209	1-1/2	9.2	2	8-1/8	2-3/8	6	6-1/2	5/8	15/16	3/4
	1-5/8	9.2								
	1-11/16	9.2								
	1-3/4	9.2								
	45mm	2.8	50.8	206.4	60.3	152.4	165.1	M12	23.8	19.1

Series	Shaft Size	J	L	M	R	S	T Total Expansion	U	V	W	X
206	1	3-13/16	2-7/32	1-7/8	9/16	1	3/16	2-29/32	5-13/16	9/16	3/16
	1-1/8										
	1-3/16										
	1-1/4										
	30mm	96.8	56.4	47.6	14.3	25.4	4.8	73.8	147.6	14.3	4.8
207	1-3/16	3-15/16	2-11/16	1-15/16	11/16	1-1/16	3/16	3-17/64	6-17/32	11/16	3/16
	1-1/4										
	1-3/8										
	1-7/16										
	35mm	100.0	68.3	49.2	17.5	27.0	4.8	82.9	165.9	17.5	4.8
209	1-1/2	4-9/16	3-1/16	2-1/4	3/4	1-1/4	1/4	3-11/16	7-3/8	13/16	3/16
	1-5/8										
	1-11/16										
	1-3/4										
	45mm	115.9	77.8	57.2	19.1	31.8	6.4	93.7	187.3	20.6	4.8

MODIFICATIONS PAGE B4-60			
-----------------------------	--	--	--

# SELECTION/DIMENSIONS

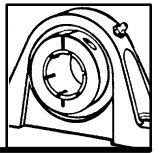

## D-LOK Ball Bearings

### DLH D-LOK NORMAL DUTY PILLOW BLOCKS

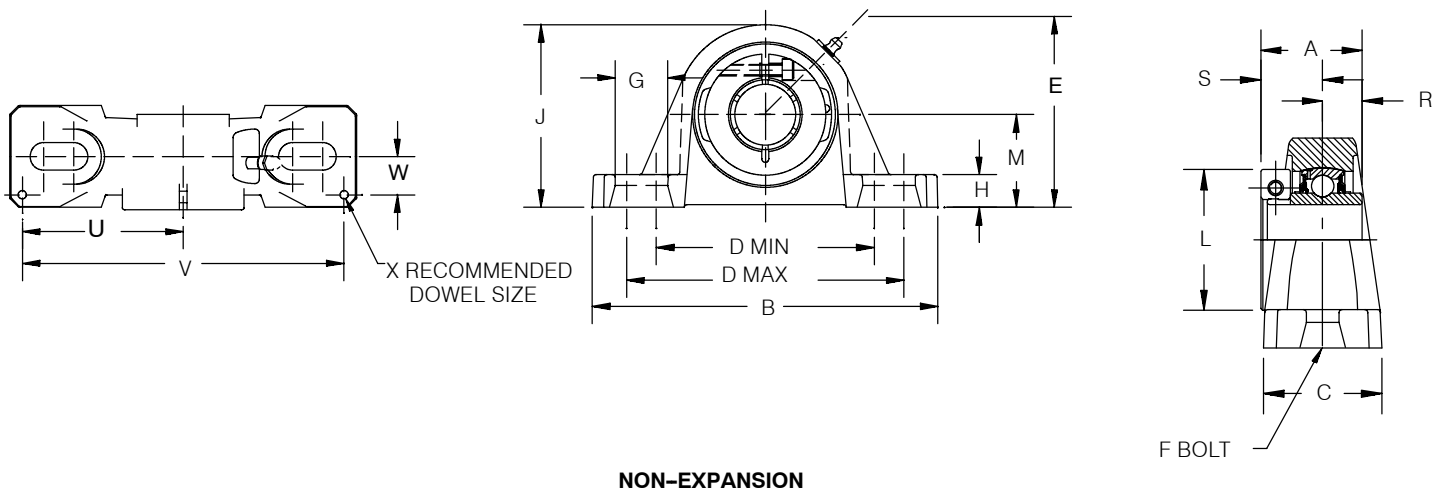
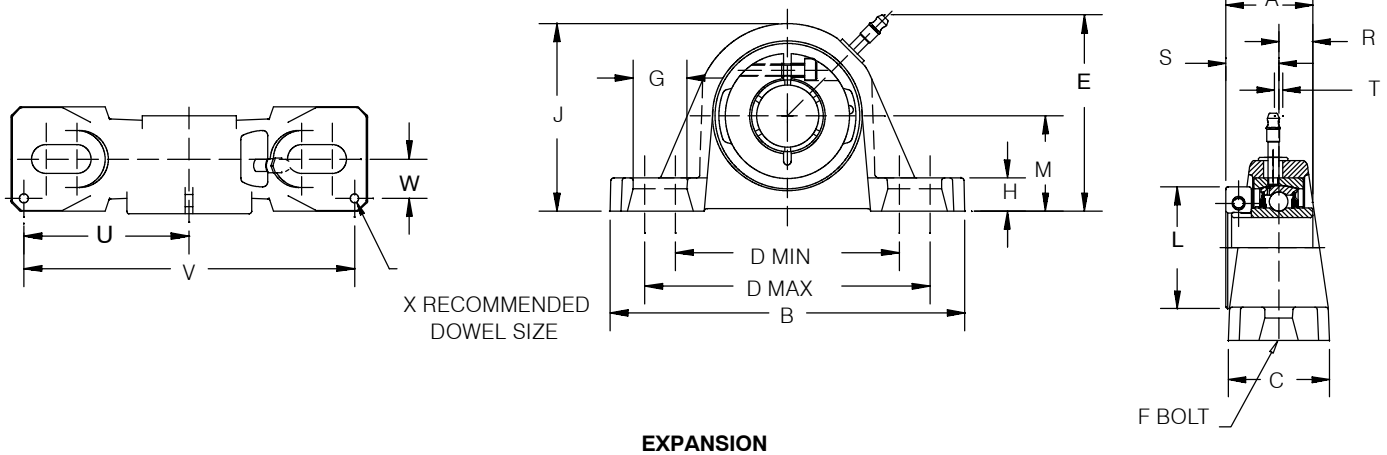

FEATURES/BENEFITS PAGE B4-2	HOW TO ORDER/ NOMENCLATURE PAGE B4-4	SELECTION PAGE B4-5	/
--------------------------------	--	------------------------	---

# SELECTION/DIMENSIONS

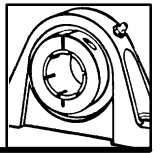

## D-LOK Ball Bearings

### DLH-E EXPANSION AND DLH NON-EXPANSION NORMAL DUTY PILLOW BLOCKS

Series	Shaft Size	Part No.	Expansion Description	Part No.	Non-Expansion Description	Part No.	Alternative Non-Exp. Description
210	1-11/16	@	P2B-DLMH-111-E	@	P2B-DLMH-111	@	---
	1-3/4	@	P2B-DLMH-112-E	@	P2B-DLMH-112	@	---
	1-15/16	<b>126452</b>	P2B-DLH-115-E	<b>126447</b>	P2B-DLH-115	<b>128829</b>	P2B-DLM-115
	2	@	P2B-DLH-200-E	@	P2B-DLH-200	<b>128830</b>	P2B-DLM-200
	50mm	@	P2B-DLH-50M-E	@	P2B-DLH-50M	@	---
211	1-15/16	<b>052625</b>	P2B-DLMH-115-E	<b>052624</b>	P2B-DLMH-115	@	---
	2	@	P2B-DLMH-200-E	@	P2B-DLMH-200	@	---
	2-3/16	<b>126453</b>	P2B-DLH-203-E	<b>126448</b>	P2B-DLH-203	<b>128831</b>	P2B-DLM-203
	55mm	@	P2B-DLH-55M-E	@	P2B-DLH-55M	@	---
212	2-3/16	@	P2B-DLMH-203-E	@	P2B-DLMH-203	@	---
	2-1/4	@	P2B-DLMH-204-E	@	P2B-DLMH-204	@	---
	2-7/16	<b>126454</b>	P2B-DLH-207-E	<b>126449</b>	P2B-DLH-207	<b>128833</b>	P2B-DLM-207
	60mm	@	P2B-DLH-60M-E	@	P2B-DLH60M	@	---

@ Assembled to order

Series	Shaft Size	Weight lbs. kg.	A	B	C	D		F Bolt Dia.	G	H	J
						Min.	Max.				
210	1-11/16	10.8	2-3/32	8-5/8	2-3/8	6-3/8	7-1/4	5/8	1-1/8	13/16	5-1/16
	1-3/4	10.8									
	1-15/16	10.8									
	2	10.8									
	50mm	3.3	53.2	219.1	60.3	161.9	184.2	M16	28.6	20.6	128.6
211	1-15/16	15.7	2-1/4	9-1/2	2-3/4	6-7/8	7-7/8	5/8	1-3/16	1	5-5/8
	2	15.7									
	2-3/16	15.7									
	55mm	4.8	57.2	241.3	69.9	174.6	200.0	M16	30.2	25.4	142.9
212	2-3/16	20.1	2-5/8	11-1/4	2-7/8	7-1/2	8-7/8	3/4	1-1/2	1-1/16	6-1/4
	2-1/4	2.01									
	2-7/16	2.01									
	65mm	6.1	66.7	285.8	73.0	190.5	225.4	M16	38.1	27.0	158.8

Series	Shaft Size	L	M	R	S	T Total Expansion	U	V	W	X
210	1-11/16	3-9/32	2-1/2	3/4	1-11/32	1/4	3-15/16	7-7/8	13/16	3/16
	1-3/4									
	1-15/16									
	50mm	83.3	63.5	19.1	34.1	6.4	100.0	200.0	20.6	4.8
211	1-15/16	3-11/16	2-3/4	7/8	1-3/8	1/4	4-1/4	8-1/2	7/8	3/16
	2									
	55mm	93.7	69.9	22.2	34.9	6.4	108.0	215.9	22.2	4.8
212	2-3/16	4-7/64	3	1	1-5/8	1/4	4-7/8	9-3/4	15/16	3/16
	2-1/4									
	65mm	104.4	76.2	25.4	41.3	6.4	123.8	247.7	23.8	4.8

MODIFICATIONS PAGE B4-60			
-----------------------------	--	--	--

# SELECTION/DIMENSIONS

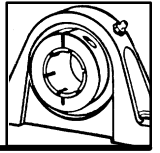

## D-LOK Ball Bearings

### DLM MEDIUM DUTY PILLOW BLOCKS

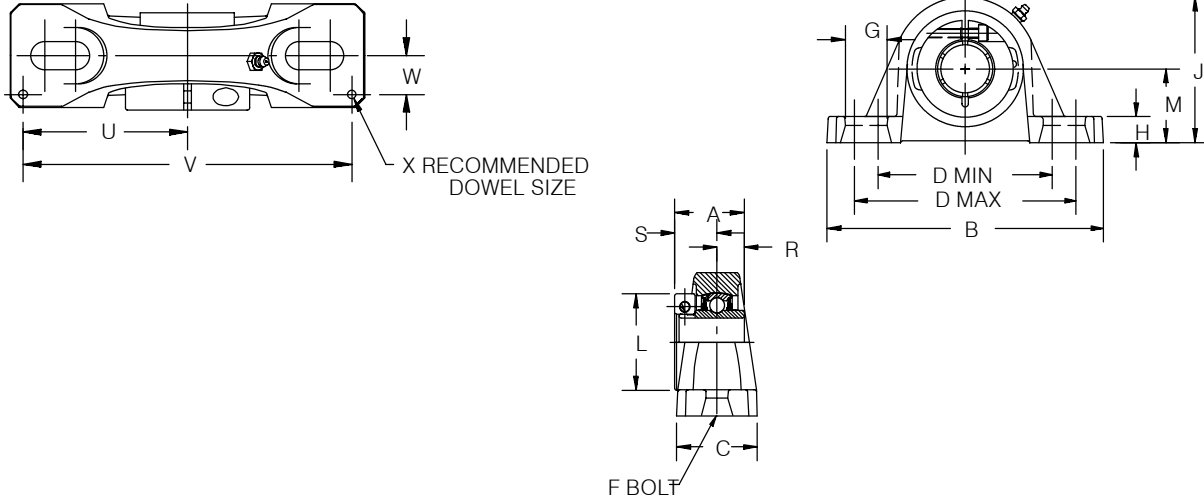

Series	Shaft Size	Part Number	Description
206	1	128823	P2B-DLM-100
207	1-3/16 1-1/4	128824 128707	P2B-DLM-103 P2B-DL-104
208	1-7/16 35mm	128825 126639	P2B-DLM-107 P2B-DLM-35M
209	1-1/2 1-5/8	128826 128711	P2B-DLM-108 P2B-DLM-110L
210	1-11/16 1-3/4	128827 128828	P2B-DLM-111 P2B-DLM-112
211	1-15/16 2	128829 128830	P2B-DLM-115 P2B-DLM-200
212	2-3/16 2-1/4	128831 128832	P2B-DLM-203 P2B-DLM-204
214	2-7/16 2-1/2 65mm	128833 128834 126640	P2B-DLM-207 P2B-DLM-208 P2B-DLM-65M
215	2-11/16	128696	P2B-DLM-211
216	2-15/16	128697	P2B-DLM-215
218	3-7/16	128698	P2B-DLM-307

FEATURES/BENEFITS PAGE B4-2	HOW TO ORDER/ NOMENCLATURE PAGE B4-4	SELECTION PAGE B4-5	DIMENSIONS DLM INSERTS PAGE B4-58
--------------------------------	--	------------------------	---



# SELECTION/DIMENSIONS

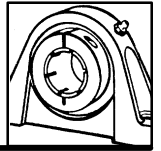

## D-LOK Ball Bearings

### DLM MEDIUM DUTY PILLOW BLOCKS

Series	Shaft Size	Weight lbs. kg.	A	B	C	D		F Bolt Dia.	G	H
						Min.	Max.			
206	1	4.2	1-9/16	6-1/2	1-7/8	4-7/16	5-3/16	1/2	15/16	9/16
207	1-3/16 1-1/4	5.6 4.9	1-3/4	6-9/16	1-7/8	4-11/16	5-5/16	1/2	7/8	11/16
208	1-7/16 35mm	7.2 3.2	2 50.8	7-1/4 184.2	2-1/8 54.0	5-1/4 133.4	5-7/8 149.2	1/2 M12	7/8 22.2	11/16 17.5
209	1-1/2 1-5/8	9.2 6.8	2	7-1/2	2-1/8	5-7/16	6-1/16	1/2	7/8	11/16
210	1-11/16 1-3/4	10.1 10.1	2-3/32	8-1/8	2-3/8	6	6-1/2	5/8	15/16	3/4
211	1-15/16 2	12.3 12.2	2-1/4	8-5/8	2-3/8	6-3/8	7-1/4	5/8	1-1/8	13/16
212	2-3/16 2-1/4	17.5 17.5	2-5/8	9-1/2	2-3/4	6-7/8	7-7/8	5/8	1-3/16	1
214	2-7/16 2-1/2 65mm	19.4 19.4 6.9	2-13/16 71.4	11-1/4 285.8	2-7/8 73.0	7-1/2 190.5	8-7/8 225.4	3/4 M18	1-1/2 38.1	1-1/16 27.0
215	2-11/16	24.9	2-21/64	11-3/4	2-7/8	8-1/2	9-1/2	7/8	1-7/16	1
216	2-15/16	25.4	2-31/64	11-3/4	3	8-1/2	9-1/2	7/8	1-7/16	1-1/4
218	3-7/16	34.9	2-21/32	14	3-3/8	10-5/16	11-5/8	7/8	1-19/32	1-5/16

Series	Shaft Size	J	L	M	R	S	U	V	W	X
206	1	3-3/8	2-7/32	1-11/16	9/16	1	2-7/8	5-3/4	9/16	3/16
207	1-3/16 1-1/4	3-13/16	2-11/16	1-7/8	11/16	1-1/16	2-29/32	5-13/16	9/16	3/16
208	1-7/16 35mm	3-15/16 100.0	2-25/32 70.6	1-15/16 49.2	3/4 19.1	1-1/4 31.8	3-17/64 82.9	6-17/32 165.9	11/16 17.5	3/16 4.8
209	1-1/2 1-5/8	4-1/4	3-1/16	2-1/8	3/4	1-1/4	3-3/8	6-3/4	11/16	3/16
210	1-11/16 1-3/4	4-9/16	3-9/32	2-1/4	3/4	1-11/32	3-11/16	7-3/8	13/16	3/16
211	1-15/16 2	5-1/16	3-11/16	2-1/2	7/8	1-3/8	3-15/16	7-7/8	13/16	3/16
212	2-3/16 2-1/4	5-5/8	4-7/64	2-3/4	1	1-5/8	4-1/4	8-1/2	7/8	3/16
214	2-7/16 2-1/2 65mm	6-1/4 158.8	4-3/8 111.1	3 76.2	1-1/16 27.0	1-3/4 44.5	4-7/8 123.8	9-3/4 247.7	15/16 23.8	3/16 4.8
215	2-11/16	6-3/4	4-11/16	3-1/2	13/16	1-33/64	—	—	—	—
216	2-15/16	6-31/32	5	3-1/2	27/32	1-43/64	—	—	—	—
218	3-7/16	8	5-1/2	4	59/64	1-47/64	—	—	—	—

MODIFICATIONS PAGE B4-60			
-----------------------------	--	--	--

# SELECTION/DIMENSIONS

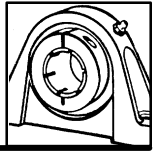

## D-LOK Ball Bearings

### DLMAH MEDIUM DUTY AIR HANDLING PILLOW BLOCKS

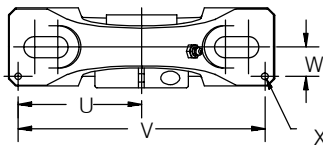

X RECOMMENDED  
DOWEL SIZE

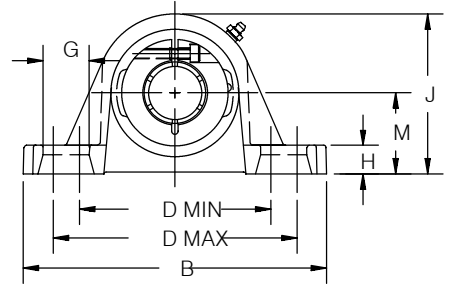
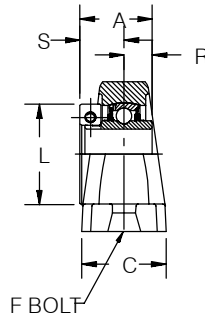

Series	Shaft Size	Part Number	Description
206	1	128474	P2B-DLMAH-100
207	1-3/16 1-1/4	128475 @	P2B-DLMAH-103 P2B-DLAH-104
208	1-7/16	128476	P2B-DLMAH-107
209	1-1/2 1-5/8	128477 @	P2B-DLMAH-108 P2B-DLAH-110L
210	1-11/16 1-3/4	128478 128479	P2B-DLMAH-111 P2B-DLMAH-112
211	1-15/16 2	128480 128481	P2B-DLMAH-115 P2B-DLMAH-200
212	2-3/16 2-1/4	128482 128483	P2B-DLMAH-203 P2B-DLMAH-204
214	2-7/16 2-1/2	128484 128485	P2B-DLMAH-207 P2B-DLMAH-208
215	2-11/16	128488	P2B-DLMAH-211
216	2-15/16	128489	P2B-DLMAH-215
218	3-7/16	128490	P2B-DLMAH-307

@ Assembled to order

FEATURES/BENEFITS PAGE B4-2	HOW TO ORDER/ NOMENCLATURE PAGE B4-4	SELECTION PAGE B4-5	MODIFICATIONS PAGE B4-60
--------------------------------	--	------------------------	-----------------------------

# SELECTION/DIMENSIONS

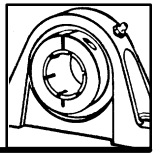

## D-LOK Ball Bearings

### DLMAH MEDIUM DUTY AIR HANDLING PILLOW BLOCKS

Series	Shaft Size	Weight lbs. kg.	A	B	C	D		F Bolt Dia.	G	H
						Min.	Max.			
206	1	4.2	1-9/16	6-1/2	1-7/8	4-7/16	5-3/16	1/2	15/16	5/8
207	1-3/16 1-1/4	5.6 4.9	1-3/4	6-9/16	1-7/8	4-11/16	5-5/16	1/2	7/8	11/16
208	1-7/16	7.2	2	7-1/4	2-1/8	5-1/4	5-7/8	1/2	7/8	5/8
209	1-1/2 1-5/8	9.2 6.8	2	7-1/2	2-1/8	5-7/16	6-1/16	1/2	7/8	5/8
210	1-11/16 1-3/4	10.1 10.1	2-3/32	8-1/8	2-3/8	6	6-1/2	5/8	15/16	13/16
211	1-15/16 2	12.3 12.2	2-1/4	8-5/8	2-3/8	6-3/8	7-1/4	5/8	1-1/8	13/16
212	2-3/16 2-1/4	17.5 17.5	2-5/8	9-1/2	2-3/4	6-7/8	7-7/8	5/8	1-3/16	1
214	2-7/16 2-1/2	19.4 19.4	2-13/16	11-1/4	2-7/8	7-1/2	8-7/8	3/4	1-1/2	1-1/16
215	2-11/16	24.9	2-21/64	11-3/4	2-7/8	8-1/2	9-1/2	7/8	1-7/16	1
216	2-15/16	25.4	2-31/64	11-3/4	3	8-1/2	9-1/2	7/8	1-7/16	1-1/4
218	3-7/16	34.9	2-21/32	14	3-3/8	10-5/16	11-5/8	7/8	1-19/32	1-5/16

Series	Shaft Size	J	L	M	R	S	U	V	W	X
206	1	3-7/16	2-7/32	1-3/4	5/8	15/16	2-7/8	5-3/4	9/16	3/16
207	1-3/16	3-13/16	2-11/16	1-7/8	11/16	1-1/16	2-29/32	5-13/16	9/16	3/16
208	1-7/16	4-1/8	2-25/32	2-1/8	3/4	1-1/4	3-17/64	6-17/32	11/16	3/16
209	1-1/2	4-7/16	3-1/16	2-5/16	3/4	1-1/4	3-3/8	6-3/4	11/16	3/16
210	1-11/16 1-3/4	4-5/8	3-9/32	2-5/16	3/4	1-11/32	3-11/16	7-3/8	13/16	3/16
211	1-15/16 2	5-1/16	3-11/16	2-1/2	7/8	1-3/8	3-15/16	7-7/8	13/16	3/16
212	2-3/16 2-1/4	5-5/8	4-7/64	2-3/4	1	1-5/8	4-1/4	8-1/2	7/8	3/16
214	2-7/16 2-1/2	6-1/4	4-3/8	3	1-1/16	1-3/4	4-7/8	9-3/4	15/16	3/16
215	2-11/16	6-3/4	4-11/16	3-1/2	13/16	1-33/64	—	—	—	—
216	2-15/16	6-31/32	5	3-1/2	27/32	1-33/64	—	—	—	—
218	3-7/16	8	5-1/2	4	59/64	1-47/64	—	—	—	—

MODIFICATIONS  
PAGE B4-60

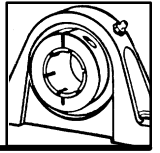

## SELECTION/DIMENSIONS

### D-LOK Ball Bearings

#### DL NORMAL DUTY TAPPED BASE PILLOW BLOCKS

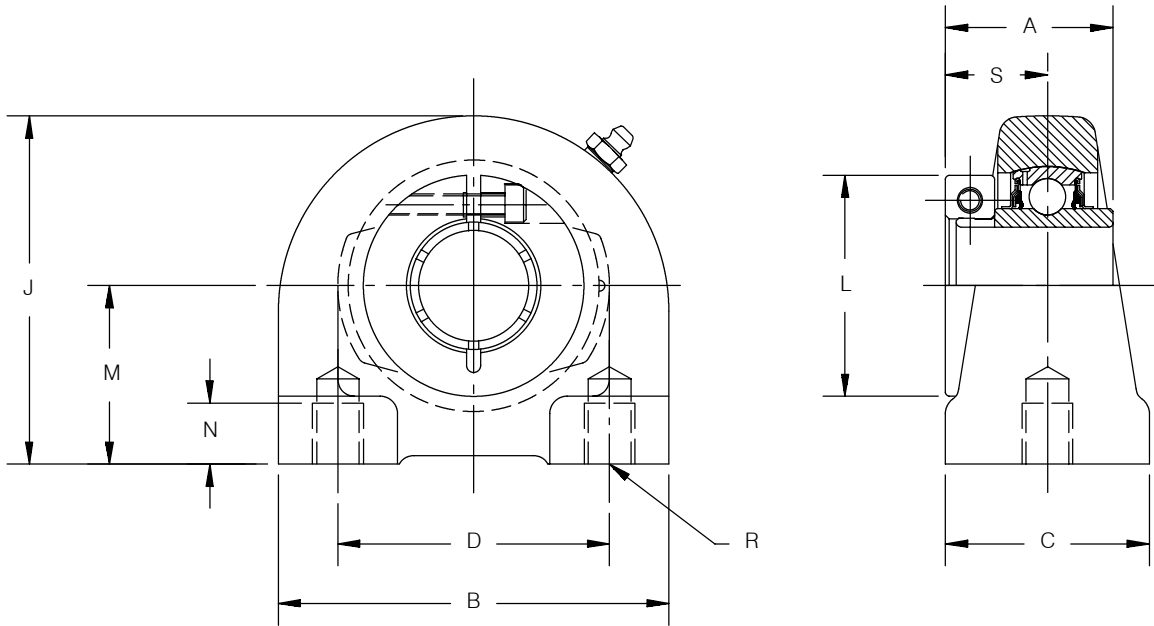

Series	Shaft Size	Part Number	Description	Weight lbs	A	B	C	D	J	L	M	N Min Tap Depth	R Bolt Holes UNC-Threads	S
204	3/4	128742	TB-DL-012	1.9	1-9/32	2-7/8	1-1/2	2	2-9/16	1-45/64	1-5/16	1/2	3/8 - 16	25/32
205	7/8 15/16 1	053011	TB-DL-014	2.1	1-7/16	3	1-1/2	2	2-13/16	2	1-7/16	1/2	3/6 - 16	7/8
		128743	TB-DL-015	2.0										
		128744	TB-DL-100	1.9										
206	1-1/8 1-3/16 1-1/4	128745	TB-DL-102	3.6	1-9/16	4	1-1/2	3	3-3/8	2-7/32	1-11/16	5/8	7/16-14	15/16
		128746	TB-DL-103	3.5										
		128747	TB-DL-104S	3.5										
207	1-1/4 1-3/8 1-7/16	128748	TB-DL-104	4.7	1-3/4	4-1/4	1-7/8	3-1/4	3-3/4	2-11/16	1-7/8	3/4	1/2 - 13	1-1/16
		128749	TB-DL-106	4.7										
		128750	TB-DL-107	4.6										
208	1-1/2	128751	TB-DL-108	6.2	2	4-5/8	1-7/8	3-1/2	3-15/16	2-47/64	1-15/16	3/4	1/2 - 13	1-1/4
209	1-5/8 1-11/16 1-3/4	128752	TB-DL-110L	6.7	2	5	2	3-3/4	4-1/4	2-62/64	2-1/8	3/4	1/2-13	1-1/4
		128753	TB-DL-111	6.7										
		128754	TB-DL-112	6.6										
210	1-15/16 2	128755	TB-DL-115	8.6	2-3/32	5-1/2	2	4	4-5/8	3-15/64	2-1/4	7/8	5/8-11	1-11/32
		128756	TB-DL-200	8.5										

FEATURES/BENEFITS PAGE B4-2	HOW TO ORDER/ NOMENCLATURE PAGE B4-4	SELECTION PAGE B4-5	DIMENSIONS DL INSERTS PAGE B4-54
--------------------------------	--	------------------------	--

# SELECTION/DIMENSIONS

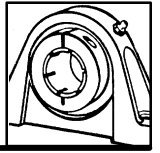

## D-LOK Ball Bearings

### DL NORMAL DUTY 2-BOLT FLANGE BEARINGS

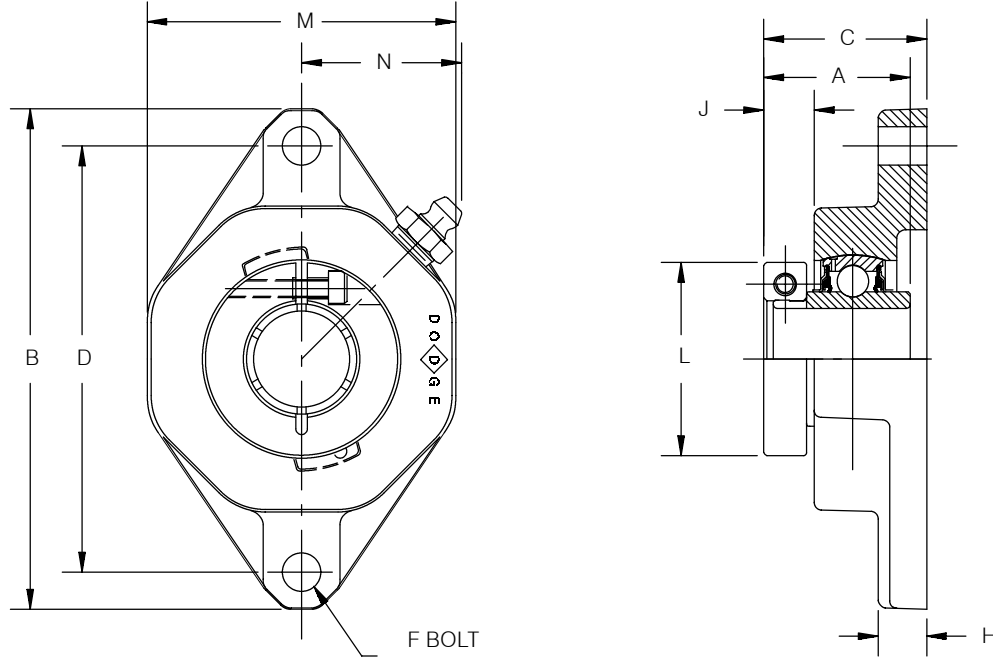

Series	Shaft Size	Part Number	Description	Weight lbs. kg.	A	B	C	D	F Bolt Dia.	H	J	L	M	N
204	3/4	<b>128757</b>	F2B-DL-012	1.4	1-9/32	4-27/64	1-11/32	3-17/32	3/8	13/32	3/8	1-45/64	2-3/8	1-3/8
	20mm	<b>126611</b>	F2B-DL-20M	0.6	32.5	112.3	34.1	89.7	M10	10.3	9.5	43.3	60.3	34.9
205	7/8	<b>128758</b>	F2B-DL-014	1.8	1-7/16	4-7/8	1-1/2	3-57/64	7/16	15/32	15/32	2	2-3/4	1-9/16
	15/16	<b>128759</b>	F2B-DL-015	1.8										
	1	<b>128760</b>	F2B-DL-100	1.8										
	25mm	<b>126612</b>	F2B-DL-25M	0.8	36.5	123.8	38.1	98.8	M10	11.9	11.9	50.8	69.9	39.7
206	1-1/8	<b>128761</b>	F2B-DL-102	2.4	1-9/16	5-9/16	1-5/8	4-19/32	7/16	17/32	31/64	2-7/32	3-1/4	1-3/4
	1-3/16	<b>128762</b>	F2B-DL-103	2.4										
	1-1/4	<b>128763</b>	F2B-DL-104S	2.3										
	30mm	<b>126613</b>	F2B-DL-30M	1.1	39.7	141.3	41.3	116.7	M10	13.5	12.3	56.4	82.6	44.5
207	1-1/4	<b>128764</b>	F2B-DL-104	3.5	1-3/4	6-1/8	1-13/16	5-1/8	1/2	35/64	9/16	2-11/16	3-3/4	1-57/64
	1-3/8	<b>128765</b>	F2B-DL-106	3.5										
	1-7/16	<b>128766</b>	F2B-DL-107	3.4										
	35mm	<b>126614</b>	F2B-DL-35M	1.6	44.5	155.6	46.0	130.2	M12	13.9	14.3	68.3	95.3	48.0
208	1-1/2	<b>128767</b>	F2B-DL-108	4.8	2	6-3/4	2-5/64	5-21/3	1/2	17/32	21/32	2-25/32	4-1/8	1-7/8
	40mm	<b>126615</b>	F2B-DL-40M	2.2	50.8	171.5	71.0	143.72	M12	13.5	16.7	70.6	104.8	47.6
209	1-5/8	<b>128768</b>	F2B-DL-110L	5.2	2	7-1/16	2-7/64	5-27/32	9/16	9/16	21/32	3-1/16	4-3/8	1-31/32
	1-11/16	<b>128769</b>	F2B-DL-111	5.2										
	1-3/4	<b>128770</b>	F2B-DL-112	5.2										
	45mm	<b>126616</b>	F2B-DL-45M	2.4	50.8	179.4	53.6	148.4	M16	14.3	16.7	78.5	111.1	50.0
210	1-15/16	<b>128771</b>	F2B-DL-115	6.0	2-3/32	7-7/16	2-7/32	6-3/16	9/16	35/64	11/16	3-9/32	4-9/16	2-1/32
	2	<b>128772</b>	F2B-DL-200	5.9										
	50mm	<b>126617</b>	F2B-DL-50M	2.7	53.2	188.9	56.4	157.2	M16	13.9	17.5	83.3	115.9	51.6
211	2	<b>128842</b>	F2B-DLM-200	9.1	2-1/4	8-1/2	2-3/8	7-1/4	5/8	19/32	11/16	3-11/16	5-1/4	2-9/32
	2-3/16	<b>128774</b>	F2B-DL-203	9.1										
	55mm	<b>126618</b>	F2B-DL-55M	4.1	57.2	215.9	60.3	184.2	M16	15.1	17.5	93.7	133.4	57.9

MODIFICATIONS PAGE B4-60			
-----------------------------	--	--	--

# SELECTION/DIMENSIONS

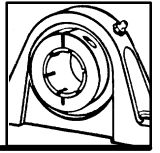

## D-LOK Ball Bearings

### DL NORMAL DUTY 2-BOLT PILOTED FLANGE BEARINGS

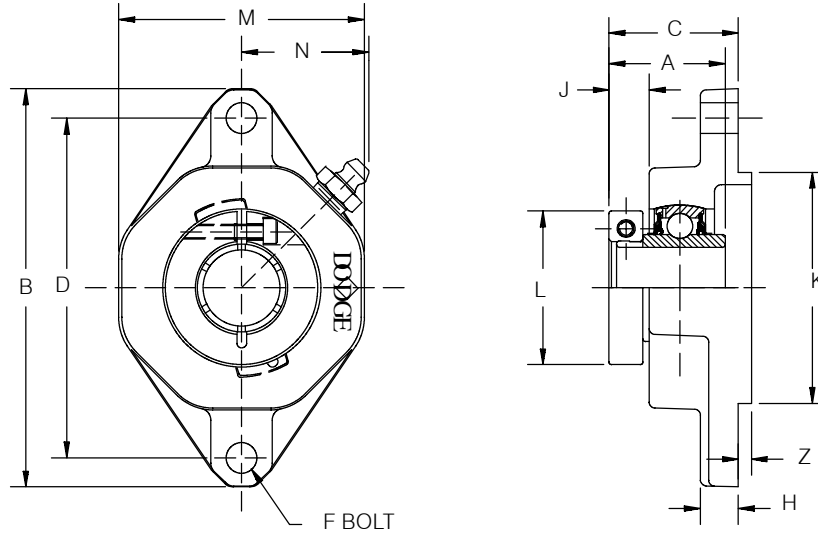

Series	Shaft Size	Part Number	Description
204	3/4 20mm	@ <b>126646</b>	F2BZ-DL-012 F2B-DL-20M
205	7/8 15/16 1 25mm	@ @ @ <b>126647</b>	F2BZ-DL-014 F2BZ-DL-015 F2BZ-DL-100 F2BZ-DL-25M
206	1-1/8 1-3/16 1-1/4 30mm	@ @ @ <b>126648</b>	F2BZ-DL-102 F2BZ-DL-103 F2BZ-DL-104S F2BZ-DL-30M
207	1-1/4 1-3/8 1-7/16 35mm	@ @ @ <b>126649</b>	F2BZ-DL-104 F2BZ-DL-106 F2BZ-DL-107 F2BZ-DL-35M
208	1-1/2 40mm	@ <b>126650</b>	F2BZ-DL-108 F2BZ-DL-40M
209	1-5/8 1-11/16 1-3/4 45mm	@ @ @ <b>126651</b>	F2BZ-DL-110L F2BZ-DL-111 F2BZ-DL-112 F2BZ-DL-45M
210	1-15/16 2 50mm	@ @ <b>126652</b>	F2BZ-DL-115 F2BZ-DL-200 F2BZ-DL-50M

@ Assembled to order

FEATURES/BENEFITS PAGE B4-2	HOW TO ORDER/ NOMENCLATURE PAGE B4-4	SELECTION PAGE B4-5	DIMENSIONS DL INSERTS PAGE B4-54
--------------------------------	--	------------------------	--

# SELECTION/DIMENSIONS

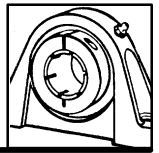

## D-LOK Ball Bearings

### DL NORMAL DUTY 2-BOLT PILOTED FLANGE BEARINGS

Series	Shaft Size	Weight lbs. - kgs.	A	B	C	D	F Bolt dia	H	J
204	3/4 20mm	1.4 0.6	1-9/32 32.5	4-27/64 112.3	1-17/32 38.9	3-17/32 89.7	3/8 M10	13/32 10.3	3/8 9.5
205	7/8	1.8	1-7/16 36.5	4-7/8 123.8	1-39/64 41.1	3-57/64 98.8	7/16 M10	15/32 11.9	15/32 11.9
	15/16	1.8							
	1 25mm	1.8 0.8							
206	1-1/8	2.4	1-9/16 39.7	5-9/16 141.3	1-23/32 43.7	4-19/32 116.7	7/16 M10	17/32 13.5	31/64 12.3
	1-3/16	2.4							
	1-1/4	2.3							
	30mm	1.1							
207	1-1/4	3.5	1-3/4 44.5	6-1/8 155.6	1-29/32 48.4	5-1/8 130.2	1/2 M12	35/64 13.9	9/16 14.3
	1-3/8	3.5							
	1-7/16	3.4							
	35mm	1.6							
208	1-1/2	4.8	2 50.8	6-3/4 171.5	2-13/64 55.9	5-21/32 143.7	1/2 M12	17/32 13.5	21/32 16.7
	40mm	2.2							
209	1-5/8	5.2	2 50.8	7-1/16 179.4	2-13/64 56.1	5-27/32 148.4	9/16 M12	9/16 14.3	21/32 16.7
	1-11/16	5.2							
	1-3/4	5.2							
	45mm	2.4							
210	1-15/16	6.0	2-3/32 53.2	7-7/16 188.9	3-1/4 82.5	6-3/16 157.2	9/16 M16	35/64 13.9	11/16 17.5
	2	5.9							
	50mm	2.6							

Series	Shaft Size	K	L	M	N	P	U	Z <sub>H8</sub>
204	3/4 20mm	27/64 10.7	1-45/64 43.3	2-3/8 60.3	1-3/8 34.9	0.1378 3.5	1-25/964 35.3	2.1654 55.0
205	7/8	29/64	2 50.8	2-3/4 69.9	1-9/16 39.7	0.1378 3.5	1-31/64 37.6	2.3622 60.0
	15/16	11.5						
	1 25mm	11.5						
206	1-1/8	29/64	2-7/32 56.4	3-1/4 82.6	1-3/4 44.5	0.1181 3.0	1-39/64 40.9	3.1496 80.0
	1-3/16	11.5						
	1-1/4	11.5						
	30mm	11.5						
207	1-1/4	33/64	2-11/16 68.3	3-3/4 95.3	1-57/64 48.0	0.1575 4.0	1-47/64 44.2	3.5433 90.0
	1-3/8	13.2						
	1-7/16	13.2						
	35mm	13.2						
208	1-1/2	33/64	2-25/32 70.6	4-1/8 104.8	1-7/8 47.6	0.1575 4.0	2-1/32 51.6	3.9370 100.0
	40mm	13.2						
209	1-5/8	33/64	3-1/16 77.8	4-3/8 111.1	1-31/32 50.0	0.1575 4.0	2-3/64 52.1	4.1339 105.0
	1-11/16	13.2						
	1-3/4	13.2						
	45mm	13.2						
210	1-15/16	43/64	3-9/32 83.3	4-9/16 115.9	2-1/32 51.6	0.1575 4.0	2-19/64 58.4	4.1339 105.0
	2	17.1						
	50mm	17.1						

MODIFICATIONS PAGE B4-60			
-----------------------------	--	--	--

# SELECTION/DIMENSIONS

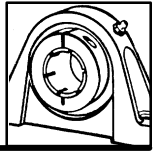

## D-LOK Ball Bearings

### DLM MEDIUM DUTY 2-BOLT FLANGE BEARINGS

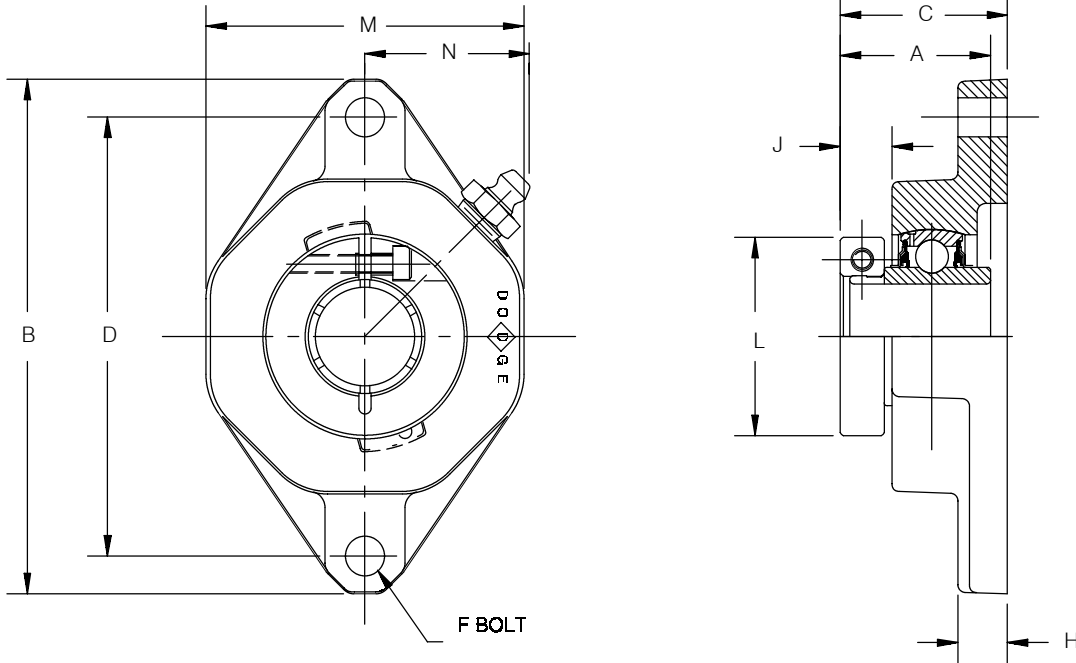

Series	Shaft Size	Part Number	Description	Weight lbs. kg.	A	B	C	D	F Bolt Dia.	H	J	L	M	N
206	1	128835	F2B-DLM-100	2.6	1-9/16	5-9/16	1-5/8	4-19/32	7/16	17/32	31/64	2-7/32	3-1/4	1-3/4
207	1-3/16 1-1/4	128836 128764	F2B-DLM-103 F2B-DL-104	3.7 3.5	1-3/4	6-1/8	1-13/16	5-1/8	1/2	35/64	9/16	2.694	3-3/4	1-57/64
208	1-7/16 35mm	128837 126641	F2B-DLM-107 F2B-DLM-35M	5.0 2.22	3-1/2 4.45	1-3/4 155.6	6-1/8 46.0	1-13/16 130.2	5-1/8 M12	1/2 13.9	35/64 14.3	9/16 68.3	2-11/16 95.3	3-3/4 48.0
209	1-1/2	128838	F2B-DLM-108	5.6	2	6-3/4	2-51/64	5-21/32	1/2	17/32	21/32	2-25/32	4-1/8	1-7/8
210	1-11/16 1-3/4	128839 128840	F2B-DLM-111 F2B-DLM-112	6.2 6.1	2-3/32	7-7/16	2-7/32	6-3/16	9/16	35/64	11/16	3-9/32	4-9/16	2-1/32
211	1-15/16 2	128841 128842	F2B-DLM-115 F2B-DLM-200	9.2 9.1	2-1/4	8-1/2	2-3/8	7-1/4	5/8	19/32	11/16	3-11/16	5-1/4	2-9/32

FEATURES/BENEFITS PAGE B4-2	HOW TO ORDER/ NOMENCLATURE PAGE B4-4	SELECTION PAGE B4-5	DIMENSIONS DLM INSERTS PAGE B4-58
--------------------------------	--	------------------------	---



# SELECTION/DIMENSIONS

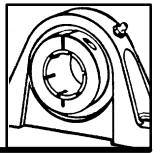

## D-LOK Ball Bearings

### DL LFT NORMAL DUTY 2-BOLT FLANGE BEARINGS

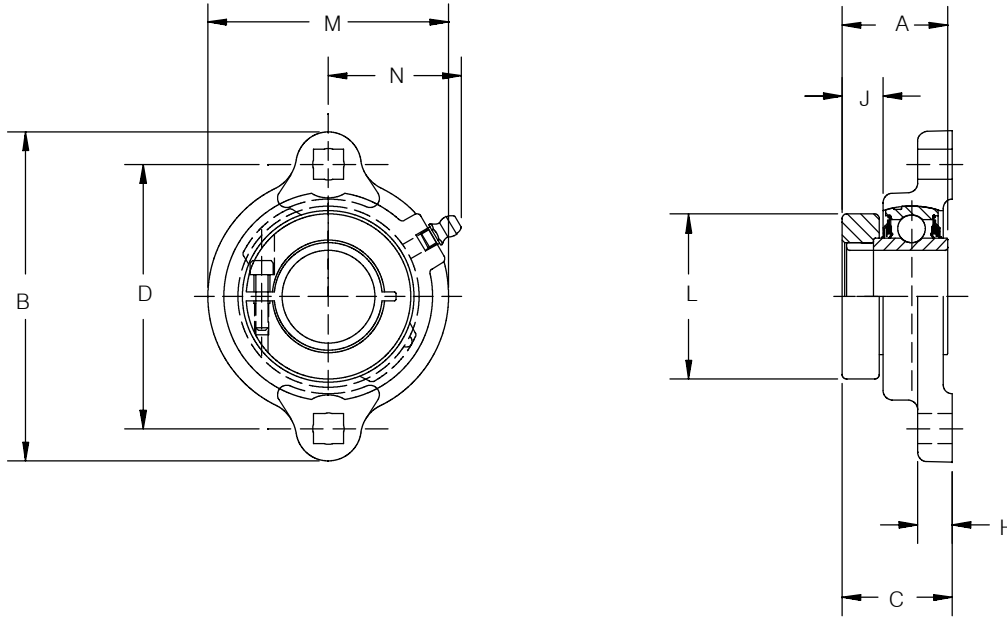

Series	Shaft Size	Part Number	Description	Weight lbs	A	B	C	D
204	3/4	@	LFT-DL-012	0.00	1-9/32	0	0	0
205	7/8	<b>053140</b>	LFT-DL-014	0.95	1-7/16	0	0	0
	15/16	@	LFT-DL-015	0.90				
	1	<b>052668</b>	LFT-DL-100	0.85				
206	1-1/8	@	LFT-DL-102	0.43	1-9/16	4-7/16	1-15/32	3-9/16
	1-3/16	@	LFT-DL-103	1.50				
	1-1/4	<b>052535</b>	LFT-DL-104S	1.45				
207	1-1/4	@	LFT-DL-104	1.35	1-3/4	112-67/94	37-19/62	90-20/41
	1-3/8	@	LFT-DL-106	0.67				
	1-7/16	@	LFT-DL-107	1.85				

@ Assembled to order

Series	Shaft Size	G	H	J	L	M	N
204	3/4	0	0	0	1-45/64	0	0
205	7/8	0	0	0	2	0	0
	15/16						
206	1	13/32	0	0	2-7/32	0	0
	1-1/8						
	1-3/16						
207	1-1/4	10-22/69	0	0	2-11/16	0	0
	1-3/8						
	1-7/16						

FEATURES/BENEFITS PAGE B4-2	HOW TO ORDER/ NOMENCLATURE PAGE B4-4	SELECTION PAGE B4-5	DIMENSIONS DLM INSERTS PAGE B4-58
--------------------------------	--	------------------------	---

# SELECTION/DIMENSIONS

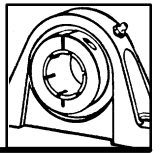

## D-LOK Ball Bearings

### DL LF NORMAL DUTY 3-BOLT FLANGE BEARINGS

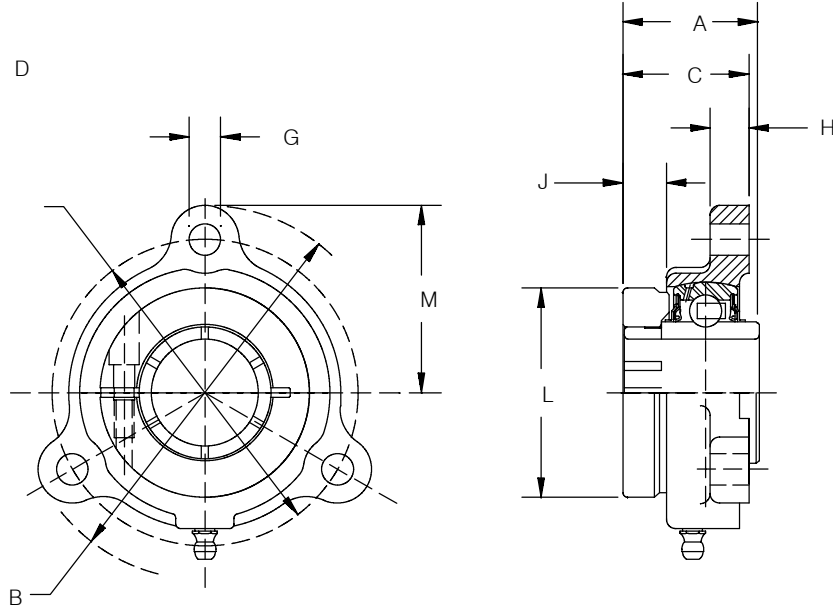

Series	Shaft Size	Part Number	Description	Weight lbs	A	B	C	D
204	3/4	@	LF-DL-012	0.85	1-9/32	3-9/16	1-7/32	2-13/16
205	7/8	@	LF-DL-014	1.10	1-7/16	3-3/4	1-1/4	3
	15/16	@	LF-DL-015	1.05				
	1	@	LF-DL-100	1.00				
206	1-1/8	@	LF-DL-102	1.60	1-9/16	4-7/16	1-15/32	3-9/16
	1-3/16	@	LF-DL-103	1.55				
	1-1/4	@	LF-DL-104S	1.50				
207	1-1/4	@	LF-DL-104	2.10	1-3/4	4-13/16	1-19/32	3-15/16
	1-3/8	@	LF-DL-106	2.00				
	1-7/16	@	LF-DL-107	1.95				

@ Assembled to order.

Series	Shaft Size	G	H	J	L	M	N
204	3/4	23/64	27/64	3/8	1-1/8	1-25/32	1-37/64
205	7/8	11/32	27/64	13/32	1-5/16	1-7/8	1-45/64
	15/16						
206	1-1/8	13/32	15/32	17/32	1-37/64	2-7/32	2-1/64
	1-3/16						
207	1-1/4	13/32	1/2	17/32	1-27/32	2-13/32	2-9/64
	1-3/8						
	1-7/16						

FEATURES/BENEFITS PAGE B4-2	HOW TO ORDER/ NOMENCLATURE PAGE B4-4	SELECTION PAGE B4-5	DIMENSIONS DLM INSERTS PAGE B4-58
--------------------------------	--	------------------------	---

# SELECTION/DIMENSIONS

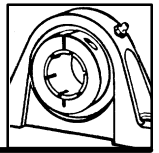

## D-LOK Ball Bearings

### DL NORMAL DUTY 3-BOLT FLANGED BRACKET BEARINGS

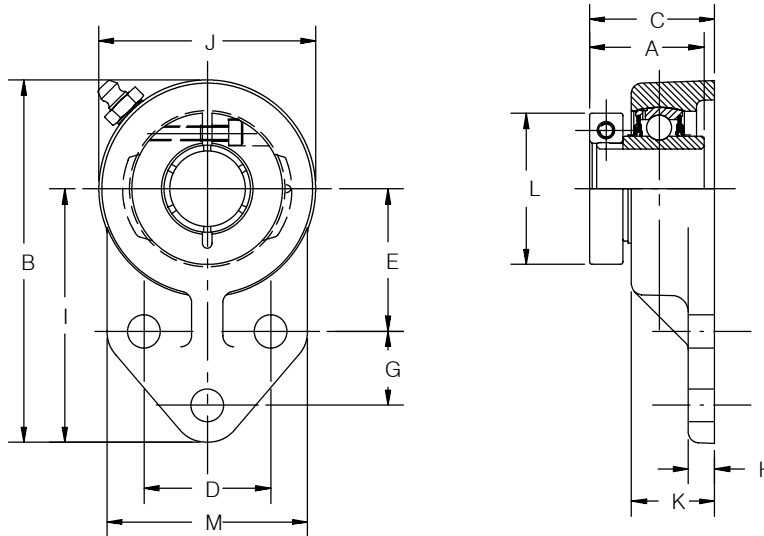

Series	Shaft Size	Part Number	Description	Weight lbs.	A	B	C	D
204	3/4	128796	FB-DL-012	1.3	1-9/32	4-1/4	1-11/32	1-1/2
205	7/8 15/16 1	128797	FB-DL-014	2.3	1-7/16	4-3/4	1-1/2	1-5/8
		128798	FB-DL-015	2.3				
		128799	FB-DL-100	2.3				
206	1-1/8 1-3/16 1-1/4	128800	FB-DL-102	3.2	1-9/16	5-3/8	1-5/8	1-7/8
		128801	FB-DL-103	3.2				
		128802	FB-DL-104S	3.1				
207	1-1/4 1-3/8 1-7/16	128803	FB-DL-104	3.4	1-3/4	6-1/8	1-7/8	2
		128804	FB-DL-106	3.4				
		128805	FB-DL-107	3.4				
210	1-15/16 2	128806	FB-DL-115	5.7	2-3/32	7-1/2	2-1/32	2-3/4
		128807	FB-DL-200	5.6				

Series	Shaft Size	E	F Bolt Dia.	G	H	I	J	K	L	M
204	3/4	1-11/16	3/8	7/8	5/16	3	2-1/2	63/64	1-45/64	2-3/8
205	7/8 15/16 1	1-13/16	3/8	1-1/8	3/8	3-3/8	2-3/4	1-7/64	2	2-1/2
206	1-1/8 1-3/16 1-1/4	2-1/16	3/8	1-1/4	3/8	3-3/4	3-1/4	1-1/8	2-7/32	2-3/4
207	1-1/4 1-3/8 1-7/16	2-3/8	1/2	1-1/4	1/2	4-1/4	3-3/4	1-5/16	2-11/16	3-1/4
210	1-15/16 2	2-15/16	1/2	1-5/8	1/2	5-3/16	4-5/8	1-1/2	3-9/32	4

FEATURES/BENEFITS PAGE B4-2	HOW TO ORDER/ NOMENCLATURE PAGE B4-4	SELECTION PAGE B4-5	DIMENSIONS DL INSERTS PAGE B4-54
--------------------------------	--	------------------------	--

# SELECTION/DIMENSIONS

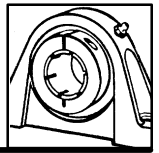

## D-LOK Ball Bearings

### DL NORMAL DUTY 4-BOLT FLANGE BEARINGS

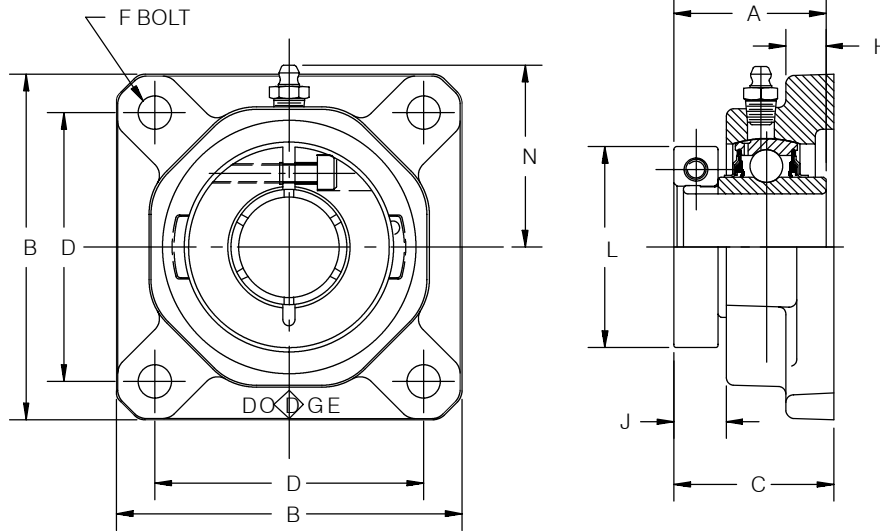

Series	Shaft Size	Part Number	Description	Weight lbs. kgs	A	B	C	D	F Bolt Dia.	H	J	L	N
204	3/4 20mm	128775	F4B-DL-012	1.7	1-9/32	3-3/8	1-11/32	2-1/2	3/8	13/32	3/8	1-45/64	2-1/32
		126619	F4B-DL-20M	0.8	32.5	85.7	34.1	63.5	M10	10.3	9.5	43.3	51.6
205	7/8 15/16 1 25mm	128776	F4B-DL-014	2.2	1-7/16	3-3/4	1-1/2	2-3/4	7/16	15/32	15/32	2	2-1/8
		128777	F4B-DL-015	2.2									
		128778	F4B-DL-100	2.2									
		126620	F4B-DL-25M	1.0	36.5	95.3	38.1	69.9	M10	11.9	11.9	50.8	54.0
206	1-1/8 1-3/16 1-1/4 30mm	128779	F4B-DL-102	3.8	1-9/16	4-1/4	1-5/8	3-1/4	7/16	17/32	31/64	2-7/32	2-5/32
		128780	F4B-DL-103	3.7									
		128781	F4B-DL-104S	3.7									
		126621	F4B-DL-30M	1.7	39.7	108.0	41.3	82.6	M10	13.5	12.3	56.4	54.8
207	1-1/4 1-3/8 1-7/16 35mm	128782	F4B-DL-104	4.4	1-3/4	4-5/8	1-13/16	3-5/8	1/2	9/16	9/16	2-11/16	2-13/32
		128783	F4B-DL-106	4.4									
		128784	F4B-DL-107	4.3									
		126222	F4B-DL-35M	2.0	44.5	117.5	46.0	92.1	M12	14.3	14.3	68.3	61.1
208	1-1/2 40mm	128785	F4B-DL-108	5.8	2	5-1/8	2-5/64	4	1/2	35/64	21/32	2-25/32	2-19/32
		126623	F4B-DL-40M	2.6	50.8	130.2	52.8	101.6	M12	13.94	16.7	70.6	65.9
209	1-5/8 1-11/16 1-3/4 45mm	128786	F4B-DL-110L	6.0	2	5-3/8	2-7/64	4-1/8	9/16	9/16	21/32	3-1/16	2-45/64
		128787	F4B-DL-111	6.0									
		128788	F4B-DL-112	5.9									
		126624	F4B-DL-45M	2.7	50.8	136.5	53.6	104.8	M14	14.3	16.7	78.5	68.7
210	1-15/16 2 50mm	128789	F4B-DL-115	7.0	2-3/32	5-5/8	2-7/32	4-3/8	9/16	35/64	11/16	3-9/32	2-51/64
		128790	F4B-DL-200	6.9									
		126625	F4B-DL-50M	3.1	53.2	142.9	56.4	111.1	M14	13.9	17.5	83.3	71.0
211	2 2-3/16 55mm	128850	F4B-DLM-200	11.0	2-1/4	6-3/8	2-3/8	5-1/8	5/8	19/32	11/16	3-11/16	3-9/64
		128792	F4B-DL-203	11.0									
		126626	F4B-DL-55M	5.0	57.2	161.9	60.3	130.2	M16	15.1	17.5	93.7	79.8
212	2-1/4 2-7/16 60mm	128852	F4B-DLM-204	13.3	2-5/8	6-7/8	2-3/4	5-5/8	5/8	19/32	7/8	4-7/64	3-15/64
		128794	F4B-DL-207	13.0									
		126627	F4B-DL-60M	5.9	66.7	174.6	69.9	142.9	M16	15.1	22.2	104.4	82.2
214	2-1/2 2-11/16 70mm	128854	F4B-DLM-208	14.6	2-13/16	7-3/8	3-1/16	5-7/8	5/8	11/16	57/64	4-3/8	3-9/16
		128795	F4B-DL-211	14.6									
		126628	F4B-DL-70M	6.6	71.4	187.3	77.8	149.2	M16	M17.5	22.6	111.1	90.5
215	2-15/16	@	F4B-DL-215	18.8	2-21/64	7-3/4	2-57/64	6	3/4	1	41/64	4-11/16	3-7/8

@ Assembled to order

MODIFICATIONS PAGE B4-60			
-----------------------------	--	--	--

# SELECTION/DIMENSIONS

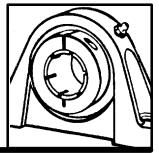

## D-LOK Ball Bearings

### DLM MEDIUM DUTY 4-BOLT FLANGE BEARINGS

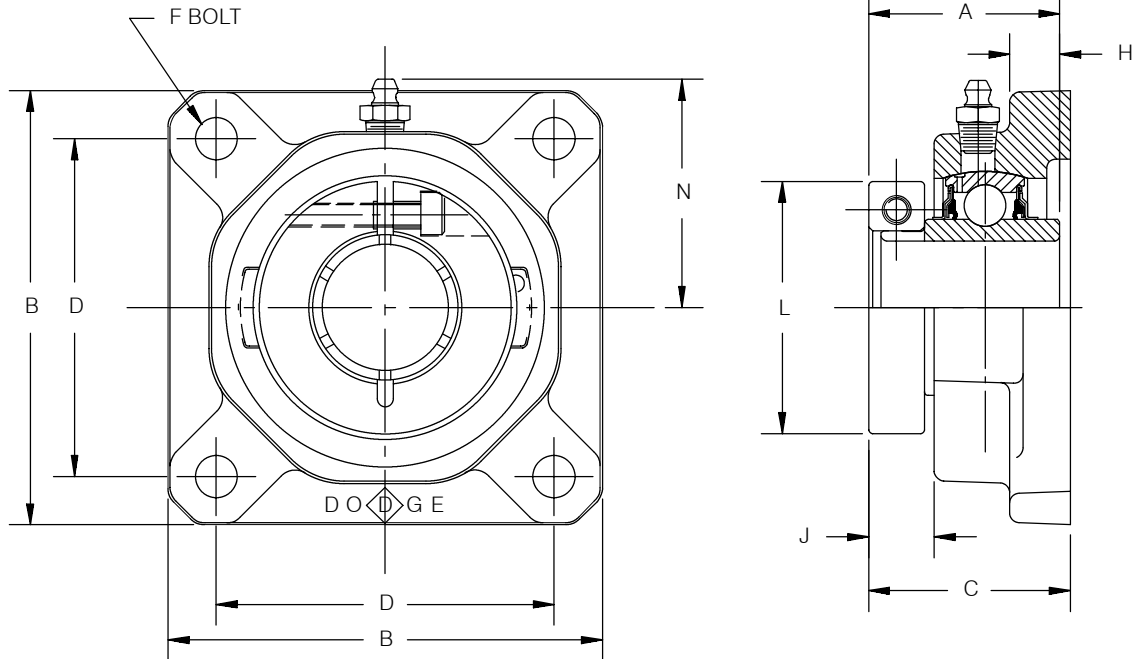

Series	Shaft Size	Part Number	Description	Weight lbs.	A	B	C	D	F Bolt Dia.	H	J	L	N
206	1	128843	F4B-DLM-100	3.8	1-9/16	4-1/4	1-5/8	3-1/4	7/16	17/32	31/64	2-7/32	2-5/32
207	1-3/16 1-1/4	128844 128782	F4B-DLM-103 F4B-DL-104	4.4 3.7	1-3/4	4-5/8	1-13/16	3-5/8	1/2	9/16	9/16	2-11/16	2-13/32
208	1-7/16 35MM	128845 126642	F4B-DLM-107 F4B-DLM-35M	5.9 2.2	2 50.8	5-1/8 130.2	2-5/64 52.8	4 101.6	1/2 M12	35/64 13.9	21/32 16.7	2-25/32 70.6	2-19/32 65.9
209	1-1/2 1-5/8	128846 128786	F4B-DLM-108 F4B-DL-110L	6.4 6.0	2	5-3/8	2-7/64	4-1/8	9/16	9/16	21/32	3-1/16	2-45/64
210	1-11/16 1-3/4	128847 128848	F4B-DLM-111 F4B-DLM-112	7.4 7.3	2-3/32	5-5/8	2-7/32	4-3/8	9/16	35/64	11/16	3-9/32	2-51/64
211	1-15/16 2	128849 128850	F4B-DLM-115 F4B-DLM-200	11.1 11.0	2-1/4	6-3/8	2-3/8	5-1/8	5/8	19/32	11/16	3-11/16	3-9/64
212	2-3/16 2-1/4	128851 128852	F4B-DLM-203 F4B-DLM-204	13.3 13.3	2-5/8	6-7/8	2-3/4	5-5/8	5/8	19/32	7/8	4-7/64	3-15/64
214	2-7/16 2-1/2 65MM	128853 128854 126643	F4B-DLM-207 F4B-DLM-208 F4B-DLM-65M	14.8 14.6 6.6	2-13/16 71.4	7-3/8 187.3	3-1/16 77.8	5-7/8 149.2	5/8 M16	11/16 17.5	57/64 22.6	4-3/8 111.1	3-9/16 90.5
215	2-11/16	@	F4B-DLM-211	20.3	2-21/64	7-3/4	2-57/64	6	3/4	1	41/64	4-11/16	3-7/8
216	2-15/16	058395	F4B-DLM-215	20.6	0	7-3/4	3-3/32	6	3/4	7/8	19/32	0	4-3/32
218	3-7/16	@	F4B-DLM-307	36.1	0	8-7/16	3-11/32	6-3/4	3/4	1	9/16	0	4-5/8

@ Assembled to order

MODIFICATIONS PAGE B4-60			
-----------------------------	--	--	--

# SELECTION/DIMENSIONS

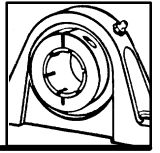

## D-LOK Ball Bearings

### DL NORMAL DUTY PILOTED FLANGE BEARINGS

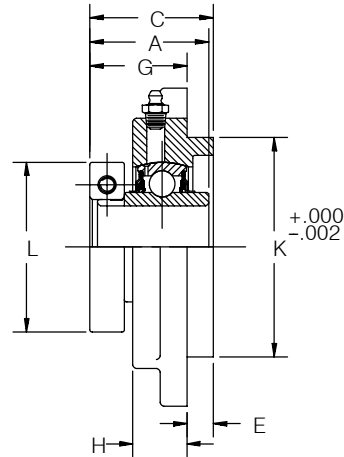
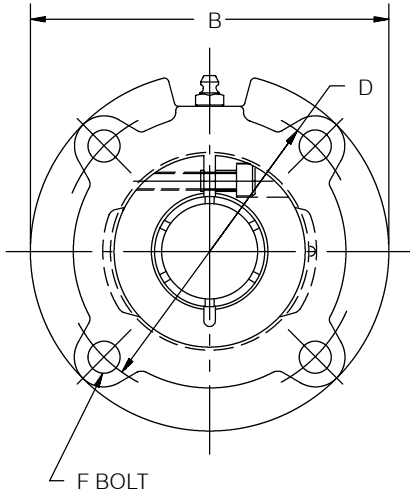

Series	Shaft Size	Part Number	Description
206	1-1/8	<b>128808</b>	FC-DL-102
	1-3/16	<b>128809</b>	FC-DL-103
	1-1/4	<b>@</b>	FC-DL-104S
	30mm	<b>126653</b>	FC-DL-30M
207	1-1/4	<b>128810</b>	FC-DL-104
	1-3/8	<b>128811</b>	FC-DL-106
	1-7/16	<b>128812</b>	FC-DL-107
	35mm	<b>126654</b>	FC-DL-35M
208	1-1/2	<b>128813</b>	FC-DL-108
	40mm	<b>126655</b>	FC-DL-40M
209	1-5/8	<b>128814</b>	FC-DL-110L
	1-11/16	<b>128815</b>	FC-DL-111
	1-3/4	<b>128816</b>	FC-DL-112
	45mm	<b>126656</b>	FC-DL-45M
210	1-15/16	<b>128817</b>	FC-DL-115
	2	<b>128818</b>	FC-DL-200
	50mm	<b>126657</b>	FC-DL-50M
211	2	<b>128862</b>	FC-DLM-200
	2-3/16	<b>128820</b>	FC-DL-203
	55mm	<b>126658</b>	FC-DL-55M
212	2-1/4	<b>128864</b>	FC-DLM-204
	2-7/16	<b>128822</b>	FC-DL-207
	60mm	<b>126659</b>	FC-DL-60M
214	2-1/2	<b>128866</b>	FC-DLM-208
	2-11/16	<b>@</b>	FC-DL-211
	70mm	<b>126661</b>	FC-DL-70M

@ Assembled to order

FEATURES/BENEFITS PAGE B4-2	HOW TO ORDER/ NOMENCLATURE PAGE B4-4	SELECTION PAGE B4-5	DIMENSIONS DL INSERTS PAGE B4-54
--------------------------------	--	------------------------	--

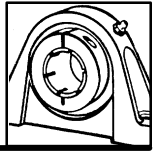

# SELECTION/DIMENSIONS

## D-LOK Ball Bearings

### DL NORMAL DUTY PILOTED FLANGE BEARINGS

Series	Shaft Size	Weight lbs. - kgs.	A	B	C	D	E
206	1-1/8	3.0	1-9/16	5	1-17/32	4-1/8	3/8
	1-3/16	3.0					
	1-1/4	3.0					
	30mm	1.4	39.7	127.0	38.9	104.8	9.5
207	1-1/4	4.1	1-3/4	5	1-51/64	4-1/8	3/8
	1-3/8	4.0					
	1-7/16	4.0					
	35mm	1.6	44.5	127.0	45.6	104.8	9.5
208	1-1/2	4.9	2	5-1/4	2-3/64	4-3/8	7/16
	40mm	2.1	50.8	133.4	52.0	111.1	11.1
209	1-5/8	6.2	2	6-1/8	2	5-1/8	15/32
	1-11/16	6.1					
	1-3/4	6.1					
	45mm	2.5	50.8	155.6	50.8	130.2	11.9
210	1-15/16	6.2	2-3/32	6-1/8	2-9/64	5-1/8	15/32
	2	6.2					
	50mm	2.6	53.2	155.6	54.4	130.2	11.9
211	2	8.0	2-1/4	6-3/8	2-3/8	5-3/8	5/8
	2-3/16	8.0					
	55mm	3.4	57.2	161.9	60.3	136.5	15.9
212	2-1/4	11.6	2-5/8	7-1/8	2-3/4	6	7/8
	2-7/16	11.6					
	60mm	4.9	66.7	181.0	69.9	152.4	22.2
214	2-1/2	13.8	2-13/16	7-5/8	3-5/64	6-1/2	1-1/8
	2-11/16	13.8					
	70mm	5.8	71.4	193.7	78.2	165.1	28.6

Series	Shaft Size	F Bolt Dia.	G	H	K*	L
206	1-1/8	3/8	1-9/32	27/32	3-3/8	2-7/32
	1-3/16					
	1-1/4					
	30mm	M10	32.5	21.4	85.7	56.4
207	1-1/4	3/8	1-27/64	27/32	3-3/8	2-11/16
	1-3/8					
	1-7/16					
	35mm	M10	36.1	21.4	85.7	68.3
208	1-1/2	7/16	1-39/64	57/64	3-5/8	2-25/32
	40mm	M12	40.9	22.6	92.1	70.6
209	1-5/8	1/2	1-9/16	59/64	4-1/4	3-1/16
	1-11/16					
	1-3/4					
	45mm	M12	39.7	23.4	108.0	78.5
210	1-15/16	1/2	1-43/64	59/64	4-1/4	3-9/32
	2					
	50mm	M12	42.5	23.4	108.0	83.3
211	2	1/2	1-3/4	1	4-1/2	3-11/16
	2-3/16					
	55mm	M12	44.5	25.4	114.3	93.7
212	2-1/4	1/2	1-7/8	1	5	4-7/64
	2-7/16					
	60mm	M12	47.6	25.4	127.0	104.4
214	2-1/2	1/2	1-61/64	1-1/16	5-1/2	4-3/8
	2-11/16					
	70mm	M12	49.6	27.0	139.7	111.1

\* +0.000" - 0.002"

MODIFICATIONS PAGE B4-60			
-----------------------------	--	--	--

# SELECTION/DIMENSIONS

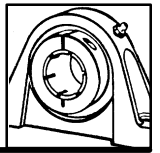

## D-LOK Ball Bearings

### DLM MEDIUM DUTY PILOTED FLANGE BEARINGS

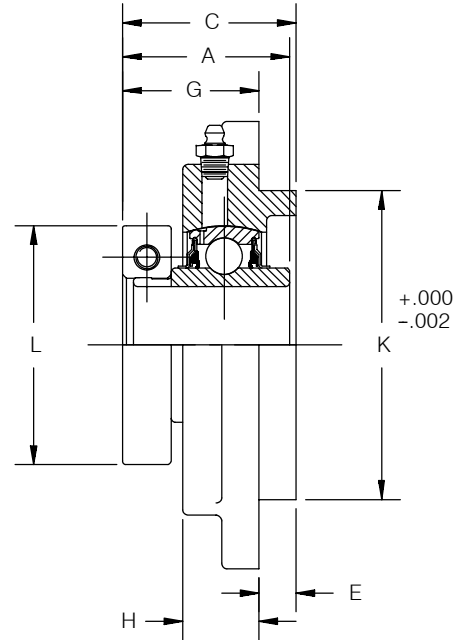
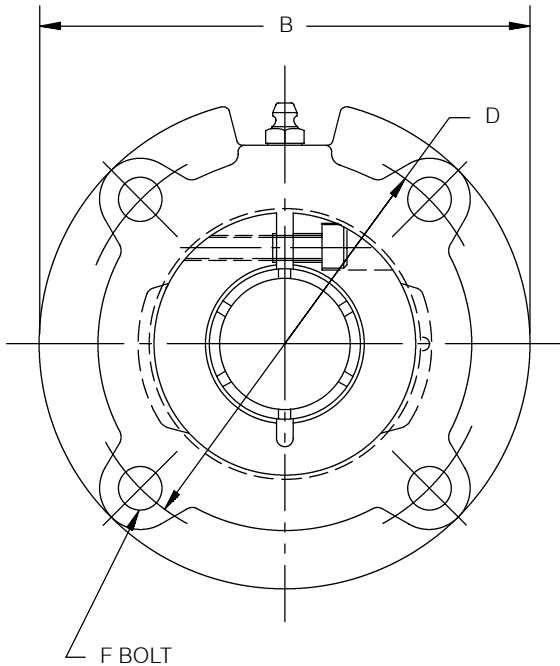

Series	Shaft Size	Part Number	Description
206	1	128855	FC-DLM-100
207	1-3/16 1-1/4	128856	FC-DLM-103
		128810	FC-DL-104
208	1-7/16 1-1/2 35mm	128857	FC-DLM-107
		128815	FC-DL-108
		053784	FC-DLM-35M
209	1-1/2 1-5/8	128858	FC-DLM-108L
		128814	FC-DL-110L
210	1-11/16 1-3/4	128859	FC-DLM-111
		128860	FC-DLM-112
211	1-15/16 2	128861	FC-DLM-115
		128862	FC-DLM-200
212	2-3/16 2-1/4	128863	FC-DLM-203
		128864	FC-DLM-204
214	2-7/16 2-1/2 65mm	128865	FC-DLM-207
		128866	FC-DLM-208
		126660	FC-DLM-65M
216	2-15/16	057475	FC-DLM-215
218	3-7/16	@	FC-DLM-307

@ Assembled to order

FEATURES/BENEFITS PAGE B4-2	HOW TO ORDER/ NOMENCLATURE PAGE B4-4	SELECTION PAGE B4-5	DIMENSIONS DLM INSERTS PAGE B4-58
--------------------------------	--	------------------------	---



# SELECTION/DIMENSIONS

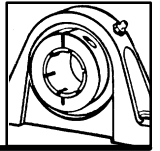

## D-LOK Ball Bearings

### DLM MEDIUM DUTY PILOTED FLANGE BEARINGS

Series	Shaft Size	Weight lbs.	A	B	C	D	E
206	1	3.1	1-9/16	5	1-17/32	4-1/8	3/8
207	1-3/16 1-1/4	4.1 4.1	1-3/4	5	1-51/64	4-1/8	3/8
208	1-7/16 1-1/2 35mm	5.1 4.9 2.6	2 50.8	5-1/4 133.4	2-3/64 52.0	4-3/8 111.1	7/16 11.1
209	1-1/2 1-5/8	6.1 6.2	2	6-1/8	2	5-1/8	15/32
210	1-11/16 1-3/4	6.2 6.2	2-3/32	6-1/8	2-9/64	5-1/8	15/32
211	1-15/16 2	8.0 8.0	2-1/4	6-3/8	2-3/8	5-3/8	5/8
212	2-3/16 2-1/4	11.6 11.6	2-5/8	7-1/8	2-3/4	6	7/8
214	2-7/16 2-1/2 65mm	13.9 13.8 5.9	2-13/16 71.4	7-5/8 193.7	3-5/64 78.2	6-1/2 165.1	1-1/8 28.6
216	2-15/16	18.8	0	8-3/4	3-11/64	7-1/2	1-1/4
218	3-7/16	36.8	0	10-1/4	3-15/32	8-5/8	1-3/8

Series	Shaft Size	F Bolt Dia.	G	H	K*	L
206	1	3/8	1-9/32	27/32	3-3/8	2-7/32
207	1-3/16 1-1/4	3/8	1-27/64	27/32	3-3/8	2-11/16
208	1-7/16 1-1/2 35mm	7/16 M12	1-39/64 40.9	57/64 22.6	3-5/8 92.1	2-25/32 70.6
209	1-1/2 1-5/8	1/2	1-9/16	59/64	4-1/4	3-1/16
210	1-11/16 1-3/4	1/2	1-43/64	59/64	4-1/4	3-9/32
211	1-15/16 2	1/2	1-3/4	1	4-1/2	3-11/16
212	2-3/16 2-1/4	1/2	1-7/8	1	5	4-7/64
214	2-7/16 2-1/2 65mm	1/2 M12	1-61/64 49.6	1-1/16 27.0	5-1/2 139.7	4-3/8 111.1
216	2-15/16	5/8	1-17/32	1-3/16	6-3/8	0
218	3-7/16	3/4	2-11/32	1-5/8	7-3/8	0

\*+0.000" - 0.002"

MODIFICATIONS PAGE B4-60			
-----------------------------	--	--	--

# SELECTION/DIMENSIONS

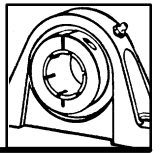

## D-LOK Ball Bearings

### DL NORMAL DUTY NARROW SLOT TAKE-UP BEARINGS

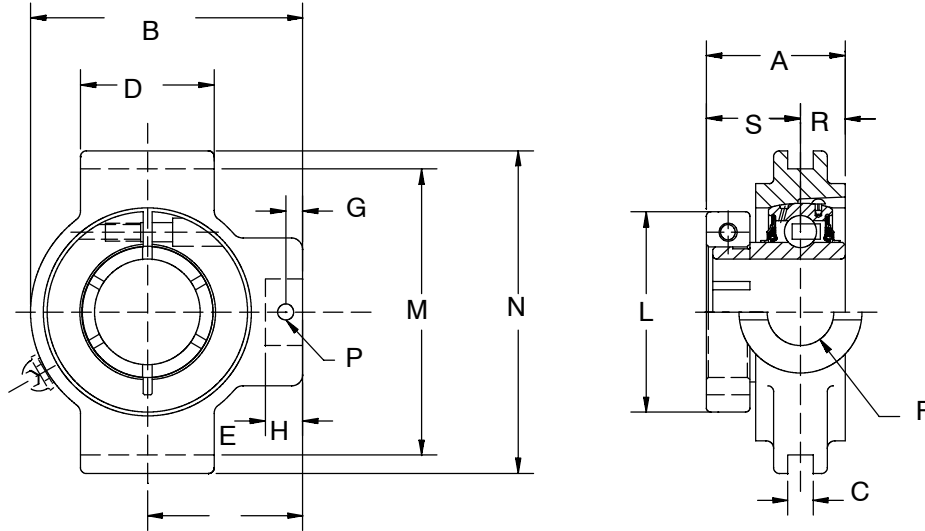

Series	Shaft Size	Part Number	Description
204	3/4 20mm	<b>052626</b> @	NSTU-DL-012 NSTU-DL-20M
205	7/8 15/16 1 25mm	@ @ @ @	NSTU-DL-014 NSTU-DL-105 NSTU-DL-100 NSTU-DL25M
206	1-1/8 1-3/16 1-1/4 30mm	@ @ @ @	NSTU-DL-102 NSTU-DL-103 NSTU-DL-104S NSTU-DL-30M
207	1-1/4 1-3/8 1-7/16 35mm	@ @ <b>053493</b> @	NSTU-DL-104 NSTU-DL-106 NSTU-DL-107 NSTU-DL-35M
208	1-1/2 40mm	@ @	NSTU-DL-108 NSTU-DL-40M

Series	Shaft Size	Part Number	Description
209	1-5/8 1-11/16 1-3/4 45mm	@ <b>057543</b> <b>057658</b> @	NSTU-DL-100L NSTU-DL-111 NSTU-DL-112 NSTU-DL-45M
210	1-15/16 2 50mm	@ @ @	NSTU-DL-115 NSTU-DL-200 NSTU-DL-50M
211	2 2-3/16 55mm	@ @ @	NSTU-DL-200 NSTU-DL-203 NSTU-DL-55M
212	2-1/4 2-7/16 60mm	@ @ @	NSTU-DLM-204 NSTU-DL-207 NSTU-DL-60M

@ Assembled to order

FEATURES/BENEFITS PAGE B4-2	HOW TO ORDER/ NOMENCLATURE PAGE B4-4	SELECTION PAGE B4-5	DIMENSIONS DL INSERTS PAGE B4-54
--------------------------------	--	------------------------	--

# SELECTION/DIMENSIONS

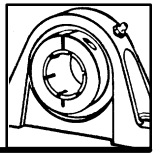

## D-LOK Ball Bearings

### DL NORMAL DUTY NARROW SLOT TAKE-UP BEARINGS

Series	Shaft Size	Weight lbs. kg.	Take-Up Frame Size	A	B	C*	D	E	F Screw Dia.	G
204	3/4 20mm	1.4 0.8	NS210	1-9/32 32.5	3-1/2 88.9	1/4 6.4	1-1/2 38.1	2-3/16 55.6	3/4 19.1	7/16 11.1
205	7/8 15/16 1 25mm	1.7 1.6 1.5 0.7	NS210	1-7/16 36.5	3-9/16 90.5	1/4 6.4	1-1/2 38.1	2-3/16 55.6	3/4 19.1	7/16 11.1
206	1-1/8 1-3/16 1-1/4 30mm	2.8 2.7 2.6 1.2	NS308	1-9/16 39.7	4-5/16 109.5	1/4 6.4	2-1/2 63.5	2-11/16 68.3	3/4 19.1	1/2 12.7
207	1-1/4 1-3/8 1-7/16 35mm	2.8 2.6 2.5 1.2	NS308	1-3/4 44.5	4-1/2 114.3	1/4 6.4	2-1/2 63.5	2-11/16 68.3	3/4 19.1	1/2 12.7
208	1-1/2 40mm	4.7 2.1	NS400	2 50.8	5-3/8 136.5	5/16 7.9	3 76.2	3-1/4 82.6	7/8 22.2	21/32 16.7
209	1-5/8 1-11/16 1-3/4 45mm	4.9 4.8 4.4 2.1	NS400	2 50.8	5-7/16 138.1	5/16 7.9	3 76.2	3-1/4 82.6	7/8 22.2	23/32 18.3
210	1-15/16 2 50mm	4.9 4.8 2.2	NS400	2-3/32 53.2	5-1/2 139.7	5/16 7.9	3 76.2	3-1/4 82.6	7/8 22.2	21/32 16.7
211	2 2-3/16 55mm	6.8 6.6 3.0	NS407	2-1/4 57.2	6-1/8 155.6	5/16 7.9	3-1/2 88.9	3-5/8 92.1	1 25.4	11/16 17.5
212	2-1/4 2-7/16 60mm	8.7 8.4 4.9	NS415	2-5/8 66.7	6-11/16 169.9	5/16 7.9	3-3/4 95.3	3-7/8 98.4	1 25.4	11/16 17.5

Series	Shaft Size	H	J	L	M#	N	P Pin Dia.	R	S
204	3/4 20mm	7/8 22.2	1-3/8 34.9	1-45/64 43.3	2-5/8 66.7	3-1/8 79.4	5/16 7.9	1/2 12.7	25/32 19.8
205	7/8 15/16 25mm	7/8 22.2	1-3/8 34.9	2 50.8	2-5/8 66.7	3-1/8 79.4	5/16 7.9	9/16 14.3	7/8 22.2
206	1-1/8 1-3/16 1-1/4 30mm	15/16 23.8	1-3/8 34.9	2-7/32 56.4	3-1/2 88.9	4-1/8 104.8	5/16 7.9	9/16 14.3	1 25.4
207	1-1/4 1-3/8 1-7/16 35mm	15/16 23.8	1-3/8 34.9	2-11/16 68.3	3-1/2 88.9	4-1/8 104.8	5/16 7.9	11/16 17.5	1-1/16 27.0
208	1-1/2 40mm	1-5/32 29.4	1-5/8 41.3	2-25/32 70.6	4 101.6	4-3/4 120.7	3/8 9.5	3/4 19.1	1-1/4 31.8
209	1-5/8 1-11/16 1-3/4 45mm	1-7/32 31.0	1-5/8 41.3	3-1/16 78.5	4 101.6	4-3/4 120.7	3/8 9.5	3/4 19.1	1-1/4 31.8
210	1-15/16 2 50mm	1-7/32 31.0	1-5/8 41.3	3-9/32 83.3	4 101.6	4-3/4 120.7	3/8 9.5	3/4 19.1	1-11/32 34.1
211	2 2-3/16 55mm	1-9/32 32.5	1-3/4 44.5	3-11/16 93.7	7/16 112.7	5-3/8 136.5	7/16 11.1	7/8 22.2	1-3/8 34.9
212	2-1/4 2-7/16 60mm	1-9/32 32.5	1-5/8 41.3	4-7/64 104.4	4-15/16 125.4	5-3/4 146.1	7/16 11.1	1 25.4	1-5/8 41.3

#+ .010, -.020" + .25mm, -.50mm

MODIFICATIONS PAGE B4-60			
-----------------------------	--	--	--

# SELECTION/DIMENSIONS

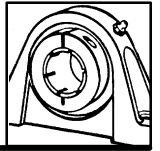

## D-LOK Ball Bearings

### DLM MEDIUM DUTY NARROW SLOT TAKE-UP BEARINGS

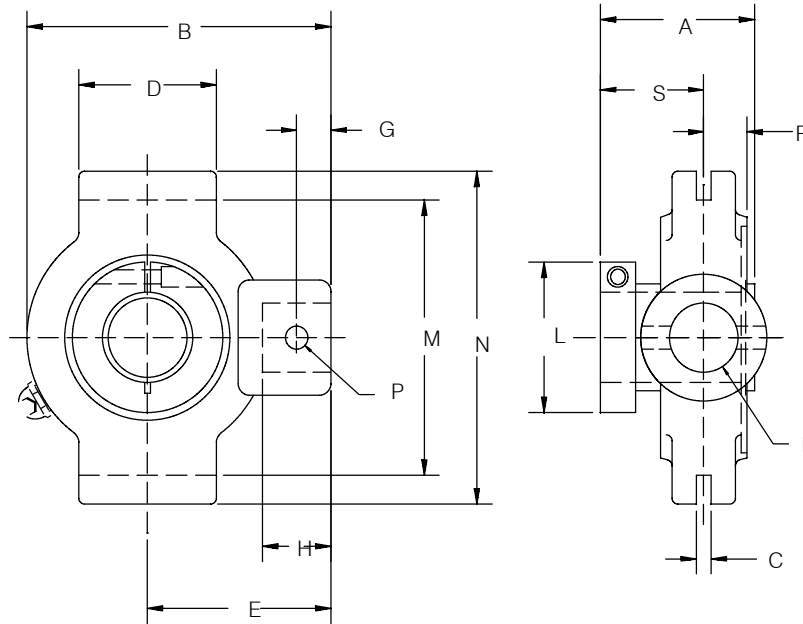

Series	Shaft Size	Part Number	Description
206	1	@	NSTU-DLM-100
207	1-3/16 1-1/4	@ @	NSTU-DL-103 NSTU-DL-104
208	1-7/16 35mm	@ @	NSTU-DLM-107 NSTU-DLM-35M
209	1-1/2 1-5/8	@ @	NSTU-DLM-108 NSTU-DL-110L
210	1-11/16 1-3/4	<b>058081</b> @	NSTU-DLM-111 NSTU-DLM-112
211	1-15/16 2	@ @	NSTU-DLM-115 NSTU-DLM-200
212	2-3/16 2-1/4	@ @	NSTU-DLM-203 NSTU-DLM-204

@ Assembled to order

FEATURES/BENEFITS PAGE B4-2	HOW TO ORDER/ NOMENCLATURE PAGE B4-4	SELECTION PAGE B4-5	DIMENSIONS DL INSERTS PAGE B4-54
--------------------------------	--	------------------------	--

# SELECTION/DIMENSIONS

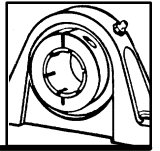

## D-LOK Ball Bearings

### DLM MEDIUM DUTY NARROW SLOT TAKE-UP BEARINGS

Series	Shaft Size	Weight lb kg	Take-Up Frame Size	A	B	C*	D	E	F Screw Dia.	G
206	1	2.8	NS308	1-9/16	4-5/16	1/4	2-1/2	2-11/16	3/4	1/2
207	1-3/16 1-1/4	2.8 2.8	NS308	1-3/4	4-1/2	1/4	2-1/2	2-11/16	3/4	1/2
208	1-7/16 35mm	4.7 2.1	NS400	2 50.8	5-3/8 136.5	5/16 7.9	3 76.2	3-1/4 82.6	7/8 22.2	21/32 16.7
209	1-1/2 1-5/8	4.9 4.8	NS400	2	5-7/16	5/16	3	3-1/4	7/8	23/32
210	1-11/16 1-3/4	4.9 4.8	NS400	2-3/32	5-1/2	5/16	3	3-1/4	7/8	21/32
211	1-15/16 2	6.8 6.8	NS407	2-1/4	6-1/8	5/16	3-1/2	3-5/8	1	11/16
212	2-3/16 2-1/4	8.7 8.7	NS415	2-5/8	6-11/16	5/16	3-3/4	3-7/8	1	11/16

\*+ or -.015", + or -.38mm

Series	Shaft Size	H	J	L	M#	N	P Pin Dia.	R	S
206	1	15/16	1-3/8	2-7/32	3-1/2	4-1/8	5/16	9/16	1
207	1-3/16 1-1/4	15/16	1-3/8	2-11/16	3-1/2	4-1/8	5/16	11/16	1-1/16
208	1-7/16 35mm	1-5/32 29.4	1-5/8 41.3	2-25/32 70.6	4 101.6	4-3/4 120.7	3/8 9.5	3/4 19.1	1-1/4 31.8
209	1-1/2 1-5/8	1-7/32	1-5/8	3-1/16	4	4-3/4	3/8	3/4	1-1/4
210	1-11/16 1-3/4	1-7/32	1-5/8	3-9/32	4	4-3/4	3/8	3/4	1-11/32
211	1-15/16 2	1-9/32	1-3/4	3-11/16	4-7/16	5-3/8	7/16	7/8	1-3/8
212	2-3/16 2-1/4	1-9/32	1-5/8	4-7/64	4-15/16	5-3/4	7/16	1	1-5/8

# +.010, -.020" +.25mm, -.50mm

FEATURES/BENEFITS PAGE B4-2	HOW TO ORDER/ NOMENCLATURE PAGE B4-4	SELECTION PAGE B4-5	DIMENSIONS DL INSERTS PAGE B4-54
--------------------------------	--	------------------------	--

# SELECTION/DIMENSIONS

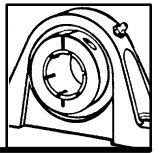

## D-LOK Ball Bearings

### DL NORMAL DUTY WIDE SLOT TAKE-UP BEARINGS

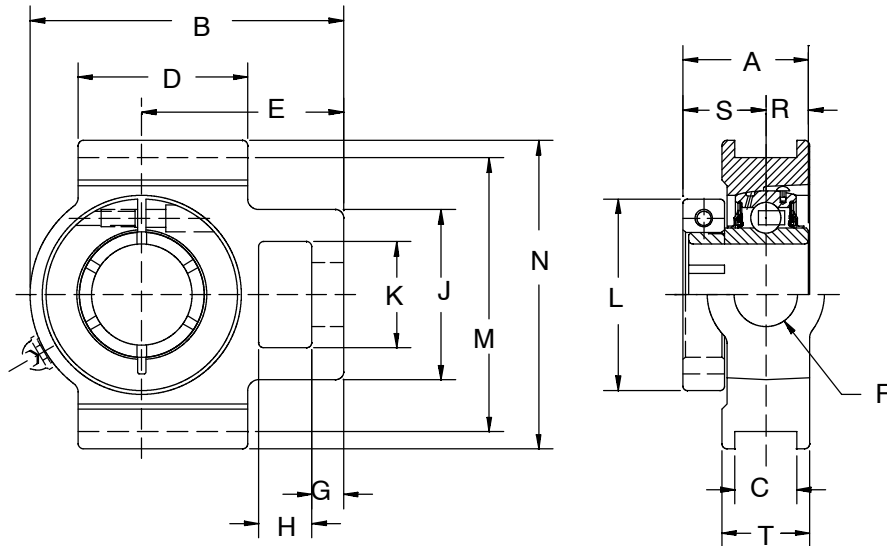

Series	Shaft Size	Part Number	Description
204	3/4 20mm	@ @	WSTU-DL-012 WSTU-DL-20M
205	7/8 15/16 1 25mm	@ @ @ @	WSTU-DL-014 WSTU-DL-015 WSTU-DL-100 WSTU-DL-25M
206	1-1/8 1-3/16 1-1/4 30mm	@ <b>057770</b> @ @	WSTU-DL-102 WSTU-DL-103 WSTU-DL-104S WSTU-DL-30M
207	1-1/4 1-3/8 1-7/16 35mm	@ @ <b>053517</b> @	WSTU-DL-104 WSTU-DL-106 WSTU-DL-107 WSTU-DL-35M
208	1-1/2 1-5/8 40mm	<b>052546</b> @	WSTU-DL-108 WSTU-DL-40M

@ Assembled to order

FEATURES/BENEFITS PAGE B4-2	HOW TO ORDER/ NOMENCLATURE PAGE B4-4	SELECTION PAGE B4-5	DIMENSIONS DL INSERTS PAGE B4-54
--------------------------------	--	------------------------	--

# SELECTION/DIMENSIONS

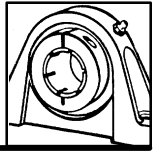

## D-LOK Ball Bearings

### DL NORMAL DUTY WIDE SLOT TAKE-UP BEARINGS

Series	Shaft Size	Weight lbs. kg.	Take-Up Frame Size	A	B	C*	D	E	F Screw Dia.
204	3/4 20mm	1.9 0.9	WS300	1-9/32 32.5	3-11/16 93.7	17/32 13.5	2 50.8	2-3/8 60.3	5/8 15.9
205	7/8 15/16 1 25mm	2.2 2.1 2.0 1.0	WS300	1-7/16 36.5	3-13/16 96.8	17/32 13.5	2 50.8	2-7/16 61.9	5/8 15.9
206	1-1/8 1-3/16 1-1/4 30mm	2.7 2.6 2.5 1.3	WS308	1-9/16 39.7	4-3/8 111.1	17/32 13.5	2-1/4 57.2	2-3/4 69.9	3/4 19.1
207	1-1/4 1-3/8 1-7/16 35mm	3.7 3.6 3.5 1.6	WS308	1-3/4 44.5	4-7/8 123.8	17/32 13.5	2-1/2 63.5	3-1/16 77.8	3/4 19.1
208	1-1/2 1-5/8 40mm	6.1 2.8	WS400	2 50.8	5-11/16 144.5	11/16 17.5	3-1/4 82.6	3-1/2 88.9	1 25.4

# +.010, -.020" +.25, -.50mm

Series	Shaft Size	G	H	J	K	L	M*	N	R	S	T
204	3/4 20mm	3/8 9.5	5/8 15.9	2 50.8	1-1/4 31.8	1-45/64 43.3	3 76.2	3-5/8 92.1	1/2 12.7	25/32 19.8	1-3/8 34.9
205	7/8 15/16 1 25mm	3/8 9.5	5/8 15.9	2 50.8	1-5/16 33.3	2 50.8	3 76.2	3-5/8 92.1	9/16 14.3	7/8 22.2	1-3/8 34.9
206	1-1/8 1-3/16 1-1/4 30mm	3/8 9.5	5/8 15.9	2-3/16 55.6	1-7/16 36.5	2-7/32 56.4	3-1/2 88.9	4-1/8 104.8	9/16 14.3	1 25.4	1-5/8 41.3
207	1-1/4 1-3/8 1-7/16 35mm	1/2 12.7	5/8 15.9	2-1/2 63.5	1-7/16 36.5	2-11/16 68.3	3-1/2 88.9	4-1/8 104.8	11/16 17.5	1-1/16 27.0	1-5/8 41.3
208	1-1/2 1-5/8 40mm	5/8 15.9	3/4 19.1	3-1/4 82.6	1-15/16 49.2	2-25/32 70.6	4 101.6	4-1/2 114.3	3/4 19.1	1-1/4 31.8	1-15/16 49.2

# +.010, -.020" +.25, -.50mm

MODIFICATIONS PAGE B4-60			
-----------------------------	--	--	--

# SELECTION/DIMENSIONS

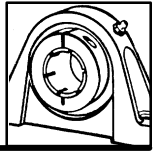

## D-LOK Ball Bearings

### DL NORMAL DUTY WIDE SLOT TAKE-UP BEARINGS

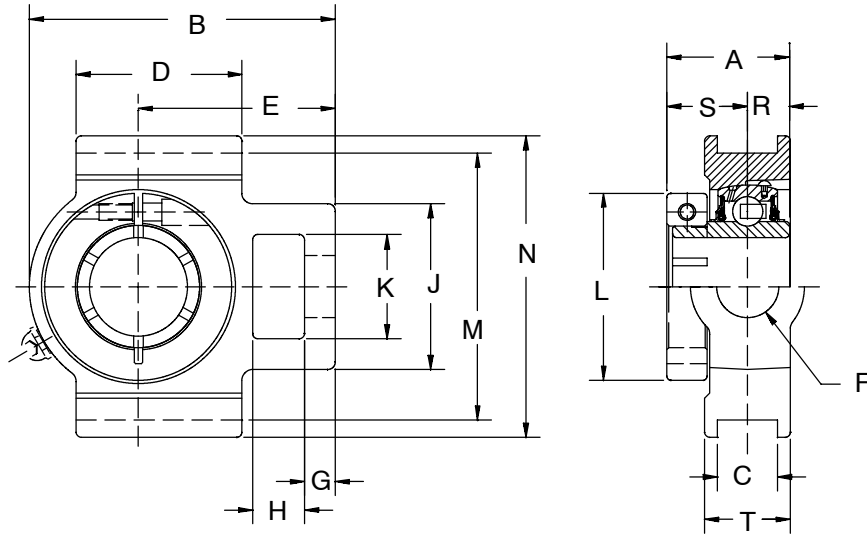

Series	Shaft Size	Part Number	Description
209	1-5/8	@	WSTU-DL-110L
	1-11/16	@	WSTU-DL-111
	1-3/4	@	WSTU-DL-112
	45mm	@	WSTU-DL-45M
210	1-15/16	<b>052722</b>	WSTU-DL-115
	2	@	WSTU-DL-200
	50mm	@	WSTU-DL-50M
211	2	@	WSTU-DL-200
	2-3/16	@	WSTU-DL-203
	55mm	@	WSTU-DL-55M
212	2-1/4	@	WSTU-DL-204
	2-7/16	@	WSTU-DL-207
	60mm	@	WSTU-DL-60M
214	2-1/2	@	WSTU-DL-208
	1-11/16	@	WSTU-DL-211
	70mm	@	WSTU-DL-70M
215	2-15/16	@	WSTU-DL-215

@ Assembled to order

FEATURES/BENEFITS PAGE B4-2	HOW TO ORDER/ NOMENCLATURE PAGE B4-4	SELECTION PAGE B4-5	DIMENSIONS DL INSERTS PAGE B4-54
--------------------------------	--	------------------------	--



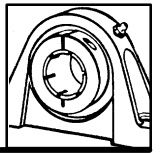

# SELECTION/DIMENSIONS

## D-LOK Ball Bearings

### DL NORMAL DUTY WIDE SLOT TAKE-UP BEARINGS

Series	Shaft Size	Weight lbs. kg.	Take-Up Frame Size	A	B	C*	D	E	F Screw Dia.
209	1-5/8	6.1	WS400	2	5-5/8	11/16	3-1/4	3-7/16	1
	1-11/16	6.0		50.8	142.9	17.5	82.6	87.3	25.4
	1-3/4	5.9							
	45mm	2.7							
210	1-15/16	6.4	WS400	2-3/32	5-13/16	11/16	3-3/8	3-9/16	1
	2	6.3		53.2	147.6	17.5	85.7	90.5	25.4
	50mm	2.9							
211	2	10.1	WS502	2-1/4	6-11/16	1-1/16	3-3/4	4-3/16	1-1/4
	2-3/16	10.0		57.2	169.9	27.0	95.3	106.4	31.8
	55mm	4.5							
212	2-1/4	11.2	WS502	2-5/8	7-1/2	1-1/16	4	4-11/16	1-1/4
	2-7/16	10.8		66.7	190.5	27.0	101.6	119.1	31.8
	60mm	4.9							
214	2-1/2	18.0	WS515	2-13/16	8-9/16	1-1/16	4-3/4	5-3/8	1-1/2
	1-11/16	17.8		71.4	217.5	27.0	120.7	136.5	38.1
	70mm	8.2							
215	2-15/16	18.9	WS515	2-21/64	9-1/8	1-1/16	4-3/4	5-1/2	1-1/2

# +.010, -.020" +.25, -.50mm

Series	Shaft Size	G	H	J	K	L	M*	N	R	S	T
209	1-5/8	5/8	3/4	3-1/4	1-15/16	3-1/16	4	4-3/4	3/4	1-1/4	1-15/16
	1-11/16										
	1-3/4	15.9	19.1	82.6	49.2	78.5	101.6	120.7	19.1	31.8	49.2
	45mm										
210	1-15/16	5/8	3/4	3-1/4	1-15/16	3-9/32	4	4-3/4	3/4	1-11/32	1-15/16
	2	15.9	19.1	82.6	49.2	83.3	101.6	120.7	19.1	34.1	49.2
	50mm										
211	2	3/4	1	4	2-1/2	3-11/16	5-1/8	5-7/8	7/8	1-3/8	2-1/2
	2-3/16	19.1	25.4	101.6	63.5	93.7	130.2	149.2	22.2	34.9	63.5
	55mm										
212	2-1/4	3/4	1-1/4	4	2-1/2	4-7/64	5-1/8	5-7/8	1	1-5/8	2-1/2
	2-7/16	19.1	31.8	101.6	63.5	104.4	130.2	149.2	25.4	41.3	63.5
	60mm										
214	2-1/2	13/16	1-1/4	4-3/8	2-3/4	4-3/8	5-15/16	6-9/16	1-1/16	1-3/4	2-3/4
	1-11/16	20.6	31.8	111.1	69.9	111.1	150.8	166.7	27.0	44.5	69.9
	70mm										
215	2-15/16	13/16	1-1/4	4-3/8	2-3/4	4-11/16	5-15/16	6-11/16	53/64	1-1/2	2-3/4

# +.010, -.020" +.25, -.50mm

MODIFICATIONS PAGE B4-60			
-----------------------------	--	--	--

# SELECTION/DIMENSIONS

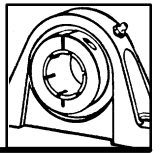

## D-LOK Ball Bearings

### DLM MEDIUM DUTY WIDE SLOT TAKE-UP BEARINGS

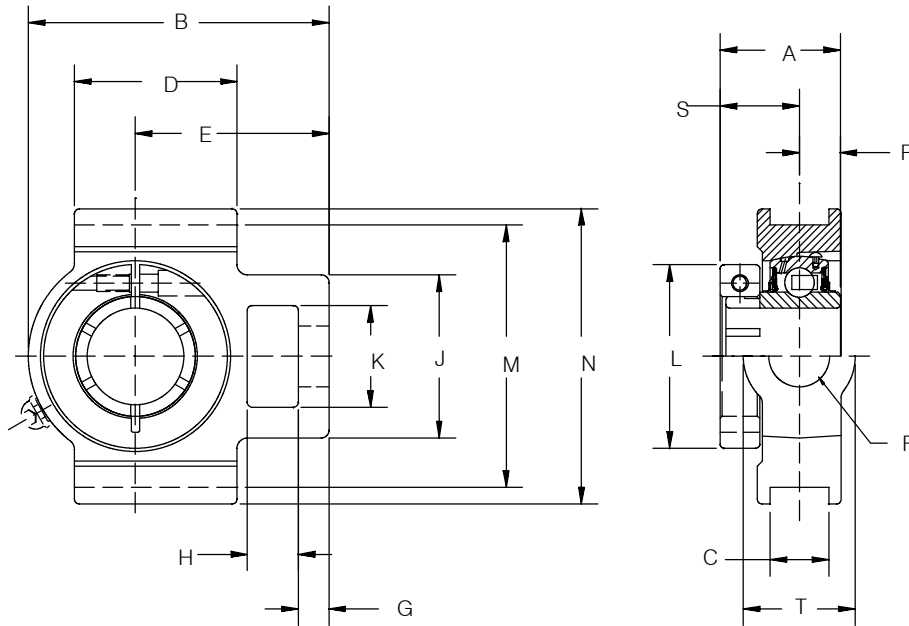

Series	Shaft Size	Part Number	Description
206	1	@	WSTU-DLM-100
207	1-3/16 1-1/4	@ @	WSTU-DLM-103 WSTU-DL-104
208	1-7/16 35mm	@ 054390	WSTU-DLM-107 WSTU-DLM-35M
209	1-1/2 1-5/8	@ @	WSTU-DLM-108 WSTU-DL-110L
210	1-11/16 1-3/4	054411 @	WSTU-DLM-111 WSTU-DLM-112
211	1-15/16 2	057266 @	WSTU-DLM-115 WSTU-DLM-200
212	2-3/16 2-1/4	@ @	WSTU-DLM-203 WSTU-DLM-204
214	2-7/16 2-1/2 65mm	@ @ @	WSTU-DLM-207 WSTU-DLM-208 WSTU-DLM-65M
215	2-11/16	@	WSTU-DLM-211
216	2-15/16	@	WSTU-DLM-215

@ Assembled to order

FEATURES/BENEFITS PAGE B4-2	HOW TO ORDER/ NOMENCLATURE PAGE B4-4	SELECTION PAGE B4-5	DIMENSIONS DL INSERTS PAGE B4-54
--------------------------------	--	------------------------	--

# SELECTION/DIMENSIONS

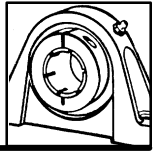

## D-LOK Ball Bearings

### DLM MEDIUM DUTY WIDE SLOT TAKE-UP BEARINGS

Series	Shaft Size	Weight lbs kg	Take-Up Frame Size	A	B	C*	D	E	F Screw Dia.	G
206	1	4.1	WS308	1-9/16	4-3/8	17-32	2-1/4	2-3/4	3/4	3/8
207	1-3/16 1-1/4	5.1 3.7	WS308	1-3/4	4-7/8	17/32	2-1/2	3-1/16	3/4	1/2
208	1-7/16 35mm	7.3 3.5	WS400	2 50.8	5-11/16 144.5	11/16 17.5	3-1/4 82.6	3-1/2 88.9	1 25.4	5/8 15.9
209	1-1/2 1-5/8	7.2 6.1	WS400	2	5-5/8	11/16	3-1/4	3-7/16	1	5/8
210	1-11/16 1-3/4	7.7 7.6	WS400	2-3/32	5-13/16	11/16	3-3/8	3-9/16	1	5/8
211	1-15/16 2	11.2 11.3	WS502	2-1/4	6-11/16	1-1/16	3-3/4	4-3/16	1-1/4	3/4
212	2-3/16 2-1/4	12.6 12.4	WS502	2-5/8	7-1/2	1-1/16	4	4-11/16	1-1/4	3/4
214	2-7/16 2-1/2 65mm	19.4 19.2 9.3	WS515	2-13/16 71.4	8-9/16 217.5	1-1/16 27.0	4-3/4 120.7	5-3/8 136.5	1-1/2 38.1	13/16 20.6
215	2-11/16	20.2	WS515	2-21/64	9-1/8	1-1/16	4-3/4	5-1/2	1-1/2	13/16
216	2-15/16	22.9	WS608	2-31/64	9-1/8	1-1/16	4-3/4	5-1/2	1-1/2	13/16

\*+or-.015+ or-.38mm

Series	Shaft Size	H	J	K	L	M#	N	R	S	T
206	1	5/8	2-3/16	1-7/16	2-7/32	3-1/2	4-1/8	9/16	1	1-5/8
207	1-3/16 1-1/4	5/8	2-1/2	1-7/16	2-11/16	3-1/2	4-1/8	11/16	1-1/16	1-5/8
208	1-7/16 35mm	3/4 19.1	3-1/4 82.6	1-15/16 49.2	2-25/32 70.6	4 101.6	4-1/2 114.3	3/4 19.1	1-1/4 31.8	1-15/16 49.2
209	1-1/2 1-5/8	3/4	3-1/4	1-15/16	3-1/196	4	4-3/4	3/4	1-1/4	1-15/16
210	1-11/16 1-3/4	3/4	3-1/4	1-15/16	3-9/32	4	4-3/4	3/4	1-11/32	1-15/16
211	1-15/16 2	1	4	2-1/2	3-11/16	5-1/8	5-7/8	7/8	1-3/8	2-1/2
212	2-3/16 2-1/4	1-1/4	4	2-1/2	4-7/64	5-1/8	5-7/8	1	1-5/8	2-1/2
214	2-7/16 2-1/2 65mm	1-1/4 31.8	4-3/8 111.1	2-3/4 69.9	4-3/8 111.1	5-15/16 150.8	6-9/16 166.7	1-1/16 27.0	1-3/4 44.5	2-3/4 69.9
215	2-11/16	1-1/4	4-3/8	2-3/4	4-11/16	5-15/16	6-11/16	53/64	1-1/2	2-3/4
216	2-15/16	1-1/4	4-3/8	2-3/4	5	6-1/2	7-1/4	27/32	1-41/64	2-3/4

# + .010, -.020" +.25, -.50MM

FEATURES/BENEFITS PAGE B4-2	HOW TO ORDER/ NOMENCLATURE PAGE B4-4	SELECTION PAGE B4-5	DIMENSIONS DL INSERTS PAGE B4-54
--------------------------------	--	------------------------	--

# SELECTION/DIMENSIONS

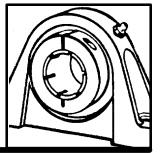

## D-LOK Ball Bearings

### DL NORMAL DUTY TOP ANGLE TAKE-UP BEARINGS

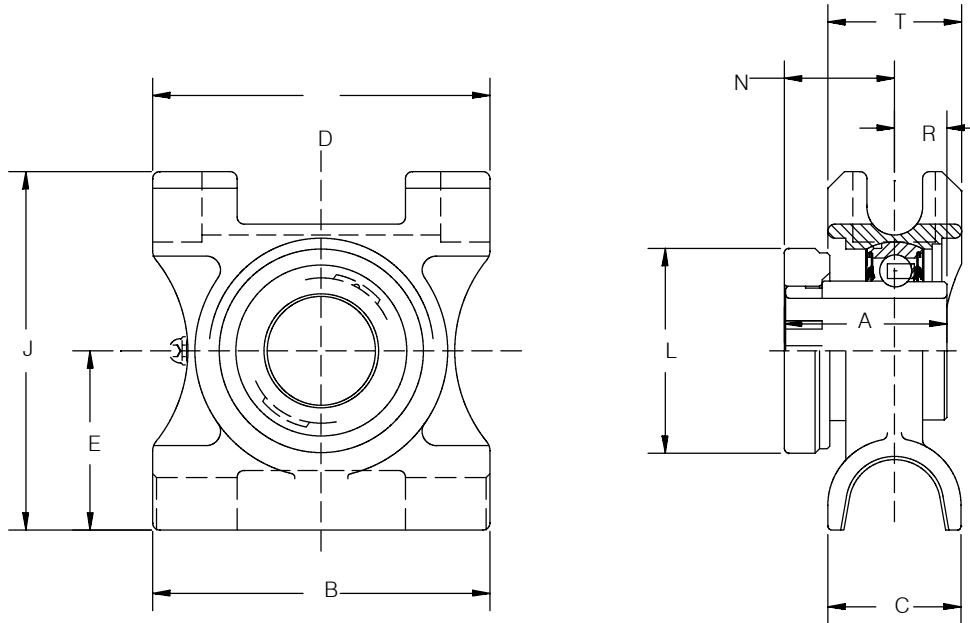

Series	Shaft Size	Part Number	Description	Weight lbs	Take-Up Frame Size	A	B	C
210	1-15/16 2	@	TP-DL-115 TP-DL-200	11.4 11.2	TP10	2-3/32	6-1/2	2-3/8
211	2 2-3/16	@	TP-DLM-200 TP-DL-203	13.7 13.2	TP20	2-1/4	7	2-1/2
212	2-1/4 2-7/16	@	TP-DLM-204 TP-DL-207	17.2 17.1	TP30	2-5/8	7-1/2	2-3/4
214	2-1/2 2-11/16	@	TP-DLM-208 TP-DL-211	22.5 22.3	TP40	2-13/16	8-1/2	2-1/2
215	2-15/16	@	TP-DL-215	22.4	TP40	2-21/64	8-1/2	2-1/2

@ Assembled to order

Series	Shaft Size	D	E	J	L	N	R	T
210	1-15/16 2	6	3-1/4	6-3/8	3-9/32	1-11/32	3/4	2-3/8
211	2 2-3/16	6-3/4	3-3/8	6-7/8	3-11/16	1-3/8	7/8	2-3/8
212	2-1/4 2-7/16	7	3-1/2	7-7/16	4-7/64	1-5/8	1	2-3/4
214	2-1/2 2-11/16	8	4	8-5/16	4-3/8	1-3/4	1-1/16	2-3/4
215	2-15/16	8	4	8-5/16	4-11/16	1-1/2	53/64	2-3/4

FEATURES/BENEFITS PAGE B4-2	HOW TO ORDER/ NOMENCLATURE PAGE B4-4	SELECTION PAGE B4-5	DIMENSIONS DL INSERTS PAGE B4-54
--------------------------------	--	------------------------	--

# SELECTION/DIMENSIONS

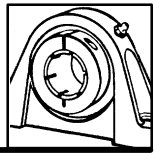

## D-LOK Ball Bearings

### DLM MEDIUM DUTY TOP ANGLE TAKE-UP BEARINGS

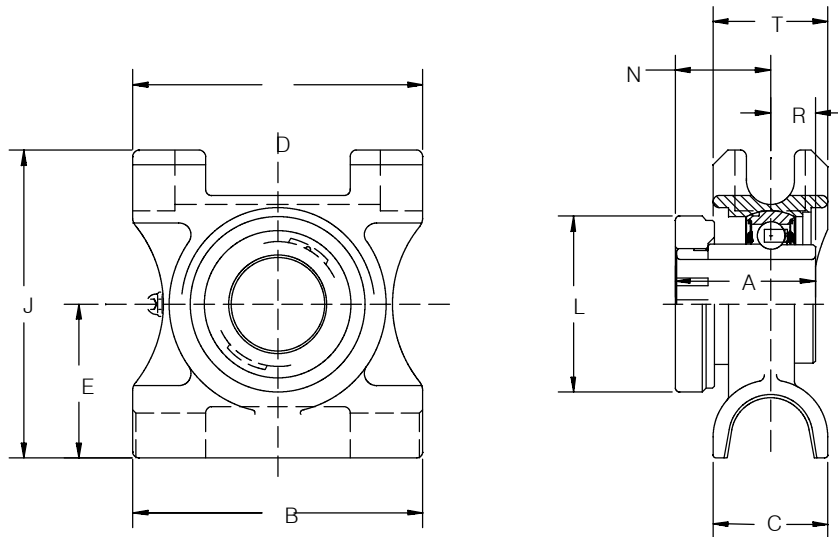

Series	Shaft Size	Part Number	Description	Weight lbs	Take-Up Frame Size	A	B	C
210	1-11/16	@	TP-DLM-111	11.6	TP10	2-3/32	6-1/2	2-3/8
	1-3/4	@	TP-DLM-112	11.2				
211	1-15/16	@	TP-DLM-115	14.0	TP20	2-1/4	7	2-1/2
	2	@	TP-DLM-200	13.7				
212	2-3/16	@	TP-DLM-203	17.4	TP30	2-5/8	7-1/2	2-3/4
	2-1/4	@	TP-DLM-204	17.2				
214	2-7/16	@	TP-DLM-207	22.9	TP40	2-13/16	8-1/2	2-1/2
	2-1/2	@	TB-DLM-208	22.5				
215	2-11/16	@	TP-DLM-211	26.2	TP40	2-21/64	8-1/2	2-1/2
216	2-15/16	@	TP-DLM-215	31.0	TP50	2-31/64	9-1/2	2-3/4
218	3-7/16	@	TP-DLM-307	41.4	TP50	2-21/32	11	3-1/8

@ Assembled to order

Series	Shaft Size	D	E	J	L	N	R	T
210	1-11/16	6	3-1/4	6-3/8	3-9/32	1-11/32	3/4	2-3/8
	1-3/4							
211	1-15/16	6-3/4	3-3/8	6-7/8	3-11/36	1-3/8	7/8	2-3/8
	2							
212	2-3/16	7	3-1/2	7-7/16	4-7/64	1-5/8	1	2-3/4
	2-1/4							
214	2-7/16	8	4	8-5/16	4-3/8	1-3/4	1-1/16	2-3/4
	2-1/2							
215	2-11/16	8	4	8-5/16	4-11/16	1-1/2	53/64	2-3/4
216	2-15/16	9	4-1/2	9-5/8	5	1-41/64	27/32	3-1/8
218	3-7/16	10-1/2	5-1/2	11	5-1/2	1-47/64	59/64	3-1/8

FEATURES/BENEFITS PAGE B4-2	HOW TO ORDER/ NOMENCLATURE PAGE B4-4	SELECTION PAGE B4-5	DIMENSIONS DL INSERTS PAGE B4-54
--------------------------------	--	------------------------	--

# SELECTION/DIMENSIONS

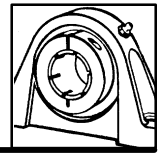

## D-LOK Ball Bearings

### DL NORMAL DUTY BEARING INSERTS

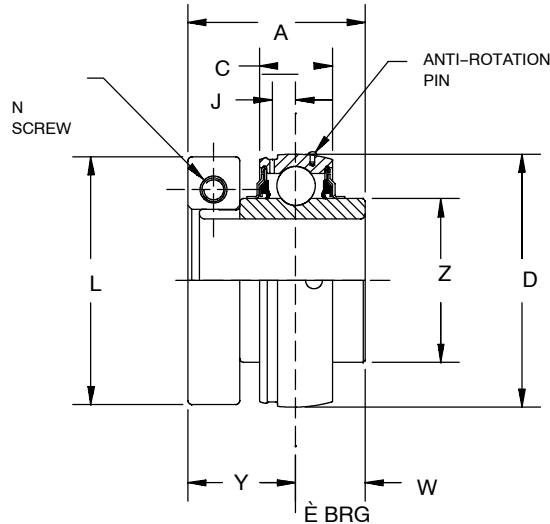

Series	Shaft Size	Standard Insert		Corrosion Resistant Insert	
		Part Number	Description	Part Number	Description
204	3/4 20mm	128646 126629	INS-DL-012 INS-DL-20M	126685 126693	INS-DL-012-CR INS-DL-20M-CR
205	7/8 15/16 1 25mm	128684 128647 128648 126630	INS-DL-014 INS-DL-015 INS-DL-100 INS-DL-25M	@ @ 126686 126694	INS-DL-014-CR* INS-DL-015-CR* INS-DL-100-CR INS-DL-25M-CR
206	1-1/8 1-3/16 1-1/4 30mm	128649 128650 128651 126631	INS-DL-102 INS-DL-103 INS-DL-104S INS-DL-30M	@ 126687 126688 126695	INS-DL-102-CR* INS-DL-103-CR INS-DL-104S-CR INS-DL-25M-CR
207	1-1/4 1-3/8 1-7/16 35mm	128652 128653 128654 126632	INS-DL-104 INS-DL-106 INS-DL-107 INS-DL-35M	126689 @ 052093 126696	INS-DL-104-CR INS-DL-106-CR* INS-DL-107-CR INS-DL-35M-CR
208	1-1/2 40mm	128655 126633	INS-DL-108 INS-DL40M	126690 126697	INS-DL-108-CR INS-DL-40M-CR
209	1-5/8 1-11/16 1-3/4 45mm	128656 128657 128658 126634	INS-DL-110L INS-DL-111 INS-DL-112 INS-DL-45M	@ 126691 @ 126698	INS-DL-110L-CR* INS-DL-111-CR INS-DL-112-CR* INS-DL-45M-CR
210	1-15/16 2 50mm	128659 128660 126635	INS-DL-115 INS-DL-200 INS-DL-50M	126692 053986 126699	INS-DL-115-CR INS-DL-200-CR* INS-DL-50M-CR
211	2 2-3/16 55mm	128661 128663 126636	INS-DLM-200 INS-DL-203 INS-DL-55M	@ @ @	INS-DLM-200-CR* INS-DL-203-CR* INS-DL-55M-CR*
212	2-1/4 2-7/16 60mm	128664 128666 126637	INS-DLM-204 INS-DL-207 INS-DL-60M	@ @ @	INS-DLM-204-CR* INS-DL-207-CR* INS-DL-60M-CR*
214	2-1/2 2-11/16 70mm	128677 128667 126638	INS-DLM-208 INS-DL-211 INS-DL-70M	@ @ @	INS-DLM-208-CR* INS-DL-211-CR* INS-DL-70M-CR*
215	2-15/16	@	INS-DL-215	@	INS-DL-215-CR*

@Assembled to order.

\* 20 piece minimum order

FEATURES/BENEFITS PAGE B4-2	HOW TO ORDER/ NOMENCLATURE PAGE B4-4	SELECTION PAGE B4-5	MODIFICATIONS PAGE B4-60
--------------------------------	--	------------------------	-----------------------------

# SELECTION/DIMENSIONS

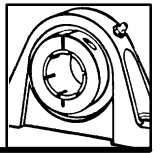

## D-LOK Ball Bearings

### DL NORMAL DUTY BEARING INSERTS

Series	Shaft Size	Weight lbs. kg.	A	C	D	J	L	N Screw (UNF)	W	Y	Z
204	3/4 20mm	0.6 0.3	1-9/32 32.5	0.5906 15.0	1.8504 47.0	0.152 3.9	1-45/64 43.3	No.8 M4	1/2 12.7	25/32 19.8	1-1/8 28.6
205	7/8 15/16	0.8 0.8	1-7/16	0.5906	2.0472	0.152	2	No. 10	9/16	7/8	1-21/64
	1 25mm	0.8 0.4	36.5	15.0	52.0	3.9	50.8	M5	14.3	22.2	33.7
206	1-1/8	1.2	1-5/8	0.7087	2.4409	0.190	2-7/32	No. 10	9/16	1	1-37/64
	1-3/16	1.2									
	1-1/4 30mm	1.1 0.6	39.7	18.0	62.0	4.8	56.4	M5	14.3	25.4	40.1
207	1-1/4	1.8	1-3/4	0.7480	2.8346	0.202	2-11/16	1/4	11/16	1-1/16	1-27/32
	1-3/8	1.8									
	1-7/16 35mm	1.7 0.8	44.5	019.0	72.0	5.1	68.3	M6	17.5	27.0	46.8
208	1-1/2 40mm	2.2 1.0	2 50.8	0.8661 22.0	3.1496 80.0	0.224 5.7	2-25/32 70.6	1/4 M6	3/4 19.1	1-1/4 31.8	2-3/64 52.0
	1-5/8	2.5	2	0.8661	3.3465	0.248	3-1/16	1/4	3/4	1-1/4	2-7/32
209	1-11/16	2.5									
	1-3/4	2.5									
	45mm	1.2	50.8	22.2	85.8	6.4	78.5	M6	19.1	31.8	56.9
210	1-15/16	3.0	2-3/32	0.8661	3.5433	0.248	3-9/32	1/4	3/4	1-11/32	2-7/16
	2	3.0									
	50mm	1.4	53.2	22.0	90.0	6.3	83.3	M6	19.1	34.1	61.9
211	2	3.4	2-1/4	0.9449	3.9370	0.267	3-11/16	5/16	7/8	1-3/8	2-23/32
	2-3/16	3.4									
	55mm	1.6	57.2	24.0	100.0	6.8	93.7	M8	22.2	34.9	69.1
212	2-1/4	4.8	2-5/8	1.0240	4.3307	0.250	4-7/64	5/16	1	1-5/8	2-31/32
	2-7/16	4.8									
	60mm	2.2	66.7	26.0	110.0	6.4	104.4	M8	25.4	41.3	75.4
214	2-1/2	5.4	2-13/16	1.1020	4.9213	0.265	4-3/8	5/16	1-1/16	1-3/4	3-5/16
	2-11/16	5.0									
	70mm	2.5	71.4	28.0	125.0	6.7	111.1	M8	27.0	44.5	84.1
215	2-15/16	5.9	2-21/64	1.1420	5.1181	0 .265	4-11/16	5/16	53/64	1-1/23	3-5/8

MODIFICATIONS  
PAGE B4-60

# SELECTION/DIMENSIONS

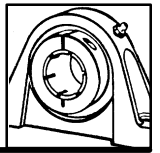

## D-LOK Ball Bearings

### DLH-E EXPANSION AND DLH NON-EXPANSION NORMAL DUTY BEARING INSERTS

#### Non-Expansion

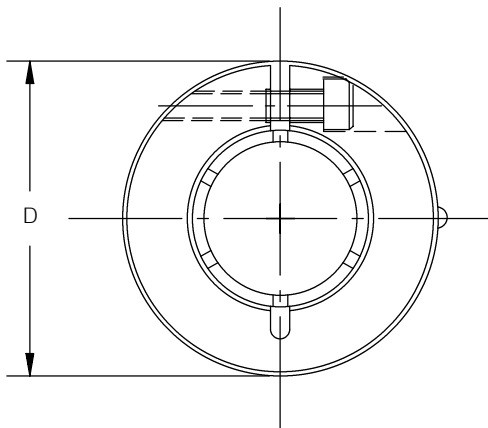

N SCREW

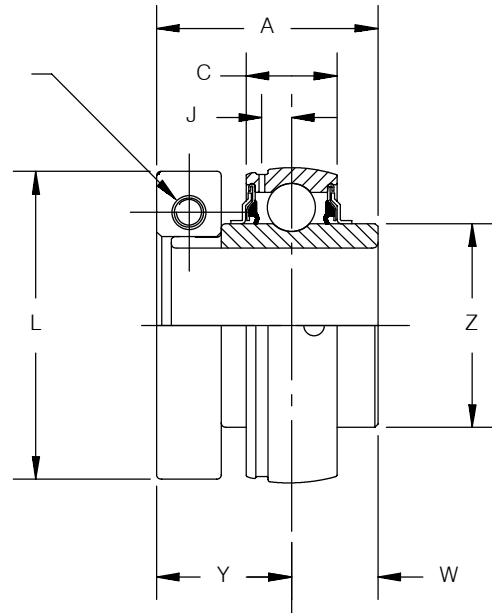

#### Expansion

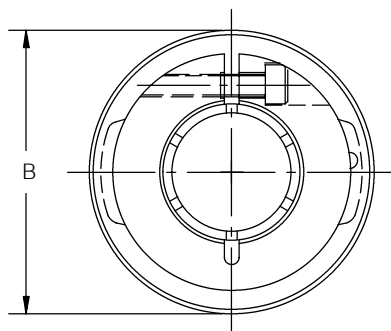

N SCREW

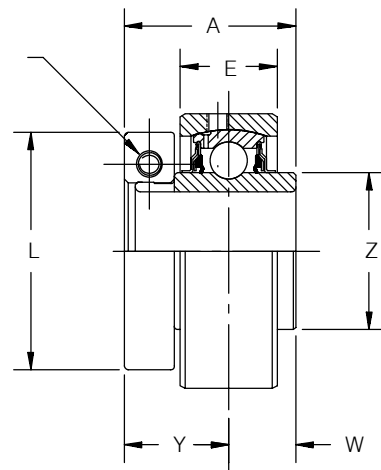

Q BRG

FEATURES/BENEFITS PAGE B4-2	HOW TO ORDER/ NOMENCLATURE PAGE B4-4	SELECTION PAGE B4-5	
--------------------------------	--	------------------------	--



# SELECTION/DIMENSIONS

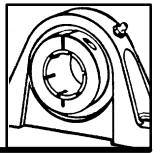

## D-LOK Ball Bearings

### DLH-E EXPANSION AND DLH NON-EXPANSION NORMAL DUTY BEARING INSERTS

Series	Shaft Size	Expansion Insert		Non-Expansion Insert		Weight Expansion lbs	Weight Non-Expansion lbs
		Part Number	Description	Part Number	Description		
206	1	@	INS-DLMH-100-E	@	INS-DLMH-100	1.9	1.2
	1-1/8	@	INS-DLH-102-E	@	INS-DLH-102		
	1-3/16	<b>126485</b>	INS-DLH-103-E	<b>126480</b>	INS-DLH-103		
	1-1/4	@	INS-DLH-104S-E	@	INS-DLH-104S		
207	1-3/16	@	INS-DLMH-103-E	@	INS-DLMH-103	2.6	1.8
	1-1/4	@	INS-DLH-104-E	@	INS-DLH-104		
	1-3/8	<b>126486</b>	INS-DLH-106-E	<b>126481</b>	INS-DLH-106		
	1-7/16	<b>126486</b>	INS-DLH-107-E	<b>126481</b>	INS-DLH-107		
210	1-11/16	@	INS-DLMH-111-E	@	INS-DLMH-111	4.5	3.0
	1-3/4	@	INS-DLMH-112-E	@	INS-DLMH-112		
	1-15/16	<b>126487</b>	INS-DLH-115-E	<b>126482</b>	INS-DLH-115		
	2	@	INS-DLH-200-E	@	INS-DLH-200		
211	1-15/16	@	INS-DLMH-115-E	@	INS-DLMH-115	5.3	3.4
	2	@	INS-DLMH-200-E	@	INS-DLMH-200		
	2-3/16	<b>126488</b>	INS-DLH-203-E	<b>126483</b>	INS-DLH-203		
212	2-3/16	@	INS-DLMH-203-E	@	INS-DLMH-203	7.4	4.8
	2-1/4	@	INS-DLMH-204-E	@	INS-DLMH-204		
	2-7/16	<b>126489</b>	INS-DLH-207-E	<b>126484</b>	INS-DLH-207		

@ Assembled to order

Series	Shaft Size	A	B	C	D	E	J	L	N Screw (UNF)	W	Y	Z
206	1	1-9/16	2.875	0.7087	2.4409	15/16	0.190	2-7/32	No. 10	9/16	1	1-37/64
	1-1/8											
	1-3/16											
	1-1/4											
207	1-3/16	1-3/4	3.272	0.7480	2.8346	1	0.202	2-11/16	1/4	11/16	1-1/16	1-27/32
	1-1/4											
	1-3/8											
	1-7/16											
210	1-11/16	2-3/32	4.000	0.8661	3.5433	1-13/32	0.248	3-9/32	1/4	3/4	1-11/32	2-7/16
	1-3/4											
	1-15/16											
	2											
211	1-15/16	2-1/4	4.475	0.9449	3.9370	1-7/16	0.267	3-11/16	5/16	7/8	1-3/8	2-23/32
	2											
	2-3/16											
212	2-3/16	2-5/8	5.035	1.0240	4.3307	1-5/8	0.250	4-7/64	5/16	1	1-5/8	2-31/32
	2-1/4											
	2-7/16											

MODIFICATIONS PAGE B4-60			
-----------------------------	--	--	--

# SELECTION/DIMENSIONS

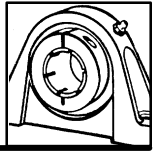

## D-LOK Ball Bearings

### DLM MEDIUM DUTY BEARING INSERTS

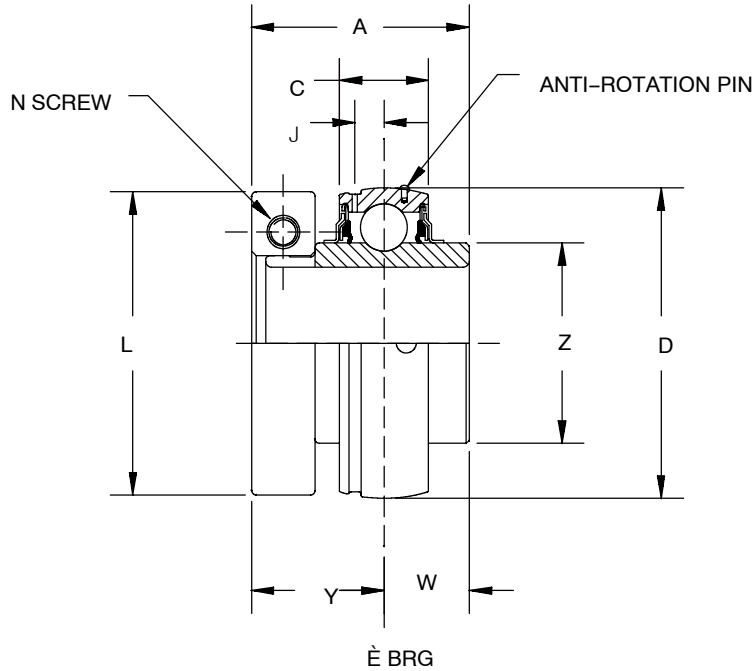

Series	Shaft Size	Part Number	Description
206	1	128668	INS-DLM-100
207	1-3/16	128669	INS-DLM-103
	1-1/4	128652	INS-DL-104
208	1-7/16	128670	INS-DLM-107
	1-1/2*	128655	INS-DL-108
	35mm	126644	INS-DLM-35M
209	1-1/2	128671	INS-DLM-108
210	1-11/16	128672	INS-DLM-111
	1-3/4	128673	INS-DLM-112
211	1-15/16	128674	INS-DLM-115
	2	128661	INS-DLM-200
212	2-3/16	128675	INS-DLM-203
	2-1/4	128664	INS-DLM-204
214	2-7/16	128676	INS-DLM-207
	2-1/2	128677	INS-DLM-208
	65mm	126645	INS-DLM-65M
215	2-11/16	@	INS-DLM-211
216	2-15/16	@	INS-DLM-215
218	3-7/16	@	INS-DLM-307

@ Assembled to order

FEATURES/BENEFITS PAGE B4-2	HOW TO ORDER/ NOMENCLATURE PAGE B4-4	SELECTION PAGE B4-5	MODIFICATIONS PAGE B4-60
--------------------------------	--	------------------------	-----------------------------

# SELECTION/DIMENSIONS

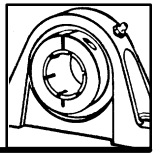

## D-LOK Ball Bearings

### DLM MEDIUM DUTY BEARING INSERTS

Series	Shaft Size	Weight lbs. kg.	A	C	D	J
206	1	1.80	1-9/16	0.7087	2.4409	0.190
207	1-3/16 1-1/4	2.20 1.70	1-3/4	0.748	2.8346	0.202
208	1-7/16 1-1/2* 35mm	2.50 2.20 1.0	2 50.8	0.8661 22.0	3.1496 80.0	0.224 5.7
209	1-1/2	3.00	2	0.8661	3.3465	0.248
210	1-11/16 1-3/4	3.00 3.00	2-3/32	0.8661	3.5433	0.248
211	1-15/16 2	3.40 3.30	2-1/4	0.9449	3.9370	0.267
212	2-3/16 2-1/4	4.90 4.80	2-5/8	1.024	4.3307	0.250
214	2-7/16 2-1/2 65mm	5.50 5.40 2.5	2-13/16 71.4	1.102 28.0	4.9213 125.0	0.265 6.7
215	2-11/16	5.89	2-21/64	1.142	5.1181	0.265
216	2-15/16	6.94	2-31/64	1.181	5.5118	0.285
218	3-7/16	8.75	2-21/32	1.340	6.2992	0.300

\* Piloted flange only.

Series	Shaft Size	L	N Screw (UNF)	W	Y	Z
206	1	2-7/32	No. 10	5/8	15/16	1-37/64
207	1-3/16 1-1/4	2-11/16	1/4	11/16	1-1/16	1-27/32
208	1-7/16 1-1/2* 35mm	2-25/32 70.6	1/4 M6	3/4 19.1	1-1/4 31.8	2-3/64 52.0
209	1-1/2	3-1/16	1/4	3/4	1-1/4	2-7/32
210	1-11/16 1-3/4	3-9/32	1/4	3/4	1-11/32	2-7/16
211	1-15/16 2	3-11/16	5/16	7/8	1-3/8	2-23/32
212	2-3/16 2-1/4	4-7/64	5/16	1	1-5/8	2-31/32
214	2-7/16 2-1/2 65mm	4-3/8 111.1	5/16 M8	1-1/16 27.0	1-3/4 44.5	3-5/16 84.1
215	2-11/16	4-11/16	5/16	53/64	1-1/2	3-5/8
216	2-15/16	5	3/8	27/32	1-41/64	3-53/64
218	3-7/16	5-1/2	3/8	59/64	1-47/64	4-23/64

MODIFICATIONS  
PAGE B4-60

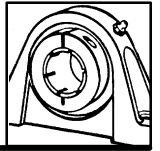

## D-LOK Ball Bearings

### LUBRICANTS

DODGE ball bearings are factory lubricated with Shell Alvania #2 lubricant. For applications where extreme ambient temperatures or speeds are anticipated or environmental considerations require a different lubricant, DODGE has a wide variety of lubricants available. Special lubricant options usually require set-up charges and premiums.

### SEALS

The PROGUARD PLUS seal is a highly effective positive contact land riding seal with flingers pressed on to each side of the inner ring offering added protection from high pressure wash down or extreme contamination. For high speeds or where seal drag would be an impediment, a labyrinth seal is available.

### HIGH TEMPERATURE

DODGE high temperature bearings are designed to operate in temperatures from 225°F (108°C) to 400°F (205°C). The bearings have adjusted internal clearances, labyrinth seals, retainers, and lubricants to meet the temperature needs of the application. To insure proper replacement, the bearing is identified by a six digit part number etched on a stainless steel nameplate riveted to the housing. The part number identifies the specific feature of the bearing. High temperature bearings are factory assembled to order and are available at extra cost. Consult DODGE Engineering for application assistance at (864) 297-4800 or fax (864) 281-2317.

### AIR HANDLING

Industrial fans and blowers generally operate at high speeds with bearing requirements of long life and quiet operation. DODGE stocks DL and DLM air handling pillow blocks that are specifically designed to meet the requirements of the Air Handling Industry. Other sizes and housing configurations can be supplied on a made/assembled to order basis. These bearings are 100% inspected for quiet operation and are recommended for fan and blower operations.

### COATINGS

For extra corrosion resistance, a variety of housing finishes are available. Special coatings include Nickel/chrome plating or polymer housed. These coatings conform to U.S.D.A. and F.D.A. requirements. DL and DLM inserts can be supplied with a thin dense chrome finish to the inner and outer rings, stainless steel balls and set-screws, nickel plated flingers as well as F.D.A. lubricant.

### OTHER MODIFICATIONS

For applications requiring modifications not listed, we encourage you to contact our Customer Order Engineering Department at (864) 297-4800 or fax (864) 281-2317.

FEATURES/BENEFITS PAGE B4-2	HOW TO ORDER NOMENCLATURE PAGE B4-4	SELECTION PAGE B4-5	RELATED PRODUCTS COATINGS PAGE 102
--------------------------------	---	------------------------	--

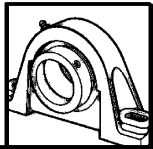

# RELATED PRODUCTS

## DODGE Ball Bearing End Covers\*

Series	Pillow Blocks Std, U, B	Tapped Base PB	2-Bolt Flange	4-Bolt Flange	Piloted Flange (FC)	Flanged Bracket	Narrow Slot Take-Up	Wide Slot Take-Up
203	X		X	X		X		
204	X	X	X	X		X	X	X
205	X	X	X	X		X	X	X
206	X	X	X	X	@	X	X	X
207	X	X	X	X	@	X	X	X
208	X	X	X	X	@		X	X
209	X	X	X	X	@		X	X
210	X	X	X	X	@	X	X	X
211	X	X	X	X	NA		X	X
212	X		X	X	NA		X	X
214	X			X	NA			X
215	X			X				X
216	X			X	X			X
218	X			X	X			

\* = Will not fit LF, LFT, SCHB, HNCR & CLY

NA = Will not fit

@ = Some modification required

X = Will fit

HOW TO ORDER/ NOMENCLATURE PAGE B3-4	DIMENSIONS PAGE B4-10		
--	--------------------------	--	--

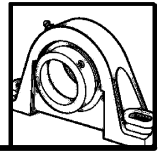

## RELATED PRODUCTS

### D-LOK Ball Bearings

#### BALL BEARING END COVERS FOR PILLOW BLOCKS & TAPPED BASE UNITS

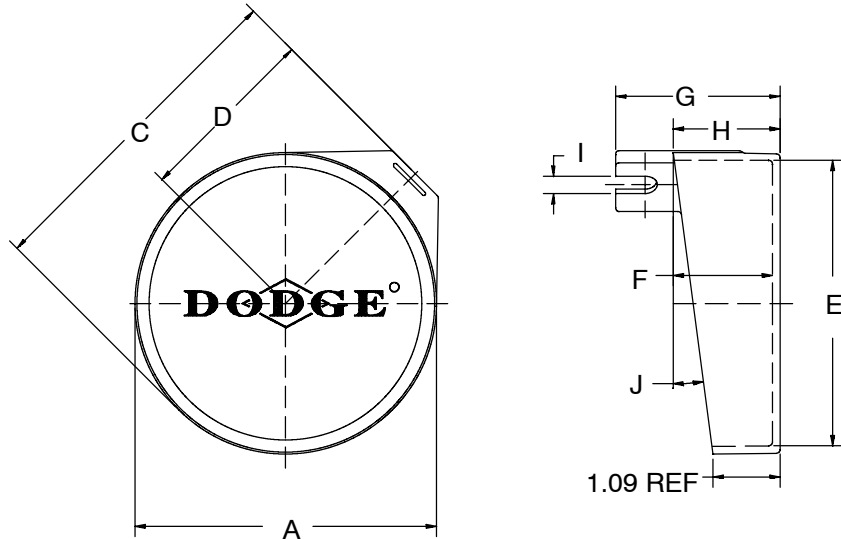

Series	Shaft Size*		Part Number	Description
	SC, VSC, DL, SXR, SXV	SCM, DLM, SCH, SXRH, DLH		
203	1/2 & 5/8 17mm	-----	128200	EC-203-P
204	1/2 - 3/4 20mm	-----	128202	EC-204-P
205	7/8 - 1 25mm	-----	128204	EC-205-P
206	1-1/16 - 1-1/4 30mm	----- 25mm	128206	EC-206-P
207	1-1/4 - 1-7/16 35mm	1-3/6 & 1-1/4 30mm	128208	EC-207-P
208	1-1/2 - 1-5/8 40mm	1-7/16 35mm	128210	EC-208-P
209	1-5/8 - 1-3/4 45mm	1-1/2 40mm	128212	EC-209-P
210	1-15/16 & 2 50mm	1-11/16 & 1-3/4 45mm	128214	EC-210-P
211	2 - 2-1/4 55mm	1-15/16 & 2 50mm	128216	EC-211-P
212	2-1/4 - 2-7/16 60mm	2-3/16 - 2-1/4 55mm	128218	EC-212-P

\*NOTE: SCH, SXRH, and DLH use the next larger end cover. E.g. A P2B-DLH-103 would use a EC-207-P.

HOW TO ORDER/ NOMENCLATURE PAGE B3-4	DIMENSIONS PAGE B4-10		
--	--------------------------	--	--

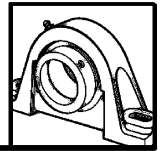

# RELATED PRODUCTS

## D-LOK Ball Bearings

### BALL BEARING END COVERS FOR PILLOW BLOCKS & TAPPED BASE UNITS

Series	Shaft Size*		Weight lbs gm	A	B	C	D	E	F	G	H	I	J
	SC, VSC, DL, SXR, SXV	SCM, DLM, SCH, SXRH, DLH											
203	1/2 & 5/8 17mm	-----	.02 9	1-25/32 45.2	1-43/64 42.4	2-7/64 53.6	1-3/32 27.7	1-41/64 41.7	49/64 19.6	1-29/64 37.1	29/32 22.9	1/4 6.4	9°
204	1/2 - 3/4 20mm	-----	.03 14	2-3/64 52.1	1-27/32 46.7	2-37/64 65.3	1-19/64 33.0	1-55/64 47.2	1-1/64 25.7	1-49/64 45.0	1-5/32 29.5	5/16 7.9	11°
205	7/8 - 1 25mm	-----	.05 23	2-3/8 60.2	2-3/16 55.6	2-13/16 71.4	1-3/16 35.1	2-5/32 54.9	1-1/16 26.9	1-7/8 47.8	1-7/32 31.0	11/32 8.6	9°
206	1-1/16 - 1-1/4 30mm	----- 25mm	.07 34	2-47/64 69.3	2-17/32 64.3	3-21/64 84.3	1-45/64 43.2	2-1/2 63.5	1-15/64 31.5	2-5/32 54.9	1-13/32 35.6	23/64 8.9	9°
207	1-1/4 - 1-7/16 35mm	1-3/16 & 1-1/4 30mm	.11 48	3-1/4 82.6	3 76.2	3-51/64 96.3	1-29/32 48.5	3-1/64 76.7	1-5/16 33.3	2-11/32 59.4	1-31/64 37.6	3/8 9.4	7° 30'
208	1-1/2 - 1-5/8 40mm	1-7/16 35mm	.13 61	3-3/8 85.9	3-1/8 79.5	4 101.6	2-1/16 52.3	3-7/64 79.0	1-19/64 33.0	2-13/32 61.0	1-1/2 38.1	27/64 10.7	6°
209	1-5/8 - 1-3/4 45mm	1-1/2 40mm	.15 69	3-11/16 93.7	3-15/32 88.1	4-17/64 108.2	2-11/64 55.1	3-13/32 86.6	1-21/64 33.8	2-21/64 59.2	1-17/32 38.9	25/64 9.9	7°
210	1-15/16 & 2 50mm	1-11/16 & 1-3/4 45mm	.17 78	3-7/8 98.6	3-37/64 90.9	4-1/2 114.3	2-21/64 59.2	3-37/64 90.9	1-23/64 34.3	2-1/2 63.5	1-9/16 39.6	31/64 12.5	9°
211	2 - 2-1/4 55mm	1-15/16 & 2 50mm	.22 102	4-27/64 112.3	4 101.6	5-1/16 128.5	2-19/32 66.0	4-1/8 104.6	1-13/32 35.8	2-37/64 65.3	1-5/8 41.2	29/64 11.4	7°
212	2-1/4 - 2-7/16 60mm	2-3/16 - 2-1/4 55mm	.26 118	4-59/64 125.0	4-15/32 113.3	5-29/64 138.7	2-3/4 69.9	4-39/64 117.1	1-17/32 38.9	2-11/16 68.3	1-3/4 44.5	13/32 10.4	8°

\*NOTE: SCH, SXRH, and DLH use the next larger end cover. E.g. A P2B-DLH-103 would use a EC-207-P.

HOW TO ORDER/ NOMENCLATURE PAGE B3-4	DIMENSIONS PAGE B4-10		
--	--------------------------	--	--

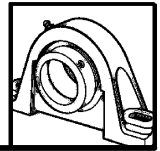

## RELATED PRODUCTS

### D-LOK Ball Bearings

BALL BEARING END COVERS FOR MOUNTED UNITS OTHER THAN PILLOW BLOCKS & TAPPED BASE UNITS

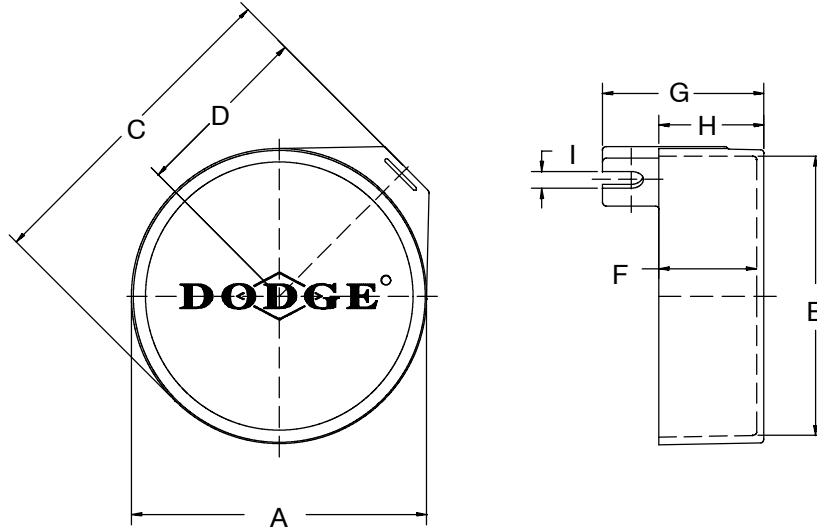

Series	Shaft Size*		Part Number	Description
	SC, VSC, DL, SXR, SXV	SCM & DLM		
203	1/2 & 5/8 17mm	-----	128201	EC-203-X
204	1/2 - 3/4 20mm	-----	128203	EC-204-X
205	7/8 - 1 25mm	-----	128205	EC-205-X
206	1-1/16 - 1-1/4 30mm	----- 25mm	128207	EC-206-X
207	1-1/4 - 1-7/16 35mm	1-3/6 & 1-1/4 30mm	128209	EC-207-X
208	1-1/2 - 1-5/8 40mm	1-7/16 35mm	128211	EC-208-X
209	1-5/8 - 1-3/4 45mm	1-1/2 40mm	128213	EC-209-X
210	1-15/16 & 2 50mm	1-11/16 & 1-3/4 45mm	128215	EC-210-X
211	2 - 2-1/4 55mm	1-15/16 & 2 50mm	128217	EC-211-X
212	2-1/4 - 2-7/16 60mm	2-3/16 - 2-1/4 55mm	128219	EC-212-X

\*NOTE: Above end covers will not fit the LF and LFT bearings

HOW TO ORDER/ NOMENCLATURE PAGE B3-4	DIMENSIONS PAGE B4-10		
--	--------------------------	--	--



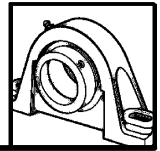

# RELATED PRODUCTS

## D-LOK Ball Bearings

BALL BEARING END COVERS FOR MOUNTED UNITS OTHER THAN PILLOW BLOCKS & TAPPED BASE UNITS

Series	Shaft Size*		Weight lbs gm	A	B	C	D	E	F	G	H	I
	SC, VSC, DL, SXR, SXV	SCM & DLM										
203	1/2 & 5/8 17mm	-----	0.02 10	1-51/64 45.5	1-43/64 42.4	2-13/64 56.1	1-3/16 30.2	1-41/64 41.7	51/64 20.3	1-29/64 37.1	15/16 23.9	1/4 6.4
204	1/2 - 3/4 20mm	-----	0.03 15	2-7/32 56.1	2 50.8	2-47/64 69.6	1-25/64 35.3	2-1/32 51.6	1-1/64 25.7	1-13/16 45.7	1-5/32 29.5	5/16 7.9
205	7/8 - 1 25mm	-----	0.05 24	2-3/8 60.2	2-3/16 55.6	3-3/64 77.2	1-19/32 40.6	2-5/32 54.9	1-1/64 25.7	1-53/64 46.5	1-11/64 29.7	11/32 8.6
206	1-1/16 - 1-1/4 30mm	----- 25mm	0.08 36	2-47/64 69.3	2-17/32 64.3	3-21/64 84.3	1-45/64 43.2	2-1/2 63.5	1-3/16 30.2	2-1/16 52.3	1-23/64 34.5	23/64 8.9
207	1-1/4 - 1-7/16 35mm	1-3/6 & 1-1/4 30mm	0.12 53	3-1/4 82.6	3 76.2	3-27/32 97.5	1-31/32 50.0	3-1/64 76.7	1-11/32 34.5	2-11/32 59.4	1-17/32 38.9	3/8 9.4
208	1-1/2 - 1-5/8 40mm	1-7/16 35mm	0.14 64	3-3/8 85.9	3-1/8 79.5	4 101.6	2-1/16 52.3	3-7/64 79.0	1-19/64 33.0	2-13/32 61.0	1-1/2 38.1	27/64 10.7
209	1-5/8 - 1-3/4 45mm	1-1/2 40mm	0.16 73	3-11/16 93.7	3-15/32 88.1	4-17/64 108.2	2-11/64 55.1	3-13/32 86.6	1-23/64 34.3	2-21/64 59.2	1-17/32 38.9	25/64 9.9
210	1-15/16 & 2 50mm	1-11/16 & 1-3/4 45mm	0.18 82	3-7/8 98.6	3-37/64 90.9	4-1/2 114.3	2-21/64 59.2	3-9/16 90.9	1-23/64 34.3	2-33/64 63.8	1-9/16 39.6	31/64 12.4
211	2 - 2-1/4 55mm	1-15/16 & 2 50mm	0.24 108	4-27/64 112.3	4 101.6	5-1/16 128.5	2-19/32 66.0	4-1/8 104.7	1-29/64 36.8	2-37/64 65.3	1-21/32 42.2	29/64 11.4
212	2-1/4 - 2-7/16 60mm	2-3/16 - 2-1/4 55mm	0.27 124	4-59/64 125.0	4-15/32 113.3	5-15/32 138.7	2-3/4 69.9	4-39/64 117.1	1-35/64 39.1	2-11/16 68.3	1-3/4 44.5	13/32 10.4

\*NOTE: Above end covers will not fit the LF and LFT bearings

HOW TO ORDER/ NOMENCLATURE PAGE B3-4	DIMENSIONS PAGE B4-10		
--	--------------------------	--	--

# RELATED PRODUCTS

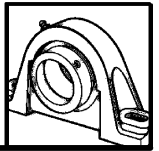

## D-LOK Ball Bearings

BALL BEARING END COVERS FOR MOUNTED UNITS 214 SERIES & LARGER

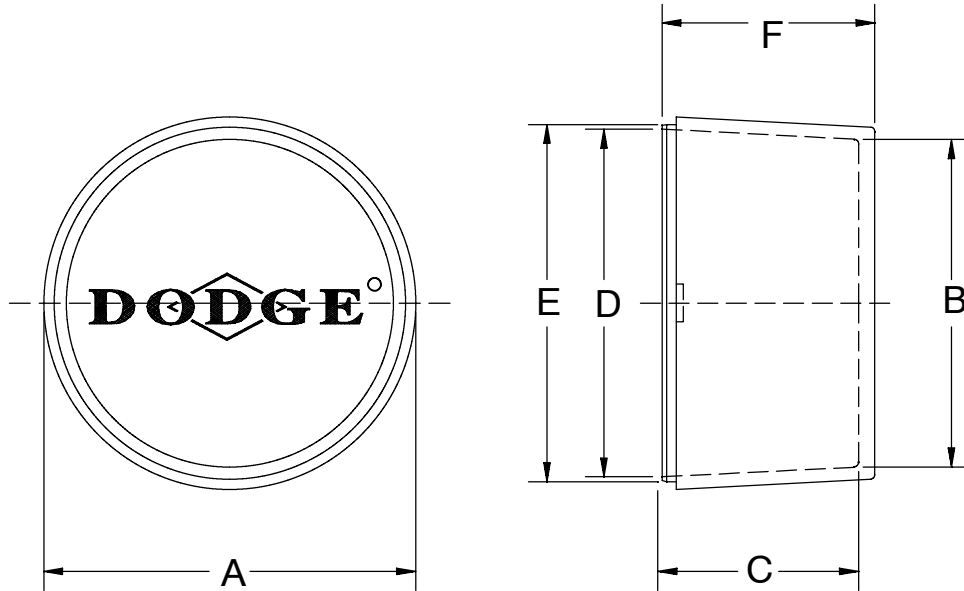

Series	Shaft Size		Part Number	Description
	SC, VSC, DL, SXR, SXV, SCH, SXRH, DLH	SC, VSC, DL, SCM & DLM		
214	2-1/2 & 2-11/16 70mm	2-7/16 & 2-1/2 65mm	128220	EC-214
215	2-15/16 75mm	2-11/16 70mm	128221	EC-215
216	-----	2-15/16 & 3 75mm	128222	EC-216
218	-----	3-7/16 & 3-1/2 85mm	128223	EC-218

HOW TO ORDER/ NOMENCLATURE PAGE B3-4	DIMENSIONS PAGE B4-10		
--	--------------------------	--	--

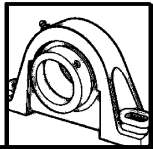

# RELATED PRODUCTS

## D-LOK Ball Bearings

### BALL BEARING END COVERS FOR MOUNTED UNITS 214 SERIES & LARGER

Series	Weight lbs gm	A	B	C	D	E	F
214	0.33 151	4-15/16 125.5	4-7/16 112.8	2-39/64 66.3	4-39/64 117.1	4.741/4.737 120.4/120.3	2-53/64 71.9
215	0.36 164	5-3/32 129.3	4-49/64 120.9	2-29/64 62.5	4-3/4 120.7	4.944/4.940 125.6/125.5	2-7/8 72.9
216	0.44 201	5-9/16 141.2	5-15/64 132.8	2-47/64 69.6	5-13/64 132.1	5.350/5.346 135.9/135.8	2-63/64 75.7
218	0.57 257	6-5/16 160.3	5-29/32 149.9	2-27/32 72.1	5-15/16 150.6	6.100/6.096 154.9/154.8	3-3/32 78.5

HOW TO ORDER/ NOMENCLATURE PAGE B3-4	DIMENSIONS PAGE B4-10		
--	--------------------------	--	--

# NOTES

---

