

10 ANGULAR CONTACT PRESSED BEARING

Part No.	Dimension (mm)			Load Ratings (kgf)				Weight Net(g)	Qty/ Carton	Remarks
				Thrust		Radial				
	D	d	B	Cr	Cor	Cr	Cor			
PCL230	23.0	11.0	7.0	26	41	17	12	12.08	500	
PCL238	23.8	12.6	6.7	27	48	19	14	10.21	500	
PCL286N	28.6	12.7	8.7	60	88	38	27	21.35		
PCL394	39.4	13.5	14.5	222	254	119	77	77.72	400	
PCL430B	42.9	22.2	11.9	122	221	81	67	56.63	500	
PCL701	70.1	38.1	17.9	501	1092	343	332	237.19	130	

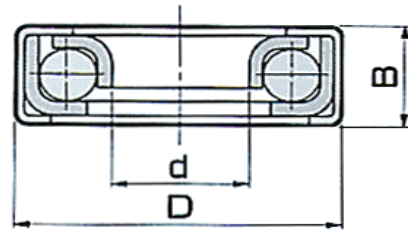

FUJI SEISAKUSHO CO. LTD.

Minamisenba No.2 Daiji Bldg.

No. 1-10, 3-chome, Minamisenba

Chuo-ku, Osaka 542-0081 Japan

Phone : 81-6-6243-3771 / Fax : 81-6-6243-6445 / e-mail : info@fuji-bearing.com