

3 PRESSED RADIAL BEARING

Part No.	Dimension (mm)				Type	Load Rat.(kgf)		Weight Net(g)	Q'ty/ Carton	Remarks
	D	d	B	L		Cr	Cor			
PCO816	16.0	8.2	5.2	10.2	3	8	6	8.58	1,000	
PCM617L	17.0	6.2	6.0	8.0	2	34	20	7.76	5,000	
PCO100-SK	20.4	8.0	6.5	9.5	3	31	20	11.24		
PCA822-D	22.0	8.0	7.0	7.0	1	34	21	12.94	1,000	
PCM1228	28.0	12.0	8.0	8.0	2	32	22	22.37	1,000	
PCO1228	28.7	12.7	9.6	10.6	3	54	38	29.06	500	
PCO1228-RS	28.7	12.7	9.6	10.6	3	54	38	28.00		Single Seal
PCM1030	30.0	10.0	9.0	9.0	2	44	31	31.83	500	
PCO120-8.1	32.0	8.1	7.2	14.0	3	72	56	43.83		
PCO120F	32.0	10.1	7.2	14.0	3	72	56	40.83		
PCM1232	32.0	12.0	10.0	10.0	2	46	35	38.60	500	
PCO120Y	32.0	12.1	7.2	14.0	3	72	56	36.84	300	
PCO120	32.0	14.1	7.2	14.0	3	72	56	32.48		
PCO1532SUS	32.0	15.0	9.0	9.0	3	18	14	36.74	1,000	All Stainless Steel
PCO120-15.1	32.0	15.1	7.2	14.0	3	72	56	29.33		
PCO120S	32.0	11.8*	7.2	14.0	3	80	60	36.69		HEX Bore
PCM1535	35.0	15.0	11.0	11.0	2	62	51	49.67	500	
PCM1740	40.0	17.0	12.0	12.0	2	100	81	67.87	300	
PCM2047	47.0	20.0	14.0	14.0	2	122	97	102.59	300	
PCM508C	50.8	25.4	12.7	15.9	2	158	143	126.71		
PCM2552	52.0	25.0	15.0	15.0	2	138	125			

* shows dimension of the opposite side

Type 1

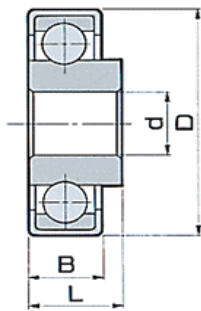

Type 2

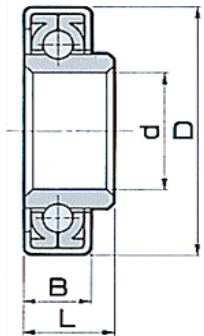

Type 3

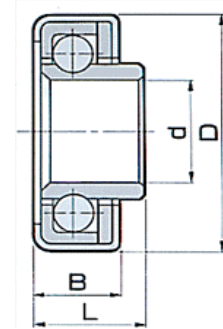

FUJI SEISAKUSHO CO. LTD.

Minamisenba No.2 Daiji Bldg.
 No. 1-10, 3-chome, Minamisenba
 Chuo-ku, Osaka 542-0081 Japan
 Phone : 81-6-6243-3771 / Fax : 81-6-6243-6445 / e-mail : info@fuji-bearing.com