

# C BEARING DIMENSIONAL DATA

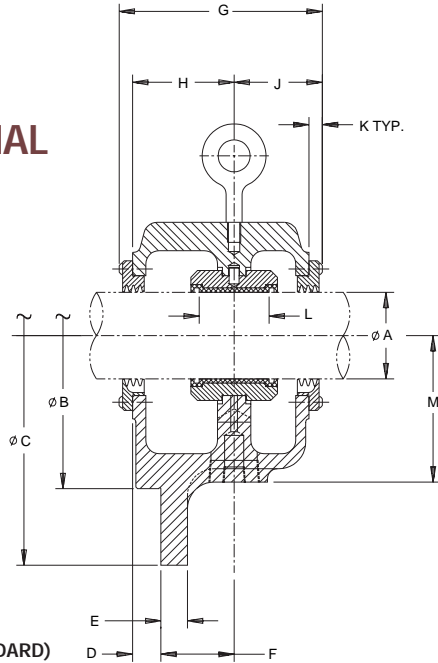

SPIGOT-MOUNT (STANDARD)

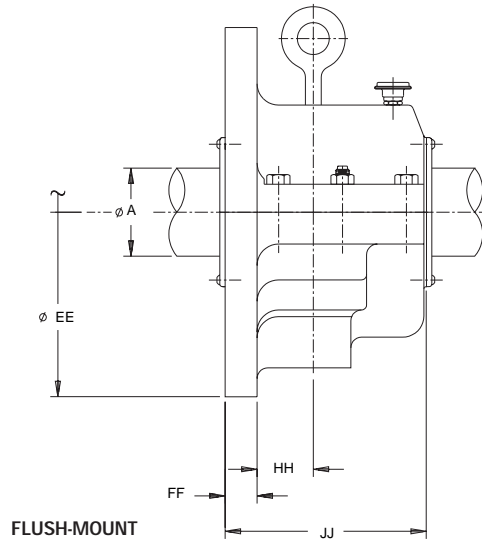

FLUSH-MOUNT

MODEL NO.	WEIGHT DRY lbs kg	A min/max in mm	B	C	D	E	F	G	H	J	K	L*	M
C-4	50	1.75/2.25	8.250	11.25	0.62	0.75	2.32	5.38	2.94	2.19	0.25	1.75	3.75
C-4	23	44.5/57.2	209.55	285.8	15.7	19.1	58.9	136.7	74.7	55.6	6.4	44.5	95.3
C-5	75	2.25/2.75	11.500	15.75	1.00	1.00	2.75	6.84	3.75	2.84	0.25	2.50	4.50
C-5	35	57.2/69.9	292.10	400.1	25.4	25.4	69.9	173.7	95.3	72.1	6.4	63.5	114.3
C-6	100	2.75/3.25	11.500	17.25	0.62	1.12	3.31	7.38	3.94	3.19	0.25	3.00	5.50
C-6	45	69.9/82.6	292.10	438.2	15.7	28.4	84.1	187.5	100.1	81.0	6.4	76.2	139.7
C-7	150	3.25/3.75	12.500	17.25	0.81	1.12	2.88	6.88	3.69	2.94	0.25	3.50	5.38
C-7	70	82.6/95.3	317.50	438.2	20.6	28.4	73.2	174.8	93.7	74.7	6.4	88.9	136.7
C-8	200	3.75/4.25	14.250	19.50	1.00	1.38	3.25	8.62	4.25	4.00	0.31	4.00	7.25
C-8	90	95.3/108.0	361.95	495.3	25.4	35.1	82.6	218.9	108.0	101.6	7.9	101.6	184.2
C-9	250	4.25/4.88	16.000	21.75	1.25	1.38	4.61	10.29	5.86	4.12	0.31	4.50	7.50
C-9	115	108.0/123.8	406.40	552.5	31.8	35.1	117.1	261.4	148.8	104.6	7.9	114.3	190.5
C-10.5	300	4.88/5.75	14.000	21.00	0.62	1.50	4.38	9.88	5.00	4.50	0.38	5.25	7.00
C-10.5	135	123.8/146.1	355.60	533.4	15.7	38.1	111.3	251.0	127.0	114.3	9.7	133.4	177.8
C-12	425	5.75/6.75	16.000	24.00	0.75	1.75	4.56	10.69	5.31	5.00	0.38	6.00	8.00
C-12	195	146.1/171.5	406.00	609.6	19.1	44.5	115.8	271.5	134.9	127.0	9.7	152.4	203.2
C-13.5	600	6.25/7.50	18.000	27.00	0.88	1.93	5.00	11.88	5.88	5.62	0.38	6.75	9.00
C-13.5	275	158.8/190.5	457.20	685.8	22.4	49.0	127.0	301.8	149.4	142.7	9.7	171.5	228.6

Metrics are shown on the shaded bars. All dimensions should be confirmed by a certified drawing. NOTE: Add to sump capacity a sufficient amount of oil to allow for the application's piping. \*Effective length will vary with shaft diameter. \*\*Dimension KK applies only to flush mount units, otherwise use R.

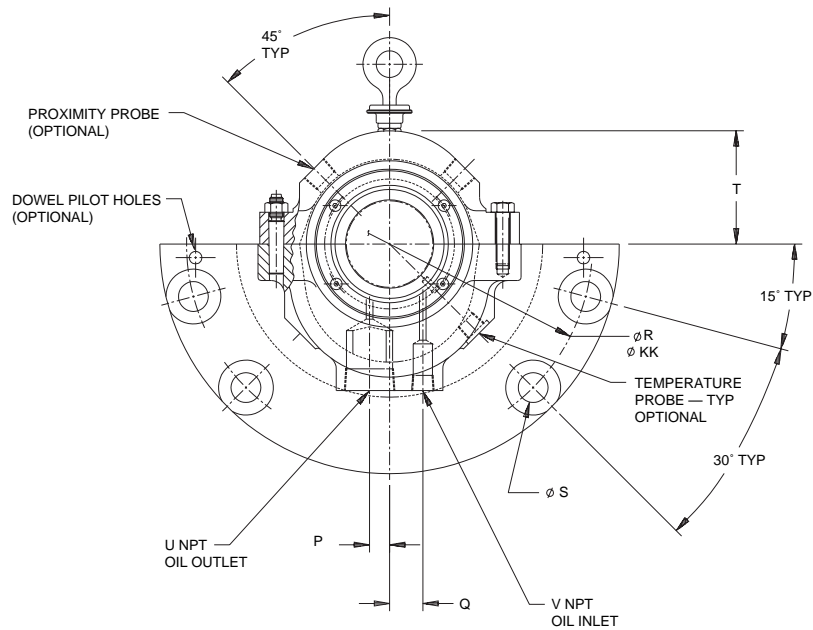

MODEL NO.	P	Q	R	S	T	U	V	EE	FF	HH	JJ	KK**
C-4	0.50	0.88	8.82	0.75	3.50	1.00	0.50	13.00	0.75	1.19	5.12	11.25
C-4	12.7	22.4	224.0	19.1	88.9	25.4	12.7	330.2	19.1	30.2	130.0	285.8
C-5	0.62	1.12	13.38	0.94	4.00	1.25	0.50	14.00	1.00	1.25	6.34	11.75
C-5	15.7	28.4	339.9	23.9	101.6	31.8	12.7	355.6	25.4	31.8	161.0	298.5
C-6	0.75	1.25	15.25	1.12	4.25	1.50	0.50	14.25	1.12	1.50	7.25	12.50
C-6	19.1	31.8	387.4	28.4	108.0	38.1	12.7	362.0	28.4	38.1	184.2	317.5
C-7	0.75	1.25	14.25	1.12	5.06	1.50	0.50	15.00	1.31	1.88	6.63	13.00
C-7	19.1	31.8	362.0	28.4	128.5	38.1	12.7	381.0	33.3	47.8	168.4	330.2
C-8	1.25	1.38	16.75	1.12	5.50	2.00	0.50	15.75	1.31	2.44	8.25	14.25
C-8	31.8	35.1	425.5	28.4	139.7	50.8	12.7	400.1	33.3	62.0	209.6	362.0
C-9	1.19	1.19	18.75	1.25	6.00	2.00	0.75	17.25	1.50	2.64	9.45	15.50
C-9	30.2	30.2	476.3	31.8	152.4	50.8	19.1	438.2	38.1	67.1	240.0	393.7
C-10.5	2.00	3.50	18.00	1.50	7.00	2.00	1.00	21.00	2.19	2.31	9.88	18.00
C-10.5	50.8	88.9	457.2	38.1	177.8	50.8	25.4	533.4	55.6	58.7	251.0	457.2
C-12	2.38	4.00	20.50	1.62	8.00	3.00	1.00	24.00	2.50	2.64	10.69	20.50
C-12	60.5	101.6	520.7	41.1	203.2	76.2	25.4	609.6	63.5	67.1	271.5	520.7
C-13.5	2.75	4.72	23.00	1.75	9.00	3.00	1.38	27.00	2.93	3.14	11.88	23.00
C-13.5	69.9	119.9	584.2	44.5	228.6	76.2	35.1	685.8	74.4	79.8	301.8	584.2