



## Inch

### Inch Series

<a href="#">Radial Open, Unflanged</a>	<a href="#">.10</a>
<a href="#">Radial Open, Flanged</a>	<a href="#">.11</a>
<a href="#">Radial Shielded, Unflanged</a>	<a href="#">.12</a>
<a href="#">Radial Shielded, Flanged</a>	<a href="#">.13</a>
<a href="#">Full Complement Radial Open, Unflanged &amp; Flanged</a>	<a href="#">.14</a>
<a href="#">Full Complement Radial Shielded, Unflanged &amp; Flanged</a>	<a href="#">.15</a>
<a href="#">Extended Inner Ring Radial Open, Unflanged &amp; Flanged</a>	<a href="#">.16</a>
<a href="#">Extended Inner Ring Radial Shielded, Unflanged &amp; Flanged</a>	<a href="#">.17</a>
<a href="#">Modified Dimension Radial Open, Unflanged &amp; Flanged</a>	<a href="#">.18</a>
<a href="#">Modified Dimension Radial Shielded, Unflanged &amp; Flanged</a>	<a href="#">.19-21</a>
<a href="#">Tapered O.D. Radial Shielded, Flanged</a>	<a href="#">.22</a>





## Radial Open, Unflanged

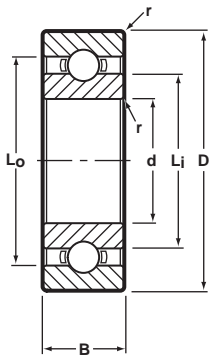

**Ribbon Cage**

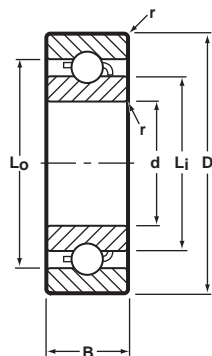

**Crown Cage**

### Notes:

1. Inch to metric conversion—see page 57.
  2. Basic part numbers shown below include code "SS" for AISI 440C stainless steel. If SAE 52100 chrome alloy steel is desired delete SS.
  3. See page 7 for ABEC tolerances.
  4. r=Maximum shaft or housing fillet radius that bearing corners will clear.
- ABEC "T" tolerances apply.
  - \* "R" Ribbon or "H" Crown Cages are available as indicated. Please consult with factory for machined cage availability.
  - ◇ Metric dimensions for reference only.
  - \*\* Load ratings are based on ABMA Standard #12.

BASIC P/N	STANDARD CAGE AVAILABILITY*		BORE d		O.D. D		WIDTH B		LAND DIAMETER (REFERENCE)		FILLET RADIUS r	BALL COMPLEMENT		LOAD RATINGS**		N <sub>max</sub> /n rpm/1000
	RIBBON	CROWN	INCH	(mm)◇	INCH	(mm)◇	INCH	(mm)◇	L <sub>i</sub>	L <sub>o</sub>		NO. Z	SIZE D <sub>b</sub>	DYN. C	STATIC C <sub>0</sub>	
SSRI-2		H	.0400	1.016	.1250	3.175	.0469	1.191	.064	.100	.003	5	.025	9	3	192
SSRI-2 1/2		H	.0469	1.191	.1562	3.967	.0625	1.588	.081	.124	.003	6	1/32	16	5	149
SSRI-3		H	.0550	1.397	.1875	4.763	.0781	1.984	.093	.159	.003	5	3/64	28	10	121
SSRI-4		H	.0781	1.984	.2500	6.350	.0937	2.380	.122	.193	.003	6	3/64	35	12	97
SSRI-3332		H	.0937	2.380	.1875	4.763	.0625	1.588	.118	.161	.003	7	1/32	19	6	109
SSRI-3332	R		.0937	2.380	.1875	4.763	.0625	1.588	.118	.161	.003	8	1/32	21	8	109
SSRI-5	R	H	.0937	2.380	.3125	7.938	.1094	2.779	.173	.270	.003	6	1/16	60	22	68
SSRI-418		H	.1250	3.175	.2500	6.350	.0937	2.380	.161	.216	.003	7	.0394	30	11	79
SSRI-418	R		.1250	3.175	.2500	6.350	.0937	2.380	.161	.216	.003	8	.0394	33	12	79
SSRI-518	R	H	.1250	3.175	.3125	7.938	.1094	2.779	.173	.270	.003	6	1/16	60	22	68
SSRI-618	R	H	.1250	3.175	.3750	9.525	.1094	2.779	.173	.270	.005	6	1/16	60	22	68
SSR-2	R	H	.1250	3.175	.3750	9.525	.1562	3.967	.200	.300	.012	7	1/16	66	26	61
SSR-2A	R	H	.1250	3.175	.5000	12.700	.1719	4.366	.200	.300	.012	7	1/16	66	26	61
SSRI-1218	R		.1250	3.175	.7500	19.050	.1250	3.175	.225	.317	.010	8	1/16	76	30	56
SSRI-5532		H	.1562	3.967	.3125	7.938	.1094	2.779	.221	.279	.003	7	3/64	41	15	61
SSRI-5532	R		.1562	3.967	.3125	7.938	.1094	2.779	.221	.279	.003	8	3/64	45	17	61
SSRI-5632		H	.1875	4.763	.3125	7.938	.1094	2.779	.221	.279	.003	7	3/64	41	15	61
SSRI-5632	R		.1875	4.763	.3125	7.938	.1094	2.779	.221	.279	.003	8	3/64	45	17	61
SSRI-6632	R	H	.1875	4.763	.3750	9.525	.1250	3.175	.235	.325	.003	8	1/16	76	31	54
SSR-3	R	H	.1875	4.763	.5000	12.700	.1562	3.967	.276	.412	.012	7	3/32	140	59	44
SSRI-614		H	.2500	6.350	.3750	9.525	.1250	3.175	.285	.341	.003	13	.0394	43	21	48
SSRI-814	R	H	.2500	6.350	.5000	12.700	.1250	3.175	.330	.431	.005	10	1/16	88	40	40
SSR-4	R	H	.2500	6.350	.6250	15.875	.1960	4.978	.364	.510	.012	8	3/32	159	70	35
SSRI-1214	R		.2500	6.350	.7500	19.050	.2188	5.558	.386	.597	.016	6	9/64	412	193	31
SSRI-8516	R		.3125	7.938	.5000	12.700	.1562	3.967	.362	.450	.005	11	1/16	93	43	37
SSRI-1038	R		.3750	9.525	.6250	15.875	.1562	3.967	.457	.542	.010	12	1/16	96	53	30
SSRI-1438	R		.3750	9.525	.8750	22.225	.2188	5.558	.521	.741	.016	7	5/32	569	273	24
SSRI-1212	R		.5000	12.700	.7500	19.050	.1562	3.967	.587	.672	.010	16	1/16	111	71	24
SSRI-1412	R		.5000	12.700	.8750	22.225	.2188	5.558	.622	.750	.016	12	3/32	198	110	22
SSRI-1812	R		.5000	12.700	1.1250	28.575	.2500	6.350	.701	.913	.016	9	5/32	684	344	19
SSRI-1458●	R		.6250	15.875	.8750	22.225	.1562	3.967	.712	.797	.010	18	1/16	116	81	20
SSRI-1634●	R		.7500	19.050	1.0000	25.400	.1562	3.967	.837	.922	.010	22	1/16	127	99	17
SSRI-1878SD502		H	.8750	22.225	1.1250	28.575	.1562	3.967	.961	1.072	.010	24	1/16	189	161	15



## Radial Open, Flanged

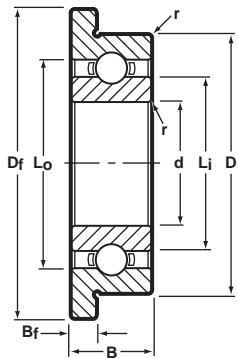

**Ribbon Cage**

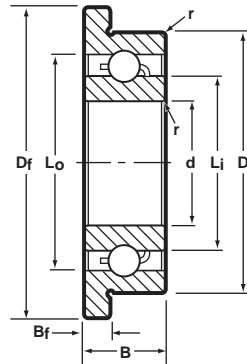

**Crown Cage**

### Notes:

1. Inch to metric conversion—see page 57.
  2. Basic part numbers shown below include code "SS" for AISI 440C stainless steel. If SAE 52100 chrome alloy steel is desired delete SS.
  3. See page 7 for ABEC tolerances.
  4. r=Maximum shaft or housing fillet radius that bearing corners will clear.
- ABEC "T" tolerances apply.
  - \* "R" Ribbon or "H" Crown Cages are available as indicated. Please consult with factory for machined cage availability.
  - ◇ Metric dimensions for reference only.
  - \*\* Load ratings are based on ABMA Standard #12.

BASIC P/N	STANDARD CAGE AVAILABILITY *		BORE d		O.D. D		WIDTH B		FLANGE DIA. D <sub>f</sub>	FLANGE WIDTH B <sub>f</sub>	LAND DIAMETER (REFERENCE)		FILLET RADIUS r	BALL COMPLEMENT		LOAD RATINGS**		N <sub>max</sub> /h rpm/1000
	RIBBON	CROWN	INCH	(mm)◇	INCH	(mm)◇	INCH	(mm)◇			L <sub>i</sub>	L <sub>o</sub>		NO. Z	SIZE D <sub>b</sub>	DYN. C	STATIC C <sub>0</sub>	
SSRIF-2		H	.0400	1.016	.1250	3.175	.0469	1.191	.171	.013	.064	.100	.003	5	.025	9	3	192
SSRIF-2 1/2		H	.0469	1.191	.1562	3.967	.0625	1.588	.203	.013	.081	.124	.003	6	1/32	16	5	149
SSRIF-3		H	.0550	1.397	.1875	4.763	.0781	1.984	.234	.023	.093	.159	.003	5	3/64	28	10	121
SSRIF-4		H	.0781	1.984	.2500	6.350	.0937	2.380	.296	.023	.122	.193	.003	6	3/64	35	12	97
SSRIF-3332		H	.0937	2.380	.1875	4.763	.0625	1.588	.234	.018	.118	.161	.003	7	1/32	19	6	109
SSRIF-3332	R		.0937	2.380	.1875	4.763	.0625	1.588	.234	.018	.118	.161	.003	8	1/32	21	8	109
SSRIF-5	R	H	.0937	2.380	.3125	7.938	.1094	2.779	.359	.023	.173	.270	.003	6	1/16	60	22	68
SSRIF-418		H	.1250	3.175	.2500	6.350	.0937	2.380	.296	.023	.161	.216	.003	7	.0394	30	11	79
SSRIF-418	R		.1250	3.175	.2500	6.350	.0937	2.380	.296	.023	.161	.216	.003	8	.0394	33	12	79
SSRIF-518	R	H	.1250	3.175	.3125	7.938	.1094	2.779	.359	.023	.173	.270	.003	6	1/16	60	22	68
SSRIF-618	R	H	.1250	3.175	.3750	9.525	.1094	2.779	.422	.023	.173	.270	.005	6	1/16	60	22	68
SSRF-2	R	H	.1250	3.175	.3750	9.525	.1562	3.967	.440	.030	.200	.300	.012	7	1/16	66	26	61
SSRIF-5532		H	.1562	3.967	.3125	7.938	.1094	2.779	.359	.023	.221	.279	.003	7	3/64	41	15	61
SSRIF-5532	R		.1562	3.967	.3125	7.938	.1094	2.779	.359	.023	.221	.279	.003	8	3/64	45	17	61
SSRIF-5632		H	.1875	4.763	.3125	7.938	.1094	2.779	.359	.023	.221	.279	.003	7	3/64	41	15	61
SSRIF-5632	R		.1875	4.763	.3125	7.938	.1094	2.779	.359	.023	.221	.279	.003	8	3/64	45	17	61
SSRIF-6632	R	H	.1875	4.763	.3750	9.525	.1250	3.175	.422	.023	.235	.325	.003	8	1/16	76	31	54
SSRF-3	R	H	.1875	4.763	.5000	12.700	.1562	3.967	.565	.042	.276	.412	.012	7	3/32	140	59	44
SSRIF-614		H	.2500	6.350	.3750	9.525	.1250	3.175	.422	.023	.285	.341	.003	13	.0394	43	21	48
SSRIF-814	R	H	.2500	6.350	.5000	12.700	.1250	3.175	.547	.023	.330	.431	.005	10	1/16	88	40	40
SSRF-4	R	H	.2500	6.350	.6250	15.875	.1960	4.978	.690	.042	.364	.510	.012	8	3/32	159	70	35
SSRIF-8516	R		.3125	7.938	.5000	12.700	.1562	3.967	.547	.031	.362	.450	.005	11	1/16	93	43	37
SSRIF-1438	R		.3750	9.525	.8750	22.225	.2812	7.142	.969	.062	.521	.741	.016	7	5/32	569	273	24
SSRIF-1812	R		.5000	12.700	1.1250	28.575	.2500	6.350	1.225	.062	.701	.913	.016	9	5/32	684	344	19



## Radial Shielded, Unflanged

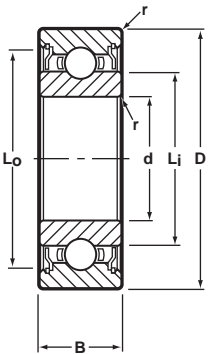

**2 Shields  
Ribbon Cage**

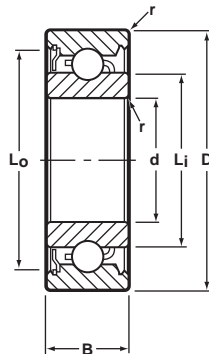

**1 Shield  
Crown Cage**

### Notes:

1. Inch to metric conversion—see page 57.
2. Basic part numbers shown below include code "SS" for AISI 440C stainless steel. If SAE 52100 chrome alloy steel is desired delete SS.
3. See page 7 for ABEC tolerances.
4. r=Maximum shaft or housing fillet radius that bearing corners will clear.
5. Add "Z" for single shield, "ZZ" for two shields as a suffix to basic part number.

- ABEC "T" tolerances apply.
- \* "R" Ribbon or "H" Crown Cages are available as indicated. Please consult with factory for machined cage availability.
- ◇ Metric dimensions for reference only.
- \*\* Load ratings are based on ABMA Standard #12.

BASIC P/N	STANDARD CAGE AVAILABILITY*		BORE d		O. D. D		WIDTH B				LAND DIAMETER (REFERENCE)		FILLET RADIUS r	BALL COMPLEMENT		LOAD RATINGS**		N <sub>max</sub> /h rpm/1000
	RIBBON	CROWN	INCH	(mm)◇	INCH	(mm)◇	1 SHIELD		2 SHIELDS		L <sub>i</sub>	L <sub>o</sub>		NO. Z	SIZE D <sub>b</sub>	DYN. C	STATIC C <sub>0</sub>	
							INCH	(mm)◇	INCH	(mm)◇								
SSRI-2 1/2		H	.0469	1.191	.1562	3.967	.0937	2.380	.0937	2.380	.081	.134	.003	6	1/32	16	5	149
SSRI-3		H	.0550	1.397	.1875	4.763	.0937	2.380	.1094	2.779	.093	.167	.003	5	3/64	28	10	121
SSRI-4		H	.0781	1.984	.2500	6.350	.1094	2.779	.1406	3.571	.122	.205	.003	6	3/64	35	12	97
SSRI-3332		H	.0937	2.380	.1875	4.763	.0937	2.380	.0937	2.380	.118	.167	.003	7	1/32	19	6	109
SSRI-3332	R		.0937	2.380	.1875	4.763	.0937	2.380	.0937	2.380	.118	.167	.003	8	1/32	21	8	109
SSRI-5	R	H	.0937	2.380	.3125	7.938	.1094	2.779	.1406	3.571	.173	.282	.003	6	1/16	60	22	68
SSRI-418		H	.1250	3.175	.2500	6.350	.0937	2.380	.1094	2.779	.161	.228	.003	7	.0394	30	11	79
SSRI-418	R		.1250	3.175	.2500	6.350	.0937	2.380	.1094	2.779	.161	.228	.003	8	.0394	33	12	79
SSRI-518	R	H	.1250	3.175	.3125	7.938	.1094	2.779	.1406	3.571	.173	.282	.003	6	1/16	60	22	68
SSRI-618	R	H	.1250	3.175	.3750	9.525	.1094	2.779	.1406	3.571	.173	.282	.005	6	1/16	60	22	68
SSR-2	R	H	.1250	3.175	.3750	9.525	.1562	3.967	.1562	3.967	.200	.321	.012	7	1/16	66	26	61
SSR-2A	R	H	.1250	3.175	.5000	12.700	.1719	4.366	.1719	4.366	.200	.321	.012	7	1/16	66	26	61
SSRI-1218	R		.1250	3.175	.7500	19.050	.1250	3.175	.1250	3.175	.225	.341	.010	8	1/16	76	30	56
SSRI-5532		H	.1562	3.967	.3125	7.938	.1094	2.779	.1250	3.175	.221	.285	.003	7	3/64	41	15	61
SSRI-5532	R		.1562	3.967	.3125	7.938	.1094	2.779	.1250	3.175	.221	.285	.003	8	3/64	45	17	61
SSRI-5632		H	.1875	4.763	.3125	7.938	.1094	2.779	.1250	3.175	.221	.285	.003	7	3/64	41	15	61
SSRI-5632	R		.1875	4.763	.3125	7.938	.1094	2.779	.1250	3.175	.221	.285	.003	8	3/64	45	17	61
SSRI-6632	R	H	.1875	4.763	.3750	9.525	.1250	3.175	.1250	3.175	.235	.341	.003	8	1/16	76	31	54
SSR-3	R	H	.1875	4.763	.5000	12.700	.1960	4.978	.1960	4.978	.276	.433	.012	7	3/32	140	59	44
SSRI-614		H	.2500	6.350	.3750	9.525	.1250	3.175	.1250	3.175	.285	.348	.003	13	.0394	43	21	48
SSRI-814	R	H	.2500	6.350	.5000	12.700	.1250	3.175	.1875	4.763	.330	.452	.005	10	1/16	88	40	40
SSR-4	R	H	.2500	6.350	.6250	15.875	.1960	4.978	.1960	4.978	.364	.544	.012	8	3/32	159	70	35
SSRI-1214	R		.2500	6.350	.7500	19.050	.2812	7.142	.2812	7.142	.341	.639	.016	6	9/64	412	193	31
SSRI-8516	R		.3125	7.938	.5000	12.700	.1562	3.967	.1562	3.967	.362	.460	.005	11	1/16	93	43	37
SSRI-1038	R		.3750	9.525	.6250	15.875	.1562	3.967	.1562	3.967	.458	.557	.010	12	1/16	96	53	30
SSRI-1438	R		.3750	9.525	.8750	22.225	.2812	7.142	.2812	7.142	.474	.783	.016	7	5/32	569	273	24
SSRI-1212	R		.5000	12.700	.7500	19.050	.1562	3.967	.1562	3.967	.587	.687	.010	16	1/16	111	71	24
SSRI-1412	R		.5000	12.700	.8750	22.225	.2812	7.142	.2812	7.142	.622	.783	.016	12	3/32	198	110	22
SSRI-1812	R		.5000	12.700	1.1250	28.575	.3125	7.938	.3125	7.938	.628	.965	.016	9	5/32	684	344	19
SSRI-1458 •	R		.6250	15.875	.8750	22.225	.1562	3.967	.1562	3.967	.713	.814	.010	18	1/16	116	81	20
SSRI-1634 •	R		.7500	19.050	1.0000	25.400	.1562	3.967	.1562	3.967	.837	.938	.010	22	1/16	127	99	17
SSRI-1878SD502		H	.8750	22.225	1.1250	28.575	—	—	.1562	3.967	.961	1.072	.010	24	1/16	189	161	15



## Radial Shielded, Flanged

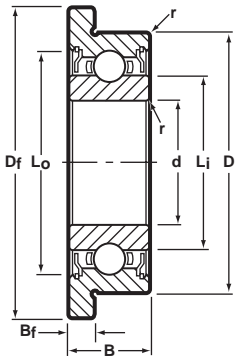

**2 Shields  
Ribbon Cage**

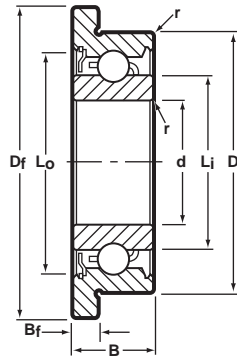

**1 Shield  
Crown Cage**

### Notes:

1. Inch to metric conversion—see page 57.
2. Basic part numbers shown below include code "SS" for AISI 440C stainless steel. If SAE 52100 chrome alloy steel is desired delete SS.
3. See page 7 for ABEC tolerances.
4. r=Maximum shaft or housing fillet radius that bearing corners will clear.
5. Add "Z" for single shield, "ZZ" for two shields as a suffix to basic part number.

- ABEC "T" tolerances apply.
- \* "R" Ribbon or "H" Crown Cages are available as indicated. Please consult with factory for machined cage availability.
- ◇ Metric dimensions for reference only.
- \*\* Load ratings are based on ABMA Standard #12.

BASIC P/N	STANDARD CAGE AVAILABILITY *		BORE d		O.D. D		WIDTH B		FLANGE DIA. D <sub>f</sub>	FLANGE WIDTH B <sub>f</sub>	LAND DIAMETER (REFERENCE)		FILLET RADIUS r	BALL COMPLEMENT		LOAD RATINGS**		N <sub>max</sub> /h rpm/1000
	RIBBON	CROWN	INCH	(mm)◇	INCH	(mm)◇	1 or 2 SHIELDS				L <sub>i</sub>	L <sub>o</sub>		NO. Z	SIZE D <sub>b</sub>	DYN. C	STATIC C <sub>0</sub>	
							INCH	(mm)◇										
SSRIF-2 1/2		H	.0469	1.191	.1562	3.967	.0937	2.380	.203	.031	.081	.134	.003	6	1/32	16	5	149
SSRIF-3		H	.0550	1.397	.1875	4.763	.1094	2.779	.234	.031	.093	.167	.003	5	3/64	28	10	121
SSRIF-4		H	.0781	1.984	.2500	6.350	.1406	3.571	.296	.031	.122	.205	.003	6	3/64	35	12	97
SSRIF-3332		H	.0937	2.380	.1875	4.763	.0937	2.380	.234	.031	.118	.167	.003	7	1/32	19	6	109
SSRIF-3332	R		.0937	2.380	.1875	4.763	.0937	2.380	.234	.031	.118	.167	.003	8	1/32	21	8	109
SSRIF-5	R	H	.0937	2.380	.3125	7.938	.1406	3.571	.359	.031	.173	.282	.003	6	1/16	60	22	68
SSRIF-418		H	.1250	3.175	.2500	6.350	.1094	2.779	.296	.031	.161	.228	.003	7	.0394	30	11	79
SSRIF-418	R		.1250	3.175	.2500	6.350	.1094	2.779	.296	.031	.161	.228	.003	8	.0394	33	12	79
SSRIF-518	R	H	.1250	3.175	.3125	7.938	.1406	3.571	.359	.031	.173	.282	.003	6	1/16	60	22	68
SSRIF-618	R	H	.1250	3.175	.3750	9.525	.1406	3.571	.422	.031	.173	.282	.005	6	1/16	60	22	68
SSRF-2	R	H	.1250	3.175	.3750	9.525	.1562	3.967	.440	.030	.200	.321	.012	7	1/16	66	26	61
SSRIF-5532		H	.1562	3.967	.3125	7.938	.1250	3.175	.359	.036	.221	.285	.003	7	3/64	41	15	61
SSRIF-5532	R		.1562	3.967	.3125	7.938	.1250	3.175	.359	.036	.221	.285	.003	8	3/64	45	17	61
SSRIF-5632		H	.1875	4.763	.3125	7.938	.1250	3.175	.359	.036	.221	.285	.003	7	3/64	41	15	61
SSRIF-5632	R		.1875	4.763	.3125	7.938	.1250	3.175	.359	.036	.221	.285	.003	8	3/64	45	17	61
SSRIF-6632	R	H	.1875	4.763	.3750	9.525	.1250	3.175	.422	.031	.235	.341	.003	8	1/16	76	31	54
SSRF-3	R	H	.1875	4.763	.5000	12.700	.1960	4.978	.565	.042	.276	.433	.012	7	3/32	140	59	44
SSRIF-614		H	.2500	6.350	.3750	9.525	.1250	3.175	.422	.036	.285	.348	.003	13	.0394	43	21	48
SSRIF-814	R	H	.2500	6.350	.5000	12.700	.1875	4.763	.547	.045	.330	.452	.005	10	1/16	88	40	40
SSRF-4	R	H	.2500	6.350	.6250	15.875	.1960	4.978	.690	.042	.364	.544	.012	8	3/32	159	70	35
SSRIF-8516	R		.3125	7.938	.5000	12.700	.1562	3.967	.547	.031	.362	.460	.005	11	1/16	93	43	37
SSRIF-1438	R		.3750	9.525	.8750	22.225	.2812	7.142	.969	.062	.474	.783	.016	7	5/32	569	273	24
SSRIF-1812	R		.5000	12.700	1.1250	28.575	.3125	7.938	1.225	.062	.628	.965	.016	9	5/32	684	344	19



## Full Complement Radial Open, Unflanged & Flanged

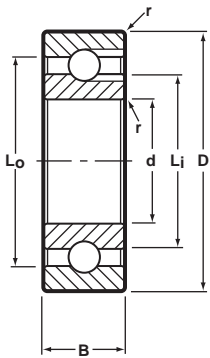

**Unflanged**

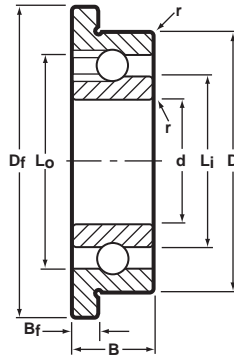

**Flanged**

### Notes:

1. Inch to metric conversion—see page 57.
2. Basic part numbers shown below include code "SS" for AISI 440C stainless steel. If SAE 52100 chrome alloy steel is desired delete SS.
3. See page 7 for ABEC tolerances.
4. r=Maximum shaft or housing fillet radius that bearing corners will clear.

† For flanged bearings substitute prefix SSRIF- or SSRF-  
 ◇ Metric dimensions for reference only.

\*\* Load ratings are based on ABMA Standard #12.

BASIC P/N †	BORE d		O.D. D		WIDTH B		FLANGE DIA. D <sub>f</sub>	FLANGE WIDTH B <sub>f</sub>	LAND DIAMETER (REFERENCE)		FILLET RADIUS r	BALL COMPLEMENT		LOAD RATINGS** Lbs.		N <sub>max</sub> /h rpm/1000
	INCH	(mm)◇	INCH	(mm)◇	INCH	(mm)◇			L <sub>i</sub>	L <sub>o</sub>		NO. Z	SIZE D <sub>b</sub>	DYN. C	STATIC C <sub>0</sub>	
SSRI-2 1/2F	.0469	1.191	.1562	3.967	.0625	1.588	.203	.013	.081	.124	.003	10	1/32	22	9	60
SSRI-3F	.0550	1.397	.1875	4.763	.0781	1.984	.234	.023	.093	.159	.003	8	3/64	38	15	48
SSRI-4SD508F	.0781	1.984	.2362	6.000	.0937	2.380	—	—	.122	.193	.003	10	3/64	49	20	39
SSRI-4F	.0781	1.984	.2500	6.350	.0937	2.380	.296	.023	.122	.193	.003	10	3/64	49	20	39
SSRI-3332F	.0937	2.380	.1875	4.763	.0625	1.588	—	—	.118	.161	.003	13	1/32	33	14	44
SSRI-5SD507F	.0937	2.380	.3125	7.938	.1094	2.779	.359	.023	.182	.270	.003	11	1/16	102	47	27
SSRI-418F	.1250	3.175	.2500	6.350	.0937	2.380	.296	.023	.161	.216	.003	15	.0394	50	23	31
SSRI-518F	.1250	3.175	.3125	7.938	.1094	2.779	.359	.023	.182	.270	.003	11	1/16	102	47	27
SSRI-618F	.1250	3.175	.3750	9.525	.1094	2.779	.422	.023	.182	.270	.005	11	1/16	102	47	27
SSR-2F	.1250	3.175	.3750	9.525	.1562	3.967	.440	.030	.200	.300	.012	12	1/16	95	45	24
SSRI-5532F	.1562	3.967	.3125	7.938	.1094	2.779	.359	.023	.221	.279	.003	16	3/64	72	34	24
SSRI-5632F	.1875	4.763	.3125	7.938	.1094	2.779	.359	.023	.221	.279	.003	16	3/64	72	34	22
SSRI-6632F	.1875	4.763	.3750	9.525	.1250	3.175	.422	.023	.235	.325	.003	13	1/16	105	50	22
SSR-3F	.1875	4.763	.5000	12.700	.1562	3.967	.565	.042	.276	.412	.012	11	3/32	190	93	18
SSRI-614F	.2500	6.350	.3750	9.525	.1250	3.175	.422	.023	.285	.341	.003	24	.0394	65	39	19
SSRI-814F	.2500	6.350	.5000	12.700	.1250	3.175	.547	.023	.330	.431	.005	18	1/16	126	71	16
SSR-4F	.2500	6.350	.6250	15.875	.1960	4.978	.690	.042	.364	.510	.012	14	3/32	231	123	14
SSRI-1214F	.2500	6.350	.7500	19.050	.2188	5.558	—	—	.386	.597	.016	10	9/64	576	322	12
SSRI-8516F	.3125	7.938	.5000	12.700	.1562	3.967	.547	.031	.362	.450	.005	20	1/16	139	78	15
SSRI-1438F	.3750	9.525	.8750	22.225	.2188	5.558	—	—	.521	.741	.016	12	5/32	778	470	10
SSRI-1412F	.5000	12.700	.8750	22.225	.2188	5.558	—	—	.622	.750	.016	22	3/32	297	201	9



## Full Complement Radial Shielded, Unflanged & Flanged

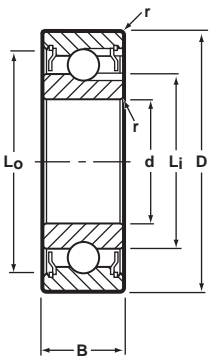

**Unflanged  
2 Shields**

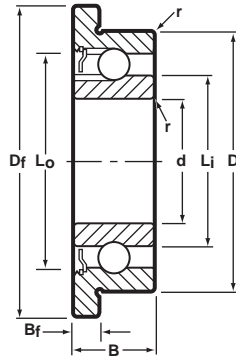

**Flanged  
1 Shield**

### Notes:

1. Inch to metric conversion—see page 57.
2. Basic part numbers shown below include code "SS" for AISI 440C stainless steel. If SAE 52100 chrome alloy steel is desired delete SS.
3. See page 7 for ABEC tolerances.
4. r=Maximum shaft or housing fillet radius that bearing corners will clear.
5. Add "ZZ" for two shields as a suffix to basic part number prior to letter "F".

† For flanged bearings substitute prefix SSRIF- or SSRF-  
 ◇ Metric dimensions for reference only.

\*\* Load ratings are based on ABMA Standard #12.

BASIC P/N †	BORE d		O. D. D		WIDTH B		FLANGE DIA. D <sub>f</sub>	FLANGE WIDTH B <sub>f</sub>	LAND DIAMETER (REFERENCE)		FILLET RADIUS r	BALL COMPLEMENT		LOAD RATINGS** Lbs.		N <sub>max</sub> /h rpm/1000
	INCH	(mm)◇	INCH	(mm)◇	2 SHIELDS				L <sub>i</sub>	L <sub>o</sub>		NO. Z	SIZE D <sub>b</sub>	DYN. C	STATIC C <sub>0</sub>	
					INCH	(mm)◇										
SSRI-2 1/2F	.0469	1.191	.1562	3.967	.0937	2.380	.203	.031	.081	.134	.003	10	1/32	22	9	60
SSRI-3F	.0550	1.397	.1875	4.763	.1094	2.779	.234	.031	.093	.167	.003	8	3/64	38	15	48
SSRI-4F	.0781	1.984	.2500	6.350	.1406	3.571	.296	.031	.122	.205	.003	10	3/64	49	20	39
SSRI-3332F	.0937	2.380	.1875	4.763	.0937	2.380	.234	.031	.118	.167	.003	13	1/32	33	14	44
SSRI-5F	.0937	2.380	.3125	7.938	.1406	3.571	.359	.031	.182	.282	.003	11	1/16	102	47	27
SSRI-418F	.1250	3.175	.2500	6.350	.1094	2.779	.296	.031	.161	.228	.003	15	.0394	50	23	31
SSRI-518F	.1250	3.175	.3125	7.938	.1406	3.571	.359	.031	.182	.282	.003	11	1/16	102	47	27
SSRI-618F	.1250	3.175	.3750	9.525	.1406	3.571	.422	.031	.182	.282	.005	11	1/16	102	47	27
SSR-2F	.1250	3.175	.3750	9.525	.1562	3.967	.440	.030	.200	.321	.012	12	1/16	95	45	24
SSRI-5532F	.1562	3.967	.3125	7.938	.1250	3.175	.359	.036	.221	.285	.003	16	3/64	72	34	24
SSRI-5632F	.1875	4.763	.3125	7.938	.1250	3.175	.359	.036	.221	.285	.003	16	3/64	72	34	22
SSRI-6632F	.1875	4.763	.3750	9.525	.1250	3.175	.422	.031	.235	.341	.003	13	1/16	105	50	22
SSR-3F	.1875	4.763	.5000	12.700	.1960	4.978	.565	.042	.276	.433	.012	11	3/32	190	93	18
SSRI-614F	.2500	6.350	.3750	9.525	.1250	3.175	.422	.036	.285	.348	.003	24	.0394	65	39	19
SSRI-814F	.2500	6.350	.5000	12.700	.1875	4.763	.547	.045	.330	.452	.005	18	1/16	126	71	16
SSR-4F	.2500	6.350	.6250	15.875	.1960	4.978	.690	.042	.364	.544	.012	14	3/32	231	123	14
SSRI-1214F	.2500	6.350	.7500	19.050	.2812	7.142	—	—	.341	.639	.016	10	9/64	576	322	12
SSRI-8516F	.3125	7.938	.5000	12.700	.1562	3.967	.547	.031	.362	.460	.005	20	1/16	139	78	15
SSRI-1438F	.3750	9.525	.8750	22.225	.2812	7.142	.969	.062	.474	.783	.016	12	5/32	778	470	10
SSRI-1412F	.5000	12.700	.8750	22.225	.2812	7.142	—	—	.622	.783	.016	22	3/32	297	201	9





## Extended Inner Ring Radial Open, Unflanged & Flanged

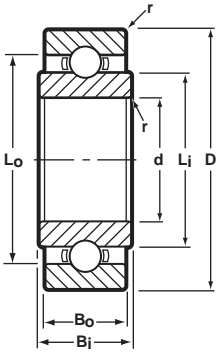

**Unflanged  
Ribbon Cage**

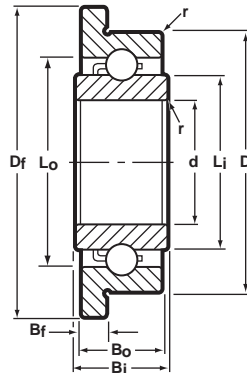

**Flanged  
Crown Cage**

### Notes:

1. Inch to metric conversion—see page 57.
2. Basic part numbers shown below include code "SS" for AISI 440C stainless steel. If SAE 52100 chrome alloy steel is desired delete SS.
3. See page 7 for ABEC tolerances.
4. r=Maximum shaft or housing fillet radius that bearing corners will clear.
5. For extended inner ring add "EE" as a suffix to basic part number

† For flanged bearings substitute prefix SSRIF- or SSRF-

\* "R" Ribbon or "H" Crown Cages are available as indicated. Please consult with factory for machined cage availability.

◇ Metric dimensions for reference only.

\*\* Load ratings are based on ABMA Standard #12.

BASIC P/N †	CAGE TYPE *	BORE d		O.D. D		INNER WIDTH Bj		OUTER WIDTH Bo		FLANGE DIA. Df	FLANGE WIDTH Bf	LAND DIAMETER (REFERENCE)		FILLET RADIUS r	BALL COMPLEMENT		LOAD RATINGS**		Nmax/n rpm/1000
		INCH	(mm)◇	INCH	(mm)◇	INCH	(mm)◇	INCH	(mm)◇			Lj	Lo		NO. Z	SIZE D0	DYN. C	STATIC Co	
SSRI-2	H	.0400	1.016	.1250	3.175	.0781	1.984	.0469	1.191	.171	.013	.059	.098	.003	5	.025	9	3	192
SSRI-2 1/2	H	.0469	1.191	.1562	3.967	.0937	2.380	.0625	1.588	.203	.013	.081	.124	.003	6	1/32	16	5	149
SSRI-3	H	.0550	1.397	.1875	4.763	.1094	2.779	.0781	1.984	.234	.023	.093	.159	.003	5	3/64	28	10	121
SSRI-4	H	.0781	1.984	.2500	6.350	.1250	3.175	.0937	2.380	.296	.023	.122	.193	.003	6	3/64	35	12	97
SSRI-3332	H	.0937	2.380	.1875	4.763	.0937	2.380	.0625	1.588	.234	.018	.118	.161	.003	7	1/32	19	6	109
SSRI-3332	R	.0937	2.380	.1875	4.763	.0937	2.380	.0625	1.588	.234	.018	.118	.161	.003	8	1/32	21	8	109
SSRI-5	R/H	.0937	2.380	.3125	7.938	.1406	3.571	.1094	2.779	.359	.023	.173	.270	.003	6	1/16	60	22	68
SSRI-418	H	.1250	3.175	.2500	6.350	.1250	3.175	.0937	2.380	.296	.023	.161	.216	.003	7	.0394	30	11	79
SSRI-418	R	.1250	3.175	.2500	6.350	.1250	3.175	.0937	2.380	.296	.023	.161	.216	.003	8	.0394	33	12	79
SSRI-518	R/H	.1250	3.175	.3125	7.938	.1406	3.571	.1094	2.779	.359	.023	.173	.270	.003	6	1/16	60	22	68
SSRI-618	R/H	.1250	3.175	.3750	9.525	.1406	3.571	.1094	2.779	.422	.023	.173	.270	.005	6	1/16	60	22	68
SSR-2	R/H	.1250	3.175	.3750	9.525	.1875	4.763	.1562	3.967	.440	.030	.200	.300	.012	7	1/16	66	26	61
SSRI-5532	H	.1562	3.967	.3125	7.938	.1406	3.571	.1094	2.779	.359	.023	.221	.279	.003	7	3/64	41	15	61
SSRI-5532	R	.1562	3.967	.3125	7.938	.1406	3.571	.1094	2.779	.359	.023	.221	.279	.003	8	3/64	45	17	61
SSRI-5632	H	.1875	4.763	.3125	7.938	.1406	3.571	.1094	2.779	.359	.023	.221	.279	.003	7	3/64	41	15	61
SSRI-5632	R	.1875	4.763	.3125	7.938	.1406	3.571	.1094	2.779	.359	.023	.221	.279	.003	8	3/64	45	17	61
SSRI-6632	R/H	.1875	4.763	.3750	9.525	.1562	3.967	.1250	3.175	.422	.023	.235	.325	.003	8	1/16	76	31	54
SSRI-614	H	.2500	6.350	.3750	9.525	.1562	3.967	.1250	3.175	.422	.023	.285	.341	.003	13	.0394	43	21	48
SSRI-814	R/H	.2500	6.350	.5000	12.700	.1562	3.967	.1250	3.175	.547	.023	.330	.431	.005	10	1/16	88	40	40
SSRI-8516	R	.3125	7.938	.5000	12.700	.1875	4.763	.1562	3.967	.547	.031	.362	.450	.005	11	1/16	93	43	37





## Extended Inner Ring Radial Shielded, Unflanged & Flanged

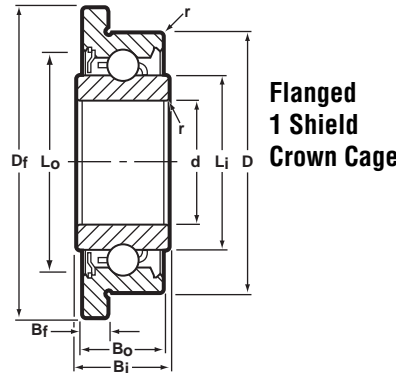
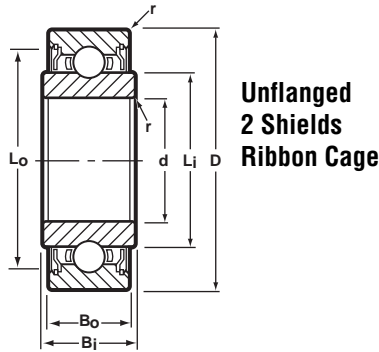

### Notes:

1. Inch to metric conversion—see page 57.
2. Basic part numbers shown below include code "SS" for AISI 440C stainless steel. If SAE 52100 chrome alloy steel is desired delete SS.
3. See page 7 for ABEC tolerances.
4. r=Maximum shaft or housing fillet radius that bearing corners will clear.
5. Add "Z" for single shield, "ZZ" for two shields, as a suffix to basic part number. For extended inner ring add "EE".

† For flanged bearings substitute prefix SSRIF- or SSRF-

\* "R" Ribbon or "H" Crown Cages are available as indicated. Please consult with factory for machined cage availability.

◇ Metric dimensions for reference only.

\*\* Load ratings are based on ABMA Standard #12.

BASIC P/N †	CAGE TYPE *	BORE d		O. D. D		INNER WIDTH Bi		OUTER WIDTH Bo		FLANGE DIA. Df	FLANGE WIDTH Bf	LAND DIAMETER (REFERENCE)		FILLET RADIUS r	BALL COMPLEMENT		LOAD RATINGS**		Nmax/n rpm/1000
		INCH	(mm)◇	INCH	(mm)◇	INCH	(mm)◇	INCH	(mm)◇			Li	Lo		NO. Z	SIZE Db	DYN. C	STATIC Co	
SSRI-2 1/2	H	.0469	1.191	.1562	3.967	.1250	3.175	.0937	2.380	.203	.031	.081	.134	.003	6	1/32	16	5	149
SSRI-3	H	.0550	1.397	.1875	4.763	.1406	3.571	.1094	2.779	.234	.031	.093	.167	.003	5	3/64	28	10	121
SSRI-4	H	.0781	1.984	.2500	6.350	.1719	4.366	.1406	3.571	.296	.031	.122	.205	.003	6	3/64	35	12	97
SSRI-3332	H	.0937	2.380	.1875	4.763	.1250	3.175	.0937	2.380	.234	.031	.118	.167	.003	7	1/32	19	6	109
SSRI-3332	R	.0937	2.380	.1875	4.763	.1250	3.175	.0937	2.380	.234	.031	.118	.167	.003	8	1/32	21	8	109
SSRI-5	R/H	.0937	2.380	.3125	7.938	.1719	4.366	.1406	3.571	.359	.031	.173	.282	.003	6	1/16	60	22	68
SSRI-418	H	.1250	3.175	.2500	6.350	.1406	3.571	.1094	2.779	.296	.031	.161	.228	.003	7	.0394	30	11	79
SSRI-418	R	.1250	3.175	.2500	6.350	.1406	3.571	.1094	2.779	.296	.031	.161	.228	.003	8	.0394	33	12	79
SSRI-518	R/H	.1250	3.175	.3125	7.938	.1719	4.366	.1406	3.571	.359	.031	.173	.282	.003	6	1/16	60	22	68
SSRI-618	R/H	.1250	3.175	.3750	9.525	.1719	4.366	.1406	3.571	.422	.031	.173	.282	.005	6	1/16	60	22	68
SSR-2	R/H	.1250	3.175	.3750	9.525	.1875	4.763	.1562	3.967	.440	.030	.200	.321	.012	7	1/16	66	26	61
SSRI-5532	H	.1562	3.967	.3125	7.938	.1562	3.967	.1250	3.175	.359	.036	.221	.285	.003	7	3/64	41	15	61
SSRI-5532	R	.1562	3.967	.3125	7.938	.1562	3.967	.1250	3.175	.359	.036	.221	.285	.003	8	3/64	45	17	61
SSRI-5632	H	.1875	4.763	.3125	7.938	.1562	3.967	.1250	3.175	.359	.036	.221	.285	.003	7	3/64	41	15	61
SSRI-5632	R	.1875	4.763	.3125	7.938	.1562	3.967	.1250	3.175	.359	.036	.221	.285	.003	8	3/64	45	17	61
SSRI-6632	R/H	.1875	4.763	.3750	9.525	.1562	3.967	.1250	3.175	.422	.031	.235	.341	.003	8	1/16	76	31	54
SSR-3	R/H	.1875	4.763	.5000	12.700	.2272	5.771	.1960	4.978	.565	.042	.276	.433	.012	7	3/32	140	59	44
SSRI-614	H	.2500	6.350	.3750	9.525	.1562	3.967	.1250	3.175	.422	.036	.285	.348	.003	13	.0394	43	21	48
SSRI-814	R/H	.2500	6.350	.5000	12.700	.2188	5.558	.1875	4.763	.547	.045	.330	.452	.005	10	1/16	88	40	40
SSR-4	R/H	.2500	6.350	.6250	15.875	.2260	5.740	.1960	4.978	.690	.042	.364	.544	.012	8	3/32	159	70	35
SSRI-8516	R	.3125	7.938	.5000	12.700	.1875	4.763	.1562	3.967	.547	.031	.362	.460	.005	11	1/16	93	43	37



## Modified Dimension Radial Open, Unflanged & Flanged

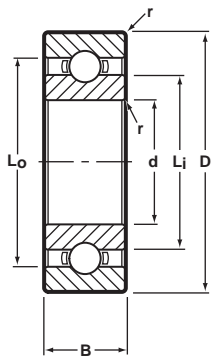

**Unflanged  
Ribbon Cage**

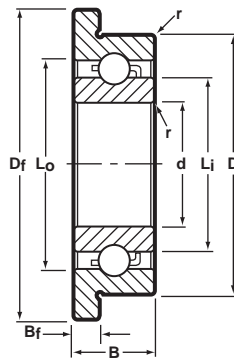

**Flanged  
Crown Cage**

### Notes:

1. Inch to metric conversion—see page 57.
2. Basic part numbers shown below include code "SS" for AISI 440C stainless steel. If SAE 52100 chrome alloy steel is desired delete SS.
3. See page 7 for ABEC tolerances.
4. r=Maximum shaft or housing fillet radius that bearing corners will clear.

\* "R" Ribbon or "H" Crown Cages are available as indicated. Please consult with factory for machined cage availability unless already noted.

◇ Metric dimensions for reference only.

▲ Available only as flanged type.

\*\* Load ratings are based on ABMA Standard #12.

BASIC P/N	CAGE TYPE *	BORE d		O.D. D		WIDTH B		FLANGE DIA. D <sub>f</sub>	FLANGE WIDTH B <sub>f</sub>	LAND DIAMETER (REFERENCE)		FILLET RADIUS r	BALL COMPLEMENT		LOAD RATINGS**		N <sub>max</sub> /h rpm/1000
		INCH	(mm)◇	INCH	(mm)◇	INCH	(mm)◇			L <sub>i</sub>	L <sub>o</sub>		NO. Z	SIZE D <sub>b</sub>	DYN. C	STATIC C <sub>0</sub>	
SSRIF-2X2▲	H	.0400	1.016	.1250	3.175	.0469	1.191	.171	.013	.064	.101	.003	6	.025	11	3	183
SSRIF-2 1/2SD501▲	H	.0469	1.191	.1562	3.967	.0625	1.588	.198	.013	.081	.124	.003	6	1/32	16	5	149
SSRIF-3332SD503▲	R	.0781	1.984	.1875	4.763	.0625	1.588	.226	.018	.118	.161	.003	8	1/32	35	14	109
SSRIF-418SD513▲	R	.0781	1.984	.2500	6.350	.0625	1.588	.296	.018	.161	.216	.003	8	.0394	53	22	79
SSRI-3332N1MC	KC/M5	.0925	2.350	.1875	4.763	.0625	1.588	—	—	.118	.161	.003	7	1/32	19	6	109
SSRI-3332A02	H	.0937	2.380	.3125	7.938	.0625	1.588	—	—	.118	.161	.003	7	1/32	19	6	109
SSRI-3332A02	R	.0937	2.380	.3125	7.938	.0625	1.588	—	—	.118	.161	.003	8	1/32	21	8	109
SSRI-418A62N	H	.0937	2.380	.4250	10.795	.0937	2.380	—	—	.161	.216	.003	7	.0394	30	11	79
SSRI-418A62N	R	.0937	2.380	.4250	10.795	.0937	2.380	—	—	.161	.216	.003	8	.0394	33	12	79
SSRI-5A62	H	.0937	2.380	.4500	11.430	.1094	2.779	—	—	.173	.270	.003	6	1/16	60	22	68
SSRI-418N1	H	.0947	2.405	.2500	6.350	.0937	2.380	—	—	.161	.216	.003	7	.0394	30	11	79
SSRI-418N1	R	.0947	2.405	.2500	6.350	.0937	2.380	—	—	.161	.216	.003	8	.0394	33	12	79
SSRI-3 1/2 18	R/H	.1250	3.175	.2188	5.558	.0937	2.380	—	—	.150	.193	.005	7	1/32	21	7	89
SSRI-418Y02	H	.1250	3.175	.2500	6.350	.0625	1.588	—	—	.171	.214	.003	9	1/32	23	9	79
SSRIFW-518▲	R/H	.1250	3.175	.3125	7.938	.1094	2.779	.359	.029	.173	.270	.003	6	1/16	60	22	68
SSRI-418A0223	H	.1250	3.175	.3750	9.525	.0650	1.651	—	—	.171	.214	.003	9	1/32	23	9	79
SSRIF-618SD504▲	H	.1250	3.175	.3750	9.525	.1094	2.779	.412	.023	.173	.270	.005	6	1/16	60	22	68
SSRIF-518A91▲	R/H	.1250	3.175	.4100	10.414	.1094	2.779	.438	.023	.173	.270	.003	6	1/16	60	22	68
SSRI-518A62	H	.1250	3.175	.4500	11.430	.1094	2.779	—	—	.173	.270	.003	6	1/16	60	22	68
SSRI-518A03	R/H	.1250	3.175	.5000	12.700	.1094	2.779	—	—	.173	.270	.003	6	1/16	60	22	68
SSRIF-5532A91▲	H	.1562	3.967	.4100	10.414	.1094	2.779	.438	.023	.221	.279	.003	7	3/64	41	15	61
SSRIF-5532A91▲	R	.1562	3.967	.4100	10.414	.1094	2.779	.438	.023	.221	.279	.003	8	3/64	45	17	61
SSRI-614Y05	H	.2500	6.350	.3750	9.525	.1094	2.779	—	—	.285	.341	.003	13	.0394	43	21	48
SSRIF-814X3▲	R	.2500	6.350	.5000	12.700	.1250	3.175	.547	.023	.315	.433	.005	8	5/64	114	48	40
SSRI-1038Y06	R	.3750	9.525	.6250	15.875	.1250	3.175	—	—	.458	.541	.010	12	1/16	95	49	30
SSRIF-1438SD503▲	R	.3750	9.525	.8750	22.225	.2188	5.558	.969	.062	.521	.741	.016	7	5/32	569	273	24



## Modified Dimension Radial Shielded, Unflanged & Flanged

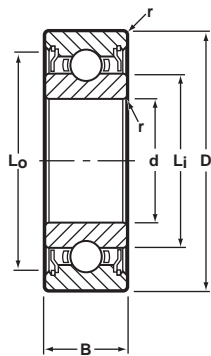

**Unflanged  
2 Shields  
Ribbon Cage**

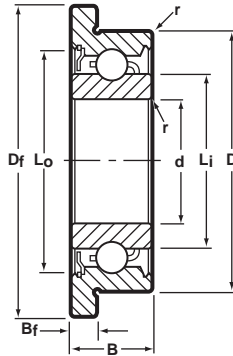

**Flanged  
1 Shield  
Crown Cage**

### Notes:

1. Inch to metric conversion—see page 57.
2. Basic part numbers shown below include code "SS" for AISI 440C stainless steel. If SAE 52100 chrome alloy steel is desired delete SS.
3. See page 7 for ABEC tolerances.
4. r=Maximum shaft or housing fillet radius that bearing corners will clear.

\* "R" Ribbon or "H" Crown Cages are available as indicated. Please consult with factory for machined cage availability unless already noted.

◇ Metric dimensions for reference only.

▲ Available only as flanged type.

\*\* Load ratings are based on ABMA Standard #12.

BASIC P/N	CAGE TYPE *	BORE d		O.D. D		WIDTH B				FLANGE DIA Df	FLANGE WIDTH Bf	LAND DIAMETER (REFERENCE)		FILLET RADIUS r	BALL COMPLEMENT		LOAD RATINGS**		Nmax/n rpm/1000
		INCH	(mm)◇	INCH	(mm)◇	1 SHIELD		2 SHIELDS				Lj	Lo		NO. Z	SIZE Db	DYN. C	STATIC Co	
						INCH	(mm)◇	INCH	(mm)◇										
SSRI-2 1/2ZZA11	H	.0469	1.191	.1875	4.763	—	—	.0937	2.380	—	—	.081	.134	.003	6	1/32	16	5	149
SSRIF-418ZZSD516▲	R	.0781	1.984	.2500	6.350	—	—	.0937	2.380	.296	.018	.161	.228	.003	8	.0394	53	22	79
SSRI-4ZZY05	H	.0781	1.984	.2500	6.350	—	—	.1094	2.779	—	—	.122	.205	.003	7	.0394	29	10	98
SSRI-4ZN6	H	.0800	2.032	.2500	6.350	.1094	2.779	—	—	—	—	.122	.205	.003	6	3/64	35	12	97
SSRI-5ZN	R	.0902	2.291	.3125	7.938	.1094	2.779	—	—	—	—	.188	.270	.003	8	3/64	44	17	68
SSRI-3332ZZN4MC	KC/M5	.0932	2.367	.1875	4.763	—	—	.0937	2.380	—	—	.118	.167	.003	7	1/32	19	6	109
SSRI-5ZA91	R	.0937	2.380	.4100	10.414	.1094	2.779	—	—	—	—	.173	.282	.003	6	1/16	60	22	68
SSRI-418ZN	H	.0937	2.380	.2500	6.350	.0937	2.380	—	—	—	—	.161	.228	.003	7	.0394	30	11	79
SSRI-418ZZN	H	.0937	2.380	.2500	6.350	—	—	.1094	2.779	—	—	.161	.228	.003	7	.0394	30	11	79
SSRI-418ZN	R	.0937	2.380	.2500	6.350	.0937	2.380	—	—	—	—	.161	.228	.003	8	.0394	33	12	79
SSRI-418ZZN	R	.0937	2.380	.2500	6.350	—	—	.1094	2.779	—	—	.161	.228	.003	8	.0394	33	12	79
SSRI-418ZZY04N	R	.0937	2.380	.2500	6.350	—	—	.0937	2.380	—	—	.161	.228	.003	8	.0394	33	12	79
SSRI-3332ZSD501	R	.0937	2.380	.2750	6.985	.0625	1.588	—	—	—	—	.118	.187	.003	8	1/32	21	7	109
SSRI-3332ZA1202	R	.0937	2.380	.2883	7.323	.0625	1.588	—	—	—	—	.118	.187	.003	8	1/32	21	8	109
SSRI-518ZA91N	R/H	.0937	2.380	.4100	10.414	.1094	2.779	—	—	—	—	.173	.270	.003	6	1/16	60	22	68
SSRI-418ZZY04	R	.1250	3.175	.2500	6.350	—	—	.0937	2.380	—	—	.161	.228	.003	8	.0394	33	12	79
SSRI-418ZW05	H	.1250	3.175	.2500	6.350	.1094	2.779	—	—	—	—	.161	.228	.003	7	.0394	30	11	79
SSRI-418ZW05	R	.1250	3.175	.2500	6.350	.1094	2.779	—	—	—	—	.161	.228	.003	8	.0394	33	12	79
SSRI-518ZZY05	R	.1250	3.175	.3125	7.938	—	—	.1094	2.779	—	—	.188	.270	.003	8	3/64	44	17	68
SSRI-418ZA02	R	.1250	3.175	.3750	9.525	.0937	2.380	—	—	—	—	.161	.228	.003	8	.0394	33	12	79
SSRI-418ZZA0204	R	.1250	3.175	.3750	9.525	—	—	.0937	2.380	—	—	.161	.228	.003	8	.0394	33	12	79
SSRI-618ZZY05	R/H	.1250	3.175	.3750	9.525	—	—	.1094	2.779	—	—	.188	.270	.005	8	3/64	44	17	68
SSRIF-618ZSD09▲	R	.1250	3.175	.3750	9.525	.1406	3.571	—	—	.500	.040	.173	.282	.005	6	1/16	60	22	68
SSRI-418ZA72	H	.1250	3.175	.4100	10.414	.0937	2.380	—	—	—	—	.161	.228	.003	7	.0394	30	11	79
SSRI-418ZA72	R	.1250	3.175	.4100	10.414	.0937	2.380	—	—	—	—	.161	.228	.003	8	.0394	33	12	79
SSRI-518ZA91	R	.1250	3.175	.4100	10.414	.1094	2.779	—	—	—	—	.173	.270	.003	6	1/16	60	22	68
SSRI-418ZA62	H	.1250	3.175	.4250	10.795	.0937	2.380	—	—	—	—	.161	.228	.003	7	.0394	30	11	79
SSRI-418ZZA62	H	.1250	3.175	.4250	10.795	—	—	.1094	2.779	—	—	.161	.228	.003	7	.0394	30	11	79
SSRI-418ZA62	R	.1250	3.175	.4250	10.795	.0937	2.380	—	—	—	—	.161	.228	.003	8	.0394	33	12	79
SSRI-418ZZA62	R	.1250	3.175	.4250	10.795	—	—	.1094	2.779	—	—	.161	.228	.003	8	.0394	33	12	79
SSRI-518ZA71	R/H	.1250	3.175	.4250	10.795	.1094	2.779	—	—	—	—	.173	.282	.003	6	1/16	60	22	68
SSRI-418ZA03	R	.1250	3.175	.4375	11.113	.0937	2.380	—	—	—	—	.161	.228	.003	8	.0394	33	12	79
SSRI-418ZZA0304	R	.1250	3.175	.4375	11.113	—	—	.0937	2.380	—	—	.161	.228	.003	8	.0394	33	12	79
SSRI-518ZZA0305	R	.1250	3.175	.5000	12.700	—	—	.1094	2.779	—	—	.188	.270	.003	8	3/64	44	17	68
SSR-2ZZA01	R/H	.1250	3.175	.5000	12.700	—	—	.1562	3.967	—	—	.200	.321	.012	7	1/16	66	26	61



## Modified Dimension Radial Shielded, Unflanged & Flanged (continued)

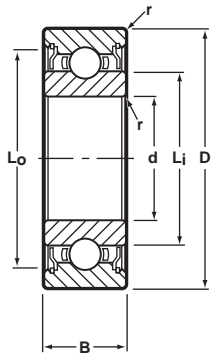

**Unflanged  
2 Shields  
Ribbon Cage**

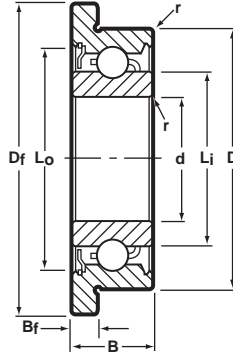

**Flanged  
1 Shield  
Crown Cage**

### Notes:

1. Inch to metric conversion—see page 57.
2. Basic part numbers shown below include code "SS" for AISI 440C stainless steel. If SAE 52100 chrome alloy steel is desired delete SS.
3. See page 7 for ABEC tolerances.
4. r=Maximum shaft or housing fillet radius that bearing corners will clear.

\* "R" Ribbon or "H" Crown Cages are available as indicated. Please consult with factory for machined cage availability.

◇ Metric dimensions for reference only.

▲ Available only as flanged type.

\*\* Load ratings are based on ABMA Standard #12.

BASIC P/N	CAGE TYPE *	BORE d		O.D. D		WIDTH B				FLANGE DIA Df	FLANGE WIDTH Bf	LAND DIAMETER (REFERENCE)		FILLET RADIUS r	BALL COMPLEMENT		LOAD RATINGS**		Nmax/fn rpm/1000
		INCH	(mm)◇	INCH	(mm)◇	1 SHIELD		2 SHIELDS				Lj	Lo		NO. Z	SIZE Db	DYN. C	STATIC Co	
						INCH	(mm)◇	INCH	(mm)◇										
SSRI-814ZSD524	R/H	.1250	3.175	.5000	12.700	.1250	3.175	—	—	—	—	.330	.452	.005	10	1/16	88	40	40
SSRIF-814ZSD504▲	H	.1250	3.175	.5000	12.700	.1875	4.763	—	—	.547	.023	.330	.452	.005	10	1/16	88	40	40
SSRI-6632ZZSD510	R	.1250	3.175	.5769	14.653	—	—	.1250	3.175	—	—	.235	.341	.003	8	1/16	76	31	54
SSRI-6632ZZSD509	H	.1250	3.175	.7500	19.050	—	—	.1250	3.175	—	—	.235	.341	.003	8	1/16	76	31	54
SSR-2ZZSD513	H	.1562	3.967	.3750	9.525	—	—	.1562	3.967	—	—	.200	.300	.012	7	1/16	66	26	61
SSRI-6632ZZSD508	R	.1567	3.980	.3750	9.525	—	—	.1250	3.175	—	—	.235	.341	.003	8	1/16	76	31	54
SSR-2ZZSD502	R/H	.1567	3.980	.3750	9.525	—	—	.1562	3.967	—	—	.200	.300	.012	7	1/16	66	26	61
SSRI-5632XZ	R	.1875	4.763	.3125	7.938	.1094	2.779	—	—	—	—	.224	.285	.003	11	.0394	40	17	61
SSRI-5632XZY05	R	.1875	4.763	.3125	7.938	—	—	.1094	2.779	—	—	.224	.285	.003	11	.0394	40	17	61
SSRIF-5632XZZ▲	R	.1875	4.763	.3125	7.938	—	—	.1250	3.175	.359	.036	.224	.285	.003	11	.0394	40	17	61
SSRI-5632XZA0105	R	.1875	4.763	.3750	9.525	—	—	.1094	2.779	—	—	.224	.286	.003	11	.0394	39	17	61
SSRI-6632XZY05	H	.1875	4.763	.3750	9.525	.1094	2.779	—	—	—	—	.221	.285	.003	7	3/64	41	15	61
SSRI-6632XZY05	R	.1875	4.763	.3750	9.525	.1094	2.779	—	—	—	—	.221	.285	.003	8	3/64	45	17	61
SSRI-5632ZA91	H	.1875	4.763	.4100	10.414	.1094	2.779	—	—	—	—	.221	.285	.003	7	3/64	41	15	61
SSRI-5632ZA91	R	.1875	4.763	.4100	10.414	.1094	2.779	—	—	—	—	.221	.285	.003	8	3/64	45	17	61
SSRI-5632ZZA71	H	.1875	4.763	.4250	10.795	—	—	.1250	3.175	—	—	.221	.285	.003	7	3/64	41	15	61
SSRI-5632ZZA71	R	.1875	4.763	.4250	10.795	.1094	2.779	—	—	—	—	.221	.285	.003	8	3/64	45	17	61
SSRI-5632ZZA71	R	.1875	4.763	.4250	10.795	—	—	.1250	3.175	—	—	.221	.285	.003	8	3/64	45	17	61
SSRI-5632XZZA0205	R	.1875	4.763	.4375	11.113	—	—	.1094	2.779	—	—	.224	.285	.003	11	.0394	40	17	61
SSRI-6632ZA6105	R	.1875	4.763	.4600	11.684	.1094	2.779	—	—	—	—	.235	.341	.003	8	1/16	76	31	54
SSRI-6632ZA0205	R	.1875	4.763	.5000	12.700	.1094	2.779	—	—	—	—	.235	.341	.003	8	1/16	76	31	54
SSRI-5632ZZA03	H	.1875	4.763	.5000	12.700	—	—	.1250	3.175	—	—	.221	.285	.003	7	3/64	41	15	61
SSRI-5632ZZA03	R	.1875	4.763	.5000	12.700	—	—	.1250	3.175	—	—	.221	.285	.003	8	3/64	45	17	61
SSRI-6632ZZA0208	R/H	.1875	4.763	.5000	12.700	—	—	.1562	3.967	—	—	.235	.341	.012	8	1/16	76	31	54
SSRIF-6632ZZA0208	R/H	.1875	4.763	.5000	12.700	—	—	.1562	3.967	.565	.042	.235	.341	.012	8	1/16	76	31	54
SSR-3ZZY08	R	.1875	4.763	.5000	12.700	—	—	.1562	3.967	—	—	.295	.441	.012	8	.0787	112	49	43
SSRIF-814ZSD503▲	H	.1875	4.763	.5000	12.700	.1875	4.763	—	—	.547	.023	.330	.452	.005	10	1/16	88	40	40
SSR-3ZZA	R/H	.1875	4.763	.6250	15.875	—	—	.1960	4.978	—	—	.276	.433	.012	7	3/32	140	59	44
SSR-3ZZA42	R/H	.1875	4.763	.7435	18.885	—	—	.1960	4.978	—	—	.276	.433	.012	7	3/32	140	59	44
SSR-3ZZA02	R/H	.1875	4.763	.7500	19.050	—	—	.1960	4.978	—	—	.276	.433	.012	7	3/32	140	59	44
SSR-3ZZA62	R/H	.1875	4.763	.7717	19.601	—	—	.1960	4.978	—	—	.276	.433	.012	7	3/32	140	59	44
SSR-3ZZA03	H	.1875	4.763	.8750	22.225	—	—	.1960	4.978	—	—	.279	.433	.012	7	3/32	140	59	44
SSR-3ZZW20	R/H	.1875	4.763	.5000	12.700	—	—	.3125	7.938	—	—	.276	.433	.012	7	3/32	140	59	44
SSRI-614ZZA01	H	.2500	6.350	.4375	11.113	—	—	.1250	3.175	—	—	.285	.348	.003	13	.0394	43	21	48
SSRI-614ZZA0205	H	.2500	6.350	.5000	12.700	.1094	2.779	—	—	—	—	.285	.348	.003	13	.0394	43	21	48



## Modified Dimension Radial Shielded, Unflanged & Flanged (continued)

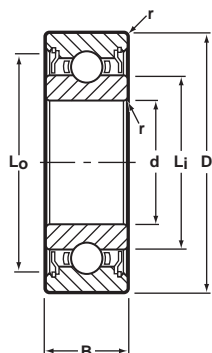

**Unflanged  
2 Shields  
Ribbon Cage**

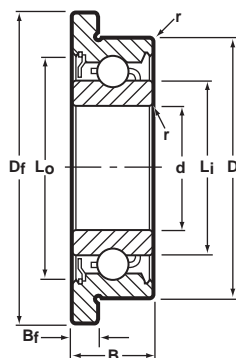

**Flanged  
1 Shield  
Crown Cage**

### Notes:

1. Inch to metric conversion—see page 57.
2. Basic part numbers shown below include code "SS" for AISI 440C stainless steel. If SAE 52100 chrome alloy steel is desired delete SS.
3. See page 7 for ABEC tolerances.
4. r=Maximum shaft or housing fillet radius that bearing corners will clear.

\* "R" Ribbon or "H" Crown Cages are available as indicated. Please consult with factory for machined cage availability.

◇ Metric dimensions for reference only.

▲ Available only as flanged type.

\*\* Load ratings are based on ABMA Standard #12.

BASIC P/N	CAGE TYPE *	BORE d		O.D. D		WIDTH B				FLANGE DIA Df	FLANGE WIDTH Bf	LAND DIAMETER (REFERENCE)		FILLET RADIUS r	BALL COMPLEMENT		LOAD RATINGS**		Nmax/n rpm/1000
		INCH	(mm)◇	INCH	(mm)◇	1 SHIELD		2 SHIELDS				Lj	Lo		NO. Z	SIZE Db	DYN. C	STATIC Co	
						INCH	(mm)◇	INCH	(mm)◇										
SSRI-8516ZZSD502	R	.2500	6.350	.5000	12.700	—	—	.1562	3.967	—	—	.362	.460	.005	11	1/16	93	43	37
SSRIF-8516ZZSD502▲	R	.2500	6.350	.5000	12.700	—	—	.1562	3.967	.547	.042	.362	.460	.005	11	1/16	93	43	37
SSR-4ZZA01	R/H	.2500	6.350	.7500	19.050	—	—	.1960	4.978	—	—	.364	.544	.012	8	3/32	159	70	35
SSR-4ZZA12	R	.2500	6.350	.8685	22.060	—	—	.1960	4.978	—	—	.364	.544	.012	8	3/32	159	70	35
SSR-4ZZA63	R	.2500	6.350	1.0415	26.454	—	—	.1960	4.978	—	—	.364	.544	.012	8	3/32	159	70	35
SSR-4ZZSD548	R	.2500	6.350	.6250	15.875	—	—	.3120	7.925	—	—	.364	.544	.012	8	3/32	159	70	35
SSR-4ZZSD561	R	.2500	6.350	.7050	17.907	—	—	.1960	4.978	—	—	.364	.544	.012	8	3/32	159	70	35
SSR-2270ZZW301	R	.2756	7.000	.8661	22.000	—	—	.4060	10.312	—	—	.424	.745	.016	7	5/32	569	273	24
SSRI-8516ZZA02	R	.3125	7.938	.6250	15.875	—	—	.1562	3.967	—	—	.362	.460	.005	11	1/16	93	43	37
SSR-2280ZZW301	R	.3150	8.000	.8661	22.000	—	—	.4060	10.312	—	—	.424	.745	.016	7	5/32	569	273	24
SSR-2280ZZW021	R	.3150	8.000	.8661	22.000	—	—	.4724	12.000	—	—	.424	.745	.016	7	5/32	425	208	24
SSRI-1438ZZA02	R	.3750	9.525	1.0000	25.400	—	—	.2812	7.142	—	—	.474	.783	.016	7	5/32	569	273	24

