

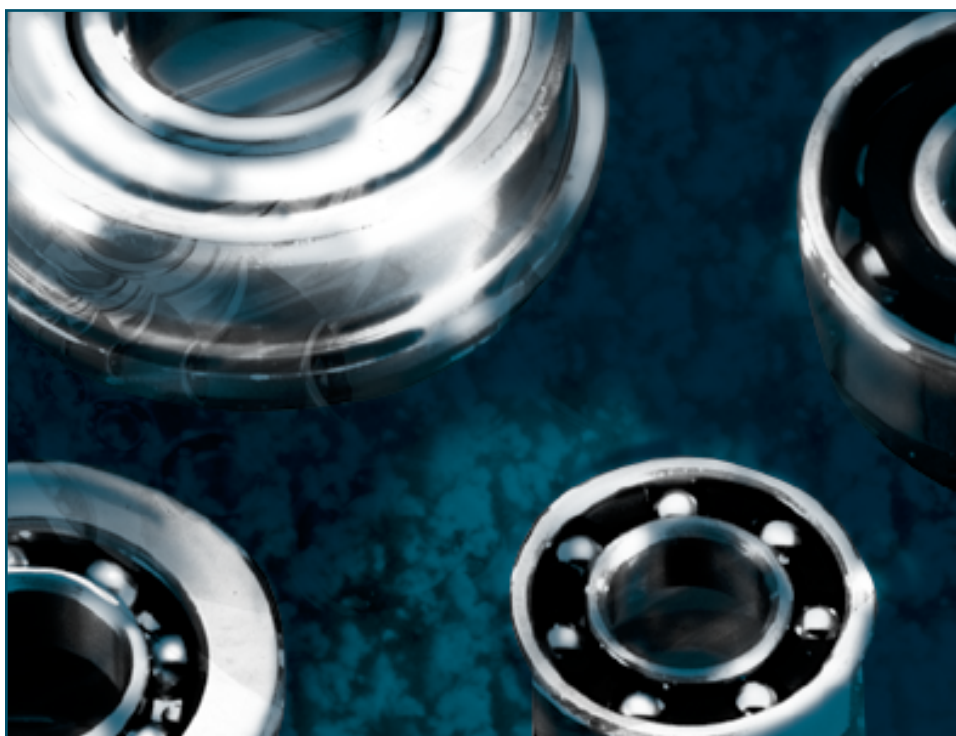

Metric

Metric L Series	
<u>Radial Open, Unflanged & Flanged</u>	<u>.26</u>
<u>Radial Shielded, Unflanged & Flanged</u>	<u>.27</u>
Metric R Series	
<u>Radial Open, Unflanged & Flanged</u>	<u>.28</u>
<u>Radial Shielded, Unflanged & Flanged</u>	<u>.29</u>





Radial Open, Unflanged & Flanged

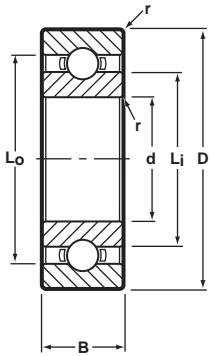

Unflanged

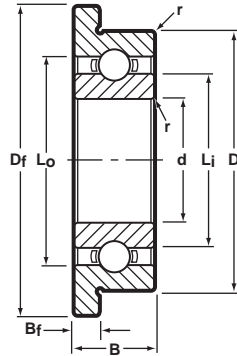

Flanged

Notes:

1. Metric to inch conversion—see page 57.
2. Basic part numbers shown below include code "SS" for AISI 440C stainless steel. If SAE 52100 chrome alloy steel is desired delete SS.
3. See page 7 for ABEC tolerances.
4. r=Maximum shaft or housing fillet radius that bearing corners will clear.
5. Please consult with factory for cage availability.

- ▲ Available only as flanged type.
- ☆ Production standard.
- † For flange bearing substitute prefix SSLF when applicable.
- ◇ Metric/inch conversion given for reference only.
- ** Load ratings are based on ABMA Standard #12.

BASIC P/N †	BORE d		O.D. D		WIDTH B		FLANGE DIA Df	FLANGE WIDTH Bf	LAND DIAMETER (REFERENCE)		FILLET RADIUS r		BALL COMPLEMENT		LOAD RATINGS** Lbs		Nmax/ñ rpm/1000
	mm	(INCH)◇	mm	(INCH)◇	mm	(INCH)◇			Li	Lo	mm	(INCH)◇	NO. Z	SIZE Db	DYN. C	STATIC Co	
SSL-310	1.0	.0394	3.0	.1181	1.0	.0394	3.8	0.3	1.60	2.42	0.05	.002	7	0.5mm	9	2	193
SSL-310W51	1.0	.0394	3.0	.1181	1.5	.0591	3.8	0.4	1.50	2.50	0.05	.002	5	0.635mm	9	2	193
SSL-415☆	1.5	.0591	4.0	.1575	1.2	.0472	5.0	0.4	2.26	3.26	0.05	.002	7	0.635mm	13	4	140
SSLFW-415☆▲	1.5	.0591	4.0	.1575	1.2	.0472	4.8	0.3	2.26	3.26	0.05	.002	7	0.635mm	13	4	140
SSL-520☆	2.0	.0787	5.0	.1969	1.5	.0591	6.1	0.5	2.90	4.00	0.08	.003	7	0.8mm	20	7	112
SSL-520W02	2.0	.0787	5.0	.1969	2.0	.0787	6.2	0.6	2.90	4.00	0.08	.003	7	0.8mm	20	7	112
SSL-625	2.5	.0984	6.0	.2362	1.8	.0709	7.1	0.5	3.80	4.90	0.08	.003	7	0.8mm	20	7	89
SSL-630	3.0	.1181	6.0	.2362	2.0	.0787	7.2	0.6	3.80	4.90	0.08	.003	7	0.8mm	20	7	89
SSL-730X5☆	3.0	.1181	7.0	.2756	2.0	.0787	8.1	0.5	4.10	5.80	0.10	.004	8	1.0mm	33	12	78
SSLFW-730▲	3.0	.1181	7.0	.2756	2.0	.0787	8.2	0.6	4.10	5.80	0.10	.004	7	3/64	40	15	78
SSL-740☆	4.0	.1575	7.0	.2756	2.0	.0787	8.2	0.6	4.80	5.90	0.08	.003	7	0.8mm	20	7	72
SSL-840	4.0	.1575	8.0	.3150	2.0	.0787	9.2	0.6	5.20	6.90	0.10	.004	7	3/64	40	15	64
SSL-940☆	4.0	.1575	9.0	.3543	2.5	.0984	10.3	0.6	5.08	7.62	0.10	.004	7	1/16	66	26	61
SSL-1040	4.0	.1575	10.0	.3937	3.0	.1181	11.2	0.6	6.00	8.30	0.15	.006	7	1/16	68	26	54
SSL-850	5.0	.1969	8.0	.3150	2.0	.0787	9.2	0.6	5.80	6.97	0.08	.003	13	0.8mm	29	13	59
SSL-850W82	5.0	.1969	8.0	.3150	2.8	.1102	—	—	5.80	6.97	0.08	.003	13	0.8mm	29	13	59
SSL-950	5.0	.1969	9.0	.3543	2.5	.0984	10.2	0.6	6.00	7.70	0.10	.004	7	3/64	40	15	56
SSL-1050	5.0	.1969	10.0	.3937	3.0	.1181	11.2	0.6	6.40	8.60	0.15	.006	7	1/16	68	26	52
SSL-1150	5.0	.1969	11.0	.4331	3.0	.1181	12.5	0.8	6.40	8.60	0.15	.006	8	1/16	75	31	48
SSL-1060☆	6.0	.2362	10.0	.3937	2.5	.0984	11.2	0.6	6.95	8.70	0.10	.004	9	3/64	49	18	49
SSL-1260	6.0	.2362	12.0	.4724	3.0	.1181	13.2	0.6	7.80	10.20	0.15	.006	7	1/16	68	29	43
SSL-1360	6.0	.2362	13.0	.5118	3.5	.1378	15.0	1.0	8.00	11.00	0.15	.006	8	2.0mm	115	49	41
SSL-1170	7.0	.2756	11.0	.4331	2.5	.0984	12.2	0.6	8.10	9.80	0.10	.004	9	3/64	46	20	43
SSL-1370	7.0	.2756	13.0	.5118	3.0	.1181	14.2	0.6	8.90	11.10	0.15	.006	9	1/16	82	37	39
SSL-1470W04	7.0	.2756	14.0	.5512	4.0	.1575	—	—	9.00	12.00	0.15	.006	9	2.0mm	126	55	37
SSLFW-1470▲	7.0	.2756	14.0	.5512	3.5	.1378	15.6	0.8	9.00	12.00	0.15	.006	9	2.0mm	126	55	37
SSL-1280	8.0	.3150	12.0	.4724	2.5	.0984	13.2	0.6	9.10	10.90	0.10	.004	11	3/64	53	24	39
SSL-1480	8.0	.3150	14.0	.5512	3.5	.1378	15.6	0.8	9.90	12.10	0.15	.006	10	1/16	86	42	35
SSL-1680☆	8.0	.3150	16.0	.6299	4.0	.1575	18.0	1.0	10.40	13.60	0.20	.008	9	3/32	170	79	32
SSLFW-1680▲	8.0	.3150	16.0	.6299	4.0	.1575	17.6	0.8	10.40	13.60	0.20	.008	9	3/32	170	79	32
SSL-1790	9.0	.3543	17.0	.6693	4.0	.1575	19.0	1.0	11.20	14.81	0.20	.008	10	3/32	183	88	30
SSL-2090	9.0	.3543	20.0	.7874	5.0	.1969	—	—	12.32	16.68	0.30	.012	9	7/64	225	108	27
SSL-1910☆	10.0	.3937	19.0	.7480	5.0	.1969	—	—	12.32	16.68	0.30	.012	9	7/64	225	108	27
SSL-1910Y54	10.0	.3937	19.0	.7480	4.5	.1772	—	—	12.32	16.68	0.30	.012	9	7/64	225	108	27

METRIC L SERIES



Radial Shielded, Unflanged & Flanged

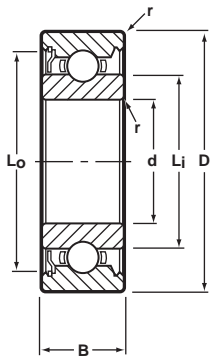

**Unflanged
1 Shield**

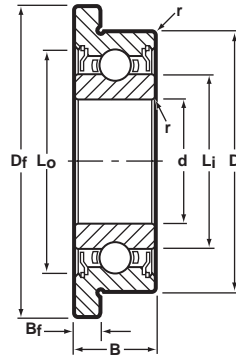

**Flanged
2 Shields**

Notes:

1. Metric to inch conversion—see page 57.
2. Basic part numbers shown below include code "SS" for AISI 440C stainless steel. If SAE 52100 chrome alloy steel is desired delete SS.
3. See page 7 for ABEC tolerances.
4. r=Maximum shaft or housing fillet radius that bearing corners will clear.
5. Please consult with factory for cage availability.
6. Add "Z" for single shield, "ZZ" for two shields as a suffix to basic part number prior to "Y" or "W" width variations.

▲ Available only as flanged type.

☆ Production standard.

† For flange bearing substitute prefix SSLF when applicable.

◇ Inch conversion given for reference only.

** Load ratings are based on ABMA Standard #12.

BASIC P/N †	BORE d		O.D. D		WIDTH B		FLANGE DIA Df	FLANGE WIDTH Bf	LAND DIAMETER (REFERENCE)		FILLET RADIUS r		BALL COMPLEMENT		LOAD RATINGS**		N _{max} /h rpm/1000
	mm	(INCH)◇	mm	(INCH)◇	mm	(INCH)◇			Li	Lo	mm	(INCH)◇	NO. Z	SIZE D _b	DYN. C	STATIC C ₀	
SSL-520	2.0	.0787	5.0	.1969	2.3	.0906	6.1	0.6	2.90	4.25	0.08	.003	7	0.8mm	20	7	112
SSL-520W52	2.0	.0787	5.0	.1969	2.5	.0984	6.2	0.6	2.90	4.25	0.08	.003	7	0.8mm	20	7	112
SSL-625	2.5	.0984	6.0	.2362	2.6	.1024	7.1	0.8	3.80	5.20	0.08	.003	7	0.8mm	20	7	89
SSL-630	3.0	.1181	6.0	.2362	2.5	.0984	7.2	0.6	3.80	5.20	0.08	.003	7	0.8mm	20	7	89
SSL-730X5☆	3.0	.1181	7.0	.2756	3.0	.1181	8.1	0.8	4.10	6.10	0.10	.004	8	1.0mm	33	12	78
SSLFW-730▲	3.0	.1181	7.0	.2756	3.0	.1181	8.2	0.6	4.10	6.10	0.10	.004	7	3/64	40	15	78
SSL-740	4.0	.1575	7.0	.2756	2.5	.0984	8.2	0.6	4.80	6.30	0.08	.003	7	0.8mm	20	7	72
SSL-840	4.0	.1575	8.0	.3150	3.0	.1181	9.2	0.6	5.20	7.20	0.10	.004	7	3/64	40	15	64
SSL-940	4.0	.1575	9.0	.3543	4.0	.1575	10.3	1.0	5.08	7.90	0.10	.004	7	1/16	66	26	61
SSLFW-940▲	4.0	.1575	9.0	.3543	4.0	.1575	10.6	0.8	5.08	7.90	0.10	.004	7	1/16	66	26	61
SSLF-1040X☆▲	4.0	.1575	10.0	.3937	4.0	.1575	11.6	0.8	5.96	8.75	0.15	.006	8	1/16	84	35	54
SSL-850	5.0	.1969	8.0	.3150	2.5	.0984	9.2	0.6	5.80	7.26	0.08	.003	13	0.8mm	29	13	59
SSL-950	5.0	.1969	9.0	.3543	3.0	.1181	10.2	0.6	6.00	8.00	0.10	.004	7	3/64	40	15	56
SSL-1050	5.0	.1969	10.0	.3937	4.0	.1575	11.6	0.8	6.40	8.90	0.15	.006	7	1/16	68	26	52
SSL-1150	5.0	.1969	11.0	.4331	5.0	.1969	12.5	1.0	6.40	9.50	0.15	.006	8	1/16	75	31	48
SSL-1060☆	6.0	.2362	10.0	.3937	3.0	.1181	11.2	0.6	6.95	9.00	0.10	.004	9	3/64	49	18	49
SSL-1060X	6.0	.2362	10.0	.3937	3.0	.1181	—	—	7.24	8.93	0.10	.004	13	1.0mm	47	22	49
SSL-1260	6.0	.2362	12.0	.4724	4.0	.1575	13.6	0.8	7.80	10.20	0.15	.006	7	1/16	68	29	43
SSL-1360	6.0	.2362	13.0	.5118	5.0	.1969	15.0	1.1	7.40	11.40	0.15	.006	8	2.0mm	115	49	41
SSLFW-1360▲	6.0	.2362	13.0	.5118	5.0	.1969	15.0	1.0	7.40	11.40	0.15	.006	8	2.0mm	115	49	41
SSL-1360Y54	6.0	.2362	13.0	.5118	4.5	.1772	15.0	1.0	8.00	11.40	0.15	.006	8	2.0mm	115	49	41
SSL-1170	7.0	.2756	11.0	.4331	3.0	.1181	12.2	0.6	8.10	10.10	0.10	.004	9	3/64	46	20	43
SSL-1370	7.0	.2756	13.0	.5118	4.0	.1575	14.6	0.8	8.50	11.50	0.15	.006	9	1/16	82	37	39
SSLFW-1470▲	7.0	.2756	14.0	.5512	5.0	.1969	16.0	1.0	9.00	12.40	0.15	.006	9	2.0mm	126	55	37
SSL-1470X☆	7.0	.2756	14.0	.5512	5.0	.1969	—	—	9.20	11.77	0.15	.006	11	1/16	102	50	37
SSL-1280	8.0	.3150	12.0	.4724	3.5	.1378	13.6	0.8	9.10	11.20	0.10	.004	11	3/64	53	24	39
SSL-1480	8.0	.3150	14.0	.5512	4.0	.1575	15.6	0.8	9.90	12.50	0.15	.006	10	1/16	86	42	35
SSL-1680☆	8.0	.3150	16.0	.6299	5.0	.1969	18.0	1.1	10.40	14.00	0.20	.008	9	3/32	170	79	32
SSL-1680W06	8.0	.3150	16.0	.6299	6.0	.2362	—	—	10.40	14.00	0.20	.008	9	3/32	170	79	32
SSL-1790	9.0	.3543	17.0	.6693	5.0	.1969	19.0	1.1	11.20	15.30	0.20	.008	10	3/32	183	88	30
SSL-2090	9.0	.3543	20.0	.7874	6.0	.2362	—	—	12.32	17.40	0.30	.012	9	7/64	225	108	27
SSL-1910☆	10.0	.3937	19.0	.7480	7.0	.2756	—	—	12.32	17.40	0.30	.012	9	7/64	225	108	27



Radial Open, Unflanged & Flanged

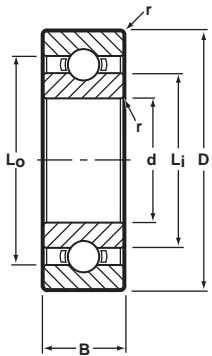

Unflanged

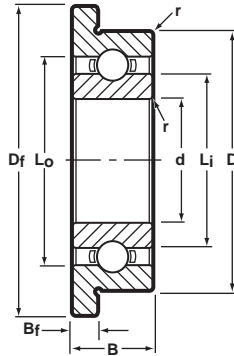

Flanged

Notes:

1. Metric to inch conversion—see page 57.
2. Basic part numbers shown below include code "SS" for AISI 440C stainless steel. If SAE 52100 chrome alloy steel is desired delete SS.
3. See page 7 for ABEC tolerances.
4. r=Maximum shaft or housing fillet radius that bearing corners will clear.
5. Please consult with factory for cage availability.

- ▲ Available only as flanged type.
- ☆ Production standard.
- † For flange bearing substitute prefix SSRF when applicable.
- ◇ Inch conversion given for reference only.
- ** Load ratings are based on ABMA Standard #12.

BASIC P/N †	BORE d		O.D. D		WIDTH B		FLANGE DIA Df	FLANGE WIDTH Bf	LAND DIAMETER (REFERENCE)		FILLET RADIUS r		BALL COMPLEMENT		LOAD RATINGS** Lbs		N _{max} /n rpm/1000
	mm	(INCH)◇	mm	(INCH)◇	mm	(INCH)◇			Li	Lo	mm	(INCH)◇	NO. Z	SIZE D _b	DYN. C	STATIC C ₀	
SSR-412	1.2	.0472	4.0	.1575	1.8	.0709	4.8	0.4	2.05	3.15	0.10	.004	6	0.8mm	18	4	149
SSR-515	1.5	.0591	5.0	.1969	2.0	.0787	6.5	0.6	2.60	3.70	0.15	.006	7	0.8mm	20	7	123
SSR-615	1.5	.0591	6.0	.2362	2.5	.0984	7.5	0.6	2.90	4.70	0.15	.006	6	3/64	35	13	102
SSR-620W52	2.0	.0787	6.0	.2362	2.5	.0984	7.2	0.6	3.10	4.90	0.15	.006	6	3/64	35	13	97
SSR-720Y52	2.0	.0787	7.0	.2756	2.5	.0984	8.2	0.6	3.80	5.50	0.15	.006	7	3/64	40	15	83
SSR-720	2.0	.0787	7.0	.2756	2.8	.1102	8.5	0.7	3.80	5.50	0.15	.006	7	3/64	40	15	83
SSR-725	2.5	.0984	7.0	.2756	2.5	.0984	8.5	0.7	3.80	5.50	0.15	.006	7	3/64	40	15	83
SSR-725▲	2.5	.0984	7.0	.2756	2.5	.0984	8.2	0.6	3.80	5.50	0.15	.006	7	3/64	40	15	83
SSR-825Y52	2.5	.0984	8.0	.3150	2.5	.0984	9.2	0.6	4.10	6.50	0.15	.006	6	1/16	60	22	73
SSR-825Y82	2.5	.0984	8.0	.3150	2.8	.1102	—	—	4.77	6.85	0.15	.006	8	3/64	44	18	68
SSR-825	2.5	.0984	8.0	.3150	2.8	.1102	9.5	0.7	4.10	6.50	0.15	.006	6	1/16	60	22	73
SSR-830Y52	3.0	.1181	8.0	.3150	2.5	.0984	9.2	0.6	4.10	6.50	0.15	.006	6	1/16	60	22	73
SSR-830	3.0	.1181	8.0	.3150	3.0	.1181	9.5	0.7	4.10	6.50	0.15	.006	6	1/16	60	22	73
SSR-930Y52	3.0	.1181	9.0	.3543	2.5	.0984	10.2	0.6	4.80	7.20	0.15	.006	7	1/16	66	26	64
SSR-930	3.0	.1181	9.0	.3543	3.0	.1181	10.5	0.7	4.80	7.20	0.15	.006	7	1/16	66	26	64
SSR-1030☆	3.0	.1181	10.0	.3937	4.0	.1575	11.5	1.0	5.08	7.62	0.15	.006	7	1/16	66	26	61
SSR-1030Y53	3.0	.1181	10.0	.3937	3.5	.1378	—	—	5.08	7.62	0.15	.006	7	1/16	66	26	61
SSR-1030▲	3.0	.1181	10.0	.3937	4.0	.1575	11.6	0.8	5.08	7.62	0.15	.006	7	1/16	66	26	61
SSR-1140	4.0	.1575	11.0	.4331	4.0	.1575	12.5	1.0	6.40	8.60	0.15	.006	8	1/16	75	31	52
SSR-1140Y53	4.0	.1575	11.0	.4331	3.5	.1378	—	—	6.40	8.60	0.15	.006	8	1/16	75	31	52
SSR-1140▲	4.0	.1575	11.0	.4331	4.0	.1575	12.6	0.8	6.40	8.60	0.15	.006	8	1/16	75	31	52
SSR-1240	4.0	.1575	12.0	.4724	4.0	.1575	13.5	1.0	6.50	9.50	0.20	.008	7	2.0mm	104	42	48
SSR-1340	4.0	.1575	13.0	.5118	5.0	.1969	15.0	1.0	7.00	10.46	0.20	.008	7	3/32	139	60	44
SSR-1640X☆	4.0	.1575	16.0	.6299	5.0	.1969	18.0	1.0	8.10	12.50	0.30	.012	8	3/32	157	68	36
SSR-1350	5.0	.1969	13.0	.5118	4.0	.1575	15.0	1.0	7.00	10.46	0.20	.010	7	3/32	139	60	44
SSR-1450	5.0	.1969	14.0	.5512	5.0	.1969	16.0	1.0	7.60	11.50	0.20	.010	7	3/32	139	60	40
SSR-1650X☆	5.0	.1969	16.0	.6299	5.0	.1969	18.0	1.0	8.10	12.50	0.30	.012	8	3/32	157	68	36
SSR-1950☆	5.0	.1969	19.0	.7480	6.0	.2362	22.0	1.5	9.50	15.60	0.30	.012	6	5/32	481	240	31
SSR-1560	6.0	.2362	15.0	.5906	5.0	.1969	17.0	1.2	8.60	12.40	0.15	.006	7	7/64	212	101	37
SSR-1560▲	6.0	.2362	15.0	.5906	5.0	.1969	17.0	1.0	8.60	12.40	0.15	.006	7	7/64	212	101	37
SSR-1760	6.0	.2362	17.0	.6693	6.0	.2362	19.0	1.2	8.90	14.10	0.20	.010	6	3.5mm	384	187	34
SSR-1960☆	6.0	.2362	19.0	.7480	6.0	.2362	22.0	1.5	9.50	15.60	0.30	.012	6	5/32	481	240	31
SSR-1970☆	7.0	.2756	19.0	.7480	6.0	.2362	—	—	10.60	15.55	0.30	.012	7	1/8	379	174	30
SSR-2270☆	7.0	.2756	22.0	.8661	7.0	.2756	25.0	1.5	10.76	17.95	0.30	.012	7	5/32	569	273	26
SSR-2280☆	8.0	.3150	22.0	.8661	7.0	.2756	25.0	1.5	10.76	17.95	0.30	.012	7	5/32	569	273	26
SSR-2690	9.0	.3543	26.0	1.0236	8.0	.3150	—	—	14.80	21.30	0.30	.012	7	3/16	703	399	21
SSR-2610	10.0	.3937	26.0	1.0236	8.0	.3150	—	—	14.80	21.30	0.30	.012	7	3/16	703	399	21

METRIC R SERIES



Radial Shielded, Unflanged & Flanged

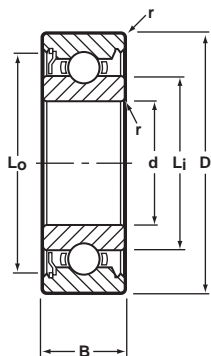

**Unflanged
1 Shield**

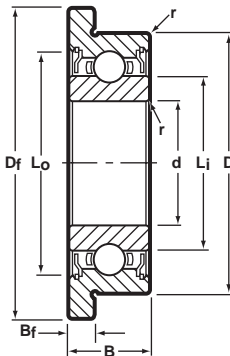

**Flanged
2 Shields**

Notes:

1. Metric to inch conversion—see page 57.
2. Basic part numbers shown below include code "SS" for AISI 440C stainless steel. If SAE 52100 chrome alloy steel is desired delete SS.
3. See page 7 for ABEC tolerances.
4. r=Maximum shaft or housing fillet radius that bearing corners will clear.
5. Please consult with factory for cage availability.
6. Add "Z" for single shield, "ZZ" for two shields as a suffix to basic part number prior to "Y" or "W" width variations.

▲ Available only as flanged type.

☆ Production standard.

† For flange bearing substitute prefix SSRF when applicable.

◇ Inch conversion given for reference only.

** Load ratings are based on ABMA Standard #12.

BASIC P/N †	BORE d		O.D. D		WIDTH B		FLANGE DIA Df	FLANGE WIDTH Bf	LAND DIAMETER (REFERENCE)		FILLET RADIUS r		BALL COMPLEMENT		LOAD RATINGS**		N _{max} /h rpm/1000
	mm	(INCH)◇	mm	(INCH)◇	mm	(INCH)◇			Lj	Lo	mm	(INCH)◇	NO. Z	SIZE D _b	DYN. C	STATIC C ₀	
SSR-515	1.5	.0591	5.0	.1969	2.6	.1024	6.5	0.8	2.60	4.00	0.15	.006	7	0.8mm	20	7	123
SSR-515Y52	1.5	.0591	5.0	.1969	2.5	.0984	—	—	2.60	4.00	0.15	.006	7	0.8mm	20	7	123
SSR-615	1.5	.0591	6.0	.2362	3.0	.1181	7.5	0.8	2.90	5.00	0.15	.006	6	3/64	35	11	102
SSR-620	2.0	.0787	6.0	.2362	3.0	.1181	7.5	0.8	3.10	5.20	0.15	.006	6	3/64	35	13	98
SSRFW-620▲	2.0	.0787	6.0	.2362	3.0	.1181	7.2	0.6	3.10	5.20	0.15	.006	6	3/64	35	13	98
SSR-620Y52	2.0	.0787	6.0	.2362	2.5	.0984	7.2	0.6	3.10	5.20	0.15	.006	6	3/64	35	13	98
SSR-620Y32	2.0	.0787	6.0	.2362	2.3	.0906	—	—	3.16	5.20	0.15	.006	7	1.0mm	29	11	98
SSR-720Y03	2.0	.0787	7.0	.2756	3.0	.1181	8.2	0.6	3.80	5.90	0.15	.006	7	3/64	40	15	83
SSR-720	2.0	.0787	7.0	.2756	3.5	.1378	8.5	0.9	3.80	5.90	0.15	.006	7	3/64	40	15	83
SSR-725Y03	2.5	.0984	7.0	.2756	3.0	.1181	8.2	0.6	3.80	5.90	0.15	.006	7	3/64	40	15	83
SSR-725	2.5	.0984	7.0	.2756	3.5	.1378	8.5	0.9	3.80	5.90	0.15	.006	7	3/64	40	15	83
SSR-825	2.5	.0984	8.0	.3150	4.0	.1575	9.5	0.9	4.10	7.16	0.15	.006	6	1/16	60	22	73
SSRFW-825▲	2.5	.0984	8.0	.3150	4.0	.1575	9.6	0.8	4.10	7.16	0.15	.006	6	1/16	60	22	73
SSR-830	3.0	.1181	8.0	.3150	4.0	.1575	9.5	0.9	4.10	7.16	0.15	.006	6	1/16	60	22	73
SSR-830Y03	3.0	.1181	8.0	.3150	3.0	.1181	—	—	4.77	6.85	0.15	.006	8	3/64	44	18	68
SSRFW-830▲	3.0	.1181	8.0	.3150	4.0	.1575	9.6	0.8	4.10	7.16	0.15	.006	6	1/16	60	22	73
SSR-930Y04	3.0	.1181	9.0	.3543	4.0	.1575	10.6	0.8	4.80	7.60	0.15	.006	7	1/16	66	26	64
SSR-930	3.0	.1181	9.0	.3543	5.0	.1969	10.5	1.0	4.80	7.60	0.15	.006	7	1/16	66	26	64
SSR-1030☆	3.0	.1181	10.0	.3937	4.0	.1575	11.5	1.0	5.08	8.20	0.15	.006	7	1/16	66	26	61
SSRFW-1030▲	3.0	.1181	10.0	.3937	4.0	.1575	11.6	0.8	5.08	8.20	0.15	.006	7	1/16	66	26	61
SSR-1140	4.0	.1575	11.0	.4331	4.0	.1575	12.5	1.0	6.40	9.50	0.20	.008	8	1/16	75	31	52
SSRFW-1140▲	4.0	.1575	11.0	.4331	4.0	.1575	12.6	0.8	6.40	9.50	0.20	.008	8	1/16	75	31	52
SSR-1140X☆	4.0	.1575	11.0	.4331	4.0	.1575	—	—	5.97	8.75	0.30	.012	8	1/16	75	31	52
SSR-1240	4.0	.1575	12.0	.4724	4.0	.1575	13.5	1.0	6.50	9.95	0.20	.008	7	2.0mm	104	42	48
SSR-1340	4.0	.1575	13.0	.5118	5.0	.1969	15.0	1.0	7.00	11.00	0.20	.008	7	3/32	139	60	44
SSR-1640X☆	4.0	.1575	16.0	.6299	5.0	.1969	18.0	1.0	8.10	13.20	0.30	.012	8	3/32	157	68	36
SSR-1350WO5	5.0	.1969	13.0	.5118	5.0	.1969	15.0	1.0	7.50	11.10	0.20	.008	7	3/32	139	60	44
SSR-1350	5.0	.1969	13.0	.5118	4.0	.1575	15.0	1.0	7.50	11.10	0.20	.008	8	2.0mm	112	49	43
SSR-1450	5.0	.1969	14.0	.5512	5.0	.1969	16.0	1.0	6.95	12.10	0.20	.008	7	3/32	139	60	40
SSR-1650X☆	5.0	.1969	16.0	.6299	5.0	.1969	18.0	1.0	8.10	13.20	0.30	.012	8	3/32	157	68	36
SSR-1950☆	5.0	.1969	19.0	.7480	6.0	.2362	22.0	1.5	8.74	16.22	0.30	.012	6	5/32	481	240	31
SSR-1560	6.0	.2362	15.0	.5906	5.0	.1969	17.0	1.2	7.76	13.20	0.15	.006	7	7/64	212	101	37
SSRFW-1560▲	6.0	.2362	15.0	.5906	5.0	.1969	17.0	1.0	7.76	13.20	0.15	.006	7	7/64	212	101	37
SSR-1760	6.0	.2362	17.0	.6693	6.0	.2362	19.0	1.2	8.22	14.77	0.20	.008	6	3.5mm	384	187	34
SSR-1960☆	6.0	.2362	19.0	.7480	6.0	.2362	22.0	1.5	8.74	16.22	0.30	.012	6	5/32	481	240	31
SSR-1970☆	7.0	.2756	19.0	.7480	6.0	.2362	22.0	1.5	10.60	15.90	0.30	.012	7	1/8	379	174	30
SSR-2270☆	7.0	.2756	22.0	.8661	7.0	.2756	25.0	1.5	10.76	18.90	0.30	.012	7	5/32	569	273	26
SSR-1980X☆	8.0	.3150	19.0	.7480	6.0	.2362	22.0	1.5	10.60	15.90	0.30	.012	7	1/8	379	174	30
SSR-2280☆	8.0	.3150	22.0	.8661	7.0	.2756	25.0	1.5	10.76	18.90	0.30	.012	7	5/32	569	273	26
SSR-2690	9.0	.3543	26.0	1.0236	8.0	.3150	—	—	13.80	22.66	0.30	.012	7	3/16	703	399	21
SSR-2610	10.0	.3937	26.0	1.0236	8.0	.3150	—	—	13.80	22.66	0.30	.012	7	3/16	703	399	21