

S-Type Sealed-Clean Bearings for Chain Conveyors

*Greatly Improved Seals Assure Years of Maintenance-Free Service
Even in the Presence of Water, Scale, and High Temperatures*

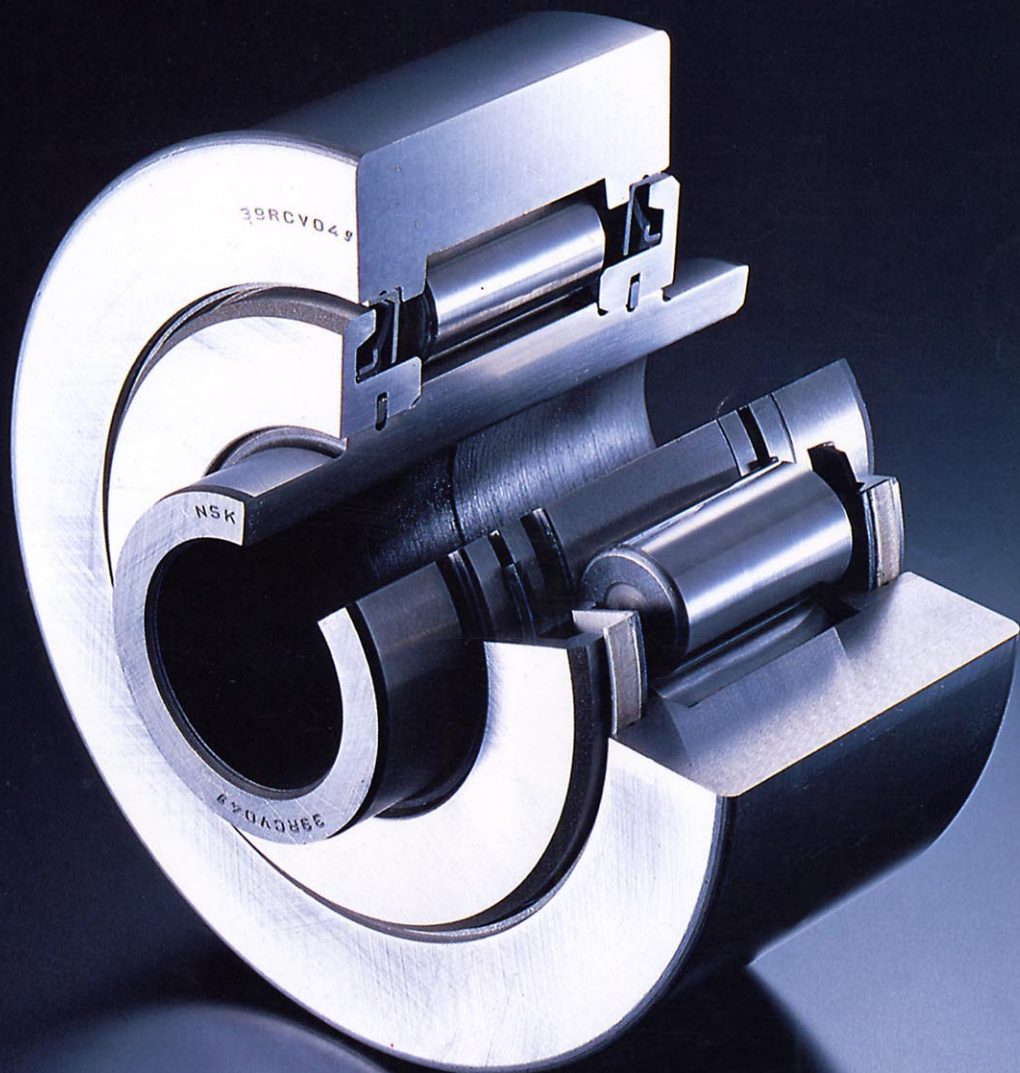

Tough, Newly Designed, Sealed-Clean Roller Bearings Eliminate Maintenance for Chain Conveyors. A Range of Popular Sizes is Available to Satisfy Any Requirement.



NSK developed a series (S-Type) of tough, sealed-clean roller bearings for chain conveyors that must operate under severe conditions. They feature newly designed seals with exceptional effectiveness. These seals, combined with specially formulated grease, assure long life with no maintenance, even at high temperatures and in the presence of water and scale. Also, the inner and outer rings are made of case-hardened steel to make them resistant to shock loads. For rugged operating conditions, S-Type chain-conveyor bearings are the solution to maintenance problems.

Example of Chain Conveyors with S-Type Bearings

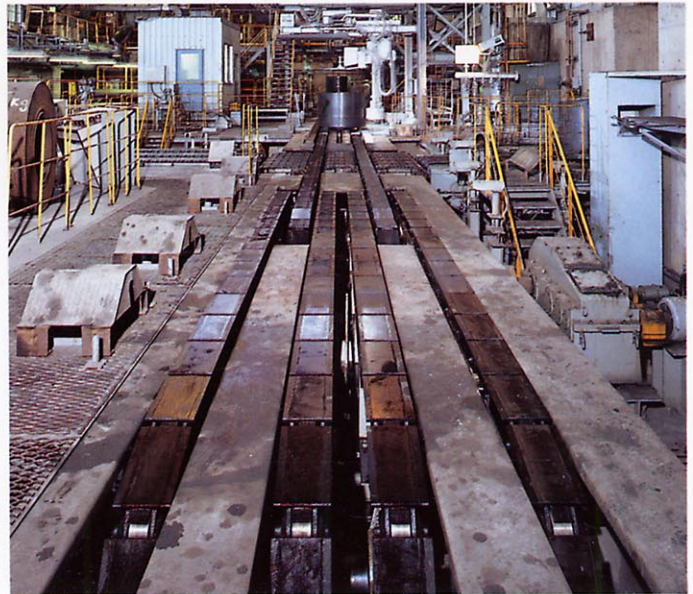
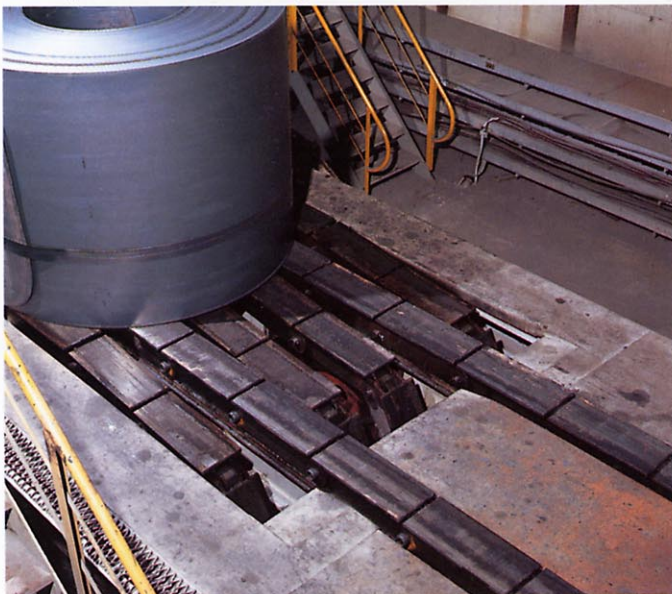

Design and Features of **NSK** S-Type Sealed-Clean Chain-Conveyor Bearings

1. The seals are newly developed side-contact types
—— Excellent Seal Effectiveness ——

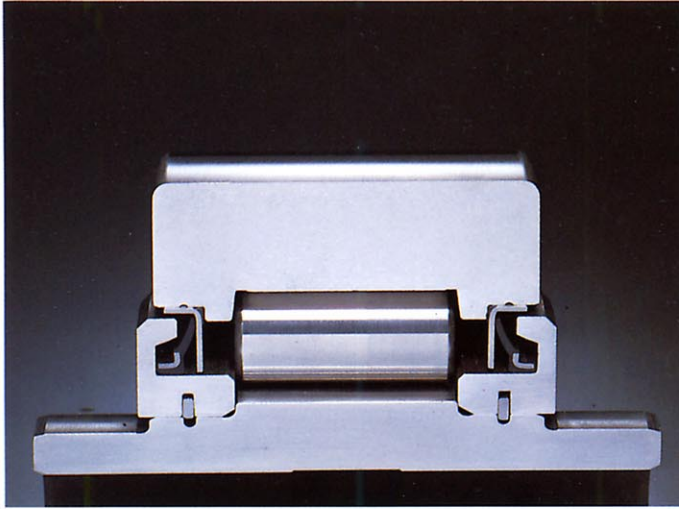

Features of S-Type Side Seal

- ① A highly elastic seal lip contacts a seal plate axially for positive sealing
- ② The S-Type seal offers low torque and high wear resistance

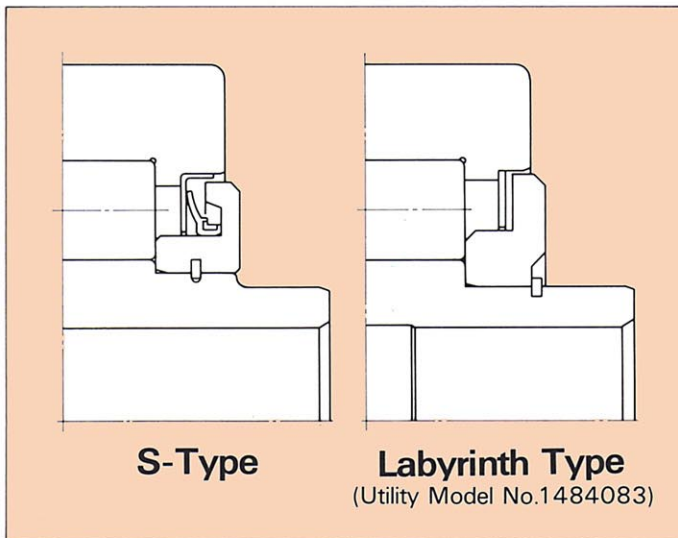

Advantages of S-Type Sealed-Clean Bearings

- Long bearing life and high reliability
Five years of maintenance-free service have been demonstrated
- Greatly reduced grease consumption
- No grease leakage and dispersion

2. The grease packed in each bearing is specially formulated for heat resistance and long life
—— Long replenishing interval ——

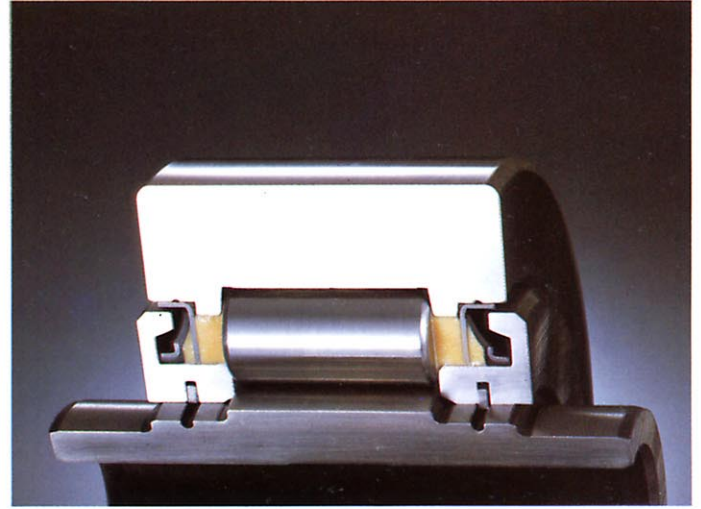

3. Sturdy shields are firmly fixed on the inner ring with special snap rings
—— High thrust rigidity and wear resistance of roller-rib surfaces ——

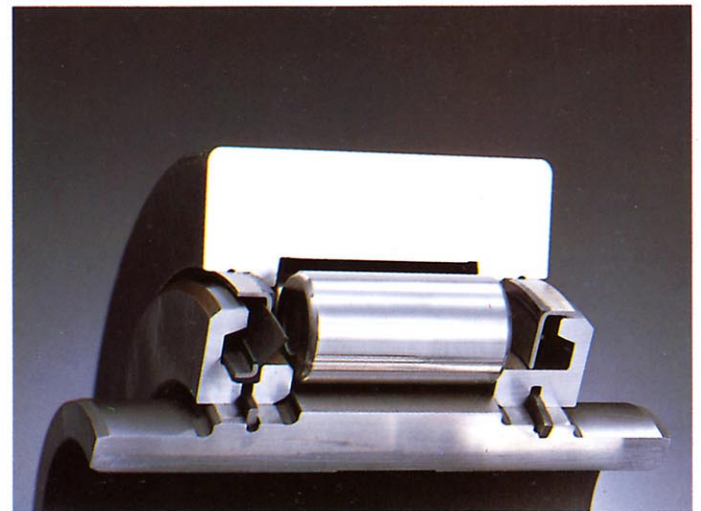

4. The inner and outer rings are made of case-hardened steel
—— Superior resistance to shock loads ——

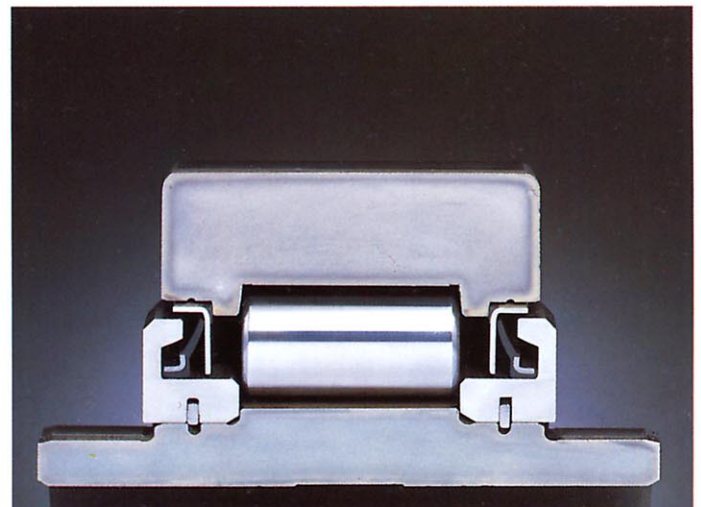

Major Specifications for **NSK** S-Type Sealed-Clean Bearings for Chain Conveyors

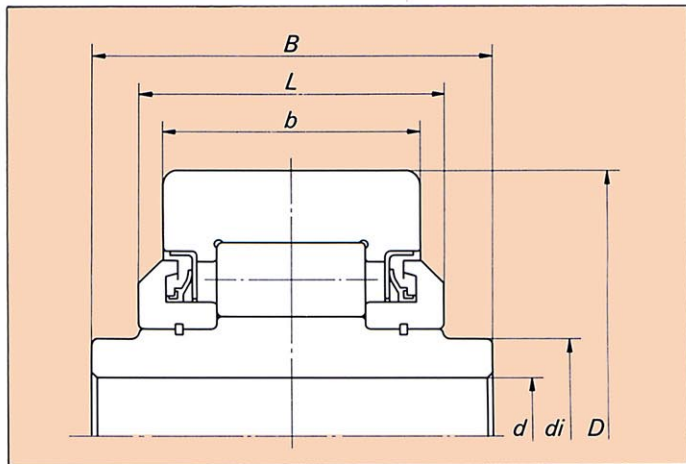

Bearing No.	Boundary Dimensions (mm)					
	d	di	D	b	B	L
28RCV12	28.2	44.03	125	60	91.4	65
28RCV13	28.2	39.95	125	55	85.4	60
30RCV16	30.2	45	135	71	110	78
30RCV17	30.3	50.03	135	65	103	78
30RCV21	30.2	45	135	55	94	62
30RCV23	30.3	50.03	135	65	111	78
30RCV25	30.3	50.03	135	65	105	70
38RCV07	38.25	55.75	150	70	114.2	83.2
38RCV13	38.7	56	150	70	114.2	76
38RCV19	38.7	56	150	70	116	78
41RCV07	41.75	64.16	175	80	125	85
41RCV11	41.75	64.16	175	85	134.8	90.5
45RCV09	45.3	70.03	180	90	140.6	95