

Self-Lube[®] cast iron flange bearing units

LFTC Series

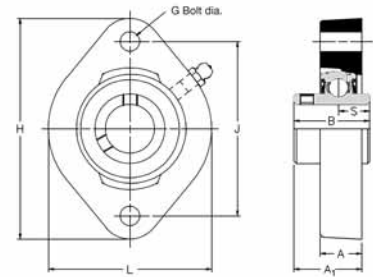

LFTC

Shaft diameter		RHP designation				Basic bearing insert	Casting group	Dimensions (mm)				
mm	inches							L	H	J	G	A
12		LFTC12		LFTC12EC		1017	1	58.5	81.0	63.5	6.0	15.0
15		LFTC15		LFTC15EC								
16		LFTC16		LFTC16EC								
17		LFTC17		LFTC17EC								
	$\frac{1}{2}$ $\frac{5}{8}$	LFTC$\frac{1}{2}$ LFTC$\frac{5}{8}$		LFTC$\frac{1}{2}$EC LFTC$\frac{5}{8}$EC								
20		LFTC20 LFTC$\frac{3}{4}$	LFTC20A LFTC$\frac{3}{4}$A	LFTC20EC LFTC$\frac{3}{4}$EC	LFTC20DEC LFTC$\frac{3}{4}$DEC	1020	2	66.5	90.5	71.5	8.0	17.0
25		LFTC25 LFTC$\frac{7}{8}$ LFTC$\frac{15}{16}$ LFTC1	LFTC25A LFTC1A	LFTC25EC LFTC$\frac{7}{8}$EC LFTC$\frac{15}{16}$EC LFTC1EC	LFTC25DEC LFTC$\frac{7}{8}$DEC LFTC$\frac{15}{16}$DEC LFTC1DEC	1025	3	71.0	96.0	76.0	8.0	17.5
30		LFTC30 LFTC$1\frac{1}{8}$ LFTC$1\frac{3}{16}$ LFTC$1\frac{1}{4}$	LFTC30A LFTC$1\frac{1}{4}$A	LFTC30EC LFTC$1\frac{1}{8}$EC LFTC$1\frac{3}{16}$EC LFTC$1\frac{1}{4}$EC	LFTC30DEC LFTC$1\frac{1}{8}$DEC LFTC$1\frac{3}{16}$DEC LFTC$1\frac{1}{4}$DEC	1030	4	84.0	112.0	90.5	10.0	20.5
35		LFTC35 LFTC$1\frac{1}{4}$L LFTC$1\frac{3}{8}$ LFTC$1\frac{7}{16}$	LFTC 35A LFTC$1\frac{1}{4}$AL	LFTC35EC LFTC$1\frac{1}{4}$ECL LFTC$1\frac{3}{8}$EC LFTC$1\frac{7}{16}$EC	LFTC35DEC LFTC$1\frac{1}{4}$DECL LFTC$1\frac{3}{8}$DEC LFTC$1\frac{7}{16}$DEC	1035	5	93.0	125.0	100.0	10.0	22.0

Please check availability

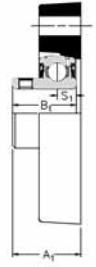
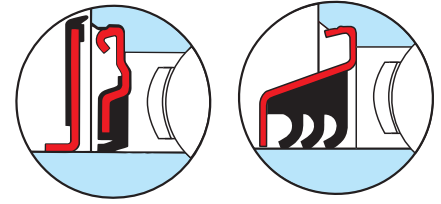

LFTC-A

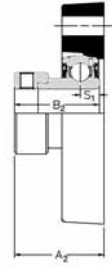

LFTC-EC

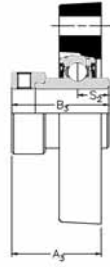

LFTC-DEC

Bearing inserts with flinger seals shown on pages 91 and 92 can be fitted into these housings. The unit reference has the suffix 'FS', e.g. LFTC 7/8 FS.

Triple seal bearing inserts shown on pages 88 to 90 can be fitted into these housings. The unit reference has a prefix 'T', e.g. TLFTC 7/8.

	Dimensions (mm)										ISO load ratings		Rec max. speed	Mass (approx.)
	A1	A2	A3	B	B1	B2	B3	s	s1	s2	dynamic Cr newtons	static Cor newtons	rev/min	kg
	24.27	30.43	–	27.38	–	28.63	–	11.58	6.53	–	9550	4800	7000	0.3
	27.76	32.92	36.04	31.00	25.80	31.03	43.73	12.73	7.53	17.13	12800	6650	6700	0.4
	29.24	32.82	36.35	34.00	27.30	31.03	44.43	14.33	7.53	17.53	14000	7880	6250	0.5
	33.62	38.07	41.50	38.10	31.20	35.73	48.43	15.93	9.03	18.33	19500	11300	5300	0.8
	37.80	41.74	44.71	42.90	34.90	38.93	51.13	17.53	9.53	18.83	25700	15300	4500	1.1

Self-Lube[®] cast iron flange cartridge bearing units

FC Series

For housing tolerances to suit spigot 'H' see page 21

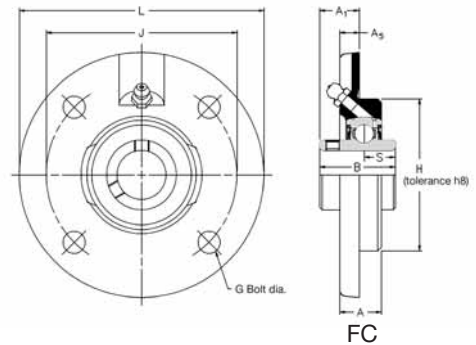

Note: Relubrication hole - M5 x 0.8 pitch

Shaft diameter		RHP designation				Basic bearing insert	Casting group	Dimensions (mm)					
								L	H	J	G	A	A1
mm	inches												
20	¾	FC20 FC¾	FC20A FC¾A	FC20EC FC¾EC	FC20DEC FC¾DEC	1020	2	100.0	62.0	78.0	8	17.0	16.29
25	⅞ 1⅕ 1	FC25 FC⅞ FC1⅕ FC1	FC25A FC1A	FC25EC FC⅞EC FC1⅕EC FC1EC	FC25DEC FC⅞DEC FC1⅕DEC FC1DEC	1025	3	115.0	70.0	90.0	8	19.0	17.34
30	1⅙ 1⅜ 1¼	FC30 FC1⅙ FC1⅜ FC1¼R	FC30A FC1¼AR	FC30EC FC1⅙C FC1⅜EC FC1¼ECR	FC30DEC FC1⅙DEC FC1⅜DEC FC1¼DECR	1030	4	125.0	80.0	100.0	10	20.5	20.22
35	1¼ 1⅜ 1⅞	FC35 FC1¼ FC1⅜ FC1⅞	FC35A FC1¼A	FC35EC FC1¼EC FC1⅜EC FC1⅞EC	FC35DEC FC1¼DEC FC1⅜DEC FC1⅞DEC	1035	5	135.0	90.0	110.0	10	20.5	24.40
40	1½	FC40 FC1½	FC40A FC1½A	FC40EC FC1½EC	FC40DEC FC1½DEC	1040	6	145.0	100.0	120.0	10	23.0	29.18
45	1⅝ 1⅞ 1¾	FC45 FC1⅝ FC1⅞ FC1¾	FC45A FC1¾A	FC45EC FC1⅝EC FC1⅞EC FC1¾EC	FC45DEC FC1⅝DEC FC1⅞DEC FC1¾DEC	1045	7	155.0	105.0	130.0	12	25.0	28.18
50	1⅞ 1⅕ 2	FC50 FC1⅞ FC1⅕ FC2R	FC50A	FC50EC FC1⅞EC FC1⅕EC	FC50DEC FC1⅞DEC FC1⅕DEC	1050	8	165.0	110.0	135.0	12	25.0	31.52
55	2 2⅙ 2⅞	FC55 FC2 FC2⅙ FC2⅞			FC55DEC FC2DEC FC2⅙DEC FC2⅞DEC	1055	9	185.0	125.0	150.0	16	27.5	33.30
60	2¼ 2⅝ 2⅞	FC60 FC2¼ FC2⅝ FC2⅞			FC60DEC FC2¼DEC FC2⅝DEC FC2⅞DEC	1060	10	195.0	135.0	160.0	16	29.0	38.65

Please check availability

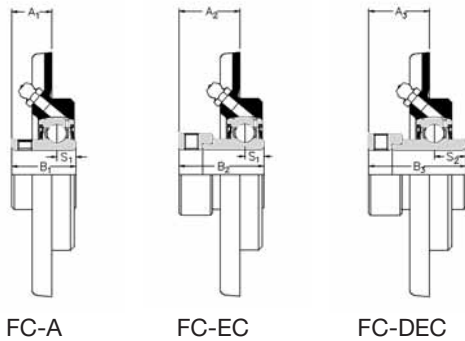
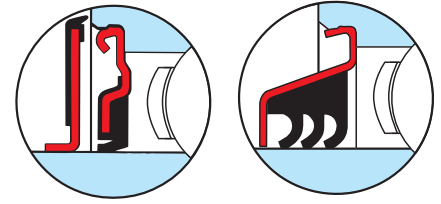

FC-A

FC-EC

FC-DEC

Bearing inserts with flinger seals shown on pages 91 and 92 can be fitted into these housings. The unit reference has the suffix 'FS', e.g. FC40FS.

Triple seal bearing inserts shown on pages 88 to 90 can be fitted into these housings. The unit reference has a prefix 'T', e.g. TFC40.

	Dimensions (mm)										ISO load ratings		Rec max. speed	Mass (approx.)
	A2	A3	A5	B	B1	B2	B3	s	s1	s2	dynamic Cr newtons	static Cor newtons	rev/min	kg
	21.45	24.57	8.00	31.00	25.80	31.03	43.73	12.73	7.53	17.13	12800	6650	6700	0.7
	20.86	24.41	9.00	34.10	27.30	31.03	44.43	14.33	7.53	17.53	14000	7880	6250	0.9
	24.64	28.10	9.50	38.10	31.20	35.73	48.43	15.93	9.03	18.33	19500	11300	5300	1.1
	28.33	31.29	10.00	42.90	34.90	38.93	51.13	17.53	9.53	18.83	25700	15300	4500	1.5
	31.59	33.88	11.50	49.20	41.20	43.73	56.33	19.03	11.03	21.43	32500	19900	4000	1.8
	30.59	32.88	12.00	49.20	41.20	43.73	56.33	19.04	11.04	21.43	32500	20500	3700	2.2
	31.63	37.14	13.00	51.60	43.50	43.73	62.73	19.04	11.04	24.64	35000	23200	3400	2.8
	–	43.72	15.00	55.60	–	–	71.42	22.24	–	27.84	43500	29200	3100	4.0
	–	45.89	16.00	65.10	–	–	77.84	25.44	–	31.04	48000	33000	2800	4.7

Self-Lube[®] cast iron flange cartridge bearing units

MFC Series

For housing tolerances to suit spigot 'H' see page 21

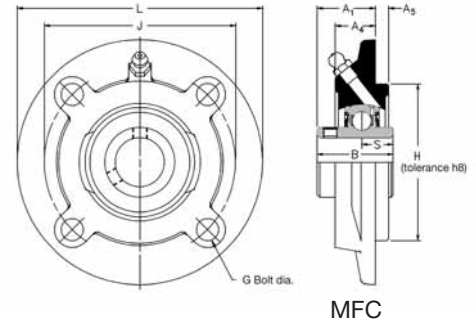

Shaft diameter		RHP designation	Basic bearing insert	Casting group	Dimensions (mm)		
					L	H	J
mm	inches						
25	1 1¼	MFC25 MFC1 MFC1¼R	1030	1	111.1	76.2	92.1
30	1⅜ 1¼	MFC30 MFC1⅜ MFC1¼	1035	2	127.0	85.7	104.8
35 40	1⅜ 1⅞ 1½	MFC35 MFC40 MFC1⅜ MFC1⅞ MFC1½	1040	3	133.4	92.1	111.1
45	1⅞ 1¾ 2	MFC45 MFC1⅞ MFC1¾ MFC2R	1050	4	155.6	108.0	130.2
50	1⅞ 1⅞ 2	MFC50 MFC1⅞ MFC1⅞ MFC2	1055	5	161.9	114.3	136.5
55	2⅞ 2¼	MFC55 MFC2⅞ MFC2¼	1060	6	181.0	127.0	152.4
60 65	2⅞ 2½	MFC60 MFC65R MFC2⅞ MFC2½	1070	7	193.7	139.7	165.1
65 70	2⅞ 2¾	MFC65R MFC70 MFC2⅞ MFC2¾	1075	8	222.2	161.9	190.5
75 80	2⅞ 3 ¾	MFC75 MFC80 MFC2⅞ MFC3 MFC¾	1080	9	222.2	161.9	190.5
85 90	3⅞ 3½	MFC85 MFC90 MFC3⅞ MFC3½	1090	10	260.4	187.3	219.1
95 100	3⅞ 4	MFC95 MFC100 MFC3⅞ MFC4	3095	11	298.4	228.6	260.4

Please check availability

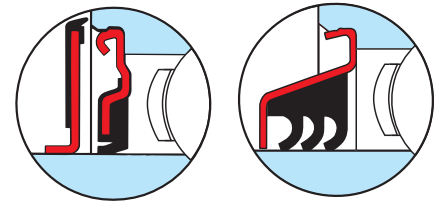

Bearing inserts with flinger seals shown on pages 91 and 92 can be fitted into these housings. The unit reference has the suffix 'FS', e.g. MFC30FS.

Triple seal bearing inserts shown on pages 88 to 90 can be fitted into these housings. The unit reference has a prefix 'T', e.g. TMFC30.

	Dimensions (mm)						ISO load ratings		Rec max. speed	Mass (approx.)
	G	A1	A4	A5	B	s	dynamic Cr newtons	static Cor newtons	rev/min	kg
	8	33.32	21.0	6.4	38.10	15.93	19500	11300	5300	1.4
	10	33.32	19.0	6.4	42.90	17.53	25700	15300	4500	1.5
	10	38.10	19.0	6.4	49.20	19.03	32500	19900	4000	1.9
	10	39.67	19.0	6.4	51.60	19.04	35000	23200	3400	2.7
	10	39.67	19.0	6.4	55.60	22.24	43500	29200	3100	3.0
	12	42.85	15.9	9.5	65.10	25.44	48000	33000	2800	3.4
	12	46.02	15.9	12.7	74.60	30.24	61000	45000	2450	4.5
	16	50.80	21.0	12.7	77.80	33.34	66000	49500	2300	5.9
	16	50.80	16.7	12.7	82.60	33.34	71500	54500	2150	5.4
	20	67.46	29.4	12.7	96.00	39.74	96000	71500	1900	9.8
	20	88.90	46.0	12.7	117.48	49.31	157000	122000	1600	17.7

Self-Lube[®] cast iron take-up bearing units

ST Series

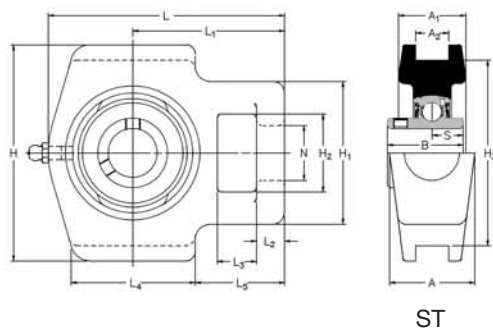

Shaft diameter		RHP designation				Basic bearing insert	Casting group	Dimensions (mm)							
								L	L1	L2	L3	L4	L5	H	
mm	inches														
20	3/4	ST20 ST3/4	ST20A ST3/4A	ST20EC ST3/4EC	ST20DEC ST3/4DEC	1020	2	96.5	62.0	11.5	16.0	50.5	36.5	88.5	
25	7/8 15/16 1	ST25 ST7/8 ST15/16 ST1	ST25A ST1A	ST25EC ST7/8EC ST15/16EC ST1EC	ST25DEC ST7/8DEC ST15/16DEC ST1DEC	1025	3	98.0	62.0	11.5	16.0	50.5	36.5	88.5	
30	1 1/8 1 3/16 1 1/4	ST30 ST1 1/8 ST1 3/16 ST1 1/4R	ST30A ST1 1/4AR	ST30EC ST1 1/8EC ST1 3/16EC ST1 1/4ECR	ST30DEC ST1 1/8DEC ST1 3/16DEC ST1 1/4DECR	1030	4	115.5	71.7	12.5	16.5	64.5	43.0	101.5	
35	1 1/4 1 3/8 1 7/16	ST35 ST1 1/4 ST1 3/8 ST1 7/16	ST35A ST1 1/4A	ST35EC ST1 1/4EC ST1 3/8EC ST1 7/16EC	ST35DEC ST1 1/4DEC ST1 3/8DEC ST1 7/16DEC	1035	5	124.0	75.5	12.5	16.5	64.5	43.0	101.5	
40	1 1/2	ST40 ST1 1/2	ST40A ST1 1/2A	ST40EC ST1 1/2EC	ST40DEC ST1 1/2DEC	1040	6	143.5	89.2	15.5	20.5	81.5	50.5	118.0	
45	1 5/8 1 11/16 1 3/4	ST45 ST1 5/8 ST1 11/16 ST1 3/4	ST45A ST1 3/4	ST45EC ST1 5/8EC ST1 11/16EC ST1 3/4EC	ST45DEC ST1 5/8DEC ST1 11/16DEC ST1 3/4DEC	1045	7	147.0	89.2	15.5	20.5	81.5	50.5	118.0	
50	1 7/8 1 15/16 2	ST50 ST1 7/8 ST1 15/16 ST2R	ST50	ST50EC ST1 7/8EC ST1 15/16EC	ST50DEC ST1 7/8DEC ST1 15/16DEC	1050	8	151.0	90.5	15.5	20.5	81.5	50.5	118.0	
55	2 2 1/8 2 3/16	ST55 ST2 ST2 1/8 ST2 3/16			ST55DEC ST2DEC ST2 1/8DEC ST2 3/16DEC	1055	9	182.0	114.0	19.0	32.0	97.5	70.0	146.0	
60	2 1/4 2 3/8 2 7/16	ST60 ST2 1/4 ST2 3/8 ST2 7/16			ST60DEC ST2 1/4DEC ST2 3/8DEC ST2 7/16DEC	1060	10	192.0	119.0	19.0	32.0	97.5	70.0	146.0	
65 70	2 1/2 2 11/16	ST65 ST70 ST2 1/2 ST2 11/16			ST65DEC ST70DEC ST2 1/2DEC ST2 11/16DEC	1070	11	222.5	137.5	21.5	32.0	120.5	77.0	166.5	
75	2 3/4 2 7/8 2 15/16	ST75 ST2 3/4 ST2 7/8 ST2 15/16			ST75DEC ST2 3/4DEC ST2 7/8DEC ST2 15/16DEC	1075	12	222.5	137.5	21.5	32.0	120.5	77.0	166.5	
80	3 3 3/16	ST80 ST3 ST3 3/16				1080	13	231.5	139.5	20.5	32.0	125.0	74.0	184.0	
85	3 1/4 3 3/8 3 7/16	ST85 ST3 1/4 ST3 3/8 ST3 7/16				1085	14	260.5	162.0	28.5	38.0	140.0	90.5	198.5	

Please check availability

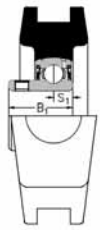
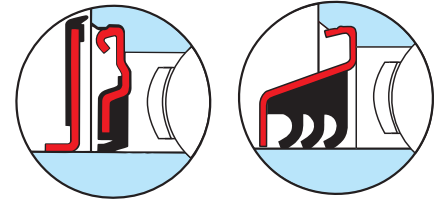

ST-A

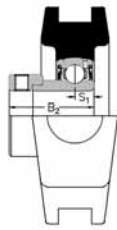

ST-EC

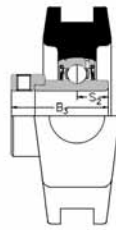

ST-DEC

Bearing inserts with flinger seals shown on pages 91 and 92 can be fitted into these housings. The unit reference has the suffix 'FS', e.g. ST45FS.

Triple seal bearing inserts shown on pages 88 to 90 can be fitted into these housings. The unit reference has a prefix 'T', e.g. TST45.

	Dimensions (mm)														ISO load ratings		Rec max. speed	Mass (approx.)
	H1	H2	H3	N	A	A1	A2	B	B1	B2	B3	s	s1	s2	dynamic Cr newtons	static Cor newtons	rev/min	kg
	58.5	32.0	76.0	22.5	36.0	27.5	13.50	31.00	25.80	31.03	43.73	12.73	7.53	17.13	12800	6650	6700	0.8
	58.5	32.0	76.0	22.5	36.0	27.5	13.50	34.10	27.30	31.03	44.43	14.33	7.53	17.53	14000	7880	6250	1.0
	64.5	37.5	89.0	22.5	36.5	30.0	13.50	38.10	31.20	35.73	48.43	15.93	9.03	18.33	19500	11300	5300	1.6
	64.5	37.5	89.0	22.5	36.5	30.0	13.50	42.90	34.90	38.93	51.13	17.53	9.53	18.83	25700	15300	4500	1.6
	82.5	49.5	101.0	29.0	49.5	37.0	17.50	49.20	41.20	43.73	56.33	19.03	11.03	21.43	32500	19900	4000	2.7
	82.5	49.5	101.0	29.0	49.5	37.0	17.50	49.20	41.20	43.73	56.33	19.04	11.04	21.43	32500	20500	3700	2.8
	82.5	49.5	101.0	29.0	49.5	37.0	17.50	51.60	43.50	43.73	62.73	19.04	11.04	24.64	35000	23200	3400	2.8
	101.0	64.0	130.0	35.0	63.5	46.5	27.00	55.60	-	-	71.42	22.24	-	27.84	43500	29200	3100	4.2
	101.0	64.0	130.0	35.0	63.5	46.5	27.00	65.10	-	-	77.84	25.44	-	31.04	48000	33000	2800	5.4
	113.0	70.0	150.8	42.0	70.0	50.5	27.00	74.60	-	-	85.74	30.24	-	34.14	61000	45000	2450	7.9
	113.0	70.0	150.8	42.0	70.0	50.5	27.00	77.80	-	-	92.14	33.34	-	37.34	66000	49500	2300	8.4
	113.0	70.0	165.1	42.0	70.0	54.0	27.00	82.60	-	-	-	33.34	-	-	71500	54500	2150	9.0
	124.0	73.0	173.0	47.5	79.5	68.5	46.05	85.70	-	-	-	34.15	-	-	83000	64000	2000	13.7

Self-Lube[®] cast iron take-up bearing units

MST Series

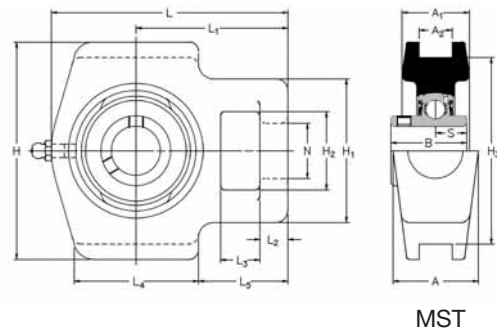

Shaft diameter		RHP designation	Basic bearing insert	Casting group	Dimensions (mm)					
					L	L1	L2	L3	L4	L5
mm	inches									
25	1	MST25 MST1	1030	1	115.5	71.7	12.5	16.5	64.5	43.0
30	1 ³ / ₁₆ 1 ¹ / ₄	MST30 MST1³/₁₆ **	1035	2	124.0	75.5	12.5	16.5	64.5	43.0
35	1 ³ / ₈ 1 ⁷ / ₁₆	MST35 MST1³/₈ MST1⁷/₁₆	1040	3	143.5	89.2	15.5	20.5	81.5	50.5
40	1 ¹ / ₂	MST40 MST1¹/₂	1045	4	147.0	89.2	15.5	20.5	81.5	50.5
45	1 ¹¹ / ₁₆ 1 ³ / ₄	MST45 MST1¹¹/₁₆ MST1³/₄	1050	5	151.0	90.5	15.5	20.5	81.5	50.5
50	1 ⁷ / ₈ 1 ¹⁵ / ₁₆ 2	MST50 MST1⁷/₈ MST1¹⁵/₁₆ **	1055	6	182.0	114.0	19.0	32.0	97.5	70.0
55	2 ³ / ₁₆ 2 ¹ / ₄	MST55 MST2³/₁₆ **	1060	7	192.0	119.0	19.0	32.0	97.5	70.0
60	2 ⁷ / ₁₆ 2 ¹ / ₂	MST60 MST2⁷/₁₆ **	1070	8	222.5	137.5	21.5	32.0	120.5	77.0
65 70	2 ¹¹ / ₁₆ 2 ³ / ₄	MST65 MST70 MST2¹¹/₁₆ **	1075	9	222.5	137.5	21.5	32.0	120.5	77.0
75	2 ¹⁵ / ₁₆ 3	MST75 MST2¹⁵/₁₆ **	1080	10	231.5	139.5	20.5	32.0	125.0	74.0
80	3 ³ / ₁₆ 3 ¹ / ₄	MST80 MST3³/₁₆ **	1085	11	260.5	162.0	28.5	38.0	140.0	90.5
85 90	3 ⁷ / ₁₆ 3 ¹ / ₂	MST85 MST90 MST3⁷/₁₆ MST3¹/₂	1090	12	270.0	165.0	28.5	38.0	152.5	90.0
95 100	3 ¹⁵ / ₁₆ 4	MST95 MST100 MST3¹⁵/₁₆ MST4	3095	13	317.5	190.5	32.0	38.0	175.0	103.0

Please check availability

** For these bore sizes select from ST series (see page 56)

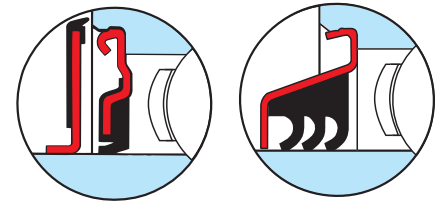

Bearing inserts with flinger seals shown on pages 91 and 92 can be fitted into these housings. The unit reference has the suffix 'FS', e.g. MST35FS.

Triple seal bearing inserts shown on pages 88 to 90 can be fitted into these housings. The unit reference has a prefix 'T', e.g. TMST35.

	Dimensions (mm)										ISO load ratings		Rec max. speed	Mass (approx.)
	H	H1	H2	H3	N	A	A1	A2	B	s	dynamic Cr newtons	static Cor newtons	rev/min	kg
	101.5	64.5	37.5	89.0	22.5	36.5	30.0	13.50	38.10	15.93	19500	11300	5300	1.6
	101.5	64.5	37.5	89.0	22.5	36.5	30.0	13.50	42.90	17.53	25700	15300	4500	1.6
	118.0	82.5	49.5	101.0	29.0	49.5	37.0	17.50	49.20	19.03	32500	19900	4000	2.7
	118.0	82.5	49.5	101.0	29.0	49.5	37.0	17.50	49.20	19.04	32500	20500	3700	2.8
	118.0	82.5	49.5	101.0	29.0	49.5	37.0	17.50	51.60	19.04	35000	23200	3400	2.8
	146.0	101.0	64.0	130.0	35.0	63.5	46.5	27.00	55.60	22.24	43500	29200	3100	4.2
	146.0	101.0	64.0	130.0	35.0	63.5	46.5	27.00	65.10	25.44	48000	33000	2800	5.4
	166.5	113.0	70.0	150.8	42.0	70.0	50.5	27.00	74.60	30.24	61000	45000	2450	7.9
	166.5	113.0	70.0	150.8	42.0	70.0	50.5	27.00	77.80	33.34	66000	49500	2300	8.4
	184.0	113.0	70.0	165.1	42.0	70.0	54.0	27.00	82.60	33.34	71500	54500	2150	9.0
	198.5	124.0	73.0	173.0	47.5	79.5	68.5	46.05	85.70	34.15	83000	64000	2000	13.7
	216.0	127.0	73.0	190.5	47.5	79.5	68.5	46.05	96.00	39.74	96000	71500	1900	16.8
	260.5	152.5	85.5	235.0	54.5	98.5	82.5	55.55	117.48	49.31	157000	122000	1600	22.2

Self-Lube[®] cast iron take-up bearing units with adapter sleeves

MST 1000-K Series

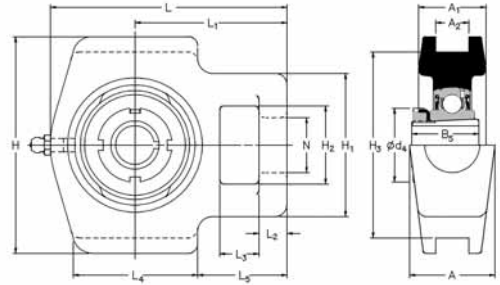

MST1000-K

Shaft diameter	RHP designation complete unit	Sleeve, nut & lockwasher only	Units without sleeve, nut & lockwasher	Basic bearing	Casting group insert	Dimensions (mm)					
						L	H	J	G	A	A1
mm	inches										
20	MST1025-20K MST1025-³/₄K	H305 HE305-³/₄	MST1025K	1025	ST3	98.0	62.0	11.5	16.0	50.5	36.5
25	MST1030-25K MST1030-¹⁵/₁₆K MST1030-1K	H306 HE306-¹⁵/₁₆ HE306-1	MST1030K	1030	1	115.5	71.7	12.5	16.5	64.5	43.0
30	MST1035-30K MST1035-1¹/₈K MST1035-1³/₁₆K	H307 HE307-1¹/₈ HE307-1³/₁₆	MST1035K	1035	2	124.0	75.5	12.5	16.5	64.5	43.0
35	MST1040-35K MST1040-1¹/₄K MST1040-1³/₈K	H308 HE308-1¹/₄ HE308-1³/₈	MST1040K	1040	3	143.5	89.2	15.5	20.5	81.5	50.5
40	MST1045-40K MST1045-1⁷/₁₆K MST1045-1¹/₂K	H309 HE309-1⁷/₁₆ HE309-1¹/₂	MST1045K	1045	4	147.0	89.2	15.5	20.5	81.5	50.5
45	MST1050-45K MST1050-1¹¹/₁₆K MST1050-1³/₄K	H310 HE310-1¹¹/₁₆ HE310-1³/₄	MST1050K	1050	5	151.0	90.5	15.5	20.5	81.5	50.5
50	MST1055-50K MST1055-1¹⁵/₁₆K MST1055-2K	H311 HE3011-1¹⁵/₁₆ HE3011-2	MST1055K	1055	6	182.0	114.0	19.0	32.0	97.5	70.0

Please check availability

	Dimensions (mm)										ISO load ratings		Rec max. speed	Mass (approx.)
	A2	A3	A5	B	B1	B2	B3	s	s1	s2	dynamic Cr newtons	static Cor newtons	rev/min	kg
	88.5	58.5	32.0	76.0	22.5	36.0	27.5	13.50	29.0	38.0	14000	7880	6250	1.0
	101.5	64.5	37.5	89.0	22.5	36.5	30.0	13.50	31.0	45.0	19500	11300	5300	1.6
	101.5	64.5	37.5	89.0	22.5	36.5	30.0	13.50	35.0	52.0	25700	15300	4500	1.6
	118.0	82.5	49.5	101.0	29.0	49.5	37.0	17.50	36.0	58.0	32500	19900	4000	2.7
	118.0	82.5	49.5	101.0	29.0	49.5	37.0	17.50	39.0	65.0	32500	20500	3700	2.8
	118.0	82.5	49.5	101.0	29.0	49.5	37.0	17.50	42.0	70.0	35000	23200	3400	2.8
	146.0	101.0	64.0	130.0	35.0	63.5	46.5	27.00	45.0	75.0	43500	29200	3100	4.2

Self-Lube[®] cast iron conveyor belt tensioner units

BT Series

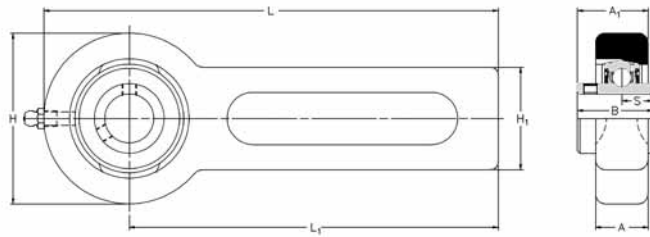

BT

Shaft diameter		RHP designation			Basic bearing insert	Casting group	Dimensions (mm)			
mm	inches						H	H1	L	L1
25	$\frac{7}{8}$	BT25	BT25A	BT25EC	1025	3	78.0	42.5	264.0	225.0
	$\frac{15}{16}$	BT$\frac{7}{8}$		BT$\frac{7}{8}$EC						
	1	BT$\frac{15}{16}$	BT1A	BT$\frac{15}{16}$EC						
		BT1		BT1EC						
30	$1\frac{3}{16}$	BT30L			1035	5	98.0	42.5	274.0	225.0
35	$1\frac{1}{4}$	BT35	BT35A	BT35EC						
	$1\frac{3}{8}$	BT$1\frac{3}{16}$L	BT$1\frac{1}{4}$A	BT$1\frac{1}{4}$EC						
	$1\frac{1}{2}$	BT$1\frac{1}{4}$		BT$1\frac{1}{4}$EC						
	$1\frac{5}{8}$	BT$1\frac{3}{8}$		BT$1\frac{3}{8}$EC						
	$1\frac{7}{16}$	BT$1\frac{7}{16}$		BT$1\frac{7}{16}$EC						

Please check availability

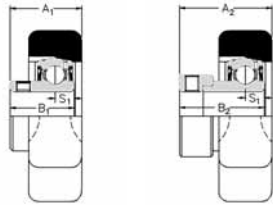
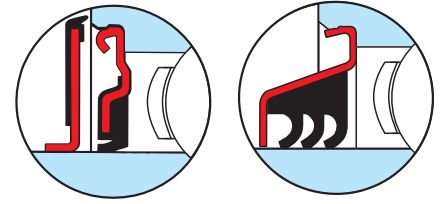

BT-A

BT-EC

Bearing inserts with flinger seals shown on pages 91 and 92 can be fitted into these housings. The unit reference has the suffix 'FS', e.g. BT35FS.

Triple seal bearing inserts shown on pages 88 to 90 can be fitted into these housings. The unit reference has a prefix 'T', e.g. TBT35.

Dimensions (mm)									ISO load ratings		Rec max. speed	Mass (approx.)
A	A1	A2	B	B1	B2	s	s1		dynamic Cr newtons	static Cor newtons	rev/min	kg
22.0	30.57	34.20	34.10	27.30	31.03	14.33	7.53		14000	7880	6250	1.8
22.0	36.13	40.20	42.90	34.90	38.93	17.53	9.53		25700	15300	4500	2.3

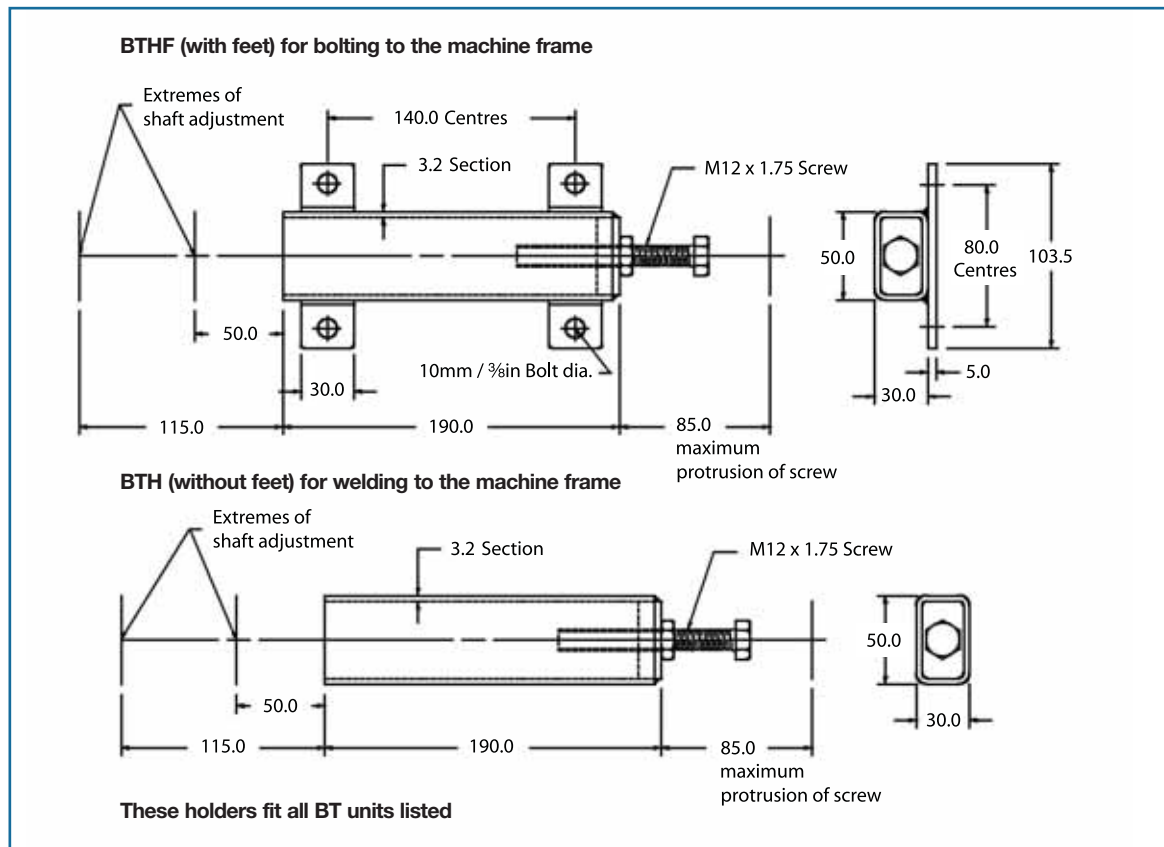

Self-Lube[®] cast iron cartridge bearing units

SLC Series

For housing tolerances to suit outside dia 'L' see page 21

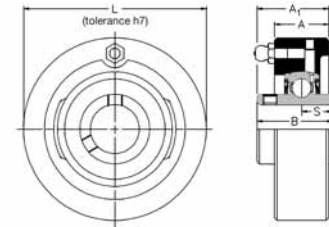

SLC

Shaft diameter		RHP designation				Basic bearing insert	Casting group	Dimensions (mm)			
mm	inches							L	A	A1	A2
12 15 16 17	$\frac{1}{2}$ $\frac{5}{8}$	SLC12 SLC15 SLC16 SLC17 SLC$\frac{1}{2}$ SLC$\frac{5}{8}$		SLC12EC SLC15EC SLC16EC SLC17EC SLC$\frac{1}{2}$EC SLC$\frac{5}{8}$EC		1017	1	68.287	22.22	24.21	30.35
20	$\frac{3}{4}$	SLC20 SLC$\frac{3}{4}$	SLC20A SLC$\frac{3}{4}$A	SLC20EC SLC$\frac{3}{4}$EC	SLC20DEC SLC$\frac{3}{4}$DEC	1020	2	74.367	22.22	29.39	34.54
25	$\frac{7}{8}$ $\frac{15}{16}$ 1	SLC25 SLC$\frac{7}{8}$ SLC$\frac{15}{16}$ SLC1	SLC25A SLC1A	SLC25EC SLC$\frac{7}{8}$EC SLC$\frac{15}{16}$EC SLC1EC	SLC25DEC SLC$\frac{7}{8}$DEC SLC$\frac{15}{16}$DEC SLC1DEC	1025	3	79.400	26.19	32.94	36.52
30	$\frac{1}{8}$ $\frac{13}{16}$ $\frac{1}{4}$	SLC30 SLC$\frac{1}{8}$ SLC$\frac{13}{16}$ SLC$\frac{1}{4}$R	SLC30A SLC$\frac{1}{4}$AR	SLC30EC SLC$\frac{1}{8}$EC SLC$\frac{13}{16}$EC SLC$\frac{1}{4}$ECR	SLC30DEC SLC$\frac{1}{8}$DEC SLC$\frac{13}{16}$DEC SLC$\frac{1}{4}$DECR	1030	4	88.925	27.78	36.12	40.56
35	$\frac{1}{4}$ $\frac{13}{16}$ $\frac{17}{16}$	SLC35 SLC$\frac{1}{4}$ SLC$\frac{13}{16}$ SLC$\frac{17}{16}$	SLC35A SLC$\frac{1}{4}$A	SLC35EC SLC$\frac{1}{4}$EC SLC$\frac{13}{16}$EC SLC$\frac{17}{16}$EC	SLC35DEC SLC$\frac{1}{4}$DEC SLC$\frac{13}{16}$DEC SLC$\frac{17}{16}$DEC	1035	5	98.450	30.96	40.87	44.81
40	$\frac{1}{2}$	SLC40 SLC$\frac{1}{2}$	SLC40A SLC$\frac{1}{2}$A	SLC40EC SLC$\frac{1}{2}$EC	SLC40DEC SLC$\frac{1}{2}$DEC	1040	6	106.387	37.31	48.84	51.28
45	$\frac{15}{8}$ $\frac{11}{16}$ $\frac{13}{4}$	SLC45 SLC$\frac{15}{8}$ SLC$\frac{11}{16}$ SLC$\frac{13}{4}$	SLC45A SLC$\frac{13}{4}$A	SLC45EC SLC$\frac{15}{8}$EC SLC$\frac{11}{16}$EC SLC$\frac{13}{4}$EC	SLC45DEC SLC$\frac{15}{8}$DEC SLC$\frac{11}{16}$DEC SLC$\frac{13}{4}$DEC	1045	7	111.150	36.51	48.44	50.88
50	$\frac{17}{8}$ $\frac{15}{16}$ 2	SLC50 SLC$\frac{17}{8}$ SLC$\frac{15}{16}$ SLC2R	SLC50A	SLC50EC SLC$\frac{17}{8}$EC SLC$\frac{15}{16}$EC	SLC50DEC SLC$\frac{17}{8}$DEC SLC$\frac{15}{16}$DEC	1050	8	115.913	37.31	51.18	51.28
55	2 $\frac{2}{8}$ $\frac{23}{16}$	SLC55 SLC2 SLC$\frac{2}{8}$ SLC$\frac{23}{16}$			SLC55DEC SLC2DEC SLC$\frac{2}{8}$DEC SLC$\frac{23}{16}$DEC	1055	9	125.437	40.48	53.57	–
60	$\frac{2}{4}$ $\frac{23}{8}$ $\frac{27}{16}$	SLC60 SLC$\frac{2}{4}$ SLC$\frac{23}{8}$ SLC$\frac{27}{16}$			SLC60DEC SLC$\frac{2}{4}$DEC SLC$\frac{23}{8}$DEC SLC$\frac{27}{16}$DEC	1060	10	149.250	41.28	60.30	–
65	$\frac{2}{2}$	SLC65 SLC$\frac{2}{2}$			SLC$\frac{2}{2}$DEC	1065	10/65	149.250	41.28	60.30	–

Please check availability

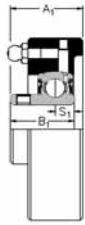
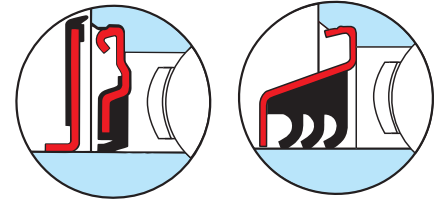

SLC-A

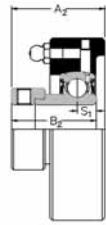

SLC-EC

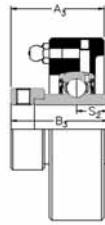

SLC-DEC

Bearing inserts with flinger seals shown on pages 91 and 92 can be fitted into these housings. The unit reference has the suffix 'FS', e.g. SLC25FS.

Triple seal bearing inserts shown on pages 88 to 90 can be fitted into these housings. The unit reference has a prefix 'T', e.g. TSLC25.

	Dimensions (mm)								ISO load ratings		Rec max. speed	Mass (approx.)
	A3	B	B1	B2	B3	s	s1	s2	dynamic Cr newtons	static Cor newtons	rev/min	kg
	–	27.38	–	28.63	–	11.58	6.53	–	9550	4800	7000	0.6
	37.67	31.00	25.80	31.03	43.73	12.73	7.53	17.13	12800	6650	6700	0.7
	40.06	34.10	27.30	31.03	44.43	14.33	7.53	17.53	14000	7880	6250	0.8
	43.99	38.10	31.20	35.73	48.43	15.93	9.03	18.33	19500	11300	5300	1.1
	47.78	42.90	34.90	38.93	51.13	17.53	9.53	18.83	25700	15300	4500	1.4
	53.57	49.20	41.20	43.73	56.33	19.03	11.03	21.43	32500	19900	4000	2.0
	53.16	49.20	41.20	43.73	56.33	19.04	11.04	21.43	32500	20500	3700	2.1
	56.72	51.60	43.50	43.73	62.73	19.04	11.04	24.64	35000	23200	3400	2.3
	63.83	55.60	–	–	71.42	22.24	–	27.82	43500	29200	3100	2.9
	67.39	65.10	–	–	77.84	25.44	–	31.04	48000	33000	2800	4.4
	67.39	65.10	–	–	85.74	25.44	–	34.14	57500	40000	2600	4.5

Self-Lube[®] cast iron cartridge bearing units

MSC Series

For housing tolerances
to suit outside dia 'L'
see page 21

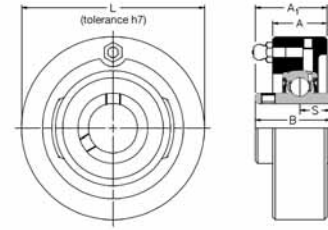

MSC

Shaft diameter		RHP designation	Basic bearing insert	Casting group	Dimensions (mm)	
mm	inches				L	A
25 30	1	MSC25 ** MSC1	1030	1	88.925	27.78
35	1 ³ / ₁₆ 1 ¹ / ₄	** MSC1³/₁₆ **	1035	2	98.450	30.96
40	1 ³ / ₈ 1 ⁷ / ₁₆	** MSC1³/₈ MSC1⁷/₁₆	1040	3	106.387	37.31
45	1 ¹ / ₂	** MSC1¹/₂	1045	4	111.150	36.51
50	1 ¹¹ / ₁₆ 1 ³ / ₄	** MSC1¹¹/₁₆ MSC1³/₄	1050	5	115.913	37.31
55	1 ⁷ / ₈ 1 ¹⁵ / ₁₆ 2	** MSC1⁷/₈ MSC1¹⁵/₁₆ **	1055	6	125.437	40.48
60	2 ³ / ₁₆ 2 ¹ / ₄	** MSC2³/₁₆ **	1060	7	149.250	41.28
65 70	2 ⁷ / ₁₆ 2 ¹ / ₂	MSC65 MCS70 MSC2⁷/₁₆ MSC2¹/₂	1070	8	158.775	50.80
75	2 ¹¹ / ₁₆ 2 ³ / ₄	MSC75 MSC2¹¹/₁₆ MSC2³/₄	1075	9	168.300	50.80
80	2 ¹⁵ / ₁₆ 3	MSC80 MSC2¹⁵/₁₆ MSC3	1080	10	177.825	55.56
85	3 ³ / ₁₆ 3 ¹ / ₄	MSC85 MSC3³/₁₆ MSC3¹/₄	1085	11	188.937	63.50
90	3 ⁷ / ₁₆ 3 ¹ / ₂	MSC90 MSC3⁷/₁₆ MSC3¹/₂	1090	12	207.987	63.50
95 100	3 ¹⁵ / ₁₆ 4	MSC95 MSC100 MSC3¹⁵/₁₆ MSC4	3095	13	241.325	76.20

Please check availability

** For these bore sizes select from SLC series (see page 64)

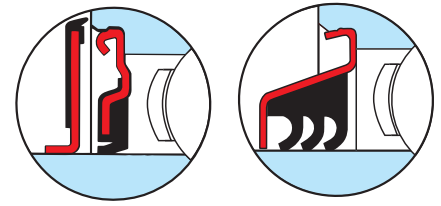

Bearing inserts with flinger seals shown on pages 91 and 92 can be fitted into these housings. The unit reference has the suffix 'FS', e.g. MSC 1 $\frac{3}{16}$ FS.

Triple seal bearing inserts shown on pages 88 to 90 can be fitted into these housings. The unit reference has a prefix 'T', e.g. TMSC 1 $\frac{3}{16}$.

	Dimensions (mm)			ISO load ratings		Rec max. speed	Mass (approx.)
	A1	B	s	dynamic Cr newtons	static Cor newtons	rev/min	kg
	36.12	38.10	15.93	19500	11300	5300	1.1
	40.87	42.90	17.53	25700	15300	4500	1.4
	48.84	49.20	19.03	32500	19900	4000	2.0
	48.44	49.20	19.04	32500	20500	3700	2.1
	51.18	51.60	19.04	35000	23200	3400	2.3
	53.57	55.60	22.24	43500	29200	3100	2.9
	60.30	65.10	25.44	48000	33000	2800	4.4
	69.80	74.60	30.24	61000	45000	2450	5.3
	69.80	77.80	33.34	66000	49500	2300	6.2
	76.99	82.60	33.34	71500	54500	2150	7.9
	83.29	85.70	34.15	83000	64000	2000	9.3
	88.06	96.00	39.74	96000	71500	1900	12.7
	106.38	117.48	49.31	157000	122000	1600	20.4

Self-Lube[®] cast iron hanger bearing units

SCHB Series (BSP thread)
SCH Series (metric thread)**

**These series units are identical to SCHB series except for thread details

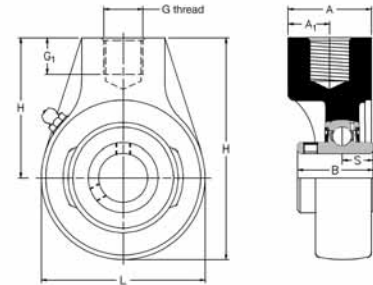

SCHB (BSP thread)
SCH (metric thread)

Shaft diameter		RHP designation	Basic bearing insert	Casting group	Dimensions				
mm	inches				G (BSP)	G (metric)	G1 (mm)	L	
20	3/4	SCHB20 SCHB3/4	SCH20 SCH3/4	1020	0	1/2	M16 x 2.00	19.0	67.0
25 30	7/8 1 1 1/8	SCHB25 SCHB30 SCHB7/8 SCHB1 SCHB1 1/8	SCH25 SCH30 SCH7/8 SCH1 SCH1 1/8	1030	2/0	1/2	M20 x 2.50	16.0	89.0
35	1 3/16 1 1/4 1 3/8	SCHB35 SCHB1 3/16 SCHB1 1/4 SCHB1 3/8	SCH35 SCH1 3/16 SCH1 1/4 SCH1 3/8	1035	1	3/4	M24 x 3.00	19.0	97.0
40	1 7/16 1 1/2	SCHB40 SCHB1 7/16 SCHB1 1/2	SCH40 SCH1 7/16 SCH1 1/2	1040	2	3/4	M24 x 3.00	19.0	107.0
45 50	1 11/16 1 3/4 1 7/8 1 15/16 2	SCHB45 SCHB50 SCHB1 11/16 SCHB1 3/4 SCHB1 7/8 SCHB1 15/16 SCHB2	SCH45 SCH50 SCH1 11/16 SCH1 3/4 SCH1 7/8 SCH1 15/16 SCH2	1050	3	1	M24 x 3.00	21.0	121.0
55 60	2 3/16 2 1/4 2 3/8 2 7/16	SCHB55 SCHB60 SCHB2 3/16 SCHB2 1/4 SCHB2 3/8 SCHB2 7/16	SCH55 SCH60 SCH2 3/16 SCH2 1/4 SCH2 3/8 SCH2 7/16	1060	4	1 1/4	M42 x 4.50	29.0	146.5
	2 1/2	SCHB2 1/2	SCH2 1/2	1065	4/65	1 1/4	M42 x 4.50	29.0	143.0
65 70 75	2 11/16 2 3/4 2 7/8 2 15/16	SCHB65 SCHB70 SCHB75 SCHB2 11/16 SCHB2 3/4 SCHB2 7/8 SCHB2 15/16	SCH65 SCH70 SCH75 SCH2 11/16 SCH2 3/4 SCH2 7/8 SCH2 15/16	1075	5	1 1/2	M48 x 5.00	32.0	165.0
80	3 3 3/16	SCHB80 SCHB3 SCHB3 3/16	SCH80 SCH3 SCH3 3/16	1080	6	1 1/2	M48 x 5.00	32.0	174.5

Please check availability

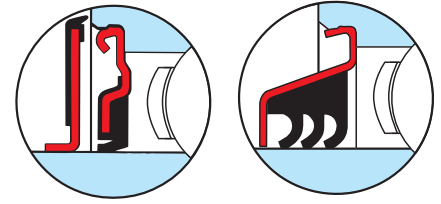

Bearing inserts with flinger seals shown on pages 91 and 92 can be fitted into these housings. The unit reference has the suffix 'FS', e.g. SCHB35FS.

Triple seal bearing inserts shown on pages 88 to 90 can be fitted into these housings. The unit reference has a prefix 'T', e.g. TSCHB35.

	Dimensions (mm)						ISO load ratings		Rec max. speed	Mass (approx.)
	H	H1	A	A1	B	s	dynamic Cr newtons	static Cor newtons	rev/min	kg
	91.6	57.2	34.0	18.26	30.96	12.75	12800	6650	6700	0.8
	107.5	61.9	33.5	22.22	38.10	15.93	19500	11300	5300	1.2
	119.0	69.8	39.5	25.40	42.88	17.53	25700	15300	4500	1.5
	127.5	73.0	39.0	27.79	49.23	19.10	32500	19900	4000	1.6
	144.0	82.6	47.5	27.79	51.59	19.10	35000	23200	3400	2.2
	175.0	101.6	58.5	30.94	65.07	25.45	48000	33000	2800	3.5
	173.5	101.6	58.5	30.94	65.07	25.45	57500	40000	2600	3.4
	200.6	117.5	70.0	34.94	77.77	33.37	66000	49500	2300	6.8
	211.5	123.8	71.5	41.29	82.55	33.37	71500	54500	2150	8.1

Self-Lube[®] pressed steel flange bearing units (zinc plated housings)

SLFE Series

Housings of groups 6 to 10 inclusive have four bolt holes

Note: these units are not re-greaseable

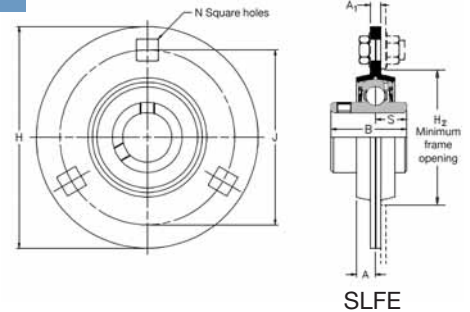

Shaft diameter		RHP designation				Basic bearing insert	Casting group	Dimensions (mm)			
mm	inches							H	H2	J	N
12		SLFE12		SLFE12EC		1017	1	81.0	49.0	63.5	7.1
15		SLFE15		SLFE15EC							
16		SLFE16		SLFE16EC							
17		SLFE17		SLFE17A							
	1/2	SLFE1/2		SLFE1/2EC							
	5/8	SLFE5/8		SLFE5/8EC							
20		SLFE20	SLFE20A	SLFE20EC	SLFE20DEC	1020	2	90.5	55.0	71.5	8.7
	3/4	SLFE3/4	SLFE3/4A	SLFE3/4EC	SLFE3/4DEC						
25		SLFE25	SLFE25A	SLFE25EC	SLFE25DEC	1025	3	95.2	60.0	76.0	8.7
	7/8	SLFE7/8		SLFE7/8EC	SLFE7/8DEC						
	15/16	SLFE15/16		SLFE15/16EC	SLFE15/16DEC						
	1	SLFE1	SLFE1A	SLFE1EC	SLFE1DEC						
30		SLFE30	SLFE30A	SLFE30EC	SLFE30DEC	1030	4	112.7	71.0	90.5	10.5
	1 1/8	SLFE1 1/8		SLFE1 1/8EC	SLFE1 1/8DEC						
	1 3/16	SLFE1 3/16		SLFE1 3/16EC	SLFE1 3/16DEC						
	1 1/4	SLFE1 1/4	SLFE1 1/4A	SLFE1 1/4EC	SLFE1 1/4DEC						
35		SLFE1 1/4L	SLFE1 1/4AL	SLFE1 1/4ECL	SLFE1 1/4DECL	1035	5	122.2	81.0	100.0	10.5
	1 3/8	SLFE35	SLFE35A	SLFE35EC	SLFE35DEC						
	1 5/8	SLFE1 5/8		SLFE1 5/8EC	SLFE1 5/8DEC						
	1 7/16	SLFE1 7/16		SLFE1 7/16EC	SLFE1 7/16DEC						
40		SLFE40	SLFE40A	SLFE40EC	SLFE40DEC	1040	6	147.8	91.0	119.0	13.5
	1 1/2	SLFE1 1/2	SLFE1 1/2A	SLFE1 1/2EC	SLFE1 1/2DEC						
45		SLFE45	SLFE45A	SLFE45EC	SLFE45DEC	1045	7	149.2	97.0	120.5	13.5
	1 5/8	SLFE1 5/8		SLFE1 5/8EC	SLFE1 5/8DEC						
	1 11/16	SLFE1 11/16		SLFE1 11/16EC	SLFE1 11/16DEC						
	1 3/4	SLFE1 3/4	SLFE1 3/4A	SLFE1 3/4EC	SLFE1 3/4DEC						
50		SLFE50	SLFE50A	SLFE50EC	SLFE50DEC	1050	8	155.6	102.0	127.0	13.5
	1 7/8	SLFE1 7/8		SLFE1 7/8EC	SLFE1 7/8DEC						
	1 15/16	SLFE1 15/16		SLFE1 15/16EC	SLFE1 15/16DEC						
	2	SLFE2R									
55		SLFE55			SLFE55DEC	1055	9	166.6	113.0	138.0	13.5
	2	SLFE2			SLFE2DEC						
	2 1/8	SLFE2 1/8			SLFE2 1/8DEC						
	2 3/16	SLFE2 3/16			SLFE2 3/16DEC						
60		SLFE60			SLFE60DEC	1060	10	176.2	122.0	147.6	13.5
	2 1/4	SLFE2 1/4			SLFE2 1/4DEC						
	2 7/16	SLFE2 7/16			SLFE2 7/16DEC						

Please check availability

A modified version of these units is available if a Protector is to be fitted, see page 93 for details

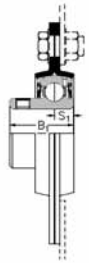
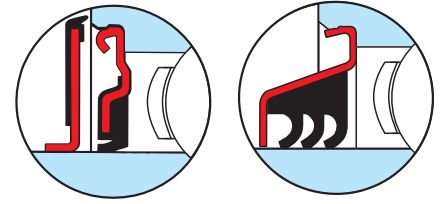

SLFE-A

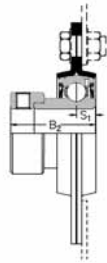

SLFE-EC

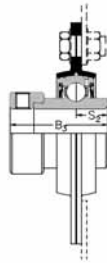

SLFE-DEC

Bearing inserts with flinger seals shown on pages 91 and 92 can be fitted into these housings. The unit reference has the suffix 'FS', e.g. SLFE25FS.

Triple seal bearing inserts shown on pages 88 to 90 can be fitted into these housings. The unit reference has a prefix 'T', e.g. TSLFE25.

	Dimensions (mm)									Max. radial housing load	Rec max. speed	Mass (approx.)
	A	A1	B	B1	B2	B3	s	s1	s2			
	6.7	4.0	27.38	–	28.63	–	11.58	6.53	–	2670	3000	0.2
	7.7	4.0	31.00	25.80	31.03	43.73	12.73	7.53	17.13	3110	3000	0.3
	8.7	4.0	34.10	27.30	31.03	44.43	14.33	7.53	17.53	3560	2500	0.4
	9.0	5.0	38.10	31.20	35.73	48.43	15.93	9.03	18.33	4890	2500	0.7
	10.0	5.0	42.90	34.90	38.93	51.13	17.53	9.53	18.83	6250	2000	0.9
	10.0	7.0	49.20	41.20	43.73	56.33	19.03	11.03	21.43	7550	2000	1.5
	10.0	7.0	49.20	41.20	43.73	56.33	19.04	11.04	21.43	7550	2000	1.6
	10.5	8.0	51.60	43.50	43.73	62.73	19.04	11.04	24.64	8450	1500	1.8
	10.7	8.0	55.60	–	–	71.42	22.24	–	27.84	10200	1500	2.2
	11.9	8.0	65.10	–	–	77.84	25.44	–	31.04	11300	1500	2.5

Self-Lube[®] pressed steel flange bearing units (zinc plated housings)

SLFT Series

Note: these units are not re-greaseable

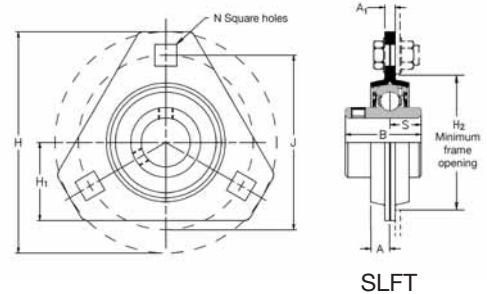

SLFT

Shaft diameter		RHP designation				Basic bearing insert	Casting group	Dimensions (mm)				
mm	inches							H	H1	H2	J	N
25		SLFT25	SLFT25A	SLFT25EC	SLFT25DEC	1025	3	95.2	34.2	60.0	76.0	8.7
	$\frac{7}{8}$	SLFT$\frac{7}{8}$		SLFT$\frac{7}{8}$EC	SLFT$\frac{7}{8}$DEC							
	$\frac{15}{16}$	SLFT$\frac{15}{16}$		SLFT$\frac{15}{16}$EC	SLFT$\frac{15}{16}$DEC							
	1	SLFT1	SLFT1A	SLFT1EC	SLFT1DEC							
30		SLFT30	SLFT30A	SLFT30EC	SLFT30DEC	1030	4	112.7	40.2	71.0	90.5	10.5
	$1\frac{1}{8}$	SLFT$1\frac{1}{8}$		SLFT$1\frac{1}{8}$EC	SLFT$1\frac{1}{8}$DEC							
	$1\frac{3}{16}$	SLFT$1\frac{3}{16}$		SLFT$1\frac{3}{16}$EC	SLFT$1\frac{3}{16}$DEC							
	$1\frac{1}{4}$	SLFT$1\frac{1}{4}$	SLFT$1\frac{1}{4}$A	SLFT$1\frac{1}{4}$EC	SLFT$1\frac{1}{4}$DEC							
35	$1\frac{1}{4}$	SLFT$1\frac{1}{4}$L	SLFT$1\frac{1}{4}$AL	SLFT$1\frac{1}{4}$ECL	SLFT$1\frac{1}{4}$DECL	1035	5	122.2	44.2	81.0	100.0	10.5
		SLFT35	SLFT35A	SLFT35EC	SLFT35DEC							
	$1\frac{3}{8}$	SLFT$1\frac{3}{8}$		SLFT$1\frac{3}{8}$EC	SLFT$1\frac{3}{8}$DEC							
	$1\frac{7}{16}$	SLFT$1\frac{7}{16}$		SLFT$1\frac{7}{16}$EC	SLFT$1\frac{7}{16}$DEC							

Please check availability

A modified version of these units is available if a Protector is to be fitted, see page 93 for details

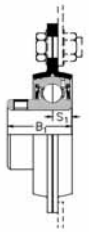
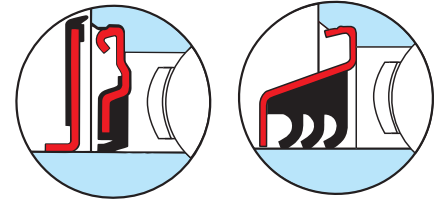

SLFT-A

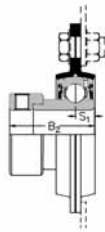

SLFT-EC

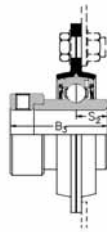

SLFT-DEC

Bearing inserts with flinger seals shown on pages 91 and 92 can be fitted into these housings. The unit reference has the suffix 'FS', e.g. SLFT35FS.

Triple seal bearing inserts shown on pages 88 to 90 can be fitted into these housings. The unit reference has a prefix 'T', e.g. TSLFT35.

	Dimensions (mm)									Max. radial housing load	Rec max. speed	Mass (approx.)
	A	A1	B	B1	B2	B3	s	s1	s2			
	8.7	4.0	34.11	27.35	30.92	44.40	14.32	7.56	17.49	newtons	rev/min	kg
	8.7	4.0	34.11	27.35	30.92	44.40	14.32	7.56	17.49	3560	2500	0.3
	9.0	5.0	38.10	31.21	35.68	48.42	15.93	9.04	18.32	4890	2500	0.5
	9.0	5.0	38.10	31.21	35.68	48.42	15.93	9.04	18.32	4890	2500	0.5
	10.0	5.0	42.88	34.90	38.88	51.18	17.53	9.55	18.89	6250	2000	0.7
	10.0	5.0	42.88	34.90	38.88	51.18	17.53	9.55	18.89	6250	2000	0.7

Self-Lube[®] pressed steel flange bearing units (zinc plated housings)

SLFL Series

Note: these units are not re-greaseable

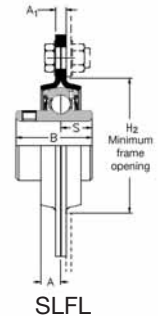
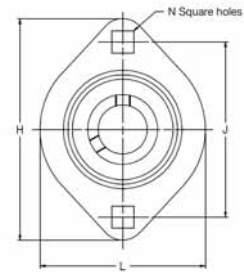

Shaft diameter		RHP designation				Basic bearing insert	Casting group	Dimensions (mm)				
mm	inches							L	H	H2	J	N
12		SLFL12		SLFL12EC		1017	1	58.7	81.0	49.0	63.5	7.1
15		SLFL15		SLFL15EC								
16		SLFL16		SLFL16EC								
17		SLFL17		SLFL17EC								
	$\frac{1}{2}$	SLFL$\frac{1}{2}$		SLFL$\frac{1}{2}$EC								
	$\frac{5}{8}$	SLFL$\frac{5}{8}$		SLFL$\frac{5}{8}$EC								
20		SLFL20	SLFL20A	SLFL20EC	SLFL20DEC	1020	2	66.7	90.5	55.0	71.5	8.7
	$\frac{3}{4}$	SLFL$\frac{3}{4}$	SLFL$\frac{3}{4}$A	SLFL$\frac{3}{4}$EC	SLFL$\frac{3}{4}$DEC							
25		SLFL25	SLFL25A	SLFL25EC	SLFL25DEC	1025	3	71.0	95.3	60.0	76.0	8.7
	$\frac{7}{8}$	SLFL$\frac{7}{8}$		SLFL$\frac{7}{8}$EC	SLFL$\frac{7}{8}$DEC							
	$\frac{15}{16}$	SLFL$\frac{15}{16}$		SLFL$\frac{15}{16}$EC	SLFL$\frac{15}{16}$DEC							
	1	SLFL1	SLFL1A	SLFL1EC	SLFL1DEC							
30		SLFL30	SLFL30A	SLFL30EC	SLFL30DEC	1030	4	84.1	112.7	71.0	90.5	10.5
	$\frac{1}{8}$	SLFL$\frac{1}{8}$		SLFL$\frac{1}{8}$EC	SLFL$\frac{1}{8}$DEC							
	$\frac{3}{16}$	SLFL$\frac{3}{16}$		SLFL$\frac{3}{16}$EC	SLFL$\frac{3}{16}$DEC							
	$\frac{1}{4}$	SLFL$\frac{1}{4}$	SLFL$\frac{1}{4}$A	SLFL$\frac{1}{4}$EC	SLFL$\frac{1}{4}$DEC							

Please check availability

A modified version of these units is available if a Protector is to be fitted, see page 93 for details

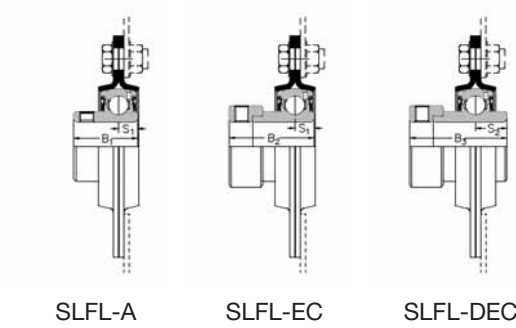
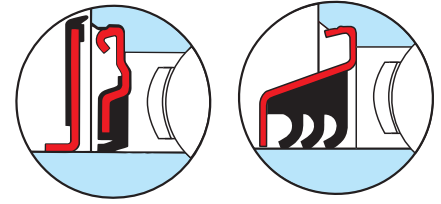

Bearing inserts with flinger seals shown on pages 91 and 92 can be fitted into these housings. The unit reference has the suffix 'FS', e.g. SLFL1FS.

Triple seal bearing inserts shown on pages 88 to 90 can be fitted into these housings. The unit reference has a prefix 'T', e.g. TSLFL1.

	Dimensions (mm)									Max. radial housing load	Rec max. speed	Mass (approx.)
	A	A1	B	B1	B2	B3	s	s1	s2			
	6.7	4.0	27.38	–	28.54	–	11.55	6.55	–	2670	3000	0.2
	7.7	4.0	30.96	25.77	30.92	43.62	12.75	7.56	17.12	3110	3000	0.3
	8.7	4.0	34.11	27.35	30.92	44.40	14.32	7.56	17.49	3560	2500	0.3
	9.0	5.0	38.10	31.21	35.68	48.42	15.93	9.04	18.32	4890	2500	0.5

Self-Lube[®] pressed steel pillow block units (zinc plated housings)

LPB Series

Note: these units are not re-greaseable

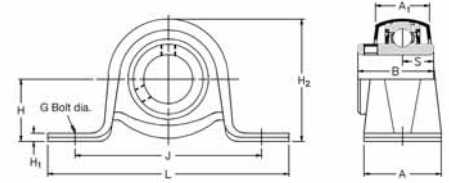

LPB

Shaft diameter		RHP designation				Basic bearing insert	Casting group	Dimensions (mm)				
mm	inches							L	H	H1	H2	J
12		LPB12		LPB12EC		1017	1	85.7	22.2	2.4	43.2	68.0
15		LPB15		LPB15EC								
16		LPB16		LPB16EC								
17		LPB17		LPB17EC								
	1/2	LPB1/2		LPB1/2EC								
	5/8	LPB5/8		LPB5/8EC								
20		LPB20	LPB20A	LPB20EC	LPB20DEC	1020	2	98.4	25.4	2.4	49.9	76.0
	3/4	LPB3/4	LPB3/4A	LPB3/4EC	LPB3/4DEC							
25		LPB25	LPB25A	LPB25EC	LPB25DEC	1025	3	108.0	28.6	2.8	55.8	86.0
	7/8	LPB7/8		LPB7/8EC	LPB7/8DEC							
	15/16	LPB15/16		LPB15/16EC	LPB15/16DEC							
	1	LPB1	LPB1A	LPB1EC	LPB1DEC							
30		LPB30	LPB30A	LPB30EC	LPB30DEC	1030	4	117.5	33.3	3.6	65.7	95.0
	1 1/8	LPB1 1/8		LPB1 1/8EC	LPB1 1/8DEC							
	1 3/16	LPB1 3/16		LPB1 3/16EC	LPB1 3/16DEC							
	1 1/4	LPB1 1/4	LPB1 1/4A	LPB1 1/4EC	LPB1 1/4DEC							
	1 1/4	LPB1 1/4L	LPB1 1/4AL	LPB1 1/4ECL	LPB1 1/4DECL							
35		LPB35	LPB35A	LPB35EC	LPB35DEC	1035	5	128.6	39.7	4.4	77.5	106.0
	1 3/8	LPB1 3/8		LPB1 3/8EC	LPB1 3/8DEC							
	1 7/16	LPB1 7/16		LPB1 7/16EC	LPB1 7/16DEC							

Please check availability

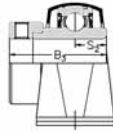
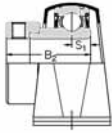
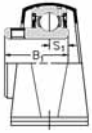

LPB-A

LPB-EC

LPB-DEC

	Dimensions (mm)										Max. radial housing load	Rec. max. speed	Mass (approx.)
	G	A	A1	B	B1	B2	B3	s	s1	s2			
	8	25.4	15.9	27.38	–	28.54	–	11.55	6.55	–	1330	3000	0.2
	8	31.7	21.6	30.96	25.77	30.92	43.62	12.75	7.56	17.12	1570	3000	0.2
	10	31.7	21.6	34.11	27.35	30.92	44.40	14.32	7.56	17.49	1780	2500	0.3
	10	37.5	25.5	38.10	31.21	35.68	48.42	15.93	9.04	18.32	2670	2500	0.5
	10	41.0	28.4	42.88	34.90	38.88	51.18	17.53	9.55	18.89	3560	2000	0.9

Self-Lube[®] pressed steel rubber mounted pillow block units (zinc plated housings)

LPBR Series

Note: these units are not re-greaseable

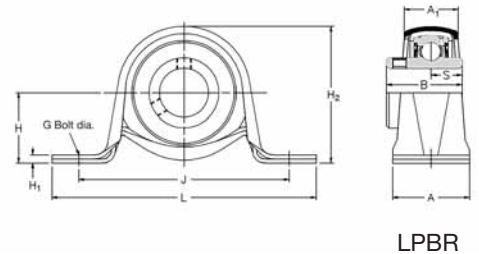

LPBR

Shaft diameter		RHP designation				Basic bearing insert	Casting group	Dimensions (mm)				
mm	inches							L	H	H1	H2	J
12		LPBR12		LPBR12EC		1017	2	98.4	25.4	2.4	49.9	76.0
15		LPBR15		LPBR15EC								
16		LPBR16		LPBR16EC								
17		LPBR17		LPBR17EC								
	1/2	LPBR1/2		LPBR1/2EC								
	5/8	LPBR5/8		LPBR5/8EC								
20		LPBR20	LPBR20A	LPBR20EC	LPBR20DEC	1020	3	108.0	28.6	2.8	55.8	86.0
	3/4	LPBR3/4	LPBR3/4A	LPBR3/4EC	LPBR3/4DEC							
25		LPBR25	LPBR25A	LPBR25EC	LPBR25DEC	1025	4	117.5	33.3	3.6	65.7	95.0
	7/8	LPBR7/8		LPBR7/8EC	LPBR7/8DEC							
	15/16	LPBR15/16		LPBR15/16EC	LPBR15/16DEC							
	1	LPBR1	LPBR1A	LPBR1EC	LPBR1DEC							
30		LPBR30	LPBR30A	LPBR30EC	LPBR30DEC	1030	5	128.6	39.7	4.4	77.5	106.0
	1 1/8	LPBR1 1/8		LPBR1 1/8EC	LPBR1 1/8DEC							
	1 3/16	LPBR1 3/16		LPBR1 3/16EC	LPBR1 3/16DEC							
	1 1/4	LPBR1 1/4	LPBR1 1/4A	LPBR1 1/4EC	LPBR1 1/4DEC							

Please check availability

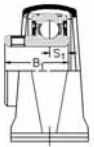

LPBR-A

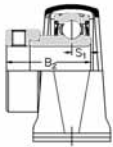

LPBR-EC

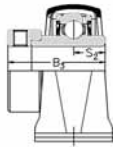

LPBR-DEC

	Dimensions (mm)										Max. radial housing load	Rec. max. speed	Mass (approx.)
	G	A	A1	B	B1	B2	B3	s	s1	s2			
	8	31.7	21.6	27.38	–	28.54	–	11.55	6.55	–	890	3000	0.2
	10	31.7	21.6	30.96	25.77	30.92	43.62	12.75	7.56	17.12	1110	3000	0.3
	10	37.5	25.5	34.11	27.35	30.92	44.40	14.32	7.56	17.49	1330	2500	0.5
	10	41.0	28.4	38.10	31.21	35.68	48.42	15.93	9.04	18.32	1560	2500	0.9

Self-Lube[®] bearing inserts

1000G and 1100 Series

Shaft diameter		RHP designation		Dimensions (mm)						ISO load ratings		Rec. max. speed	Mass (approx.)	
mm	inches	1000G Series	1100 Series	D	C	B	s	d1	M	r	dynamic Cr newtons	static Cor newtons	rev/min	kg
12 15 16 17	1/2 5/8	1017-12G 1017-15G 1017-16G 1017-17G 1017-1 1/2G 1017-5/8G	1117-12 1117-15 1117-16 1117-17 1117-1 1/2 1117-5/8	40.000	12.00	27.38	11.58	24.80	5.00	0.60	9550	4800	7000	0.09
20	3/4	1020-20G 1020-3/4G	1120-20 1120-3/4	47.000	14.00	31.00	12.73	28.30	5.00	1.00	12800	6650	6700	0.13
25	7/8 15/16 1	1025-25G 1025-7/8G 1025-15/16G 1025-1G	1125-25 1125-7/8 1125-15/16 1125-1	52.000	15.00	34.10	14.33	34.00	5.00	1.00	14000	7880	6250	0.17
25 30	1 1 1/8 1 3/16 1 1/4	1030-25G 1030-30G 1030-1G 1030-1 1/8G 1030-1 3/16G 1030-1 1/4G	1130-25 1130-30 1130-1 1130-1 1/8 1130-1 3/16 1130-1 1/4	62.000	16.00	38.10	15.93	40.30	5.00	1.00	19500	11300	5300	0.37
30 35	1 3/16 1 1/4 1 5/16 1 3/8 1 7/16	1035-30G 1035-35G 1035-1 3/16G 1035-1 1/4G 1035-1 5/16G 1035-1 3/8G 1035-1 7/16G	1135-30 1135-35 1135-1 3/16 1135-1 1/4 1135-1 5/16 1135-1 3/8 1135-1 7/16	72.000	17.00	42.90	17.53	46.90	6.50	1.00	25700	15300	4500	0.51
35 40	1 3/8 1 7/16 1 1/2	1040-35G 1040-40G 1040-1 3/8G 1040-1 7/16G 1040-1 1/2G	1140-35 1140-40 1140-1 3/8 1140-1 7/16 1140-1 1/2	80.000	18.00	49.20	19.03	52.40	8.00	1.00	32500	19900	4000	0.64
40 45	1 1/2 1 5/8 1 11/16 1 3/4	1045-40G 1045-45G 1045-1 1/2G 1045-1 5/8G 1045-1 11/16G 1045-1 3/4G	1145-40 1145-45 1145-1 1/2 1145-1 5/8 1145-1 11/16 1145-1 3/4	85.000	19.00	49.20	19.04	57.40	8.00	1.00	32500	20500	3700	0.73
45 50	1 11/16 1 3/4 1 7/8 1 15/16 2	1050-45G 1050-50G 1050-1 11/16G 1050-1 3/4G 1050-1 7/8G 1050-1 15/16G 1050-2G	1150-45 1150-50 1150-1 11/16 1150-1 3/4 1150-1 7/8 1150-1 15/16 1150-2	90.000	20.00	51.60	19.04	62.40	10.00	1.00	35000	23200	3400	0.91
50 55	1 7/8 1 15/16 2 2 1/8 2 3/16	1055-50G 1055-55G 1055-1 7/8G 1055-1 15/16G 1055-2G 1055-2 1/8G 1055-2 3/16G	1155-50 1155-55 1155-1 7/8 1155-1 15/16 1155-2 1155-2 1/8 1155-2 3/16	100.000	21.00	55.60	22.24	68.90	10.00	1.50	43500	29200	3100	1.12

Please check availability

1000G
With spherical outside diameter and integral set screw lock

1100
With parallel outside diameter and integral set screw lock

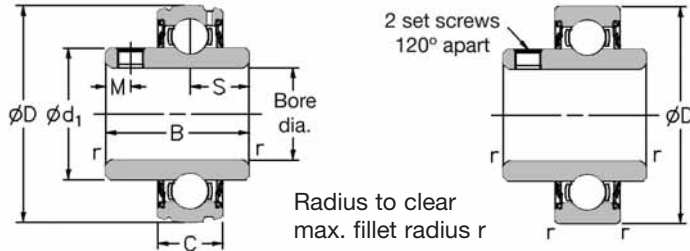

Shaft diameter		RHP designation		Dimensions (mm)						ISO load ratings		Rec. max. speed	Mass (approx.)	
										dynamic Cr newtons	static Cor newtons			rev/min
mm	inches	1000G Series	1100 Series	D	C	B	s	d1	M	r				
55 60	2 ³ / ₁₆ 2 ¹ / ₄ 2 ³ / ₈ 2 ⁷ / ₁₆	1060-55G 1060-60G 1060-2³/₁₆G 1060-2¹/₄G 1060-2³/₈G 1060-2⁷/₁₆G	1160-55 1160-60 1160-2³/₁₆ 1160-2¹/₄ 1160-2³/₈ 1160-2⁷/₁₆	110.000	22.00	65.10	25.44	76.00	10.00	1.50	48000	33000	2800	1.47
60 65	2 ¹ / ₂	1065-60G 1065-65G 1065-2¹/₂G	1165-60 1165-65 1165-2¹/₂	120.000	23.00	65.10	25.44	82.50	10.00	1.50	57500	40000	2600	2.02
60 65 70	2 ⁷ / ₁₆ 2 ¹ / ₂ 2 ⁵ / ₈ 2 ¹¹ / ₁₆	1070-60G 1070-65G 1070-70G 1070-2⁷/₁₆G 1070-2¹/₂G 1070-2⁵/₈G 1070-2¹¹/₁₆G	1170-60 1170-65 1170-70 1170-2⁷/₁₆ 1170-2¹/₂ 1170-2⁵/₈ 1170-2¹¹/₁₆	125.000	24.00	74.60	30.24	89.00	12.00	1.50	61000	45000	2450	2.27
65 70 75	2 ¹¹ / ₁₆ 2 ³ / ₄ 2 ⁷ / ₈ 2 ¹⁵ / ₁₆ 3	1075-65G 1075-70G 1075-75G 1075-2¹¹/₁₆G 1075-2³/₄G 1075-2⁷/₈G 1075-2¹⁵/₁₆G 1075-3G	1175-65 1175-70 1175-75 1175-2¹¹/₁₆ 1175-2³/₄ 1175-2⁷/₈ 1175-2¹⁵/₁₆ 1175-3	130.000	25.00	77.80	33.34	94.00	12.00	1.50	66000	49500	2300	2.61
75 80	2 ¹⁵ / ₁₆ 3 3 ³ / ₁₆ 3 ¹ / ₄	1080-75G 1080-80G 1080-2¹⁵/₁₆G 1080-3G 1080-3³/₁₆G 1080-3¹/₄G	1180-75 1180-80 1180-2¹⁵/₁₆ 1180-3 1180-3³/₁₆ 1180-3¹/₄	140.000	26.00	82.60	33.34	100.00	12.00	2.00	71500	54500	2150	3.23
80 85	3 ³ / ₁₆ 3 ¹ / ₄ 3 ³ / ₈ 3 ⁷ / ₁₆	1085-80G 1085-85G 1085-3³/₁₆G 1085-3¹/₄G 1085-3³/₈G 1085-3⁷/₁₆G	1185-80 1185-85 1185-3³/₁₆ 1185-3¹/₄ 1185-3³/₈ 1185-3⁷/₁₆	150.000	28.00	85.70	34.15	107.10	12.00	2.00	83000	64000	2000	3.74
85 90	3 ⁷ / ₁₆ 3 ¹ / ₂	1090-85G 1090-90G 1090-3⁷/₁₆G 1090-3¹/₂G	1190-85 1190-90 1190-3⁷/₁₆ 1190-3¹/₂	160.000	30.00	96.00	39.74	111.50	15.00	2.00	96000	71500	1900	4.99
95 100	3 ¹⁵ / ₁₆ 4	3095-95G 3095-100G 3095-3¹⁵/₁₆G 3095-4G		200.000	45.00	117.48	49.31	127.10	16.00	2.50	157000	122000	1600	9.53

Please check availability

Self-Lube® bearing inserts

1000DECG and 1100DEC Series

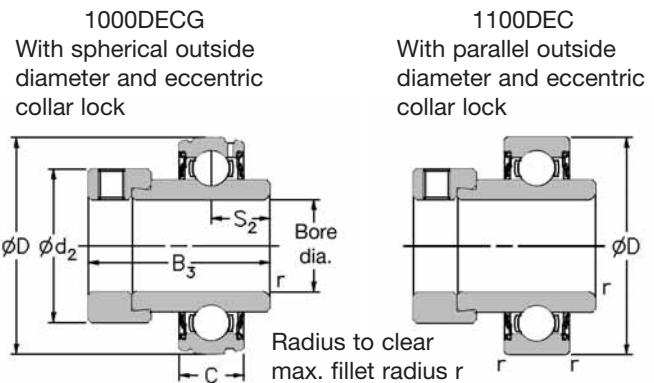

Shaft diameter		RHP designation		Dimensions (mm)						ISO load ratings		Rec. max. speed	Mass (approx.)
mm	inches	1000DECG Series	1100EC Series	D	C	B3	s2	d2	r	dynamic Cr	static Cor	rev/min	kg
										newtons	newtons		
20	3/4	1020-20DECG 1020-3/4DECG	1120-20DEC 1120-3/4DEC	47.000	14.00	43.73	17.13	33.30	1.00	12800	6650	6700	0.20
25	7/8 15/16 1	1025-25DECG 1025-7/8DECG 1025-15/16DECG 1025-1DECG	1125-25DEC 1125-7/8DEC 1125-15/16DEC 1125-1DEC	52.000	15.00	44.43	17.53	38.10	1.00	14000	7880	6250	0.26
30	1 1/8 1 3/16 1 1/4	1030-30DECG 1030-1 1/8DECG 1030-1 3/16DECG 1030-1 1/4DECG	1130-30DEC 1130-1 1/8DEC 1130-1 3/16DEC 1130-1 1/4DEC	62.000	16.00	48.43	18.33	44.50	1.00	19500	11300	5300	0.53
35	1 1/4 1 3/8 1 7/16	1035-35DECG 1035-1 1/4DECG 1035-1 3/8DECG 1035-1 7/16DECG	1135-35DEC 1135-1 1/4DEC 1135-1 3/8DEC 1135-1 7/16DEC	72.000	17.00	51.13	18.83	55.60	1.00	25700	15300	4500	0.70
40	1 1/2	1040-40DECG 1040-1 1/2DECG	1140-40DEC 1140-1 1/2DEC	80.000	18.00	56.33	21.43	60.30	1.00	32500	19900	4000	0.82
45	1 5/8 1 11/16 1 3/4	1045-45DECG 1045-1 5/8DECG 1045-1 11/16DECG 1045-1 3/4DECG	1145-45DEC 1145-1 5/8DEC 1145-1 11/16DEC 1145-1 3/4DEC	85.000	19.00	56.33	21.43	63.50	1.00	32500	20500	3700	1.08
50	1 7/8 1 15/16	1050-50DECG 1050-1 7/8DECG 1050-1 15/16DECG	1150-50DEC 1150-1 7/8DEC 1150-1 15/16DEC	90.000	20.00	62.73	24.64	69.90	1.00	35000	23200	3400	1.19
55	2 2 1/8 2 3/16	1055-55DECG 1055-2DECG 1055-2 1/8DECG 1055-2 3/16DECG	1155-55DEC 1155-2DEC 1155-2 1/8DEC 1155-2 3/16DEC	100.000	21.00	71.42	27.84	76.20	1.50	43500	29200	3100	1.40
60	2 1/4 2 3/8 2 7/16	1060-60DECG 1060-2 1/4DECG 1060-2 3/8DECG 1060-2 7/16DECG	1160-60DEC 1160-2 1/4DEC 1160-2 3/8DEC 1160-2 7/16DEC	110.000	22.00	77.84	31.04	84.20	1.50	48000	33000	2800	1.72
	2 1/2	1065-60DECG 1065-2 1/2DECG	1165-60DEC 1165-2 1/2DEC	120.000	23.00	85.74	34.14	92.00	1.50	57500	40000	2600	2.21
65 70	2 1/2 2 5/8 2 11/16	1070-65DECG 1070-70DECG 1070-2 1/2DECG 1070-2 5/8DECG 1070-2 11/16DECG	1170-65DEC 1170-70DEC 1170-2 1/2DEC 1170-2 5/8DEC 1170-2 11/16DEC	125.000	24.00	85.74	34.14	97.00	1.50	61000	45000	2450	2.56
65 70 75	2 11/16 2 3/4 2 7/8 2 15/16	1075-65DECG 1075-70DECG 1075-75DECG 1075-2 11/16DECG 1075-2 3/4DECG 1075-2 7/8DECG 1075-2 15/16DECG	1175-65DEC 1175-70DEC 1175-75DEC 1175-2 11/16DEC 1175-2 3/4DEC 1175-2 7/8DEC 1175-2 15/16DEC	130.000	25.00	92.14	37.34	102.00	1.50	66000	49500	2300	2.94

Please check availability

Self-Lube® bearing inserts

1200G and 1300 Series

1200G
With spherical outside diameter and integral set screw lock

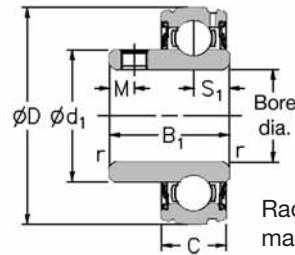

1300DEC
With parallel outside diameter and integral set screw lock

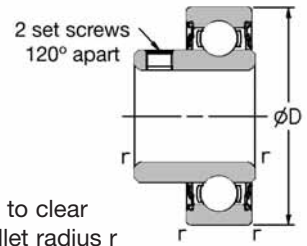

Shaft diameter		RHP designation		Dimensions (mm)							ISO load ratings		Rec. max. speed rev/min	Mass (approx.) kg
				D	C	B1	s1	d1	M	r	dynamic Cr newtons	static Cor newtons		
mm	inches	1200G Series	1300 Series											
20	¾	1220-20G 1220-¾G	1320-20 1320-¾	47.000	14.00	25.80	7.53	28.30	5.00	1.00	12800	6650	6700	0.10
25	1	1225-25G 1225-1G	1325-25 1325-1	52.000	15.00	27.30	7.53	34.00	5.00	1.00	14000	7880	6250	0.13
30	1¼	1230-30G 1230-¼G	1330-30 1330-¼	62.000	16.00	31.20	9.03	40.30	5.00	1.00	19500	11300	5300	0.32
35	1¼	1235-35G 1235-1¼G	1335-35 1335-1¼	72.000	17.00	34.90	9.53	46.90	6.50	1.00	25700	15300	4500	0.43
40	1½	1240-40G 1240-1½G	1340-40 1340-1½	80.000	18.00	41.20	11.03	52.40	8.00	1.00	32500	19900	4000	0.54
45	1¾	1245-45G 1245-1¾G	1345-45 1345-1¾	85.000	19.00	41.20	11.04	57.40	8.00	1.00	32500	20500	3700	0.61
50		1250-50G	1350-50	90.000	20.00	43.50	11.04	62.40	10.00	1.00	35000	23200	3400	0.76

Please check availability

Self-Lube® bearing inserts

1200EC and 1200ECG Series 1300EC Series

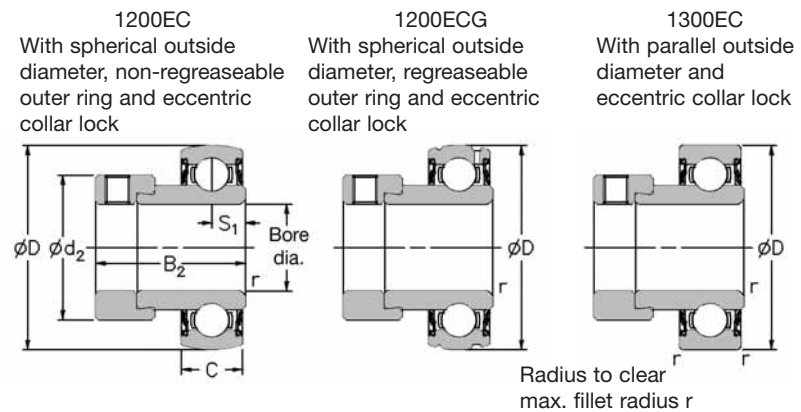

Shaft diameter		RHP designation			Dimensions (mm)						ISO load ratings		Rec. max. speed rev/min	Mass (approx.) kg
					D	C	B2	s1	d2	r	dynamic Cr newtons	static Cor newtons		
mm	inches	1200EC Series	1200ECG Series	1300EC Series										
12		1217-12EC	1217-12ECG	1317-12EC	40.000	12.00	28.63	6.53	28.60	0.60	9550	4800	7000	0.15
15		1217-15EC	1217-15ECG	1317-15EC										
16		1217-16EC	1217-16ECG	1317-16EC										
17		1217-17EC	1217-17ECG	1317-17EC										
	1/2	1217-1/2EC	1217-1/2ECG	1317-1/2EC										
	5/8	1217-5/8EC	1217-5/8ECG	1317-5/8EC										
20		1220-20EC	1220-20ECG	1320-20EC	47.000	14.00	31.03	7.53	33.30	1.00	12800	6650	6700	0.16
	3/4	1220-3/4EC	1220-3/4ECG	1320-3/4EC										
25		1225-25EC	1225-25ECG	1325-25EC	52.000	15.00	31.03	7.53	38.10	1.00	14000	7880	6250	0.23
	7/8	1225-7/8EC	1225-7/8ECG	1325-7/8EC										
	15/16	1225-15/16EC	1225-15/16ECG	1325-15/16EC										
	1	1225-1EC	1225-1ECG	1325-1EC										
30		1230-30EC	1230-30ECG	1330-30EC	62.000	16.00	35.73	9.03	44.50	1.00	19500	11300	5300	0.40
	1 1/8	1230-1 1/8EC	1230-1 1/8ECG	1330-1 1/8EC										
	1 3/16	1230-1 3/16EC	1230-1 3/16ECG	1330-1 3/16EC										
	1 1/4	1230-1 1/4EC	1230-1 1/4ECG	1330-1 1/4EC										
35		1235-35EC	1235-35ECG	1335-35EC	72.000	17.00	38.93	9.53	55.60	1.00	25700	15300	4500	0.58
	1 1/4	1235-1 1/4EC	1235-1 1/4ECG	1335-1 1/4EC										
	1 3/8	1235-1 3/8EC	1235-1 3/8ECG	1335-1 3/8EC										
	1 7/16	1235-1 7/16EC	1235-1 7/16ECG	1335-1 7/16EC										
40		1240-40EC	1240-40ECG	1340-40EC	80.000	18.00	43.73	11.03	60.30	1.00	32500	19900	4000	0.73
	1 1/2	1240-1 1/2EC	1240-1 1/2ECG	1340-1 1/2EC										
45		1245-45EC	1245-45ECG	1345-45EC	85.000	19.00	43.73	11.03	63.50	1.00	32500	20500	3700	0.87
	1 5/8	1245-1 5/8EC	1245-1 5/8ECG	1345-1 5/8EC										
	1 11/16	1245-1 11/16EC	1245-1 11/16ECG	1345-1 11/16EC										
	1 3/4	1245-1 3/4EC	1245-1 3/4ECG	1345-1 3/4EC										
50		1250-50EC	1250-50ECG	1350-50EC	90.000	20.00	43.73	11.04	69.90	1.00	35000	23200	3400	0.98
	1 7/8	1250-1 7/8EC	1250-1 7/8ECG	1350-1 7/8EC										
	1 15/16	1250-1 15/16EC	1250-1 15/16ECG	1350-1 15/16EC										
	2	1250-2EC	1250-2ECG	1350-2EC										

Please check availability

Self-Lube® bearing inserts complete with snap ring

1100CG Series

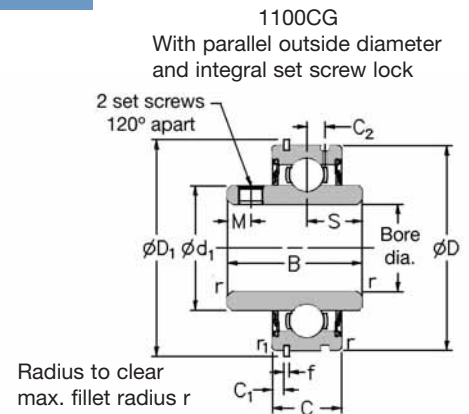

Shaft diameter		RHP designation	Dimensions (mm)											ISO load ratings		Rec. max. speed rev/min	Mass (approx.) kg	
			D	D1	C	C1	C2	B	s	d1	f	M	r	r1	dynamic Cr newtons			static Cor newtons
20	3/4	1120-20CG 1120-3/4CG	47.000	52.68	15.88	2.39	4.17	31.00	12.73	28.30	1.12	5.00	1.00	0.50	12800	6650	6700	0.23
25	7/8 15/16 1	1125-25CG 1125-7/8CG 1125-15/16CG 1125-1CG	52.000	57.81	19.05	2.39	4.39	34.10	14.33	34.00	1.12	5.00	1.00	0.50	14000	7880	6250	0.31
30	1 1/8 1 3/16	1130-30CG 1130-1 1/8CG 1130-1 3/16CG	62.000	67.69	22.22	3.18	5.10	38.10	15.93	40.30	1.70	5.00	1.00	0.50	19500	11300	5300	0.42
35	1 1/4 1 3/8 1 7/8	1135-35CG 1135-1 1/4CG 1135-1 3/8CG 1135-1 7/8CG	72.000	78.51	23.81	3.18	5.61	42.90	17.53	46.90	1.70	6.50	1.00	1.00	25700	15300	4500	0.61
40	1 1/2	1140-40CG 1140-1 1/2CG	80.000	86.51	27.78	3.18	6.22	49.20	19.03	52.40	1.70	8.00	1.00	1.00	32500	19900	4000	0.91
45	1 5/8 1 11/16 1 3/4	1145-45CG 1145-1 5/8CG 1145-1 11/16CG 1145-1 3/4CG	85.000	91.51	27.78	3.18	6.52	49.20	19.04	57.40	1.70	8.00	1.00	1.00	32500	20500	3700	1.05
	1 7/8 1 5/4	1150-1 7/8CG 1150-1 5/4CG	90.000	96.49	28.58	3.18	6.72	51.59	19.10	62.40	2.46	10.00	1.00	1.00	35000	23200	3400	1.10
55	2 2 3/16	1155-55CG 1155-2CG 1155-2 3/16CG	100.00	106.50	30.16	3.18	7.43	55.60	22.20	68.90	2.46	10.00	1.00	1.00	43500	29200	3100	1.50

Please check availability

Self-Lube[®] bearing inserts with adapter sleeves

1000-KG and 1100-K Series

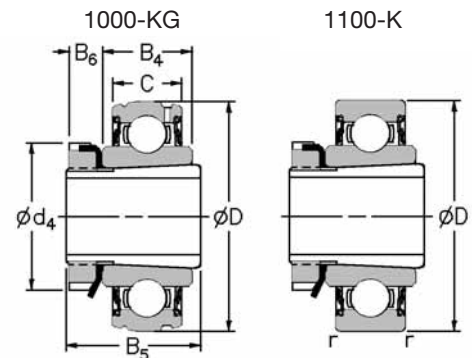

Shaft diameter	RHP designation		Sleeve, nut & lockwasher assembly only	Basic insert without sleeve, nut & lockwasher		Dimensions (mm)				
	mm	inches		1000KG	1100K	D	C	B4		
20			1025-20KG 1025-³/₄KG	1125-20K 1125-³/₄K	H305 HE305-³/₄	1025KG	1125K	52.000	15.00	19.00
25			1030-25KG 1030-¹⁵/₁₆KG 1030-1KG	1130-25K 1130-¹⁵/₁₆K 1130-1K	H306 HE306-¹⁵/₁₆ HE306-1	1030KG	1130K	62.000	16.00	20.00
30			1035-30KG 1035-¹/₈KG 1035-³/₁₆KG	1135-30K 1135-¹/₈K 1135-³/₁₆K	H307 HE307-¹/₈ HE307-³/₁₆	1035KG	1135K	72.000	17.00	21.00
35			1040-35KG 1040-¹/₄KG 1040-³/₈KG	1140-35K 1140-¹/₄K 1140-³/₈K	H308 HE308-¹/₄ HE308-³/₈	1040KG	1140K	80.000	18.00	22.00
40			1045-40KG 1045-⁷/₁₆KG 1045-¹/₂KG	1145-40K 1145-⁷/₁₆K 1145-¹/₂K	H309 HE309-⁷/₁₆ HE309-¹/₂	1045KG	1145K	85.000	19.00	23.00
45			1050-45KG 1050-¹¹/₁₆KG 1050-³/₄KG	1150-45K 1150-¹¹/₁₆K 1150-³/₄K	H310 HE310-¹¹/₁₆ HE310-³/₄	1050KG	1150K	90.000	20.00	24.00
50			1055-50KG 1055-¹⁵/₁₆KG 1055-2KG	1155-50K 1155-¹⁵/₁₆K 1155-2K	H311 HE311-¹⁵/₁₆ HE311-2	1055KG	1155K	100.000	21.00	25.00

Please check availability

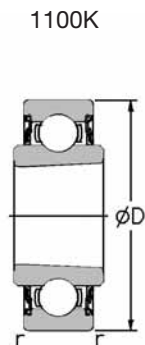
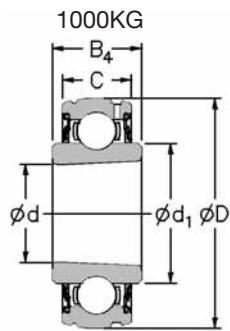

Bore taper 1:12
on diameter

	Dimensions (mm)						ISO load ratings		Rec max. speed	Mass (approx.)
	B5	B6	d	d1	d4	r	dynamic Cr newtons	static Cor newtons	rev/min	kg
	29.00	8.00	25.000	34.00	38.00	1.00	14000	7880	6250	0.20
	31.00	8.00	30.000	40.30	45.00	1.00	19500	11300	5300	0.30
	35.00	9.00	35.000	46.90	52.00	1.00	25700	15300	4500	0.42
	36.00	10.00	40.000	52.40	58.00	1.00	32500	19900	4000	0.54
	39.00	11.00	45.000	57.40	65.00	1.00	32500	20500	3700	0.64
	42.00	12.00	50.000	62.40	70.00	1.00	35000	23200	3400	0.75
	45.00	12.00	55.000	68.90	75.00	1.50	43500	29200	3100	0.95

Self-Lube[®] triple seal bearing inserts

T1000G Series



T1000G

With spherical outside diameter and integral set screw lock

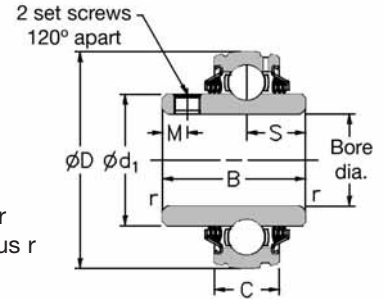

Radius to clear max. fillet radius r

Shaft diameter		RHP designation	Dimensions (mm)						ISO load ratings		Rec. max. speed rev/min	Mass (approx.) kg	
			D	C	B	s	d1	M	r	dynamic Cr newtons			static Cor newtons
mm	inches												
25	7/8 15/16 1	T1025-25G T1025-7/8G T1025-15/16G T1025-1G	52.000	15.00	34.10	14.33	34.00	5.00	1.00	14000	7880	1000	0.17
25 30	7/8 1 1 1/8 1 3/16 1 1/4	T1030-25G T1030-30G T1030-7/8G T1030-1G T1030-1 1/8G T1030-1 3/16G T1030-1 1/4G	62.000	18.00	38.10	15.93	40.30	5.00	1.00	19500	11300	850	0.37
30 35	1 3/16 1 1/4 1 3/8 1 7/16	T1035-30G T1035-35G T1035-1 3/16G T1035-1 1/4G T1035-1 3/8G T1035-1 7/16G	72.000	19.00	42.90	17.53	46.90	6.50	1.00	25700	15300	750	0.51
35 40	1 3/8 1 7/16 1 1/2	T1040-35G T1040-40G T1040-1 3/8G T1040-1 7/16G T1040-1 1/2G	80.000	21.00	49.20	19.03	52.40	8.00	1.00	32500	19900	650	0.64
40 45	1 1/2 1 5/8 1 11/16 1 3/4	T1045-40G T1045-45G T1045-1 1/2G T1045-1 5/8G T1045-1 11/16G T1045-1 3/4G	85.000	22.00	49.20	19.04	57.40	8.00	1.00	32500	20500	600	0.73
45 50	1 11/16 1 3/4 1 7/8 1 15/16 2	T1050-45G T1050-50G T1050-1 11/16G T1050-1 3/4G T1050-1 7/8G T1050-1 15/16G T1050-2G	90.000	23.00	51.60	19.04	62.40	10.00	1.00	35000	23200	550	0.91
50 55	1 7/8 1 15/16 2 2 1/8 2 3/16	T1055-50G T1055-55G T1055-1 7/8G T1055-1 15/16G T1055-2G T1055-2 1/8G T1055-2 3/16G	100.000	25.00	55.60	22.24	68.90	10.00	1.50	43500	29200	500	1.12

Please check availability

Shaft diameter		RHP designation	Dimensions (mm)						ISO load ratings		Rec. max. speed rev/min	Mass (approx.) kg	
mm	inches		D	C	B	s	d1	M	r	dynamic Cr newtons			static Cor newtons
55 60	$2\frac{3}{16}$ $2\frac{1}{4}$ $2\frac{3}{8}$ $2\frac{7}{16}$	T1060-55G T1060-60G T1060-2$\frac{3}{16}$G T1060-2$\frac{1}{4}$G T1060-2$\frac{3}{8}$G T1060-2$\frac{7}{16}$G	110.000	25.00	65.10	25.44	76.00	10.00	1.50	48000	33000	450	1.50
60 65 70	$2\frac{7}{16}$ $2\frac{1}{2}$ $2\frac{5}{8}$ $2\frac{11}{16}$	T1070-60G T1070-65G T1070-70G T1070-2$\frac{7}{16}$G T1070-2$\frac{1}{2}$G T1070-2$\frac{5}{8}$G T1070-2$\frac{11}{16}$G	125.000	28.00	74.60	30.24	89.00	12.00	1.50	61000	45000	400	2.30
75 80	$2\frac{15}{16}$ 3	T1080-75G T1080-80G T1080-2$\frac{15}{16}$G T1080-3G	140.000	30.00	82.60	33.34	100.00	12.00	2.00	71500	54500	345	3.27

Please check availability

Self-Lube® triple seal bearing inserts

T1000DECG Series

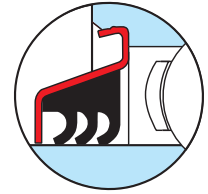

T1000DECG
With spherical outside diameter and eccentric collar lock

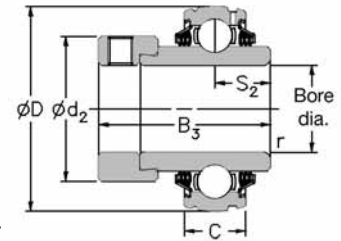

Radius to clear
max. fillet radius r

Shaft diameter		RHP designation	Dimensions (mm)					ISO load ratings		Rec. max. speed rev/min	Mass (approx.) kg	
			D	C	B3	s2	d2	r	dynamic Cr newtons			static Cor newtons
mm	inches											
25	$\frac{7}{8}$ $\frac{15}{16}$ 1	T1025-25DECG T1025-$\frac{7}{8}$DECG T1025-$\frac{15}{16}$DECG T1025-1DECG	52.000	15.00	44.43	17.53	38.10	1.00	14000	7880	1000	0.26
30	$1\frac{1}{8}$ $1\frac{3}{16}$ $1\frac{1}{4}$	T1030-30DECG T1030-$1\frac{1}{8}$DECG T1030-$1\frac{3}{16}$DECG T1030-$1\frac{1}{4}$DECG	62.000	18.00	48.43	18.33	44.50	1.00	19500	11300	850	0.53
35	$1\frac{1}{4}$ $1\frac{3}{8}$ $1\frac{7}{16}$	T1035-35DECG T1035-$1\frac{1}{4}$DECG T1035-$1\frac{3}{8}$DECG T1035-$1\frac{7}{16}$DECG	72.000	19.00	51.13	18.83	55.60	1.00	25700	15300	750	0.70
40	$1\frac{1}{2}$	T1040-40DECG T1040-$1\frac{1}{2}$DECG	80.000	21.00	56.33	21.43	60.30	1.00	32500	19900	650	0.82
45	$1\frac{5}{8}$ $1\frac{11}{16}$ $1\frac{3}{4}$	T1045-45DECG T1045-$1\frac{5}{8}$DECG T1045-$1\frac{11}{16}$DECG T1045-$1\frac{3}{4}$DECG	85.000	22.00	56.33	21.43	63.50	1.00	32500	20500	600	1.08
50	$1\frac{7}{8}$ $1\frac{15}{16}$	T1050-50DECG T1050-$1\frac{7}{8}$DECG T1050-$1\frac{15}{16}$DECG	90.000	23.00	62.73	24.64	69.90	1.00	35000	23200	550	1.19
55	2 $2\frac{1}{8}$ $2\frac{3}{16}$	T1055-55DECG T1055-2DECG T1055-$2\frac{1}{8}$DECG T1055-$2\frac{3}{16}$DECG	100.000	25.00	71.42	27.84	76.20	1.50	43500	29200	500	1.40
60	$2\frac{1}{4}$ $2\frac{7}{16}$	T1060-60DECG T1060-$2\frac{1}{4}$DECG T1060-$2\frac{7}{16}$DECG	110.000	25.00	77.84	31.04	84.20	1.50	48000	33000	450	1.81
65 70		T1070-65DECG T1070-70DECG	125.000	28.00	85.74	34.14	97.00	1.50	61000	45000	400	2.49

Please check availability

Self-Lube® bearing inserts with flinger seals

1000GFS Series

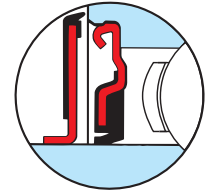

1000GFS
With spherical outside diameter and integral set screw lock

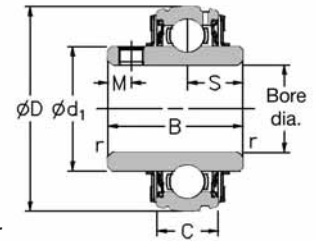

Radius to clear max. fillet radius r

Shaft diameter		RHP designation	Dimensions (mm)							ISO load ratings		Rec. max. speed rev/min	Mass (approx.) kg
mm	inches		D	C	B	s	d1	M	r	dynamic Cr newtons	static Cor newtons		
25	7/8 15/16 1	1025-25GFS 1025-7/8GFS 1025-15/16GFS 1025-1GFS	52.000	15.00	34.10	14.33	34.00	5.00	1.00	14000	7880	6250	0.17
25 30	7/8 1 1 1/8 1 3/16 1 1/4	1030-25GFS 1030-30GFS 1030-7/8GFS 1030-1GFS 1030-1 1/8GFS 1030-1 3/16GFS 1030-1 1/4GFS	62.000	16.00	38.10	15.93	40.30	5.00	1.00	19500	11300	5300	0.37
30 35	1 3/16 1 1/4 1 5/16 1 3/8 1 7/16	1035-30GFS 1035-35GFS 1035-1 3/16GFS 1035-1 1/4GFS 1035-1 5/16GFS 1035-1 3/8GFS 1035-1 7/16GFS	72.000	17.00	42.90	17.53	46.90	6.50	1.00	25700	15300	4500	0.51
35 40	1 3/8 1 7/16 1 1/2	1040-35GFS 1040-40GFS 1040-1 3/8GFS 1040-1 7/16GFS 1040-1 1/2GFS	80.000	18.00	49.20	19.03	52.40	8.00	1.00	32500	19900	4000	0.64
40 45	1 1/2 1 5/8 1 11/16 1 3/4	1045-40GFS 1045-45GFS 1045-1 1/2GFS 1045-1 5/8GFS 1045-1 11/16GFS 1045-1 3/4GFS	85.000	19.00	49.20	19.04	57.40	8.00	1.00	32500	20500	3700	0.73
45 50	1 11/16 1 3/4 1 7/8 1 15/16 2	1050-45GFS 1050-50GFS 1050-1 11/16GFS 1050-1 3/4GFS 1050-1 7/8GFS 1050-1 15/16GFS 1050-2GFS	90.000	20.00	51.60	19.04	62.40	10.00	1.00	35000	23200	3400	0.91
50 55	1 7/8 1 15/16 2 2 1/8 2 3/16	1055-50GFS 1055-55GFS 1055-1 7/8GFS 1055-1 15/16GFS 1055-2GFS 1055-2 1/8GFS 1055-2 3/16GFS	100.000	21.00	55.60	22.24	68.90	10.00	1.50	43500	29200	3100	1.12
55 60	2 3/16 2 1/4 2 3/8 2 7/16	1060-55GFS 1060-60GFS 1060-2 3/16GFS 1060-2 1/4GFS 1060-2 3/8GFS 1060-2 7/16GFS	110.000	22.00	65.10	25.44	76.00	10.00	1.50	48000	33000	2800	1.47

Please check availability

Self-Lube® bearing inserts with flinger seals

1000DECGFS Series

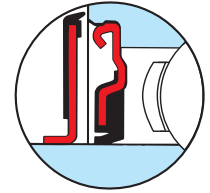

1000DECGFS
With spherical outside diameter and eccentric collar lock

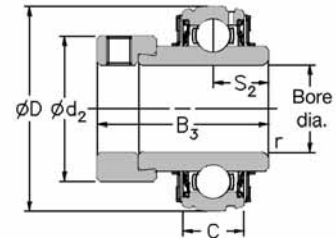

Radius to clear max. fillet radius r

Shaft diameter		RHP designation	Dimensions (mm)					ISO load ratings		Rec. max. speed rev/min	Mass (approx.) kg	
mm	inches		D	C	B3	s2	d2	r	dynamic Cr newtons			static Cor newtons
25	7/8 15/16 1	1025-25DECGFS 1025-7/8DECGFS 1025-15/16DECGFS 1025-1DECGFS	52.000	15.00	44.43	17.53	38.10	1.00	14000	7880	6250	0.26
30	1 1 3/16 1 1/4	1030-30DECGFS 1030-1 1/8DECGFS 1030-1 3/16DECGFS 1030-1 1/4DECGFS	62.000	16.00	48.43	18.33	44.50	1.00	19500	11300	5300	0.53
35	1 1/4 1 5/16 1 3/8 1 7/16	1035-35DECGFS 1035-1 1/4DECGFS 1035-1 5/16DECGFS 1035-1 3/8DECGFS 1035-1 7/16DECGFS	72.000	17.00	51.13	18.83	55.60	1.00	25700	15300	4500	0.70
40	1 1/2	1040-40DECGFS 1040-1 1/2DECGFS	80.000	18.00	56.33	21.43	60.30	1.00	32500	19900	4000	0.82
45	1 5/8 1 11/16 1 3/4	1045-45DECGFS 1045-1 5/8DECGFS 1045-1 11/16DECGFS 1045-1 3/4DECGFS	85.000	19.00	56.33	21.43	63.50	1.00	32500	20500	3700	1.08
50	1 7/8 1 15/16	1050-50DECGFS 1050-1 7/8DECGFS 1050-1 15/16DECGFS	90.000	20.00	62.73	24.64	69.90	1.00	35000	23200	3400	1.19
55	2 2 1/8 2 3/16	1055-55DECGFS 1055-2DECGFS 1055-2 1/8DECGFS 1055-2 3/16DECGFS	100.000	21.00	71.42	27.84	76.20	1.50	43500	29200	3100	1.40
60	2 1/4 2 3/8 2 7/16	1060-60DECGFS 1060-2 1/4DECGFS 1060-2 3/8DECGFS 1060-2 7/16DECGFS 1060-2 1/2DECGFS	110.000	22.00	77.84	31.04	84.20	1.50	48000	33000	2800	1.72

Please check availability

Self-Lube® protector

The Protector Range

RHP designation	Dimensions (mm)			Basic bearing insert
	Dp	A	A1	
20P	37.0	23.0	30.0	1020
25P	42.5	23.0	30.5	1025
30P	50.5	26.5	34.5	1030
35P	60.5	28.5	37.0	1035
40P	67.5	30.5	39.5	1040
45P	72.0	30.0	39.5	1045
50P	76.0	32.5	42.5	1050
55P	85.0	37.5	48.0	1055
60P	94.0	40.5	51.5	1060

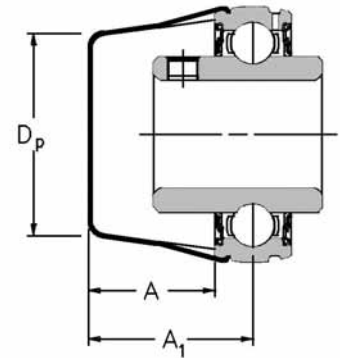

The following table shows the range of units which can be fitted with a protector and indicates the right protector to select.

Bore size	Self-Lube® unit												
	NP	SFT	SNP	LFTC	FC	ST	BT	SLFEP	SLFTP	MFC	SCHB	NP-K	MP
	NP-A	SFT-A	SNP-A	LFTC-A	FC-A	ST-A	BT-A	SLFEP-A	SLFTP-A		SCH	MP-K	MSF
	NP-EC	SFT-EC	SNP-EC	LFTC-EC	FC-EC	ST-EC	BT-EC	SLFEP-EC	SLFTP-EC			MSF-K	MSFT
	NP-DEC	SFT-DEC	SNP-DEC	LFTC-DEC	FC-DEC	ST-DEC		SLFEP-DEC	SLFTP-DEC			MSFT-K	MST
	SL	SLC	CNP	SLFLP								MST-K	MSC
	SL-A	SLC-A	CNP-A	SLFLP-A									
	SL-EC	SLC-EC	CNP-EC	SLFLP-EC									
	SL-DEC	SLC-DEC	CNP-DEC	SLFLP-DEC									
	SF												
	SF-A												
	SF-EC												
	SF-DEC												
20, 3/4	20P	20P	20P	20P	20P	20P	-	20P	-	-	20P	20P	-
25, 7/8, 15/16, 1	25P	25P	25P	25P	25P	25P	25P	25P	25P	30P	30P	30P	30P
30, 1 1/8	30P	30P	30P	30P	30P	30P	-	30P	30P	30P	30P	35P	35P
1 3/16	30P	30P	30P	30P	30P	30P	-	30P	30P	35P	35P	35P	35P
1 1/4	35P	35P	35P	35P	35P	35P	35P	30P	30P	35P	35P	40P	35P
35, 1 3/8	35P	35P	35P	35P	35P	35P	35P	35P	35P	40P	35P	40P	40P
1 7/16	35P	35P	35P	35P	35P	35P	35P	35P	35P	40P	40P	45P	40P
40, 1 1/2	40P	40P	40P	-	40P	40P	-	40P*	-	40P	40P	45P	45P
45, 1 5/8	45P	45P	45P	-	45P	45P	-	45P*	-	50P	50P	50P	50P
1 11/16, 1 3/4	45P	45P	45P	-	45P	45P	-	45P*	-	50P	50P	50P	50P
50, 1 7/8, 1 15/16	50P	50P	-	-	50P	50P	-	50P*	-	55P	50P	55P	55P
2	55P	55P	-	-	55P	55P	-	55P*	-	55P	50P	55P	55P
55, 2 1/8, 2 3/16	55P	55P	-	-	55P	55P	-	55P*	-	60P	60P	-	60P
2 1/4	60P	60P	-	-	60P	60P	-	60P*	-	60P	60P	-	60P
60, 2 3/8, 2 7/16	60P	60P	-	-	60P	60P	-	60P*	-	-	60P	-	-

* Please check availability of units (protectors are available, but special SLFEP flangettes may not be).

Note 1: The appropriate protector is determined by the basic bearing insert group.

Note 2: When a pressing from the series SLFL, SLFE or SLFT is fitted with a protector, the unit reference includes the letter "P", e.g. SLFEP-25EC.

Silver-Lube® Bearing Units



Silver-Lube® unit references

Insert Type

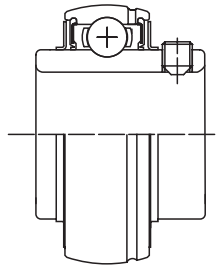

Housing Type

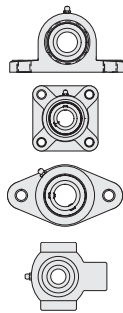

Page	100
102	PNP
104	PSF
106	PSFT
108	PST

Silver-Lube® insert references

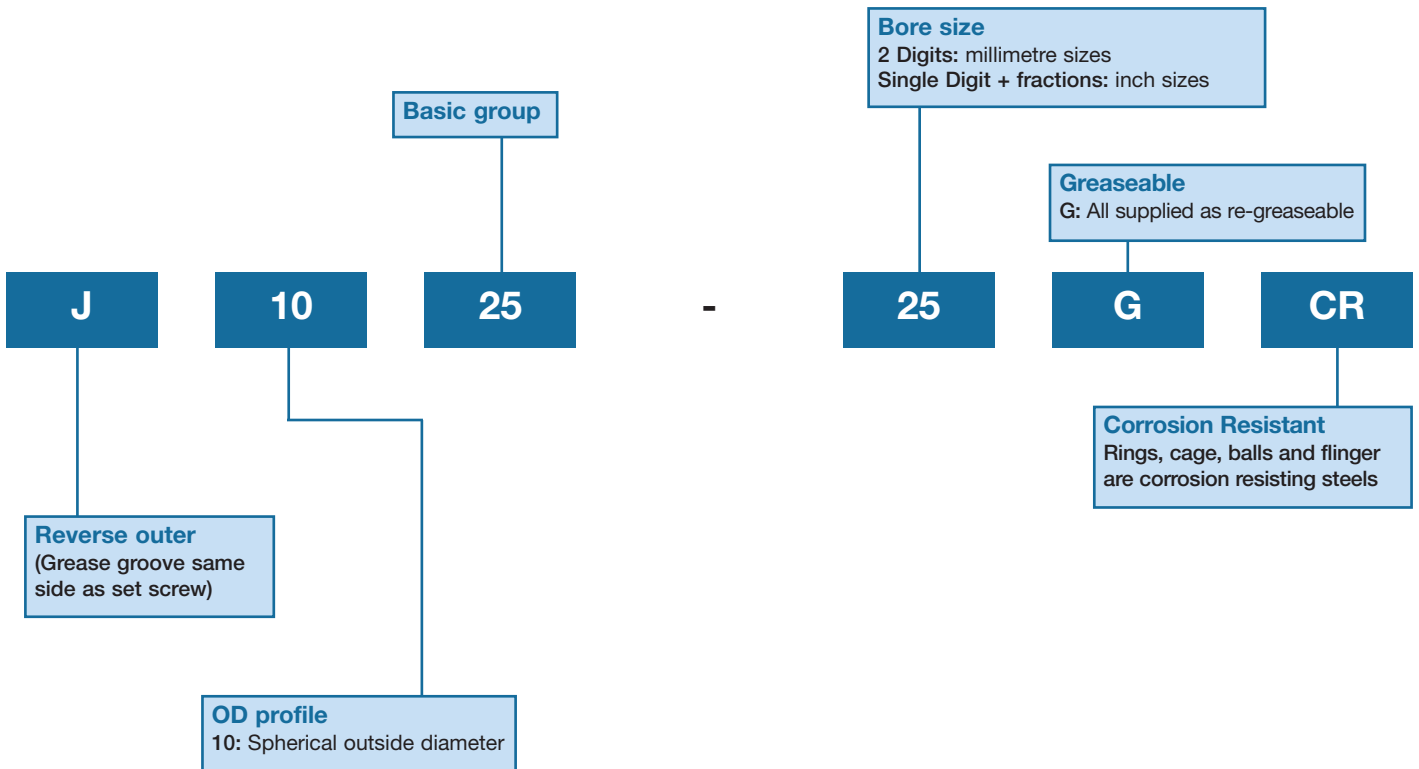

Silver-Lube® product range

Introduction

The Silver-Lube® series is a range of corrosion resistant bearing units specifically for use in industries where frequent thorough washdowns are necessary, optimum hygiene standards are required and good chemical resistance is important over a wide temperature range.

The units are available in pillow block, two-bolt flange, four-bolt flange and take-up unit configurations and are capable of accommodating initial misalignment from mounting errors. In operation the units have proven reliability in the most hostile applications. Relubrication is possible for long trouble-free life, minimising maintenance, maximising productivity and helping maintain hygiene standards.

Silver-Lube® housings are made from PBT thermoplastic resin which, in addition to being non-corrodible, is resistant to detergents and a wide range of chemicals. The housings are paint and coating free which prevents chipping or flaking and have smooth surfaces to assist thorough washdowns.

Silver-Lube® bearing inserts are made from stainless steel, are provided with effective, efficient sealing arrangements and are charged with an aluminium complex, high temperature approved food grade grease as standard.

Housing strength

Housing load carrying capacity varies depending on the application loading regime, which may be intermittent, continuous or cyclical. Maximum housing loads are given in tables 1, 2, 3 and 4. These loads must not be exceeded without prior consultation with NSK.

Published housing maximum load capacities do not allow for any reduction in housing strength caused by exposure of the housing to chemicals, water, steam, heat, ultraviolet light or any combination of these factors. If any of these factors are present in the application the designer or end-user must establish the effect of these exposures and reduce the published maximum housing load accordingly.

To maximise load carrying capacity it is recommended that washers are used with the fixing bolts. Tables 1, 2 and 3 also detail maximum fixing bolt tightening torques.

Static electricity generation

Static electricity may be generated by Silver-Lube® bearing units under certain application conditions.

Silver-Lube® bearings are therefore not recommended for use in explosive or flammable environments. If Silver-Lube® bearing units are used in flammable or explosive applications the bearing insert must be earthed.

Housing strength

Table 1 PNP Silver-Lube® pillow block - housing load capacity

RHP designation	Maximum housing load (N) at 20°C								
	P1			P2			P3		
	Intermittent loading	Continuous loading	Cyclical loading	Intermittent loading	Continuous loading	Cyclical loading	Intermittent loading	Continuous loading	Cyclical loading
PNP20CR	3500	1700	800	2800	1400	800	2600	1300	700
PNP $\frac{3}{4}$ CR	3500	1700	800	2800	1400	800	2600	1300	700
PNP25CR	4000	2000	1000	3100	1500	800	2600	1300	700
PNP1CR	4000	2000	1000	3100	1500	800	2600	1300	700
PNP30CR	5000	2500	1200	3500	1800	1000	4000	2000	1100
PNP $\frac{3}{16}$ CR	5000	2500	1200	3500	1800	1000	4000	2000	1100
PNP $\frac{1}{4}$ RCR	5000	2500	1200	3500	1800	1000	4000	2000	1100
PNP35CR	6000	3000	1500	4300	2100	1200	4100	2100	1100
PNP $\frac{1}{4}$ CR	6000	3000	1500	4300	2100	1200	4100	2100	1100
PNP $\frac{1}{16}$ CR	6000	3000	1500	4300	2100	1200	4100	2100	1100
PNP40CR	10700	5300	2900	8000	4000	2200	6800	3400	1900
PNP $\frac{1}{2}$ CR	10700	5300	2900	8000	4000	2200	6800	3400	1900

Table 2 PSF Silver-Lube® four-bolt flange - housing load capacity

RHP designation	Maximum housing load (N) at 20°C						Maximum fixing bolt torque (Nm)
	F1			F2			
	Intermittent loading	Continuous loading	Cyclical loading	Intermittent loading	Continuous loading	Cyclical loading	
PSF20CR	3100	1600	900	1300	700	400	18
PSF $\frac{3}{4}$ CR	3100	1600	900	1300	700	400	18
PSF25CR	3500	1700	1000	1300	700	400	25
PSF1CR	3500	1700	1000	1300	700	400	25
PSF30CR	4600	2300	1300	2200	1100	600	30
PSF $\frac{3}{16}$ CR	4600	2300	1300	2200	1100	600	30
PSF $\frac{1}{4}$ RCR	4600	2300	1300	2200	1100	600	30
PSF35CR	6200	3100	1700	2600	1300	700	35
PSF $\frac{1}{4}$ CR	6200	3100	1700	2600	1300	700	35
PSF $\frac{1}{16}$ CR	6200	3100	1700	2600	1300	700	35
PSF40CR	6200	3100	1700	4000	2000	1100	40
PSF $\frac{1}{2}$ CR	6200	3100	1700	4000	2000	1100	40

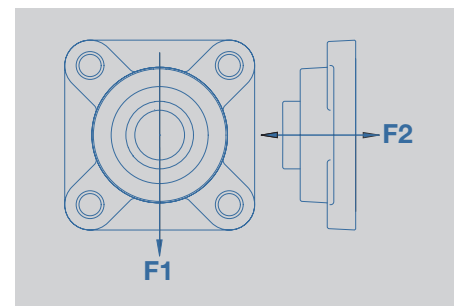

PSF SERIES

Table 4 PST Silver-Lube® take-up - housing load capacity

RHP designation	Maximum housing load (N) at 20°C		
	U Intermittent loading	U Continuous loading	U Cyclical loading
PST20CR	5700	2800	1600
PST $\frac{3}{4}$ CR	5700	2800	1600
PST25CR	5400	2700	1500
PST1CR	5400	2700	1500
PST30CR	8100	4000	2300
PST $\frac{3}{16}$ CR	8100	4000	2300
PST $\frac{1}{4}$ RCR	8100	4000	2300
PST35CR	7800	3900	2200
PST $\frac{1}{4}$ CR	7800	3900	2200
PST $\frac{1}{16}$ CR	7800	3900	2200
PST40CR	8100	4000	2300
PST $\frac{1}{2}$ CR	8100	4000	2300

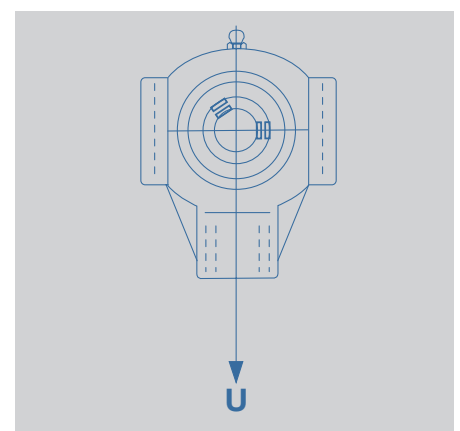

PST SERIES

Note that there is no maximum fixing bolt torque applicable for take-up units.

	Maximum housing load (N) at 20°C			Maximum fixing bolt torque (Nm)
	P4 Intermittent loading	P4 Continuous loading	P4 Cyclical loading	
	1300	700	400	18
	1300	700	400	18
	1700	900	500	25
	1700	900	500	25
	2600	1300	700	30
	2600	1300	700	30
	2600	1300	700	30
	3200	1600	900	35
	3200	1600	900	35
	3200	1600	900	35
	5200	2600	1400	40
	5200	2600	1400	40

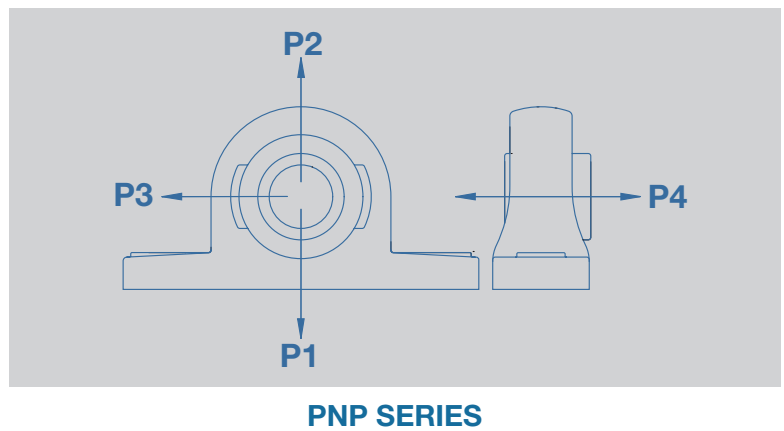
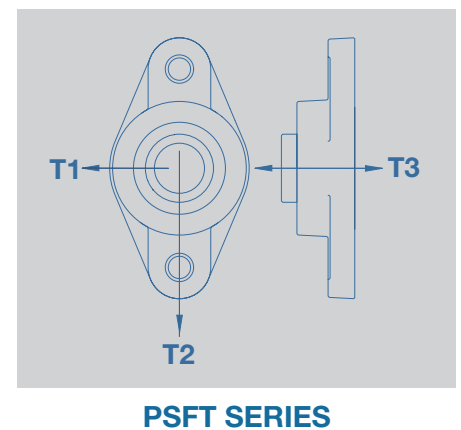

Table 3 PSFT Silver-Lube® two-bolt flange - housing load capacity

RHP designation	Maximum housing load (N) at 20°C									Maximum fixing bolt torque (Nm)
	T1 Intermittent loading	T1 Continuous loading	T1 Cyclical loading	T2 Intermittent loading	T2 Continuous loading	T2 Cyclical loading	T3 Intermittent loading	T3 Continuous loading	T3 Cyclical loading	
PSFT20CR	4400	2200	1200	1900	900	500	1300	700	400	18
PSFT ³ / ₄ CR	4400	2200	1200	1900	900	500	1300	700	400	18
PSFT25CR	4400	2200	1200	3000	1500	800	1400	700	400	25
PSFT1CR	4400	2200	1200	3000	1500	800	1400	700	400	25
PSFT30CR	5900	2900	1600	3300	1600	900	2000	1000	500	30
PSFT1 ³ / ₁₆ CR	5900	2900	1600	3300	1600	900	2000	1000	500	30
PSFT1 ¹ / ₄ RCR	5900	2900	1600	3300	1600	900	2000	1000	500	30
PSFT35CR	6400	3200	1700	3900	2000	1100	2800	1400	800	35
PSFT1 ¹ / ₄ CR	6400	3200	1700	3900	2000	1100	2800	1400	800	35
PSFT1 ⁷ / ₁₆ CR	6400	3200	1700	3900	2000	1100	2800	1400	800	35
PSFT40CR	9000	4500	2500	3900	2000	1100	3300	1600	900	40
PSFT1 ¹ / ₂ CR	9000	4500	2500	3900	2000	1100	3300	1600	900	40



Silver-Lube® bearing inserts

Silver-Lube® bearing inserts have martensitic stainless steel rings and balls, and austenitic stainless steel ball cage, flingers and set screws.

The grease in this product is an aluminium complex food grade grease, classified to NSF grade H1. In the event of relubricating being necessary, this type of grease is the first choice replacement.

If an aluminium complex food grade grease is not available, it is essential that any alternative grease is NSF H1 approved and ideally chemically compatible with the original grease. If chemical compatibility cannot be assured, then it is recommended that the original grease is completely flushed out of the system before relubrication. NSK should be consulted where necessary.

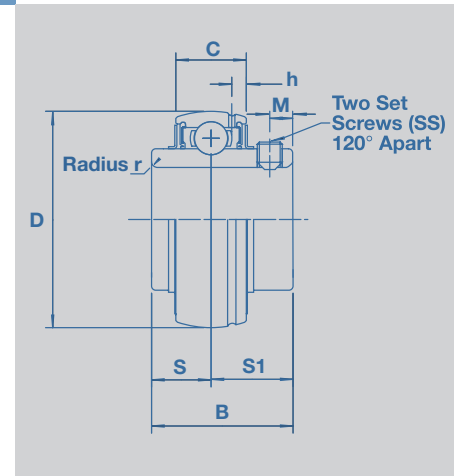

Table 5 Insert designations, dimensions and weights

Units: mm

RHP designation	Bore dia	D	C	B	S	r	M	C _r (N)	C _{or} (N)	Weight (Kg)
J1020-20GCR	20	47	16	31.0	12.7	1.5	5.0	9910	5350	0.16
J1020-3/4GCR	3/4"	47	16	31.0	12.7	1.5	5.0	9910	5350	0.16
J1025-25GCR	25	52	17	34.0	14.3	1.5	5.5	10820	6300	0.20
J1025-1GCR	1"	52	17	34.0	14.3	1.0	5.5	10820	6300	0.20
J1030-30GCR	30	62	19	38.1	15.9	1.5	6.0	15000	9050	0.32
J1030-13/16GCR	13/16"	62	19	38.1	15.9	1.0	6.0	15000	9050	0.32
J1030-11/4GCR	11/4"	62	19	38.1	15.9	1.0	6.0	15000	9050	0.32
J1035-35GCR	35	72	20	42.9	17.5	2.0	6.5	19820	12300	0.48
J1035-11/4GCR	11/4"	72	20	42.9	17.5	2.0	6.5	19820	12300	0.48
J1035-17/16GCR	17/16"	72	20	42.9	17.5	1.5	6.5	19820	12300	0.48
J1040-40GCR	40	80	21	49.2	19.0	2.0	8.0	22540	14300	0.64
J1040-11/2GCR	11/2"	80	21	49.2	19.0	2.0	8.0	22540	14300	0.64

Shaft tolerances and permissible speeds

Bearing insert permissible speed is dependent on shaft tolerance. For higher speed applications an ISO h7 shaft tolerance is recommended. An ISO h9 shaft tolerance may be used for low speed applications. For more information see table 6.

Table 6 Tolerances and speeds

Basic bearing insert	Bearing limiting speed (RPM)	ISO h7 Shaft tolerance high (0.001 mm Units)	ISO h7 Shaft tolerance low (0.001 mm Units)	Bearing limiting speed (RPM)	ISO h9 Shaft tolerance high (0.001 mm Units)	ISO h9 Shaft tolerance low (0.001 mm Units)
J1020	2900	0	-21	1490	0	-52
J1025	2600	0	-21	1300	0	-52
J1030	2180	0	-21	1090	0	-52
J1035	1870	0	-25	940	0	-62
J1040	1650	0	-25	830	0	-62

Materials and tightening torques

Materials

	Parts	Materials
Bearing	Bearing Rings	Martensitic stainless steel (equivalent to SUS440C)
	Ball	Martensitic stainless steel (equivalent to SUS440C)
	Flinger	Austenitic stainless steel (equivalent to SUS302)
	Set Screw	Martensitic stainless steel (equivalent to SUS304)
	Cage	Austenitic stainless steel (equivalent to SUS302)
Bearing housing		Thermo Plastic PBT

Set screw tightening torques

Set screws for Silver-Lube® bearing inserts are manufactured from stainless steel and can fracture if overtightened. The limiting set screw torques listed (in Table 7) should not be exceeded.

Table 7 Recommended tightening torques for set screws

Bearing designation	Designation of set screws	Maximum tightening torque (Nm)
J1020-20GCR	M6 X 6.0 LONG	4
J1020- $\frac{3}{4}$ GCR	M6 X 6.0 LONG	4
J1025-25GCR	M6 X 6.0 LONG	4
J1025-1GCR	M6 X 6.0 LONG	4
J1030-30GCR	M6 X 6.0 LONG	4
J1030- $1\frac{3}{16}$ GCR	M6 X 6.0 LONG	4
J1030- $1\frac{1}{4}$ GCR	M6 X 6.0 LONG	4
J1035-35GCR	M8 X 8.0 LONG	8
J1035- $1\frac{1}{4}$ GCR	M8 X 8.0 LONG	8
J1035- $1\frac{7}{16}$ GCR	M8 X 8.0 LONG	8
J1040-40GCR	M8 X 8.0 LONG	8
J1040- $1\frac{1}{2}$ GCR	M8 X 8.0 LONG	8

Unit dimensions

Table 8
PNP Silver-Lube® pillow block - unit dimensions

Shaft diameter		RHP designation	Basic bearing insert	Housing group	Dimensions (mm)				
mm	inches				L	H	H1	H2	J
20	¾	PNP20CR	J1020	2	127.2	33.3	14.2	65.9	94.9
		PNP¾CR	J1020	2	127.2	33.3	14.2	65.9	94.9
25	1	PNP25CR	J1025	3	140.2	36.5	14.5	71.9	104.9
		PNP1CR	J1025	3	140.2	36.5	14.5	71.9	104.9
30	1⅜	PNP30CR	J1030	4	162.2	42.9	17.8	83.9	118.9
	1¼	PNP1⅜CR	J1030	4	162.2	42.9	17.8	83.9	118.9
		PNP1¼RCR	J1030	4	162.2	42.9	17.8	83.9	118.9
35	1¼	PNP35CR	J1035	5	167.2	47.6	18.0	94.9	126.9
		PNP1¼CR	J1035	5	167.2	47.6	18.0	94.9	126.9
	1⅞	PNP1⅞CR	J1035	5	167.2	47.6	18.0	94.9	126.9
40	1½	PNP40CR	J1040	6	184.2	49.2	19.5	98.9	136.8
		PNP1½CR	J1040	6	184.2	49.2	19.5	98.9	136.8

All dimensions in mm except inch shaft sizes

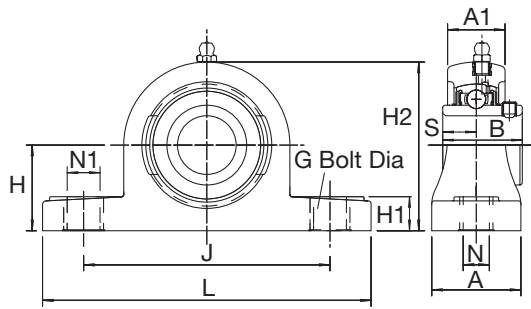

PNP SERIES

Dimensions (mm)								Weight
N	N1	G	A	A1	B	S	kg	
11.0	14.2	M10	37.8	22.5	31.0	12.7	0.27	
11.0	14.2	M10	37.8	22.5	31.0	12.7	0.27	
11.0	14.2	M10	37.8	24.5	34.0	14.3	0.39	
11.0	14.2	M10	37.8	24.5	34.0	14.3	0.39	
14.0	18.2	M12	45.8	27.0	38.1	15.9	0.52	
14.0	18.2	M12	45.8	27.0	38.1	15.9	0.52	
14.0	18.2	M12	45.8	27.0	38.1	15.9	0.52	
14.0	18.2	M12	47.8	32.5	42.9	17.5	0.72	
14.0	18.2	M12	47.8	32.5	42.9	17.5	0.72	
14.0	18.2	M12	47.8	32.5	42.9	17.5	0.72	
14.0	18.2	M12	53.8	36.0	49.2	19.0	0.99	
14.0	18.2	M12	53.8	36.0	49.2	19.0	0.99	

Unit dimensions

Table 9
PSF Silver-Lube® four-bolt flange - unit dimensions

Shaft diameter		RHP designation	Basic bearing insert	Housing group	Dimensions (mm)		
mm	inches				L	J	G
20		PSF20CR	J1020	2	86.5	63.5	M10
	$\frac{3}{4}$	PSF $\frac{3}{4}$ CR	J1020	2	86.5	63.5	M10
25		PSF25CR	J1025	3	95.0	70.0	M10
	1	PSF1CR	J1025	3	95.0	70.0	M10
30		PSF30CR	J1030	4	107.5	83.0	M12
	$1\frac{3}{16}$	PSF $1\frac{3}{16}$ CR	J1030	4	107.5	83.0	M12
	$1\frac{1}{4}$	PSF $1\frac{1}{4}$ RCR	J1030	4	107.5	83.0	M12
35		PSF35CR	J1035	5	117.5	92.0	M12
	$1\frac{1}{4}$	PSF $1\frac{1}{4}$ CR	J1035	5	117.5	92.0	M12
	$1\frac{7}{16}$	PSF $1\frac{7}{16}$ CR	J1035	5	117.5	92.0	M12
40		PSF40CR	J1040	6	130.5	102.0	M12
	$1\frac{1}{2}$	PSF $1\frac{1}{2}$ CR	J1040	6	130.5	102.0	M12

All dimensions in mm except inch shaft sizes

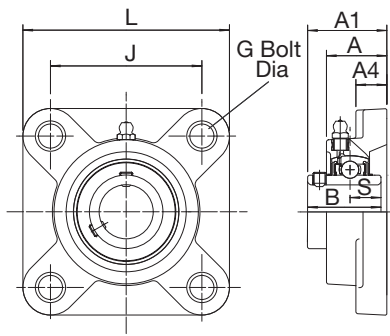

PSF SERIES

Dimensions (mm)						Weight
A	A1	A1	B	S		kg
27.8	36.3	13.4	31.0	12.7		0.28
27.8	36.3	13.4	31.0	12.7		0.28
27.9	36.7	14.3	34.0	14.3		0.34
27.9	36.7	14.3	34.0	14.3		0.34
31.5	41.4	14.3	38.1	15.9		0.50
31.5	41.4	14.3	38.1	15.9		0.50
31.5	41.4	14.3	38.1	15.9		0.50
34.8	46.9	15.5	42.9	17.5		0.74
34.8	46.9	15.5	42.9	17.5		0.74
34.8	46.9	15.5	42.9	17.5		0.74
37.5	53.2	17.1	49.2	19.0		0.98
37.5	53.2	17.1	49.2	19.0		0.98

Unit dimensions

Table 10
PSFT Silver-Lube® two-bolt flange - unit dimensions

Shaft diameter		RHP designation	Basic bearing insert	Housing group	Dimensions (mm)		
mm	inches				L	H	J
20		PSFT20CR PSFT $\frac{3}{4}$ CR	J1020 J1020	2 2	64.1	113.3	90.0
	$\frac{3}{4}$				64.1	113.3	90.0
25		PSFT25CR PSFT1CR	J1025 J1025	3 3	68.4	130.3	99.0
	1				68.4	130.3	99.0
30		PSFT30CR PSFT $1\frac{3}{16}$ CR PSFT $1\frac{1}{4}$ RCR	J1030 J1030 J1030	4 4 4	80.1	148.3	117.0
	$1\frac{3}{16}$				80.1	148.3	117.0
	$1\frac{1}{4}$				80.1	148.3	117.0
35		PSFT35CR PSFT $1\frac{1}{4}$ CR PSFT $1\frac{7}{16}$ CR	J1035 J1035 J1035	5 5 5	90.1	163.3	130.0
	$1\frac{1}{4}$				90.1	163.3	130.0
	$1\frac{7}{16}$				90.1	163.3	130.0
40		PSFT40CR PSFT $1\frac{1}{2}$ CR	J1040 J1040	6 6	100.1	175.3	144.0
	$1\frac{1}{2}$				100.1	175.3	144.0

All dimensions in mm except inch shaft sizes

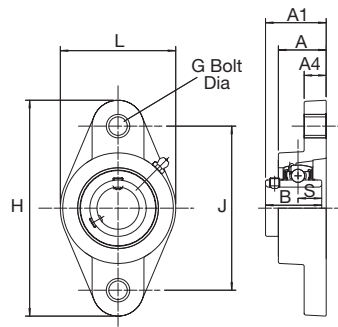

PSFT SERIES

	Dimensions (mm)						Weight
	G	A	A1	A4	B	S	kg
M10	26.5	26.5	33.7	11.4	31.0	12.7	0.24
M10	26.5	26.5	33.7	11.4	31.0	12.7	0.24
M10	29.1	29.1	36.7	13.4	34.0	14.3	0.30
M10	29.1	29.1	36.7	13.4	34.0	14.3	0.30
M10	30.5	30.5	41.2	13.4	38.1	15.9	0.44
M10	30.5	30.5	41.2	13.4	38.1	15.9	0.44
M10	30.5	30.5	41.2	13.4	38.1	15.9	0.44
M12	32.8	32.8	43.4	16.1	42.9	17.5	0.64
M12	32.8	32.8	43.4	16.1	42.9	17.5	0.64
M12	32.8	32.8	43.4	16.1	42.9	17.5	0.64
M12	37.5	37.5	51.7	20.0	49.2	19.0	0.89
M12	37.5	37.5	51.7	20.0	49.2	19.0	0.89

Unit dimensions

Table 11
PST Silver-Lube® take up units - unit dimensions

Shaft diameter		RHP designation	Basic bearing insert	Housing group	Dimensions (mm)				
mm	inches				L	L1	L4	H	H1
20		PST20CR	J1020	2	99.0	64.0	47.0	88.0	35.0
	$\frac{3}{4}$	PST $\frac{3}{4}$ CR	J1020	2	99.0	64.0	47.0	88.0	35.0
25		PST25CR	J1025	3	99.0	64.0	47.0	88.0	35.0
	1	PST1CR	J1025	3	99.0	64.0	47.0	88.0	35.0
30		PST30CR	J1030	4	125.0	76.0	63.0	102.0	40.0
	$1\frac{3}{16}$	PST $1\frac{3}{16}$ CR	J1030	4	125.0	76.0	63.0	102.0	40.0
	$1\frac{1}{4}$	PST $1\frac{1}{4}$ RCR	J1030	4	125.0	76.0	63.0	102.0	40.0
35		PST35CR	J1035	5	125.0	76.0	63.0	102.0	40.0
	$1\frac{1}{4}$	PST $1\frac{1}{4}$ CR	J1035	5	125.0	76.0	63.0	102.0	40.0
	$1\frac{7}{16}$	PST $1\frac{7}{16}$ CR	J1035	5	125.0	76.0	63.0	102.0	40.0
40		PST40CR	J1040	6	140.0	85.0	80.0	114.0	40.0
	$1\frac{1}{2}$	PST $1\frac{1}{2}$ CR	J1040	6	140.0	85.0	80.0	114.0	40.0

All dimensions in mm except inch shaft sizes

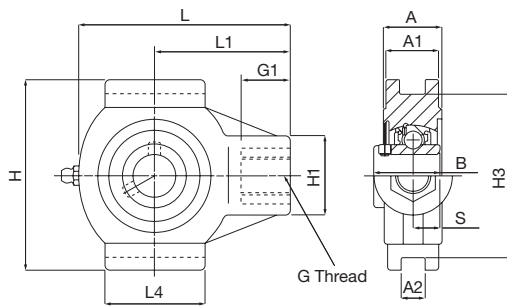

PST SERIES

	Dimensions (mm)								Weight
	H3	G	G1	A	A1	A2	B	S	kg
	75.8	M16X2.00	22.5	27.5	24.5	12.2	31.0	12.7	0.32
	75.8	M16X2.00	22.5	27.5	24.5	12.2	31.0	12.7	0.32
	75.8	M16X2.00	22.5	27.5	24.5	12.2	34.0	14.3	0.36
	75.8	M16X2.00	22.5	27.5	24.5	12.2	34.0	14.3	0.36
	88.8	M16X2.00	22.5	34.5	30.0	12.2	38.1	15.9	0.53
	88.8	M16X2.00	22.5	34.5	30.0	12.2	38.1	15.9	0.53
	88.8	M16X2.00	22.5	34.5	30.0	12.2	38.1	15.9	0.53
	88.8	M16X2.00	22.5	34.5	30.0	12.2	42.9	17.5	0.74
	88.8	M16X2.00	22.5	34.5	30.0	12.2	42.9	17.5	0.74
	88.8	M16X2.00	22.5	34.5	30.0	12.2	42.9	17.5	0.74
	101.8	M16X2.00	22.5	34.0	32.0	16.2	49.2	19.0	1.00
	101.8	M16X2.00	22.5	34.0	32.0	16.2	49.2	19.0	1.00