

ROLLWAY

EXTRA CAPACITY METRIC CYLINDRICAL ROLLER BEARINGS

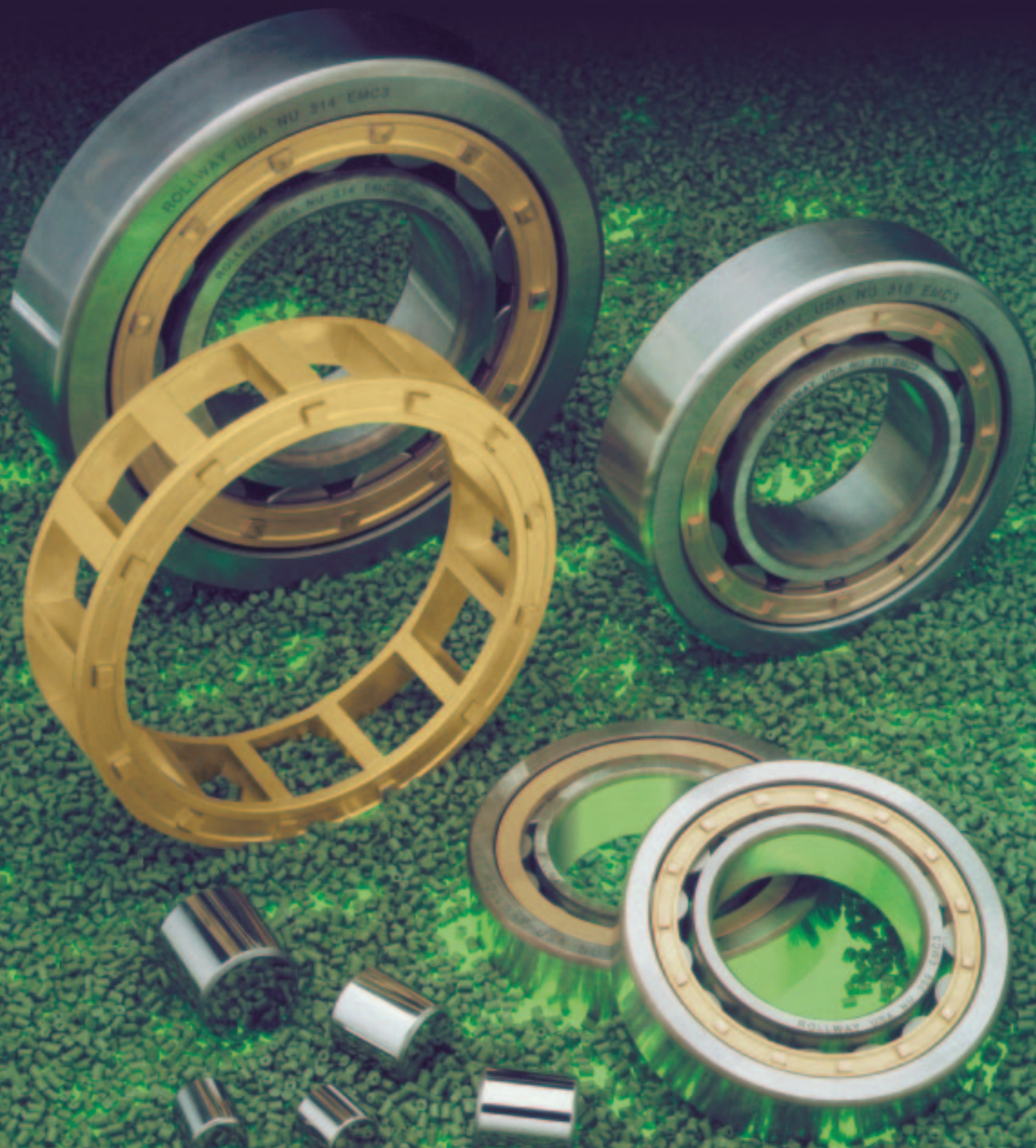

EXTRA CAPACITY METRIC CYLINDRICAL ROLLER BEARINGS

**New, heavy-duty American-made bearings:
Rugged and ready to go.**

Since 1908, the name Rollway has meant precision and quality in heavy-duty cylindrical roller bearings. Now, the release of our new, American-made Extra Capacity Metric Cylindrical Roller Bearings clearly extends our tradition.

Users of various internationally manufactured equipment no longer have to search overseas for these metric replacement bearings. Rollway makes the precise bearings you need right here in the U.S.A. Plus, our nationwide distribution network can get them to you fast, whenever and wherever you need them.

Design specifications and features

Rollway's Extra Capacity Metric Cylindrical Roller Bearings are made to RBEC-1 (PO) tolerances and may be special ordered to RBEC-3 (P6) or RBEC-5 (P5). Bearings are available in 200 and 300 series with NU and NJ configurations. N and NUP configurations may be special ordered.

Materials

All rings and rollers are made from through hardened bearing quality steel, which is heat treated to assure stabilization of parts and retention of metallurgical integrity at operating temperatures.

Cages are made from centrifugally cast brass and machined to ensure close running control.

Load ratings

Static and dynamic capacities are calculated in accordance with ABMA standard #11.

Limiting speeds

Limiting speeds are based on normal loads and applications, and may vary depending on environment, lubrication and load profile.

For more information about our new Extra Capacity Metric Cylindrical Roller Bearings, contact Rollway's Engineering Department. Our experts are always ready to assist you with bearing applications.

Basic numbering system

NU, NJ refers to the configuration
E - extra capacity
M - machined brass cage
C3 - clearance

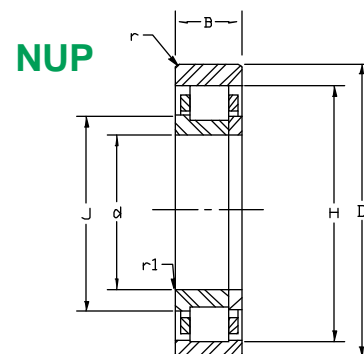
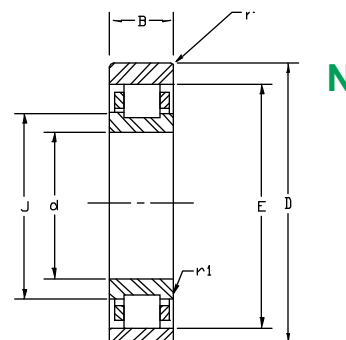
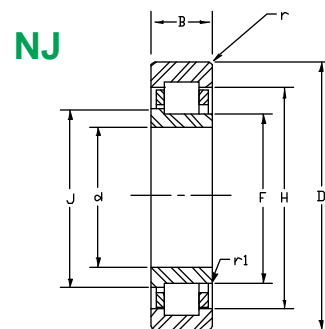
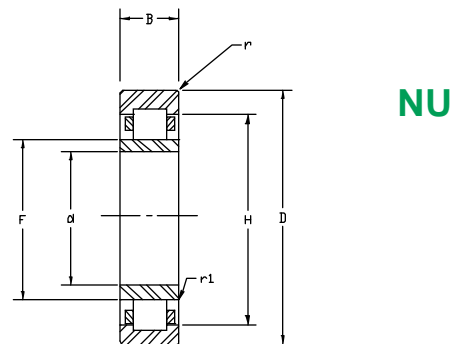

200 SERIES

Basic Size	d		D		B		r		r ₁	F	E	J	H	Dynamic Load Rating	Static Load Rating	Dynamic Load Rating	Static Load Rating	Limiting Speed in RPM					
	Bore Diameter		Outside Diameter		Width		Housing Fillet Radius		Shaft Fillet Radius	Inner Track	Outer Track	Inner Flange	Outer Flange					daN	daN	Pounds	Pounds	Oil	Grease
	mm	Inches	mm	Inches	mm	Inches	mm	Inches	mm	mm	mm	mm	mm					daN	daN	Pounds	Pounds	Oil	Grease
209E	45	1.7716	85	3.3464	19	0.7480	1.0	0.039	1.0	54.50	76.50	59.10	72.10	6300	6700	14200	15100	8300	6800				
210E	50	1.9685	90	3.5433	20	0.7874	1.0	0.039	1.0	59.50	81.50	64.10	77.10	6600	7200	14800	16300	7700	6400				
211E	55	2.1653	100	3.9370	21	0.8268	1.5	0.059	1.5	66.00	90.00	70.95	85.20	8600	9900	19400	22400	7000	5700				
212E	60	2.3622	110	4.3307	22	0.8661	1.5	0.059	1.5	72.00	100.00	77.70	94.40	9600	10600	21700	23900	6300	5200				
213E	65	2.5590	120	4.7244	23	0.9055	1.5	0.059	1.5	78.50	108.50	84.55	102.50	11000	12300	24700	27700	5800	4700				
214E	70	2.7559	125	4.9212	24	0.9449	1.5	0.059	1.5	83.50	113.50	89.55	107.50	12100	14200	27300	31900	5500	4500				
215E	75	2.9527	130	5.1181	25	0.9842	1.5	0.059	1.5	88.50	118.50	94.50	112.50	13300	16200	29800	36300	5300	4300				
216E	80	3.1496	140	5.5118	26	1.0236	2.0	0.079	2.0	95.30	127.30	101.65	120.90	14200	17300	31900	38800	4900	4000				
217E	85	3.3464	150	5.9055	28	1.1024	2.0	0.079	2.0	100.50	136.50	107.60	129.30	16900	20300	37900	45500	4600	3800				
218E	90	3.5433	160	6.2992	30	1.1811	2.0	0.079	2.0	107.00	145.00	114.45	137.40	18700	22600	41900	50900	4300	3600				
219E	95	3.7401	170	6.6929	32	1.2598	2.0	0.079	2.0	112.50	154.50	120.65	146.10	21400	25600	48100	57600	4100	3400				
220E	100	3.9370	180	7.0866	34	1.3386	2.0	0.079	2.0	119.00	163.00	127.50	154.20	25300	31300	56800	70500	3900	3200				
221E	105	4.1339	190	7.4803	36	1.4173	2.0	0.079	2.0	125.50	171.50	134.70	162.50	26500	32800	59600	73700	3700	3000				
222E	110	4.3307	200	7.8740	38	1.4961	2.0	0.079	2.0	132.50	180.50	141.75	170.40	29600	37400	66600	84000	3400	2900				
224E	120	4.7244	215	8.4645	40	1.5748	2.0	0.079	2.0	143.50	195.50	153.45	185.10	34300	43800	77200	98500	3200	2600				

300 SERIES

Basic Size	d		D		B		r		r ₁	F	E	J	H	Dynamic Load Rating	Static Load Rating	Dynamic Load Rating	Static Load Rating	Limiting Speed in RPM					
	Bore Diameter		Outside Diameter		Width		Housing Fillet Radius		Shaft Fillet Radius	Inner Track	Outer Track	Inner Flange	Outer Flange					daN	daN	Pounds	Pounds	Oil	Grease
	mm	Inches	mm	Inches	mm	Inches	mm	Inches	mm	mm	mm	mm	mm					daN	daN	Pounds	Pounds	Oil	Grease
307E	35	1.3779	80	3.1496	21	0.8268	1.0	0.039	1.5	46.20	70.20	51.15	65.40	6600	6700	15000	14800	9000	7500				
308E	40	1.5748	90	3.5433	23	0.9055	1.5	0.059	1.5	52.00	80.00	57.70	74.40	8200	8100	18500	18200	7500	6300				
309E	45	1.7716	100	3.9370	25	0.9842	1.5	0.059	1.5	58.50	88.50	64.55	82.50	9900	10200	22400	22900	6700	5600				
310E	50	1.9685	110	4.3307	27	1.0630	2.0	0.079	2.0	65.00	97.00	71.40	90.60	11200	11700	25300	26300	6000	5000				
311E	55	2.1653	120	4.7244	29	1.1417	2.0	0.079	2.0	70.50	106.50	77.65	99.30	13900	14500	31100	32700	5600	4800				
312E	60	2.3622	130	5.1181	31	1.2205	2.0	0.079	2.0	77.00	115.00	84.50	107.40	15300	16400	34500	36700	5000	4300				
313E	65	2.5590	140	5.5118	33	1.2992	2.0	0.079	2.0	82.50	124.50	90.65	116.10	18300	19700	41200	44200	4800	4000				
314E	70	2.7559	150	5.9055	35	1.3779	2.0	0.079	2.0	89.00	133.00	97.50	124.20	20800	22800	46700	51200	4300	3600				
315E	75	2.9527	160	6.2992	37	1.4567	2.0	0.079	2.0	95.00	143.00	104.25	133.40	24300	26900	54700	60600	4000	3400				
316E	80	3.1496	170	6.6929	39	1.5354	2.0	0.079	2.0	101.00	151.00	110.60	141.00	26300	29300	59000	65900	3600	3000				
317E	85	3.3464	180	7.0866	41	1.6142	2.5	0.098	2.5	108.00	160.00	117.95	149.60	28200	31900	63500	71700	3400	2800				
318E	90	3.5433	190	7.4803	43	1.6929	2.5	0.098	2.5	113.50	169.50	124.20	158.30	32000	36200	71900	81500	3800	3200				
319E	95	3.7401	200	7.8740	45	1.7716	2.5	0.098	2.5	121.50	177.50	132.20	166.30	33800	39500	76100	88900	3600	3000				
320E	100	3.9370	215	8.4645	47	1.8504	2.5	0.098	2.5	127.50	191.50	139.60	178.70	38900	44200	87500	99400	3400	2800				
321E	105	4.1339	225	8.8583	49	1.9291	2.5	0.098	2.5	135.00	195.00	147.00	182.20	43700	49900	98100	112200	3300	2700				
322E	110	4.3307	240	9.4488	50	1.9685	2.5	0.098	2.5	143.00	211.00	155.85	197.40	43700	50700	98300	113900	3100	2500				
324E	120	4.7244	260	10.232	55	2.1653	2.5	0.098	2.5	154.00	230.00	168.65	214.80	53500	62600	120400	140600	2800	2300				

STANDARD RBECTOLERANCES- INNER RING

(Tolerances in .001 in., .001 mm)

Bearing Bore		Outside Diameter + .0000" + .000 mm To			Width Variation		
over	incl.	1	3	5	1	3	5
		in. mm	in. mm	in. mm	in. mm	in. mm	in. mm
30	50	-4.5 -12	-4 -10	-3 -8	-47 -120	-47 -120	-47 -120
50	80	-6 -15	-4.5 -12	-3.5 -9	-59 -150	-59 -150	-59 -150
80	120	-8 -20	-6 -15	-4 -10	-79 -200	-79 -200	-79 -200

STANDARD RBECTOLERANCES- OUTER RING

(Tolerances in .001 in., .001 mm)

Bearing Outside Diameter		Outside Diameter + .0000" + .000 mm To			Width Variation		
over	incl.	1	3	5	1	3	5
		in. mm	in. mm	in. mm	in. mm	in. mm	in. mm
80	120	-6 -18	-5 -13	-4 -10	-79 -200	-79 -200	-79 -200
120	150	-7 -18	-6 -15	-4.5 -11	-98 -250	-98 -250	-98 -250
150	180	-10 -25	-7 -18	-5 -13	-98 -250	-98 -250	-98 -250
180	250	-12 -30	-8 -20	-6 -15	-118 -300	-118 -300	-118 -300
250	315	-14 -35	-10 -25	-7 -18	-118 -350	-118 -350	-118 -350

Note: Maximum shaft or housing fillet radius which bearing corners will clear.

To order, or to obtain specific application information about these heavy-duty bearings, please contact your Rollway representative.



Rollway Bearing

Emerson Power Transmission Corp.

P.O. Box 4827, Syracuse, New York 13221

(315) 457-6211

Fax: (315) 451-8596 • Toll-Free: 1-800-448-2260