

EN 2584 Narrow Series MND (G)

[Menu](#)

[P/N X-Ref](#)

[Materials](#)

[Clearance/Torque](#)

[Staking Groove](#)

[Limits & Fits](#)

[Keyways](#)

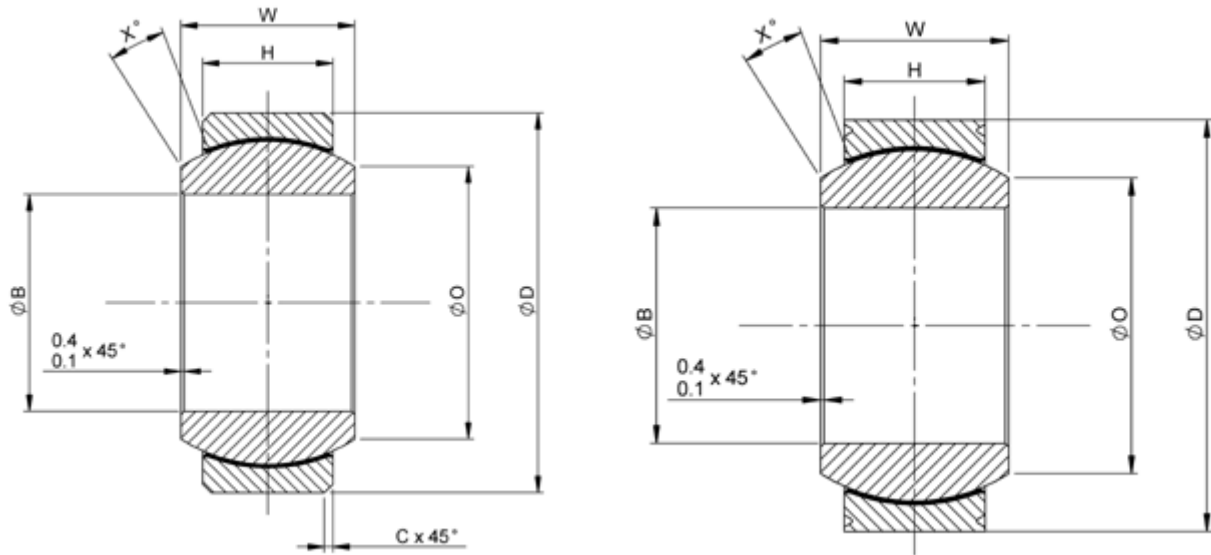

Bore code	B		D		H	W		O	C		X°	Ball dia nom	Max static load N		Dynamic radial load max 25000 cycles N	Weight g max
	max	min	max	min	+0.1 -0.1	+0 -0.06	min	max	min	max	Radial		Axial see note 1			
05	5.002	4.990	14.005	13.987	5.5	7.0	8.6				9	11.1	20500	1900	12300	7
06	6.002	5.990	16.005	15.987	6.5	9.0	9.0				14	12.8	29200	3500	17500	9
08	8.002	7.990	18.005	17.987	7.0	10.0	10.2				15	14.3	37000	3900	22200	12
10	10.002	9.990	21.006	20.985	8.0	10.5	11.9	0.8	0.5		11	15.9	47200	6500	28300	20
12	12.003	11.989	25.006	24.985	10.0	13.0	15.0				10	19.8	78100	11700	43000	32
15	15.003	14.989	29.006	28.985	12.0	15.0	20.5				8	25.4	121900	18000	67000	50
17	17.003	16.989	31.008	30.985	13.5	16.0	21.7				7	27.0	148300	24300	81000	59
22	22.003	21.987	40.008	39.981	18.0	22.0	27.1				8	34.9	268600	45500	147700	126
25	25.003	24.987	45.008	44.981	20.0	25.0	29.8	1.0	0.6		8	38.8	324700	55900	162400	185
30	30.003	29.987	51.010	50.977	24.0	28.0	35.5				6	45.2	433400	77800	216700	300
35	35.003	34.985	57.010	56.977	26.0	31.0	41.7				7	52.0	543400	92200	271700	340
40	40.003	39.985	64.010	63.977	29.0	34.0	47.0				6	56.0	680900	113400	340300	460
45	45.003	44.985	72.010	71.977	32.0	37.0	52.2	1.2	0.8		5	64.0	833900	135900	416900	630
50	50.003	49.985	80.013	49.972	34.0	41.0	59.2				7	72.0	981400	154200	490700	870

Dimensions in millimetres

Note 1- For bearings without staking grooves



Head Office

[UK](#)

[Germany](#)

Contact Details

[France](#)

[Italy](#)

[Singapore](#)

[USA](#)