

EN 2585 Wide Series Chamfered MWD (G)

Menu

P/N X-Ref

Materials

Clearance/Torque

Staking Groove

Limits & Fits

Keyway

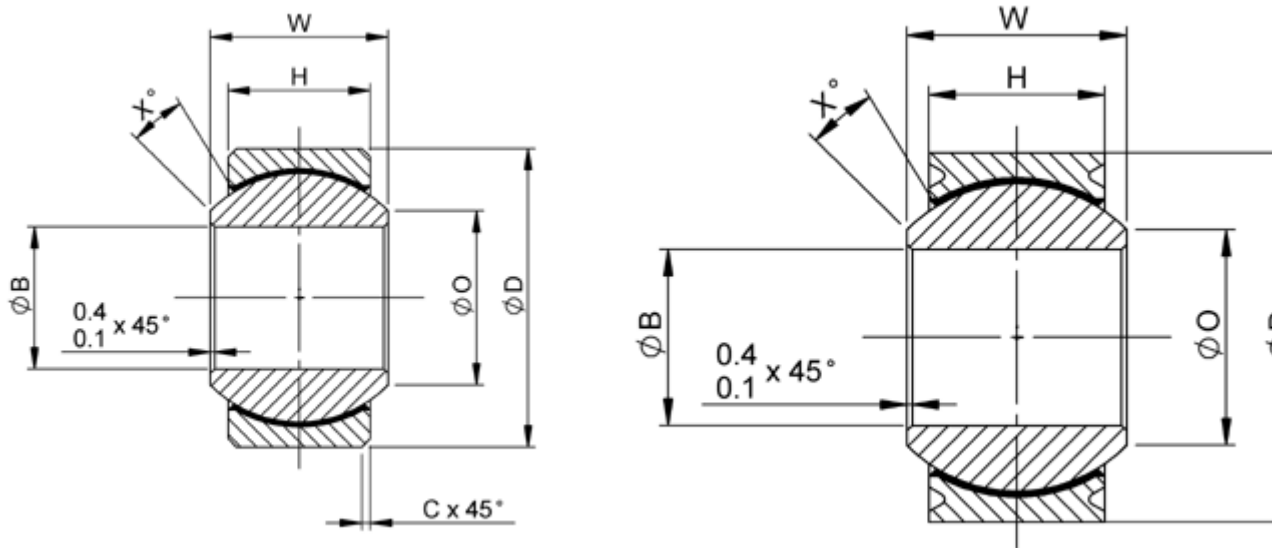

Bore code	B		D		H	W		O	C		X°	Ball dia nom	Max static load N		Dynamic radial load max 25000 cycles N	Weight g max
	max	min	max	min	+0.1 -0.1	+0 -0.06	min	max	min	max	Radial		Axial see note 1			
05	5.002	4.990	16.005	15.987	8.5	11.0	7.7				15	13.5	42600	7200	25600	16
06	6.002	5.990	16.005	15.987	8.5	11.0	7.7				15	13.5	42600	7200	25600	16
08	8.002	7.990	18.005	17.987	8.0	11.0	10.3				14	15.1	45700	6400	27400	17
10	10.002	9.990	21.006	20.985	10.0	12.5	12.2				10	17.5	68700	11700	41200	27
12	12.003	11.989	26.006	25.985	13.0	16.0	15.5				10	22.3	116400	21500	64000	49
15	15.003	14.989	29.006	28.985	13.5	17.0	18.9				9	25.5	139000	24100	76500	62
17	17.003	16.989	30.006	29.985	14.5	18.0	20.1				9	27.5	159100	29000	87500	69
20	20.003	19.987	35.008	34.981	16.0	20.0	23.5				8	31.8	207500	36000	113900	104
25	25.003	24.987	54.010	53.977	26.0	32.0	35.3				9	47.7	496600	93200	248300	445
30	30.003	29.987	60.010	59.977	28.0	34.0	40.9				8	53.2	587500	109600	293700	480
35	35.003	34.985	65.010	64.977	29.0	36.0	45.5				8	58.1	666000	117600	333000	565
40	40.003	39.985	68.010	67.977	31.0	38.0	47.0				8	60.5	745600	136600	372800	600
45	45.003	44.985	76.010	75.977	33.0	41.0	54.1				8	67.9	895900	155600	447900	800
50	50.003	49.985	82.013	81.972	35.0	44.0	60.3				8	74.7	1024700	176200	512300	970
55	55.003	54.985	96.013	95.972	40.0	52.0	63.4				10	82.0	1298700	221200	649300	1580

Dimensions in millimetres

Note 1 - For bearings without staking grooves

Chamfer C applies to MWD-- series only



Head Office

UK

Germany

Contact Details

France

Italy

Singapore

USA