

Models ST / ST-B

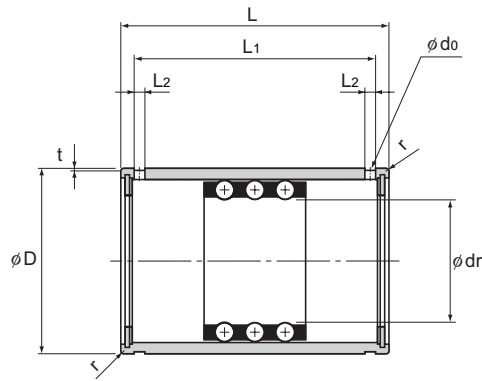

Model ST
(For light load)

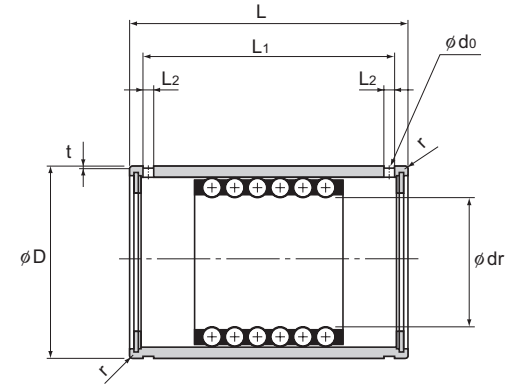

Model ST-B
(For medium load)

Unit: mm

Model No.	Maximum stroke											Basic dynamic load rating C kN	Basic static load rating C ₀ kN	Mass g	
		Inscribed bore diameter		Outer diameter		Length		L ₁	L ₂	t	d ₀				r
		dr	Tolerance	D	Tolerance	L	Tolerance								
ST 6	14	6	+0.018 +0.010	12	0 -0.008	19	0 -0.2	13.5	1.1	0.25	—	0.3	0.98	0.23	8
ST 8 ST 8B	24 8	8	+0.022 +0.013	15		24		20.1	1.5	0.5	1.5	0.5	0.98 2.06	0.27 0.55	16.4 17.6
ST 10 ST 10B	30 8	10		19	30	25.7		1.5	0.5	1.5	0.5	2.35 4.61	0.62 1.27	31.5 34.5	
ST 12 ST 12B	32 8	12		23	32	27.5		1.5	0.5	1.5	0.5	4.02 8.14	1.08 2.25	47 53.5	
ST 16 ST 16B	40 16	16	28	37	32.1	1.5		0.5	1.5	0.5	4.02 8.04	1.27 2.65	77 85		
ST 20 ST 20B	54 28	20	32	45	39.8	2		0.5	2	0.5	4.12 8.33	1.57 3.24	109 120		
ST 25 ST 25B	54 28	25	+0.033 +0.020	37	0 -0.011	45	0 -0.3	39.8	2	0.5	2	1	4.12 8.14	1.76 3.63	128 142
ST 30 ST 30B	82 44	30		45		65		58.5	2.5	0.5	2.5	1	9.31 18.7	4.12 8.14	240 275
ST 35 ST 35B	92 54	35		52	70	63.5		2.5	0.7	2.5	1.5	9.41 18.7	4.51 9.02	370 410	

LM Stroke

Models ST / ST-B

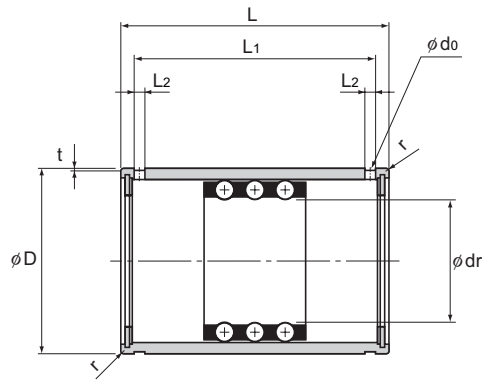

Model ST
(For light load)

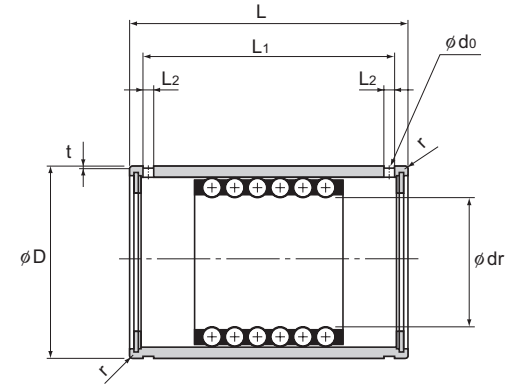

Model ST-B
(For medium load)

Unit: mm

Model No.	Maximum stroke											Basic dynamic load rating C kN	Basic static load rating C ₀ kN	Mass g	
		Inscribed bore diameter		Outer diameter		Length		L ₁	L ₂	t	d ₀				r
		dr	Tolerance	D	Tolerance	L	Tolerance								
ST 40 ST 40B	108 66	40	+0.041 +0.025	60	0 -0.013	80	0 -0.3	73.3	2.5	0.7	2.5	1.5	12.5 25	6.18 12.4	570 635
ST 45 ST 45B	108 66	45		65		80		73.3	2.5	0.7	2.5	1.5	12.6 25.2	6.76 13.5	625 695
ST 50 ST 50B	138 88	50		72		100		92.4	3	1	3	1.5	16.3 32.5	8.82 17.7	910 1020
ST 55 ST 55B	138 88	55		80		100		92.4	3	1	3	2	16.6 33	9.71 19.3	1270 1380
ST 60 ST 60B	138 88	60	+0.049 +0.030	85	0 -0.015	100	0 -0.4	92.4	3	1	3	2	16.8 33.6	10.5 21	1360 1480
ST 70 ST 70B	138 88	70		95		100		92.4	3	1	3	2	16.9 33.8	11.7 23.3	1530 1670
ST 80 ST 80B	132 76	80		110		100		92	3	1.5	3	2	21.3 42.5	15.3 30.6	2220 2430
ST 90 ST 90B	132 76	90	+0.058 +0.036	120	0 -0.018	100	0 -0.4	92	3	1.5	3	2	21.7 43.3	16.9 33.7	2440 2670
ST 100 ST 100B	132 76	100		130		100		92	3	1.5	3	2	22 43.9	18.3 36.8	2670 2910

LM Stroke