

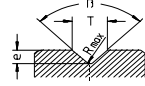

# Examples of wire guides and straightening rollers - Profile A

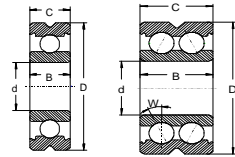

Profile A

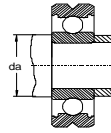

## Cages and shields

- Available
- Feasible (minimum quantity)
- Out of program

## Profile codes and specialities. (page 93)

- A : " V " notch
- L : Ring(s) and/or balls with wear resisting coating
- M : Different ring widths
- T : Two rows of balls

Dimensions d D B C	Designation	Angle of contact W	Profile specifications			Limiting speeds			Basic load ratings		Abutment dimensions da min	Mass ~ gr	Designation	Cage Y Shields						Cage J Shields						Cage T9H Shields						Cage TBH Shields																				
			T	e	R max	β	Oil	Grease	Contact seals	Dyn. Cr				Stat. Cor	Open	Z	ZZ	RSR	2RSR	RSF	2RSF	RSV	2RSV	Open	Z	ZZ	RSR	2RSR	RSF	2RSF	RSV	2RSV	Open	Z	ZZ	RSR	2RSR	RSF	2RSF	RSV	2RSV											
5	13 9 8	AT5M05	-	1.5	0.71	0.1	90	45	38	24	2.010	0.970	6.6	6.5	AT5M05	Open	Z	ZZ	RSR	2RSR	RSF	2RSF	RSV	2RSV	Open	Z	ZZ	RSR	2RSR	RSF	2RSF	RSV	2RSV	Open	Z	ZZ	RSR	2RSR	RSF	2RSF	RSV	2RSV	Open	Z	ZZ	RSR	2RSR	RSF	2RSF	RSV	2RSV	
	16 5 5	A500	-	2	0.56	0.1	120	43	36	22	1.880	0.681	7.0	4.6	A500	*	Open	Z	ZZ	RSR	2RSR	RSF	2RSF	RSV	2RSV	Open	Z	ZZ	RSR	2RSR	RSF	2RSF	RSV	2RSV	Open	Z	ZZ	RSR	2RSR	RSF	2RSF	RSV	2RSV	Open	Z	ZZ	RSR	2RSR	RSF	2RSF	RSV	2RSV
	16 5 5	A501	-	1	0.46	0.1	90	43	36	22	1.880	0.681	7.0	4.8	A501	*	Open	Z	ZZ	RSR	2RSR	RSF	2RSF	RSV	2RSV	Open	Z	ZZ	RSR	2RSR	RSF	2RSF	RSV	2RSV	Open	Z	ZZ	RSR	2RSR	RSF	2RSF	RSV	2RSV	Open	Z	ZZ	RSR	2RSR	RSF	2RSF	RSV	2RSV
	16 5 5	A506	-	1.47	0.65	0.2	90	43	36	22	1.880	0.681	7.0	5.54	A506	*	Open	Z	ZZ	RSR	2RSR	RSF	2RSF	RSV	2RSV	Open	Z	ZZ	RSR	2RSR	RSF	2RSF	RSV	2RSV	Open	Z	ZZ	RSR	2RSR	RSF	2RSF	RSV	2RSV	Open	Z	ZZ	RSR	2RSR	RSF	2RSF	RSV	2RSV
	16 5 5	A509	-	1.5	0.71	0.1	90	43	36	22	1.880	0.681	7.0	4.7	A509	*	Open	Z	ZZ	RSR	2RSR	RSF	2RSF	RSV	2RSV	Open	Z	ZZ	RSR	2RSR	RSF	2RSF	RSV	2RSV	Open	Z	ZZ	RSR	2RSR	RSF	2RSF	RSV	2RSV	Open	Z	ZZ	RSR	2RSR	RSF	2RSF	RSV	2RSV
	16 5 5	AL500	-	2.25	0.6	0.3	120	43	36	22	1.880	0.681	7.0	5.54	AL500	*	Open	Z	ZZ	RSR	2RSR	RSF	2RSF	RSV	2RSV	Open	Z	ZZ	RSR	2RSR	RSF	2RSF	RSV	2RSV	Open	Z	ZZ	RSR	2RSR	RSF	2RSF	RSV	2RSV	Open	Z	ZZ	RSR	2RSR	RSF	2RSF	RSV	2RSV
	16 5 5	AL501	-	1.39	0.55	0.75	60	43	36	22	1.880	0.681	7.0	4.9	AL501	*	Open	Z	ZZ	RSR	2RSR	RSF	2RSF	RSV	2RSV	Open	Z	ZZ	RSR	2RSR	RSF	2RSF	RSV	2RSV	Open	Z	ZZ	RSR	2RSR	RSF	2RSF	RSV	2RSV	Open	Z	ZZ	RSR	2RSR	RSF	2RSF	RSV	2RSV
	16 5 5	AL502	-	1.39	0.55	0.75	60	43	36	22	1.880	0.681	7.0	4.9	AL502	*	Open	Z	ZZ	RSR	2RSR	RSF	2RSF	RSV	2RSV	Open	Z	ZZ	RSR	2RSR	RSF	2RSF	RSV	2RSV	Open	Z	ZZ	RSR	2RSR	RSF	2RSF	RSV	2RSV	Open	Z	ZZ	RSR	2RSR	RSF	2RSF	RSV	2RSV
	16 5 5	AL503	-	1.39	0.55	0.75	60	43	36	22	1.880	0.681	7.0	4.9	AL503	*	Open	Z	ZZ	RSR	2RSR	RSF	2RSF	RSV	2RSV	Open	Z	ZZ	RSR	2RSR	RSF	2RSF	RSV	2RSV	Open	Z	ZZ	RSR	2RSR	RSF	2RSF	RSV	2RSV	Open	Z	ZZ	RSR	2RSR	RSF	2RSF	RSV	2RSV
	16 10 10	AT500	-	1.8	0.86	0.1	90	43	36	22	2.830	1.370	7.0	9.4	AT500	*	Open	Z	ZZ	RSR	2RSR	RSF	2RSF	RSV	2RSV	Open	Z	ZZ	RSR	2RSR	RSF	2RSF	RSV	2RSV	Open	Z	ZZ	RSR	2RSR	RSF	2RSF	RSV	2RSV	Open	Z	ZZ	RSR	2RSR	RSF	2RSF	RSV	2RSV
	16 17 16	AT5M00	-	1	0.46	0.1	90	43	36	22	2.830	1.370	7.0	14.7	AT5M00	*	Open	Z	ZZ	RSR	2RSR	RSF	2RSF	RSV	2RSV	Open	Z	ZZ	RSR	2RSR	RSF	2RSF	RSV	2RSV	Open	Z	ZZ	RSR	2RSR	RSF	2RSF	RSV	2RSV	Open	Z	ZZ	RSR	2RSR	RSF	2RSF	RSV	2RSV
	16 17 16	AT5M01	-	2.08	1	0.1	90	43	36	22	2.830	1.370	7.0	13.7	AT5M01	*	Open	Z	ZZ	RSR	2RSR	RSF	2RSF	RSV	2RSV	Open	Z	ZZ	RSR	2RSR	RSF	2RSF	RSV	2RSV	Open	Z	ZZ	RSR	2RSR	RSF	2RSF	RSV	2RSV	Open	Z	ZZ	RSR	2RSR	RSF	2RSF	RSV	2RSV
	16 17 16	AT5M04	-	1.8	0.86	0.1	90	43	36	22	2.830	1.370	7.0	13.7	AT5M04	*	Open	Z	ZZ	RSR	2RSR	RSF	2RSF	RSV	2RSV	Open	Z	ZZ	RSR	2RSR	RSF	2RSF	RSV	2RSV	Open	Z	ZZ	RSR	2RSR	RSF	2RSF	RSV	2RSV	Open	Z	ZZ	RSR	2RSR	RSF	2RSF	RSV	2RSV
	17 6 6	A508	-	1	0.46	0.1	90	41	33	22	1.480	0.618	6.5	6.4	A508	Open	Z	ZZ	RSR	2RSR	RSF	2RSF	RSV	2RSV	Open	Z	ZZ	RSR	2RSR	RSF	2RSF	RSV	2RSV	Open	Z	ZZ	RSR	2RSR	RSF	2RSF	RSV	2RSV	Open	Z	ZZ	RSR	2RSR	RSF	2RSF	RSV	2RSV	
	17 8 7.5	AT5M02	20	5.3	1.5	-	100	45	38	24	2.060	0.941	6.6	8.4	AT5M02	Open	Z	ZZ	RSR	2RSR	RSF	2RSF	RSV	2RSV	Open	Z	ZZ	RSR	2RSR	RSF	2RSF	RSV	2RSV	Open	Z	ZZ	RSR	2RSR	RSF	2RSF	RSV	2RSV	Open	Z	ZZ	RSR	2RSR	RSF	2RSF	RSV	2RSV	
	17 8 7.5	AT5M03	20	4.43	1.44	0.5	110	45	38	24	2.060	0.941	6.6	8.4	AT5M03	Open	Z	ZZ	RSR	2RSR	RSF	2RSF	RSV	2RSV	Open	Z	ZZ	RSR	2RSR	RSF	2RSF	RSV	2RSV	Open	Z	ZZ	RSR	2RSR	RSF	2RSF	RSV	2RSV	Open	Z	ZZ	RSR	2RSR	RSF	2RSF	RSV	2RSV	
	19 6 6	A502	-	1	0.46	0.1	90	38	32	22	2.460	1.050	7.0	8.8	A502	Open	Z	ZZ	RSR	2RSR	RSF	2RSF	RSV	2RSV	Open	Z	ZZ	RSR	2RSR	RSF	2RSF	RSV	2RSV	Open	Z	ZZ	RSR	2RSR	RSF	2RSF	RSV	2RSV	Open	Z	ZZ	RSR	2RSR	RSF	2RSF	RSV	2RSV	
	19 6 6	A510	-	2	0.56	0.1	120	38	32	22	2.460	1.050	7.0	8.6	A510	Open	Z	ZZ	RSR	2RSR	RSF	2RSF	RSV	2RSV	Open	Z	ZZ	RSR	2RSR	RSF	2RSF	RSV	2RSV	Open	Z	ZZ	RSR	2RSR	RSF	2RSF	RSV	2RSV	Open	Z	ZZ	RSR	2RSR	RSF	2RSF	RSV	2RSV	
	19 6 6	A511	-	1.5	0.71	0.1	90	38	32	22	2.460	1.050	7.0	8.4	A511	Open	Z	ZZ	RSR	2RSR	RSF	2RSF	RSV	2RSV	Open	Z	ZZ	RSR	2RSR	RSF	2RSF	RSV	2RSV	Open	Z	ZZ	RSR	2RSR	RSF	2RSF	RSV	2RSV	Open	Z	ZZ	RSR	2RSR	RSF	2RSF	RSV	2RSV	
	21 6 6	A507	-	2.34	0.965	0.5	90	38	32	22	2.460	1.050	7.0	11	A507	Open	Z	ZZ	RSR	2RSR	RSF	2RSF	RSV	2RSV	Open	Z	ZZ	RSR	2RSR	RSF	2RSF	RSV	2RSV	Open	Z	ZZ	RSR	2RSR	RSF	2RSF	RSV	2RSV	Open	Z	ZZ	RSR	2RSR	RSF	2RSF	RSV	2RSV	

\* Version available with TNH cage

# Examples of wire guides and straightening rollers - Profile A

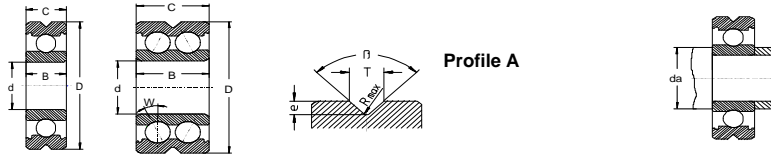

## Cages and shields

- Available
- Feasible (minimum quantity)
- Out of program

## Profile codes and specialties. (page 93)

- A : " V " notch
- M : Different ring widths
- T : Two rows of balls

Dimensions d D B C	Designation	Angle of contact		Profile specifications			Limiting speeds			Basic load ratings		Abutment dimensions da min	Mass ~ gr	Designation	Cage Y Shields						Cage J Shields						Cage T9H Shields						Cage TBH Shields																	
		W	T	e	R max	β	Oil	Grease	Contact seals	Dyn. Cr	Stat. Cor				Open	Z	ZZ	RSR	2RSF	RSF	2RSF	RSV	2RSV	Open	Z	ZZ	RSR	2RSF	RSF	2RSF	RSV	2RSV	Open	Z	ZZ	RSR	2RSF	RSF	2RSF	RSV	2RSV									
<b>5.5</b> 16 17 16	<b>AT5,5M00</b> <i>double row</i>	-	2.08	1	0.1	90	43	36	22	2.830	1.370	7.3	13.1	<b>AT5,5M00</b>	Open	Z	ZZ	RSR	2RSF	RSF	2RSF	RSV	2RSV	Open	Z	ZZ	RSR	2RSF	RSF	2RSF	RSV	2RSV	Open	Z	ZZ	RSR	2RSF	RSF	2RSF	RSV	2RSV	Open	Z	ZZ	RSR	2RSF	RSF	2RSF	RSV	2RSV
16.5 17 16	<b>AT5,5M01</b> <i>double row</i>	-	2.48	1.2	0.1	90	43	36	22	2.830	1.370	7.3	13.1	<b>AT5,5M01</b>																																				
<b>6</b> 19 6 6	<b>A600</b>	-	1	0.46	0.1	90	38	32	22	2.460	1.050	8.0	8.2	<b>A600</b>	Open	Z	ZZ	RSR	2RSF	RSF	2RSF	RSV	2RSV	Open	Z	ZZ	RSR	2RSF	RSF	2RSF	RSV	2RSV	Open	Z	ZZ	RSR	2RSF	RSF	2RSF	RSV	2RSV	Open	Z	ZZ	RSR	2RSF	RSF	2RSF	RSV	2RSV
19 6 6	<b>A601</b>	-	2	0.56	0.1	120	38	32	22	2.460	1.050	8.0	8	<b>A601</b>	Open	Z	ZZ	RSR	2RSF	RSF	2RSF	RSV	2RSV	Open	Z	ZZ	RSR	2RSF	RSF	2RSF	RSV	2RSV	Open	Z	ZZ	RSR	2RSF	RSF	2RSF	RSV	2RSV	Open	Z	ZZ	RSR	2RSF	RSF	2RSF	RSV	2RSV
20 10 10	<b>A602</b>	-	4.38	1.235	0.2	120	38	32	22	2.460	1.050	8.0	15	<b>A602</b>	Open	Z	ZZ	RSR	2RSF	RSF	2RSF	RSV	2RSV	Open	Z	ZZ	RSR	2RSF	RSF	2RSF	RSV	2RSV	Open	Z	ZZ	RSR	2RSF	RSF	2RSF	RSV	2RSV	Open	Z	ZZ	RSR	2RSF	RSF	2RSF	RSV	2RSV
21 6 6	<b>A603</b>	-	2.34	1.045	0.5	90	38	32	22	2.460	1.050	8.0	10.5	<b>A603</b>	Open	Z	ZZ	RSR	2RSF	RSF	2RSF	RSV	2RSV	Open	Z	ZZ	RSR	2RSF	RSF	2RSF	RSV	2RSV	Open	Z	ZZ	RSR	2RSF	RSF	2RSF	RSV	2RSV	Open	Z	ZZ	RSR	2RSF	RSF	2RSF	RSV	2RSV
<b>7</b> 22 7 7	<b>A702</b>	-	2.6	0.7	0.3	120	36	30	20	3.280	1.360	9.0	12.8	<b>A702</b>	Open	Z	ZZ	RSR	2RSF	RSF	2RSF	RSV	2RSV	Open	Z	ZZ	RSR	2RSF	RSF	2RSF	RSV	2RSV	Open	Z	ZZ	RSR	2RSF	RSF	2RSF	RSV	2RSV	Open	Z	ZZ	RSR	2RSF	RSF	2RSF	RSV	2RSV
22 7 7	<b>A703</b>	-	1.6	0.7	0.3	90	36	30	20	3.280	1.360	9.0	12.8	<b>A703</b>	Open	Z	ZZ	RSR	2RSF	RSF	2RSF	RSV	2RSV	Open	Z	ZZ	RSR	2RSF	RSF	2RSF	RSV	2RSV	Open	Z	ZZ	RSR	2RSF	RSF	2RSF	RSV	2RSV	Open	Z	ZZ	RSR	2RSF	RSF	2RSF	RSV	2RSV
22 7 7	<b>A704</b>	-	1.5	0.7	0.15	90	36	30	20	3.280	1.360	9.0	12.8	<b>A704</b>	Open	Z	ZZ	RSR	2RSF	RSF	2RSF	RSV	2RSV	Open	Z	ZZ	RSR	2RSF	RSF	2RSF	RSV	2RSV	Open	Z	ZZ	RSR	2RSF	RSF	2RSF	RSV	2RSV	Open	Z	ZZ	RSR	2RSF	RSF	2RSF	RSV	2RSV
26 7 7	<b>A705</b>	-	3.33	1.5	0.5	90	36	30	20	3.280	1.360	9.0	12.8	<b>A705</b>	Open	Z	ZZ	RSR	2RSF	RSF	2RSF	RSV	2RSV	Open	Z	ZZ	RSR	2RSF	RSF	2RSF	RSV	2RSV	Open	Z	ZZ	RSR	2RSF	RSF	2RSF	RSV	2RSV	Open	Z	ZZ	RSR	2RSF	RSF	2RSF	RSV	2RSV
<b>8</b> 19 6 6	<b>A800</b>	-	1.65	0.8	0.1	90	38	32	22	2.460	1.050	10.0	6.8	<b>A800</b>	Open	Z	ZZ	RSR	2RSF	RSF	2RSF	RSV	2RSV	Open	Z	ZZ	RSR	2RSF	RSF	2RSF	RSV	2RSV	Open	Z	ZZ	RSR	2RSF	RSF	2RSF	RSV	2RSV	Open	Z	ZZ	RSR	2RSF	RSF	2RSF	RSV	2RSV
22 7 7	<b>A801</b>	-	1.5	0.7	0.12	90	36	30	20	3.280	1.360	10.0	12	<b>A801</b>	Open	Z	ZZ	RSR	2RSF	RSF	2RSF	RSV	2RSV	Open	Z	ZZ	RSR	2RSF	RSF	2RSF	RSV	2RSV	Open	Z	ZZ	RSR	2RSF	RSF	2RSF	RSV	2RSV	Open	Z	ZZ	RSR	2RSF	RSF	2RSF	RSV	2RSV
22 7 7	<b>A802</b>	-	0.93	0.42	0.2	90	36	30	20	3.280	1.360	10.0	10.7	<b>A802</b>	Open	Z	ZZ	RSR	2RSF	RSF	2RSF	RSV	2RSV	Open	Z	ZZ	RSR	2RSF	RSF	2RSF	RSV	2RSV	Open	Z	ZZ	RSR	2RSF	RSF	2RSF	RSV	2RSV	Open	Z	ZZ	RSR	2RSF	RSF	2RSF	RSV	2RSV
22 7 7	<b>A803</b>	-	2.5	0.705	0.1	120	36	30	20	3.280	1.360	10.0	12	<b>A803</b>	Open	Z	ZZ	RSR	2RSF	RSF	2RSF	RSV	2RSV	Open	Z	ZZ	RSR	2RSF	RSF	2RSF	RSV	2RSV	Open	Z	ZZ	RSR	2RSF	RSF	2RSF	RSV	2RSV	Open	Z	ZZ	RSR	2RSF	RSF	2RSF	RSV	2RSV
22 7 7	<b>A808</b>	-	1.7	0.81	0.1	90	36	30	20	3.280	1.360	10.0	12	<b>A808</b>	Open	Z	ZZ	RSR	2RSF	RSF	2RSF	RSV	2RSV	Open	Z	ZZ	RSR	2RSF	RSF	2RSF	RSV	2RSV	Open	Z	ZZ	RSR	2RSF	RSF	2RSF	RSV	2RSV	Open	Z	ZZ	RSR	2RSF	RSF	2RSF	RSV	2RSV
22 7 7	<b>A809</b>	-	2	0.9	0.2	90	36	30	20	3.280	1.360	10.0	12	<b>A809</b>	Open	Z	ZZ	RSR	2RSF	RSF	2RSF	RSV	2RSV	Open	Z	ZZ	RSR	2RSF	RSF	2RSF	RSV	2RSV	Open	Z	ZZ	RSR	2RSF	RSF	2RSF	RSV	2RSV	Open	Z	ZZ	RSR	2RSF	RSF	2RSF	RSV	2RSV
22 7 7	<b>A810</b>	-	1.5	0.71	0.1	90	36	30	20	3.280	1.360	10.0	12	<b>A810</b>	Open	Z	ZZ	RSR	2RSF	RSF	2RSF	RSV	2RSV	Open	Z	ZZ	RSR	2RSF	RSF	2RSF	RSV	2RSV	Open	Z	ZZ	RSR	2RSF	RSF	2RSF	RSV	2RSV	Open	Z	ZZ	RSR	2RSF	RSF	2RSF	RSV	2RSV
22 7.4 7	<b>A8M00</b>	-	1.97	0.9	0.2	90	38	32	22	2.460	1.050	10.0	13.4	<b>A8M00</b>	Open	Z	ZZ	RSR	2RSF	RSF	2RSF	RSV	2RSV	Open	Z	ZZ	RSR	2RSF	RSF	2RSF	RSV	2RSV	Open	Z	ZZ	RSR	2RSF	RSF	2RSF	RSV	2RSV	Open	Z	ZZ	RSR	2RSF	RSF	2RSF	RSV	2RSV
23 7 7	<b>A805</b>	-	1.7	0.73	0.3	90	36	30	20	3.280	1.360	10.0	13.5	<b>A805</b>	Open	Z	ZZ	RSR	2RSF	RSF	2RSF	RSV	2RSV	Open	Z	ZZ	RSR	2RSF	RSF	2RSF	RSV	2RSV	Open	Z	ZZ	RSR	2RSF	RSF	2RSF	RSV	2RSV	Open	Z	ZZ	RSR	2RSF	RSF	2RSF	RSV	2RSV
26 7 7	<b>A806</b>	-	3.34	1.545	0.5	90	36	30	20	3.280	1.360	10.0	19.2	<b>A806</b>	Open	Z	ZZ	RSR	2RSF	RSF	2RSF	RSV	2RSV	Open	Z	ZZ	RSR	2RSF	RSF	2RSF	RSV	2RSV	Open	Z	ZZ	RSR	2RSF	RSF	2RSF	RSV	2RSV	Open	Z	ZZ	RSR	2RSF	RSF	2RSF	RSV	2RSV

\* Version available with TNH cage

Examples of wire guides and straightening rollers - Profile A

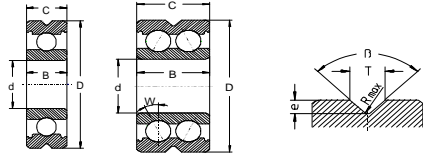

Profile A

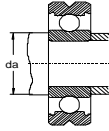

Cages and shields

- Available
- Feasible (minimum quantity)
- Out of program

Profile codes and specialities. (page 93)

- A : \* V \* notch
- SD : Without groove for protections on the outer ring
- T : Two rows of balls
- U : Ring with hole

Dimensions d D B C	Designation	Angle of contact W T		Profile specifications e R max beta			Limiting speeds rpm x 1'000 Oil Grease Contact seals			Basic load ratings Dyn. Cr Stat. Cor		Abutment dimensions da min	Mass ~ gr	Designation	Cage Y Shields						Cage J Shields						Cage T9H Shields						Cage TBH Shields																	
		mm	mm	mm	mm	mm	mm	mm	mm	mm	mm				mm	mm	mm	mm	mm	mm	mm	mm	mm	mm	mm	mm	mm	mm	mm	mm	mm	mm	mm	mm	mm	mm	mm	mm												
<b>10</b> 29.5 8 8	<b>A1007</b>	-	5.04	1.245	1.35	120	34	28	18	4.580	1.970	12.0	27	<b>A1007</b>	Open	Z	ZZ	RSR	2RSF	RSF	2RSF	RSV	2RSV	Open	Z	ZZ	RSR	2RSF	RSF	2RSF	RSV	2RSV	Open	Z	ZZ	RSR	2RSF	RSF	2RSF	RSV	2RSV	Open	Z	ZZ	RSR	2RSF	RSF	2RSF	RSV	2RSV
30 8 8	<b>A1000</b>	-	5	1.41	0.2	120	34	28	18	4.580	1.970	12.0	28.3	<b>A1000</b>	Open	Z	ZZ	RSR	2RSF	RSF	2RSF	RSV	2RSV	Open	Z	ZZ	RSR	2RSF	RSF	2RSF	RSV	2RSV	Open	Z	ZZ	RSR	2RSF	RSF	2RSF	RSV	2RSV	Open	Z	ZZ	RSR	2RSF	RSF	2RSF	RSV	2RSV
30 8 8	<b>A1001</b>	-	3.3	1.565	0.5	90	34	28	18	4.580	1.970	12.0	30.7	<b>A1001</b>	Open	Z	ZZ	RSR	2RSF	RSF	2RSF	RSV	2RSV	Open	Z	ZZ	RSR	2RSF	RSF	2RSF	RSV	2RSV	Open	Z	ZZ	RSR	2RSF	RSF	2RSF	RSV	2RSV	Open	Z	ZZ	RSR	2RSF	RSF	2RSF	RSV	2RSV
30 8 8	<b>A1006</b>	-	6	1.49	1.55	120	34	28	18	4.580	1.970	12.0	27	<b>A1006</b>	Open	Z	ZZ	RSR	2RSF	RSF	2RSF	RSV	2RSV	Open	Z	ZZ	RSR	2RSF	RSF	2RSF	RSV	2RSV	Open	Z	ZZ	RSR	2RSF	RSF	2RSF	RSV	2RSV	Open	Z	ZZ	RSR	2RSF	RSF	2RSF	RSV	2RSV
30 8 8	<b>A1008</b>	-	4.55	1.5	0.5	110	34	28	18	4.580	1.970	12.0	28.3	<b>A1008</b>	Open	Z	ZZ	RSR	2RSF	RSF	2RSF	RSV	2RSV	Open	Z	ZZ	RSR	2RSF	RSF	2RSF	RSV	2RSV	Open	Z	ZZ	RSR	2RSF	RSF	2RSF	RSV	2RSV	Open	Z	ZZ	RSR	2RSF	RSF	2RSF	RSV	2RSV
30 9 9	<b>A1009</b>	-	5.33	1.5	0.3	120	32	26	17	5.970	2.630	14.0	31	<b>A1009</b>	Open	Z	ZZ	RSR	2RSF	RSF	2RSF	RSV	2RSV	Open	Z	ZZ	RSR	2RSF	RSF	2RSF	RSV	2RSV	Open	Z	ZZ	RSR	2RSF	RSF	2RSF	RSV	2RSV	Open	Z	ZZ	RSR	2RSF	RSF	2RSF	RSV	2RSV
32 9 9	<b>A1005</b>	-	5.13	2	0.5	100	32	26	15	4.330	2.250	12.0	38.5	<b>A1005</b>	Open	Z	ZZ	RSR	2RSF	RSF	2RSF	RSV	2RSV	Open	Z	ZZ	RSR	2RSF	RSF	2RSF	RSV	2RSV	Open	Z	ZZ	RSR	2RSF	RSF	2RSF	RSV	2RSV	Open	Z	ZZ	RSR	2RSF	RSF	2RSF	RSV	2RSV
32 14 14	<b>AT10U00</b> <i>double row</i>	25	4.24	1.63	0.5	100	32	26	15	6.540	4.210	12.0	56.8	<b>AT10U00</b>	Open	Z	ZZ	RSR	2RSF	RSF	2RSF	RSV	2RSV	Open	Z	ZZ	RSR	2RSF	RSF	2RSF	RSV	2RSV	Open	Z	ZZ	RSR	2RSF	RSF	2RSF	RSV	2RSV	Open	Z	ZZ	RSR	2RSF	RSF	2RSF	RSV	2RSV
34 9 9	<b>A1003</b>	-	6.44	1.55	2	120	32	26	17	5.970	2.630	14.0	40.1	<b>A1003</b>	Open	Z	ZZ	RSR	2RSF	RSF	2RSF	RSV	2RSV	Open	Z	ZZ	RSR	2RSF	RSF	2RSF	RSV	2RSV	Open	Z	ZZ	RSR	2RSF	RSF	2RSF	RSV	2RSV	Open	Z	ZZ	RSR	2RSF	RSF	2RSF	RSV	2RSV
34 9 9	<b>A1004</b>	-	6.55	1.55	2.2	120	32	26	17	5.970	2.630	14.0	41	<b>A1004</b>	Open	Z	ZZ	RSR	2RSF	RSF	2RSF	RSV	2RSV	Open	Z	ZZ	RSR	2RSF	RSF	2RSF	RSV	2RSV	Open	Z	ZZ	RSR	2RSF	RSF	2RSF	RSV	2RSV	Open	Z	ZZ	RSR	2RSF	RSF	2RSF	RSV	2RSV
35 9 9	<b>A1002</b>	-	4.3	2.065	0.2	90	32	26	17	5.970	2.630	14.0	46.2	<b>A1002</b>	Open	Z	ZZ	RSR	2RSF	RSF	2RSF	RSV	2RSV	Open	Z	ZZ	RSR	2RSF	RSF	2RSF	RSV	2RSV	Open	Z	ZZ	RSR	2RSF	RSF	2RSF	RSV	2RSV	Open	Z	ZZ	RSR	2RSF	RSF	2RSF	RSV	2RSV
<b>12</b> 32 10 10	<b>A1200</b>	-	0.9	0.5	0.2	70	30	24	15	6.890	3.090	16.0	38	<b>A1200</b>	Open	Z	ZZ	RSR	2RSF	RSF	2RSF	RSV	2RSV	Open	Z	ZZ	RSR	2RSF	RSF	2RSF	RSV	2RSV	Open	Z	ZZ	RSR	2RSF	RSF	2RSF	RSV	2RSV	Open	Z	ZZ	RSR	2RSF	RSF	2RSF	RSV	2RSV
<b>15</b> 35 11 11	<b>A1502</b>	-	3.6	1	0.3	120	26	20	13	7.730	3.760	19.0	42	<b>A1502</b>	Open	Z	ZZ	RSR	2RSF	RSF	2RSF	RSV	2RSV	Open	Z	ZZ	RSR	2RSF	RSF	2RSF	RSV	2RSV	Open	Z	ZZ	RSR	2RSF	RSF	2RSF	RSV	2RSV	Open	Z	ZZ	RSR	2RSF	RSF	2RSF	RSV	2RSV
35 11 11	<b>A1503</b>	-	5.33	1.5	0.3	120	26	20	13	7.730	3.760	19.0	42	<b>A1503</b>	Open	Z	ZZ	RSR	2RSF	RSF	2RSF	RSV	2RSV	Open	Z	ZZ	RSR	2RSF	RSF	2RSF	RSV	2RSV	Open	Z	ZZ	RSR	2RSF	RSF	2RSF	RSV	2RSV	Open	Z	ZZ	RSR	2RSF	RSF	2RSF	RSV	2RSV
39 9 9	<b>A15SD00</b>	-	7.83	3.5	1	90	30	24	14	5.590	2.840	17.0	42.6	<b>A15SD00</b>	Open	Z	ZZ	RSR	2RSF	RSF	2RSF	RSV	2RSV	Open	Z	ZZ	RSR	2RSF	RSF	2RSF	RSV	2RSV	Open	Z	ZZ	RSR	2RSF	RSF	2RSF	RSV	2RSV	Open	Z	ZZ	RSR	2RSF	RSF	2RSF	RSV	2RSV
40 11 11	<b>A1501</b>	-	4.65	1.8	0.5	100	28	22	13	5.970	2.630	17.0	73.9	<b>A1501</b>	Open	Z	ZZ	RSR	2RSF	RSF	2RSF	RSV	2RSV	Open	Z	ZZ	RSR	2RSF	RSF	2RSF	RSV	2RSV	Open	Z	ZZ	RSR	2RSF	RSF	2RSF	RSV	2RSV	Open	Z	ZZ	RSR	2RSF	RSF	2RSF	RSV	2RSV
47 11 11	<b>A1500</b>	-	6	2.915	0.2	90	26	20	13	7.730	3.760	19.0	104	<b>A1500</b>	Open	Z	ZZ	RSR	2RSF	RSF	2RSF	RSV	2RSV	Open	Z	ZZ	RSR	2RSF	RSF	2RSF	RSV	2RSV	Open	Z	ZZ	RSR	2RSF	RSF	2RSF	RSV	2RSV	Open	Z	ZZ	RSR	2RSF	RSF	2RSF	RSV	2RSV