



**GOLD LINE™
BEVERAGE BEARINGS...**

Better by Design



SEALMASTER®
Beverage Bearing

Other Brand



Operating 27 Months

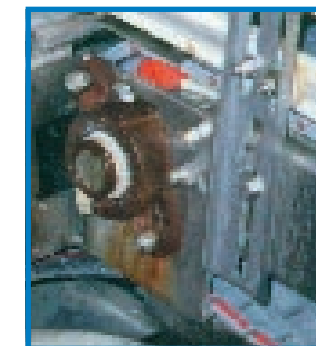

Operating 3 Months



BORE SIZE IN INCHES	TWO BOLT END CAPS		FOUR BOLT END CAP	
	OPEN	CLOSED	OPEN	CLOSED
1	TEO-16	TEC-16	FEO-16	FEC-16
1 3/16	TEO-19	TEC-19	FEO-19	FEC-19
1 1/4R	TEO-19R	TEC-19R	FEO-19R	FEC-19R
1 1/4	TEO-20	TEC-20	FEO-20	FEC-20
1 7/16	TEO-23	TEC-23	FEO-23	FEC-23
1 1/2	TEO-24	TEC-24	FEO-24	FEC-24
	TEO-27	TEC-27	FEO-27	FEC-27
1 15-16	TEO-31	TEC-31	FEO-31	FEC-31
2 3/16	TEO-35	TEC-35	FEO-35	FEC-35

BORE SIZE IN INCHES	UNIT NUMBER						
	PILLOW BLOCK		FOUR BOLT FLANGE	TWO BOLT FLANGE	TAPPED BASE	FLANGE BRACKET	TAKE-UP UNIT
	HIGH BASE	LOW BASE					
3/4	BP-12	BPL-12	BTB-12	BF-12**	BFT-12**	BFB-12	BST-12
1	BP-16	BPL-16	BTB-16	BF-16	BFT-16	BFB-16	BST-16
1 3/16	BP-19	BPL-19	BTB-19	BF-19	BFT-19	BFB-19	BST-19
1 1/4R	BP-20R	BPL-20R	BTB-20R	BF-20R	BFT-20R	BFB-20R	BST-20R
1 1/4	BP-20	BPL-20	BTB-20	BF-20	BFT-20	BFB-20	BST-20
1 7/16	BP-23	BPL-23	BTB-23	BF-23	BFT-23	BFB-23	BST-23
1 1/2	BP-24	BPL-24	BTB-24	BF-24	BFT-24		BST-24
1 11/16	BP-27	BPL-27	BTB-27	BF-27	BFT-27		BST-27
1 15/16	BP-31	BPL-31	BTB-31	BF-31	BFT-31	BFB-31	BST-31
2 3/16	BP-35	BPL-35		BF-35	BFT-35		BST-35
2 7/16	BP-39	BPL-39		BF-39**			BST-39

** No End Cap Available

or fizzy
ginger ale...



or acidic
lemonade...

or poured fruit
punch...



or foamy
root beer...



or briny
pickle juice...



or misty
citrus drink...

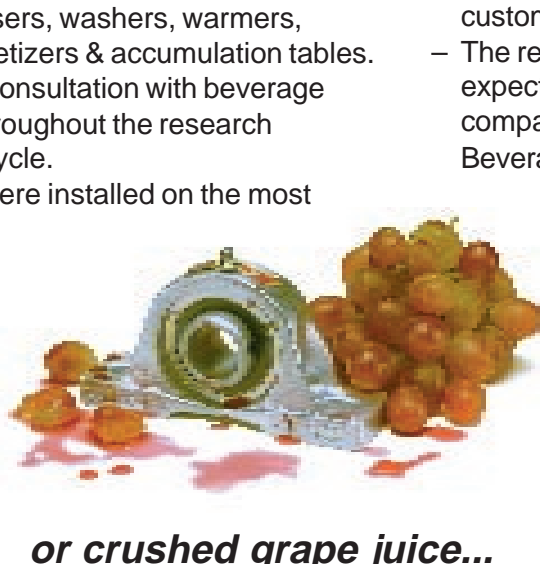

or crushed grape juice...



or bold lager...

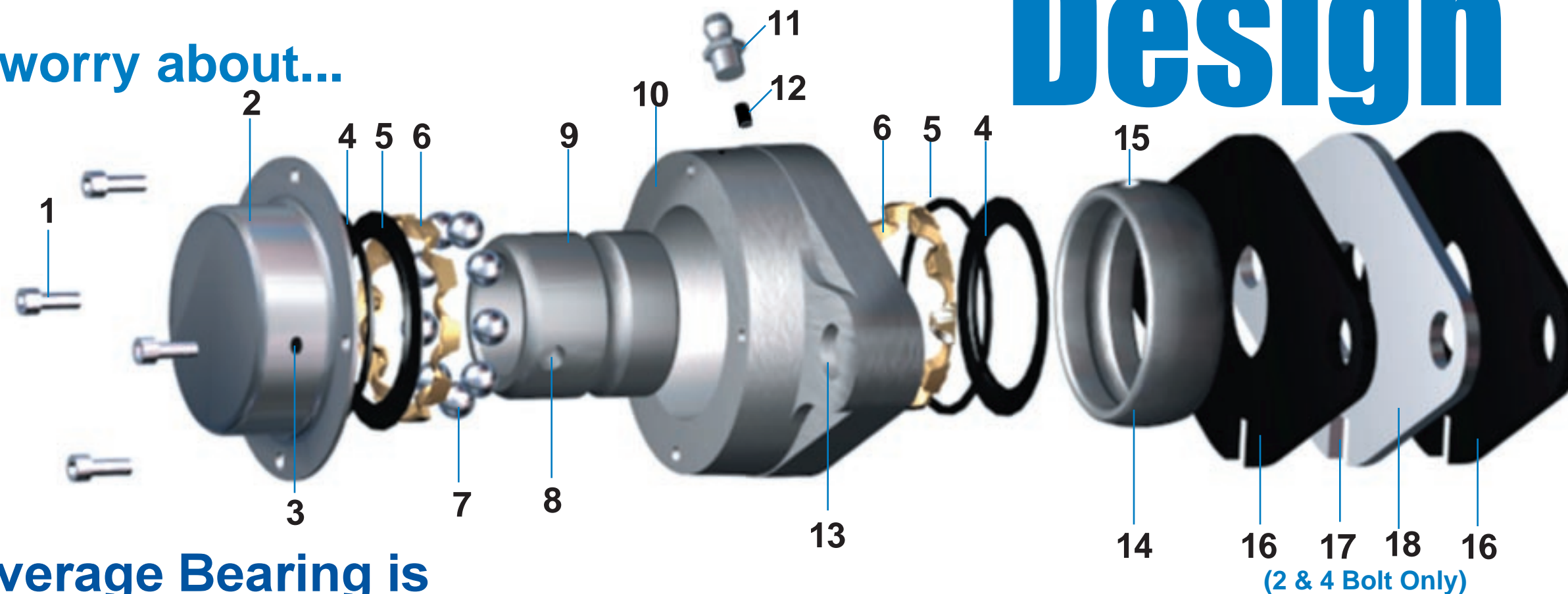

1. Stainless Cap Screws
2. Stainless Steel End Cap (2 & 4 Bolt Only)
3. End Cap Condensation Drain
4. Auxillary Seal Flingers
5. Spring Loaded Contact Seals
6. Metal Land Riding Retainer
7. Stainless Steel Balls
8. Balanced 120° Position Precision Ground Set Screws
9. Zone Hardened Thin Dense Chrome Inner Race
10. Fluoropolymer Coated Corrosion Resistant Housing
11. Stainless Lubrication Fitting
12. Direct Lube System Lock Pin
13. Stainless Washers Included For Installation
14. Thin Dense Chrome Coated Outer Race
15. ±2° Misalignment Dimple & Direct Lube
16. Rubber Gasket – Back Side Shield Assembly
17. Back Side Shield Condensation Drain
18. Stainless Shield – Back Side Shield Assembly
19. Full Grease Pack (Not Shown)

There is no need to worry about...

- Beverage Spill-overs
- High Pressure Washes
- Moisture
- Caustic Cleansers
- Grease Wash Out
- Inadequate Lubrication
- Broken Glass
- Seal Failure

The GOLD LINE™ Beverage Bearing is Designed Specifically for the Beverage Industry.

- SEALMASTER® began with a blank piece of paper... no pre-conceived notions.
- Engineers evaluated fillers, cappers, crowners, coolers, conveyors, seamers, rinsers, washers, warmers, packers, palletizers & accumulation tables.
- Continuous consultation with beverage producers throughout the research and design cycle.
- Prototypes were installed on the most challenging :
- Bearings were routinely inspected by customers and Sealmaster engineers
- Grease, coatings, seals, and races were scrutinized for over 2 years until our customers were satisfied.
- The results exceeded customer expectations and today major beverage companies demand the Sealmaster Gold Beverage Bearing...

...No Sub!

REAL Beverage Bearing Savings means more UPTIME!

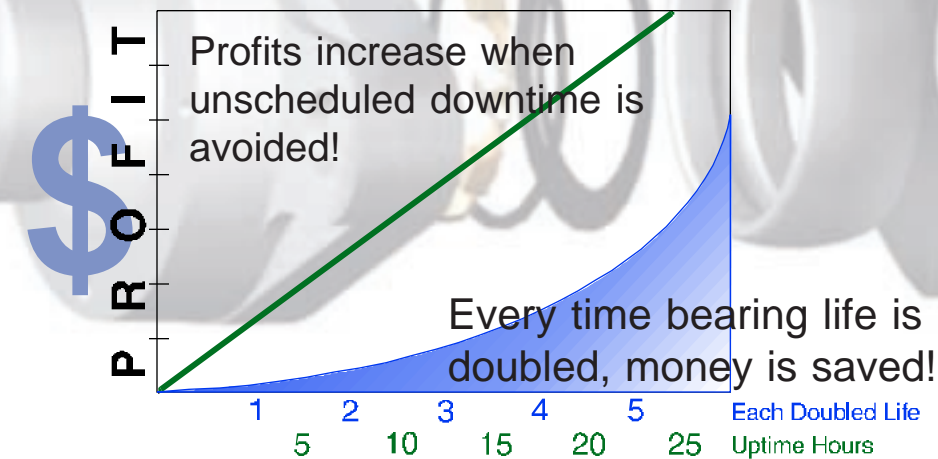
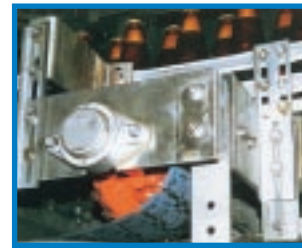

Actual field testing has proven that the GOLD LINE™ Beverage Bearing can last up to 2 years longer than ordinary bearings.

Today, sophisticated preventative maintenance programs usually identify bearings that are in the process of failing before a catastrophic emergency occurs. In the case of a breakdown, the costs at a high speed filling facility add up quickly. It is because of this that your company pays close attention to potential failures. Instead of focusing on downtime, we know you want to maximize your **uptime**. Even scheduled maintenance halts production and takes away manufacturing efficiencies, not to mention the indirect labor costs, actual replacement costs of the bearing and any other damage that may have occurred. The bottom line here is that the SEALMASTER® GOLD LINE™ Beverage Bearing contributes to your long term production reliability and **the most uptime**.



or squeezed orange juice...



or cracked iced tea...

SEALMASTER

WORLD'S MOST SPECIFIED BEARINGS ... IN A CLASS BY THEMSELVES

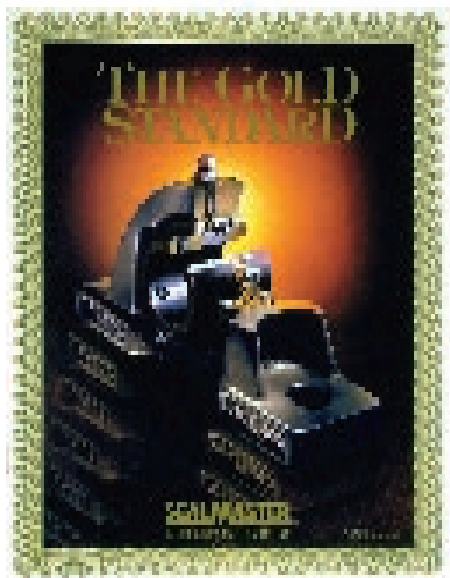

SEALMASTER® Gold Line™ standard and custom design ball bearings offer outstanding performance in a wide range of applications. Request Catalog GL 93.

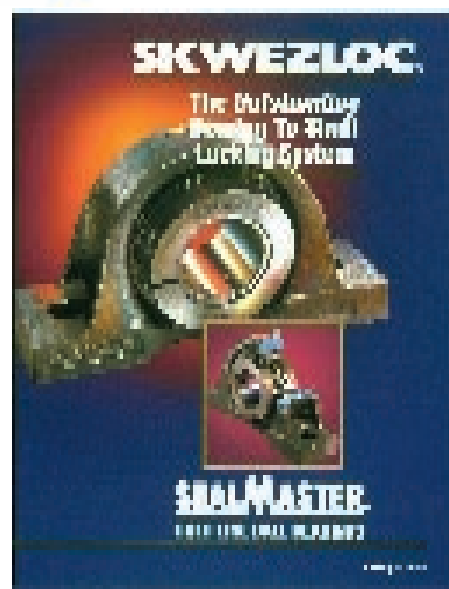

SEALMASTER® Gold Line™ Bearings equipped with the patented SKWEZLOC® locking system provide outstanding holding performance. Request Catalog GLS 94.

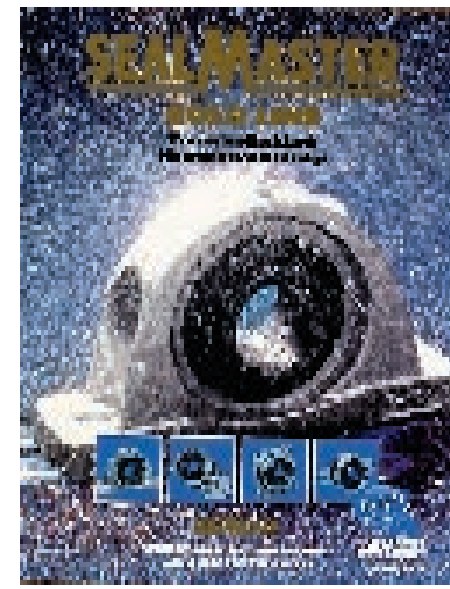

SEALMASTER® Gold Line™ Corrosion Resistant Bearings are specifically designed and manufactured for abrasive and wet atmospheres. Request Catalog CR 95.

Ask your Authorized SEALMASTER® Bearing distributor or any of the Customer Service Centers shown below for the latest product catalogs, engineering data and ordering information.

MORSE CUSTOMER SERVICE CENTERS - USA

Florence, KY 41022-0728 7120 Buffington Road P.O. Box 728 Telephone 606-342-7900 1-800-354-9825 Fax 606-342-5652 606-342-5654	Los Angeles CA 91710-2977 3553 Placentia Court Chino, CA 91720-2977 Telephone (CA) 1-800-468-3751 (OTHER) 1-800-421-6047 Fax 1-800-261-6516
---	--

CUSTOMER SERVICE CENTER - CANADA

Markham, Ont., Canada
9999 Highway 48
Markham ONT L3P 3J3
Telephone 905-475-4610
1-800-268-4149
Fax 1-800-668-9005

EXPORT SALES DEPARTMENT

7120 Buffington Road
Florence KY, 41042
Telephone 606-727-5273
Fax 606-727-0721

BROWNING CUSTOMER SERVICE CENTER-USA

Maysville, KY 41056
P.O. Box 687
Telephone 606-564-2011
1-800-626-2120
Fax 606-564-2052
1-800-262-3292

McGILL MANUFACTURING

909 Lafayette Street
Valparaiso, IN 46383
Telephone 219-465-2200
Fax 219-465-2290

EMERSON POWER TRANSMISSION CORP.
620 S. AURORA STREET
ITHACA, NY 14850

Form #8508 2/97
Printed in U.S.A.

APPLICATION CONSIDERATIONS

The proper selection and application of power transmission products and components, including the related area of product safety, is the responsibility of the customer. Operating and performance requirements and potential associated issues will vary appreciably depending upon the use and application of such products and components. The scope of the technical and application information included in this publication is necessarily limited. Unusual operating environments and conditions, lubrication requirements, loading supports, and other factors can materially affect the application and operating results of the products and components and the customer should carefully review its requirements. Any technical advice or review furnished by Emerson Power Transmission Corporation and its divisions with respect to the use of products and components is given in good faith and without charge, and Emerson assumes no obligation or liability for the advice given, or results obtained, all such advice and review being given and accepted at customer's risk.

For a copy of our *Standard Terms and Conditions of Sale, Disclaimers of Warranty, Limitation of Liability and Remedy*, please refer to Catalog BP-96 or contact one of the sales offices shown at left. *These terms and conditions of sale, disclaimers and limitations apply to any person who may buy, acquire or use SEALMASTER bearings referred to herein, including any person who buys from a licensed distributor of SEALMASTER products.*

SEALMASTER

GOLD LINE™ BALL BEARINGS

Beverage Bearing

No need to cry over spilled milk!

...or sticky sports drink!

...or sudsy beer!

...or splashed cola!

WORLD'S MOST SPECIFIED BEARINGS ...IN A CLASS BY THEMSELVES

