

**Sealmaster Beverage Bearing  
with Closed End Cap**



A: Drain Slot on Bottom  
B: Drain Hole on Bottom

Contact Sealmaster Engineering for detailed  
Beverage Bearing Installation Instructions.  
(630) 898-9620 PN 782261  
PS-740-0016 6/1/98 Printed in U.S.A.

© Emerson Power Transmission Manufacturing, L.P. 1998.  
All Rights Reserved.

**Sealmaster Beverage Bearing  
with Open End Cap**

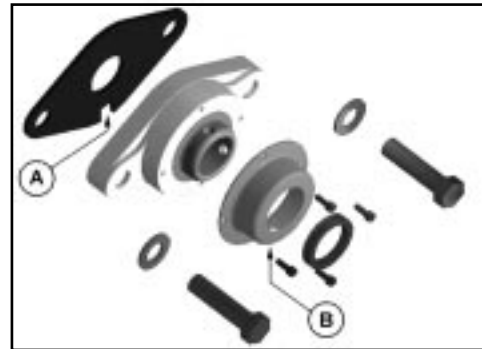

A: Drain Slot on Bottom  
B: Drain Hole on Bottom

Contact Sealmaster Engineering for detailed  
Beverage Bearing Installation Instructions.  
(630) 898-9620

PS-740-0016 6/1/98 Printed in U.S.A.

© Emerson Power Transmission Manufacturing, L.P. 1998.  
All Rights Reserved.